

NOTE:  
 1. THE EXISTING POSTED SPEED LIMIT IS 40 MPH.  
 2. "WORKERS" SIGN SHALL BE THE SYMBOLIC VERSION AND SHALL BE REMOVED WHEN NO WORKERS ARE PRESENT.

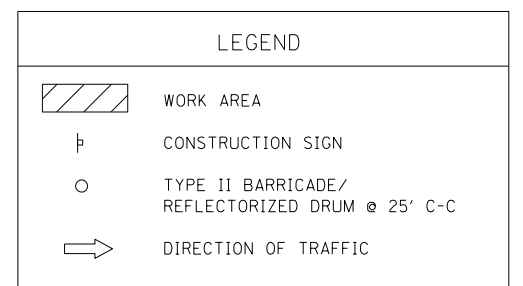

I:\6710\6710\_18 - McCarthy at Walker Intersection\_imp\CADD\CADD SHEETS\60L79-ht-staging\_1-Walker.dgn

FILE NAME =	USER NAME = r9e11	DESIGNED - RG	REVISED -
		DRAWN - RG	REVISED -
	PLOT SCALE = 100.0000' / in.	CHECKED - MGR	REVISED -
	PLOT DATE = 10/19/2012	DATE - MARCH, 2012	REVISED -

**STATE OF ILLINOIS  
DEPARTMENT OF TRANSPORTATION**

**STAGING PLANS  
WALKER ROAD  
STAGE I**

SCALE: SHEET NO. OF SHEETS STA. TO STA.

F.A.U. RTE.	SECTION	COUNTY	TOTAL SHEETS	SHEET NO.
1587	3098-R	COOK	95	34
CONTRACT NO. 60L79				
ILLINOIS FED. AID PROJECT				