

| | |
|--------------|---------------|
| DATE | |
| BY | |
| FINAL SURVEY | SURVEYED |
| NOTE BOOK | PLOTTED |
| NO. | TEMPLATE |
| | AREAS CHECKED |

| | |
|-----------------|---------------|
| DATE | |
| BY | |
| ORIGINAL SURVEY | SURVEYED |
| NOTE BOOK | PLOTTED |
| NO. | TEMPLATE |
| | AREAS CHECKED |

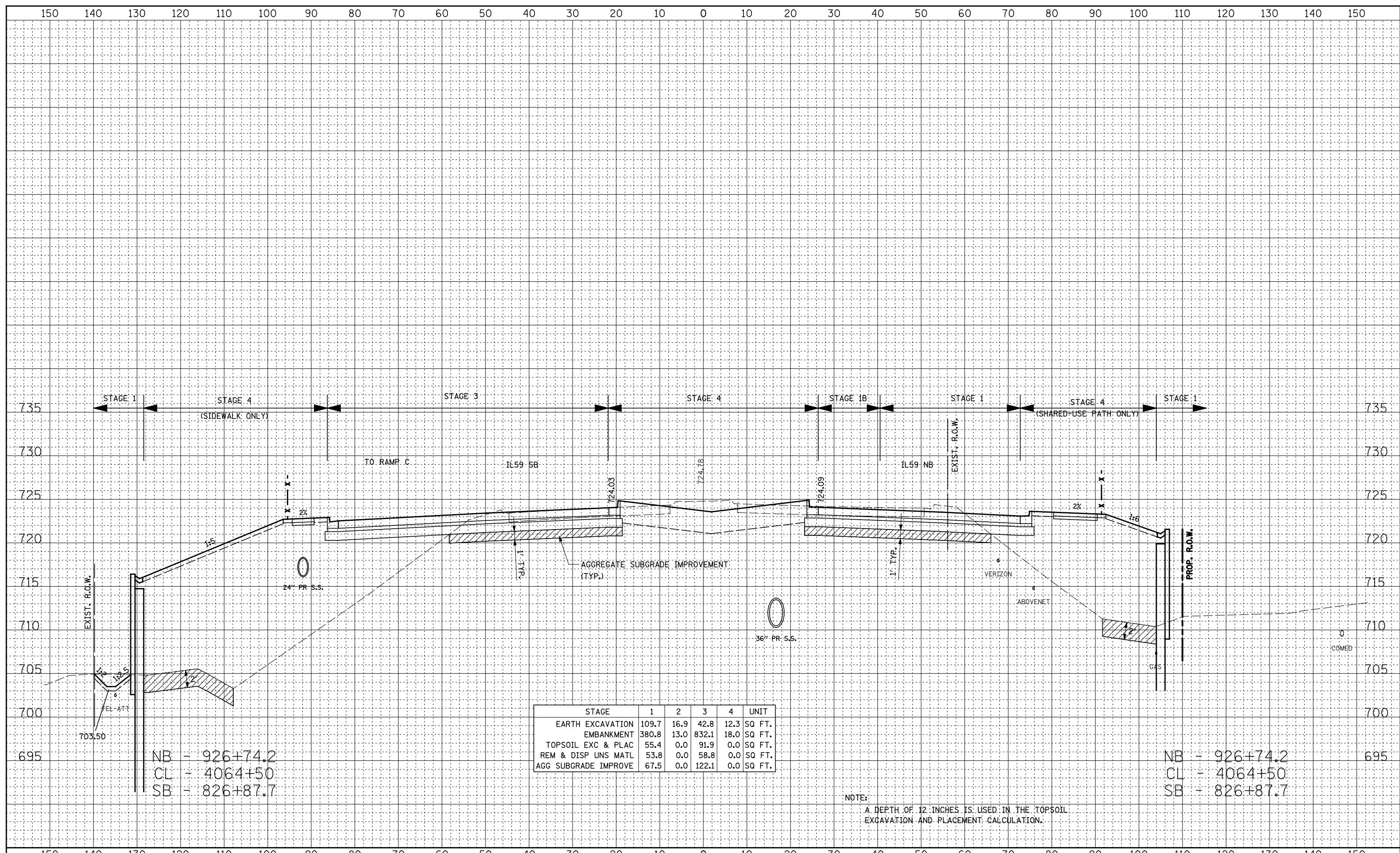

| STAGE | 1 | 2 | 3 | 4 | UNIT |
|----------------------|-------|------|-------|------|--------|
| EARTH EXCAVATION | 109.7 | 16.9 | 42.8 | 12.3 | SQ FT. |
| EMBANKMENT | 380.8 | 13.0 | 832.1 | 18.0 | SQ FT. |
| TOPSOIL EXC & PLAC | 55.4 | 0.0 | 91.9 | 0.0 | SQ FT. |
| REM & DISP UNS MATL | 53.8 | 0.0 | 58.8 | 0.0 | SQ FT. |
| AGG SUBGRADE IMPROVE | 67.5 | 0.0 | 122.1 | 0.0 | SQ FT. |

NB - 926+74.2
 CL - 4064+50
 SB - 826+87.7

NB - 926+74.2
 CL - 4064+50
 SB - 826+87.7

NOTE:
 A DEPTH OF 12 INCHES IS USED IN THE TOPSOIL EXCAVATION AND PLACEMENT CALCULATION.