

ELEVATION OF BEAM
(Showing reinforcement & dimensions)

Note A:
Hex nuts (top and bottom) with lock washers (top). Only tighten sufficiently to compress lock washers.

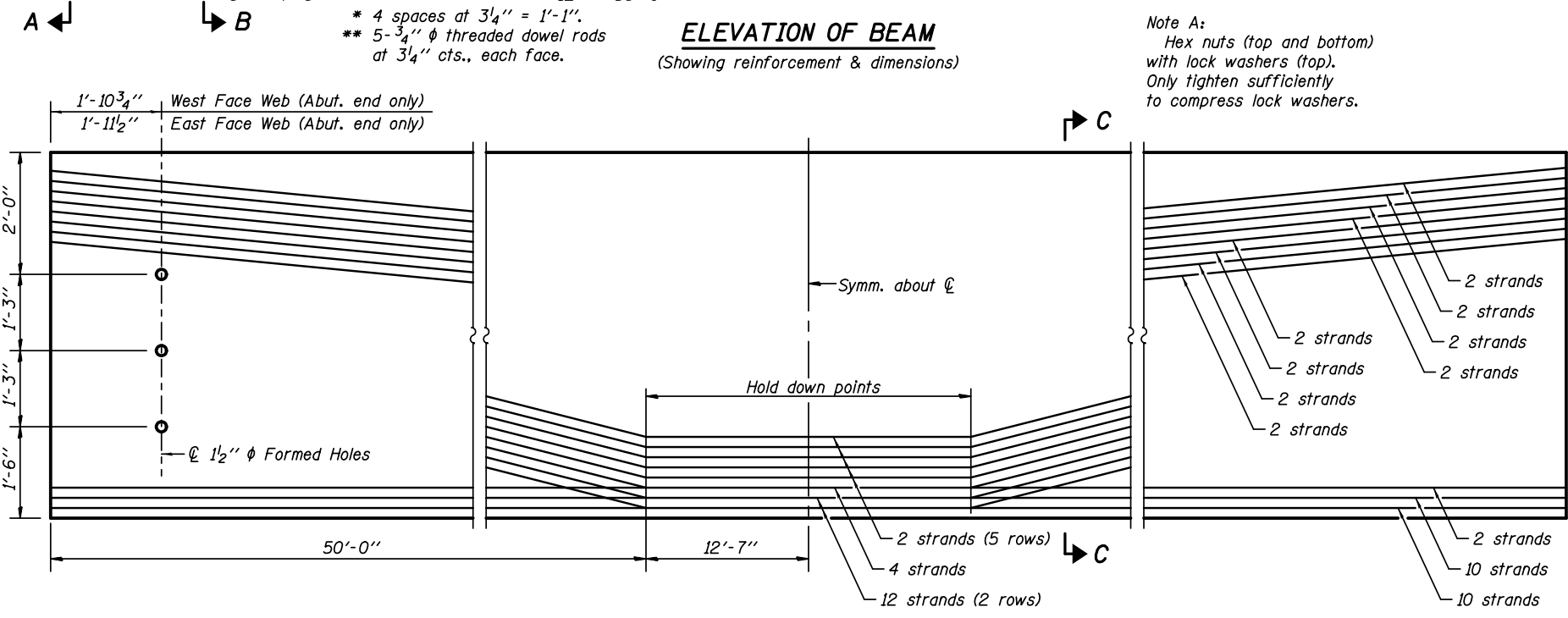

ELEVATION OF BEAM
(Showing prestressing steel)

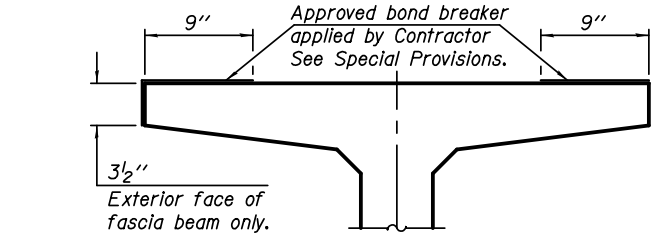

SECTION THRU TOP FLANGE
(Showing limits of bond breaker)

*****BAR LIST ONE BEAM ONLY**

Bar	No.	Size	Length	Shape
G ₁	132	#4	13'-5"	∩L
G ₂	20	#4	11'-8"	∩
G ₃	30	#6	27'-3"	∩
G ₄	56	#3	4'-11"	∩
G ₅	167	#5	3'-4"	∩
G ₆	3	#8	6'-6"	U

***For information only

Notes:
See sheet SA-43 for additional details and Bill of Material.
Required release strength, f'ci, shall be 5200 psi.
Apply approved bond breaker as shown in Section thru Top Flange full length of beam. See Special Provisions.

PBT-4-72

4-16-12

KNIGHT
Engineers & Architects

DESIGNED - WPM	REVISION
CHECKED - TB	REVISION
SCALE - NONE	REVISION
DATE - 10/15/2012	REVISION
DRAWN - TB	REVISION
CHECKED - WPM	REVISION

STATE OF ILLINOIS
DEPARTMENT OF TRANSPORTATION

72" PPC BULB T-BEAM
S.N. 022-2029 (SB) TOLLWAY B.N. 826
S.N. 022-2030 (NB) TOLLWAY B.N. 825
SHEET NO. SA-42 OF 63 SHEETS

F.A.P. RTE.	SECTION	COUNTY	TOTAL SHEETS	SHEET NO.
338	(112 & 113) WRS-5	DUPAGE	963	626
CONTRACT NO. 60131				
ILLINOIS FED. AID PROJECT				