

**WEST EDGE OF PAVEMENT**

| Location                  | Station   | Offset | Theoretical Grade Elevations |
|---------------------------|-----------|--------|------------------------------|
| S. End South Appr. Pav't. | 818+99.65 | -42.00 | 730.84                       |
| A1                        | 819+09.65 | -42.00 | 730.96                       |
| A2                        | 819+19.65 | -42.00 | 731.08                       |
| N. End South Appr. Pav't  | 819+29.65 | -42.00 | 731.18                       |

**@ SB IL 59, PROFILE GRADE LINE & EAST EDGE OF PAVEMENT**

| Location                  | Station   | Offset | Theoretical Grade Elevations |
|---------------------------|-----------|--------|------------------------------|
| S. End South Appr. Pav't. | 819+05.39 | 0.00   | 730.04                       |
| A1                        | 819+15.39 | 0.00   | 730.15                       |
| A2                        | 819+25.39 | 0.00   | 730.26                       |
| N. End South Appr. Pav't  | 819+35.39 | 0.00   | 730.37                       |

**WEST EDGE OF PAVEMENT**

| Location                  | Station   | Offset | Theoretical Grade Elevations |
|---------------------------|-----------|--------|------------------------------|
| S. End North Appr. Pav't. | 821+82.68 | -42.00 | 732.25                       |
| A3                        | 821+92.68 | -42.00 | 732.23                       |
| A4                        | 822+02.68 | -42.00 | 732.20                       |
| N. End North Appr. Pav't  | 822+12.68 | -42.00 | 732.16                       |

**@ SB IL 59, PROFILE GRADE LINE & EAST EDGE OF PAVEMENT**

| Location                  | Station   | Offset | Theoretical Grade Elevations |
|---------------------------|-----------|--------|------------------------------|
| S. End North Appr. Pav't. | 821+88.42 | 0.00   | 731.36                       |
| A3                        | 821+98.42 | 0.00   | 731.34                       |
| A4                        | 822+08.42 | 0.00   | 731.30                       |
| N. End North Appr. Pav't  | 822+18.42 | 0.00   | 731.27                       |

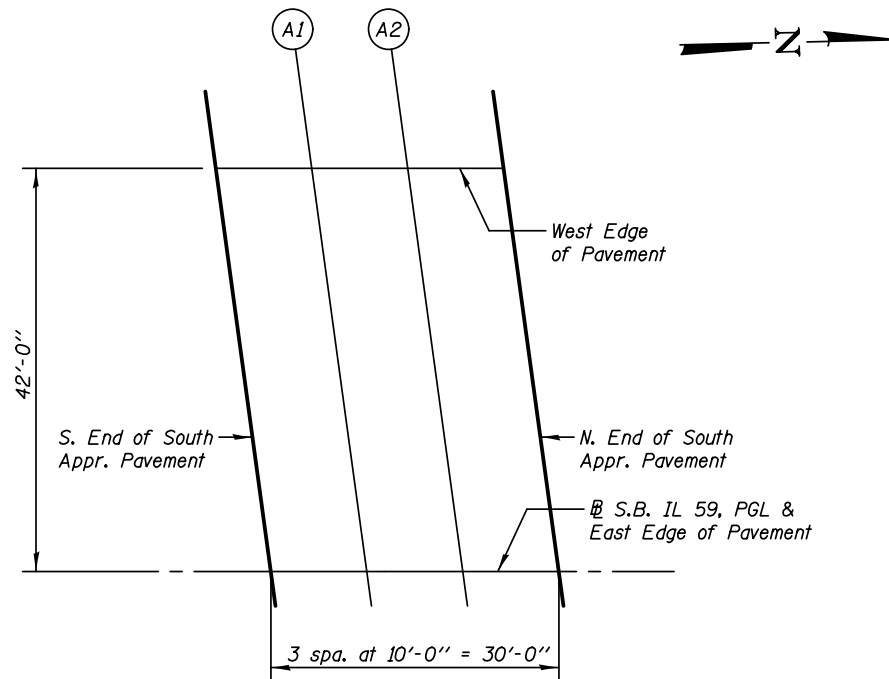

**PLAN**  
South Approach (SB)

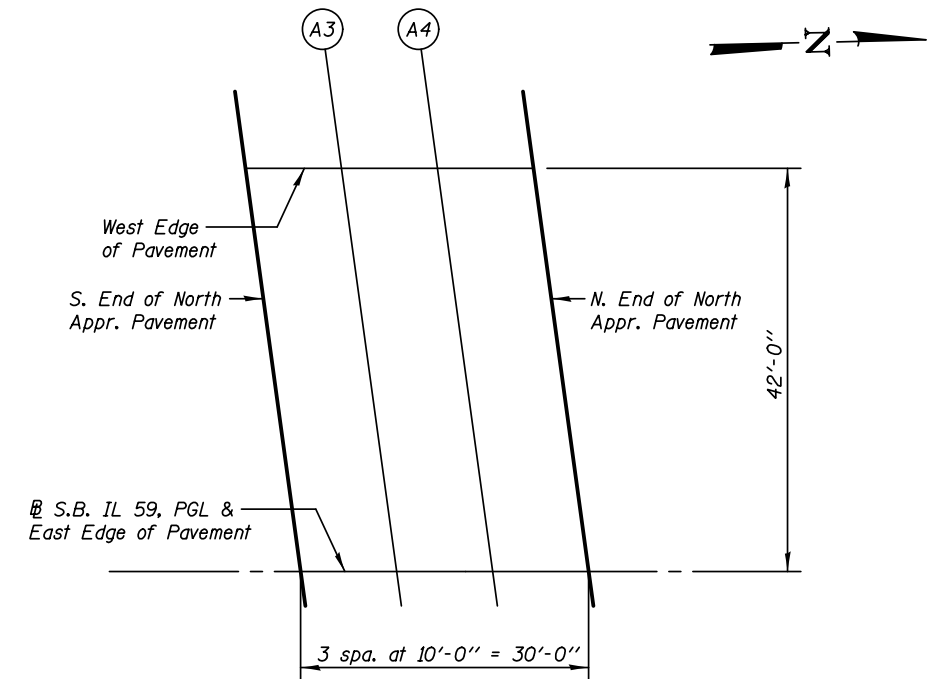

**PLAN**  
North Approach (SB)