

1. FOR SYMBOL LIST AND GENERAL ELECTRICAL NOTES, SEE SHEET LT-01.
2. INSTALL CCTV DOME CAMERA (TEMPORARY), CCTV EQUIPMENT, FIBER OPTIC DISTRIBUTION AND CCTV VIDEO DECODER ON TRAFFIC SIGNAL POLE. POWER THE CABINET FROM THE TRAFFIC SIGNAL CONTROL CABINET ON THE SAME POLE. RUN POWER CABLE (BELDEN TYPE 5140U1) AND VIDEO/SIGNAL CABLE (BELDEN TYPE 5499X5) ALL IN (1) 1" RGS CONDUIT ATTACHED TO THE POLE BETWEEN CABINET AND CCTV CAMERA AS PART OF CCTV DOME CAMERA PAY ITEM. SEE TEMPORARY TRAFFIC SIGNAL DRAWINGS FOR EXACT POLE LOCATION.
3. FIBER OPTIC CABLES SHALL BE RUN DOWN THE WOOD POLE AND UNDERGROUND TO THE NEW COMMUNICATIONS VAULT OF G4S NETWORK IN A 2" RGS CONDUIT.
4. TEMPORARY WOOD POLES, CAMERA, CABINET AND FIBER OPTIC SHALL BE REMOVED WHEN PERMANENT CAMERAS IS OPERATIONAL. WORK SHALL BE INCLUDED IN "REMOVE TEMPORARY WOOD POLE" PAY ITEM.

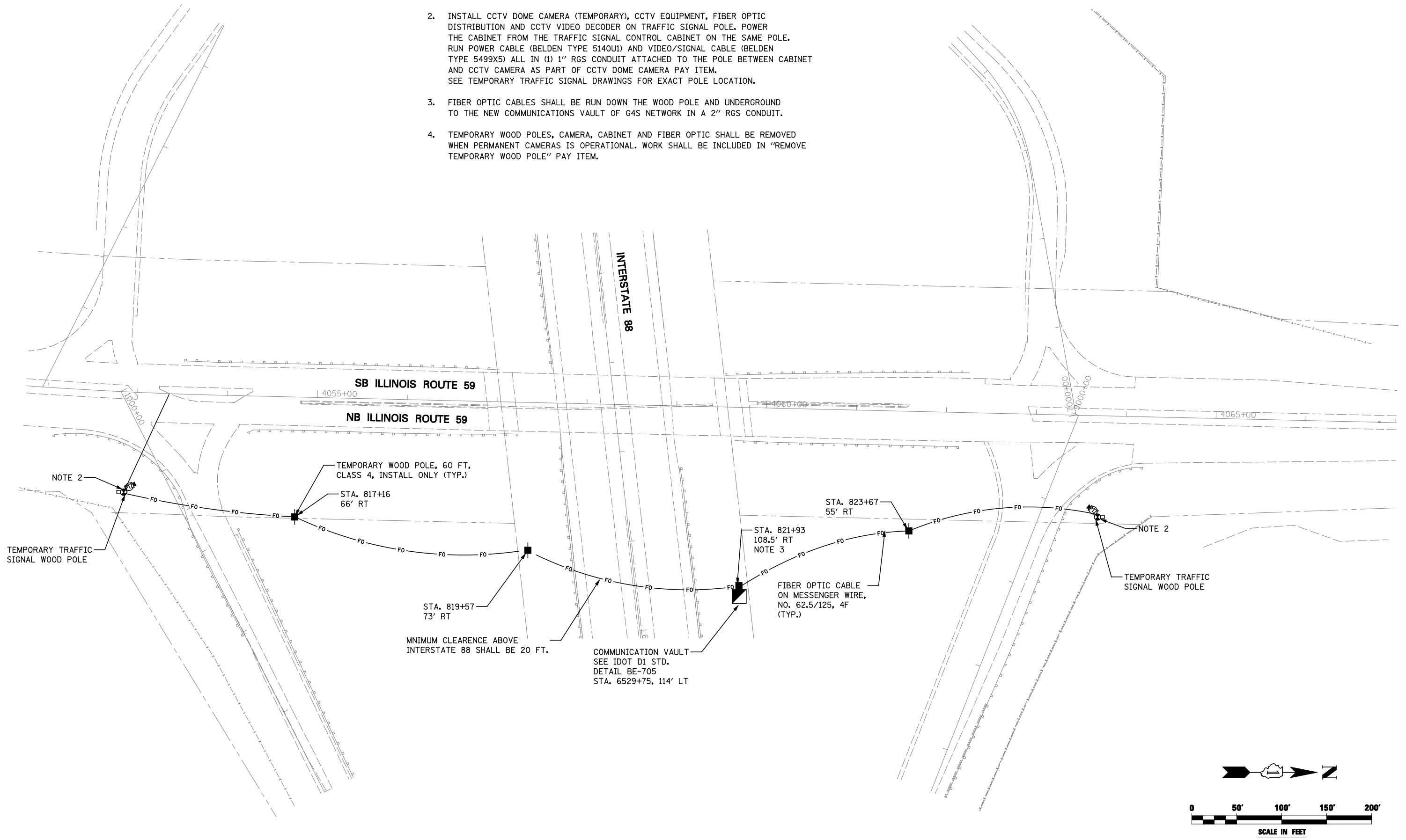

FILE NAME =	USER NAME = \$USER*	DESIGNED MCP	REVISED -
\$FILEL\$		DRAWN MLB	REVISED -
	PLOT SCALE = \$SCALE*	CHECKED MCP	REVISED -
	PLOT DATE = \$DATE*	DATE 10/15/2012	REVISED -

**STATE OF ILLINOIS
DEPARTMENT OF TRANSPORTATION**

**IDOT TEMPORARY CCTV CAMERA INSTALLATION PLAN
ILLINOIS ROUTE 59 AT INTERSTATE 88**

SCALE: AS SHOWN SHEET NO. 1 OF 1 SHEETS STA. 4051+75 TO STA. 4067+00

F.A.P. RTE.	SECTION	COUNTY	TOTAL SHEETS	SHEET NO.
338	(112 & 113) WRS-5	DUPAGE	963	557
LT-02			CONTRACT NO. 60I31	
ILLINOIS FED. AID PROJECT				