





STAGE 1A TEMPORARY TRAFFIC SIGNALS
SEE SHEET TS-20 FOR STAGE 1A TEMPORARY CABLE PLAN

RESTORATION OF WORK AREA. RESTORATION OF THE TRAFFIC SIGNAL WORK AREA SHALL BE INCIDENTAL TO THE RELATED PAY ITEM SUCH AS FOUNDATION, CONDUIT, HANDHOLE, TRENCH AND BACKFILL, ETC., AND NO EXTRA COMPENSATION SHALL BE ALLOWED. ALL ROADWAY SURFACES SUCH AS SHOULDERS, MEDIANS, SIDEWALKS, PAVEMENT, ETC. SHALL BE REPLACED IN KIND. ALL DAMAGE TO MOWED LAWNS SHALL BE REPLACED WITH AN APPROVED SOD, AND ALL DAMAGE TO UNMOWED FIELDS SHALL BE SEED IN ACCORDANCE WITH STANDARD SPECIFICATIONS 252 AND 250 RESPECTIVELY.

THE TRAFFIC SIGNAL CONTROLLER EQUIPMENT SHALL BE "ECONOLITE" TO MATCH THE EXISTING ADJACENT SYSTEM.

- LEGEND**
-  CONSTRUCTION WORK ZONE
 -  TEMPORARY PAVEMENT PLACED IN THIS STAGE
 -  DIRECTION OF TRAFFIC
 -  VIDEO DETECTION ZONE

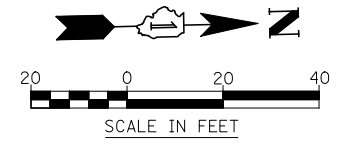
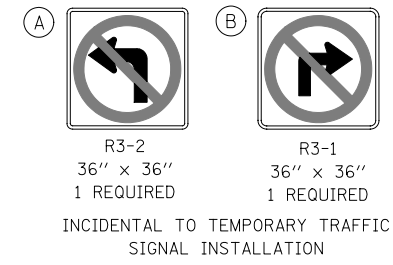

FILE NAME =	USER NAME = #USER#	DESIGNED <i>MJM</i>	REVISED -
#FILE#		DRAWN <i>KES</i>	REVISED -
	PLOT SCALE = #SCALE#	CHECKED <i>JCM</i>	REVISED -
	PLOT DATE = #DATE#	DATE <i>10/15/2012</i>	REVISED -

**STATE OF ILLINOIS
DEPARTMENT OF TRANSPORTATION**

TEMPORARY TRAFFIC SIGNAL INSTALLATION			
MOT STAGE 1A			
ILLINOIS ROUTE 59 AND I-88 SOUTH RAMPS			
SCALE: AS SHOWN	SHEET NO. 19 OF 53 SHEETS	STA. TO STA.	

F.A.P. RTE.	SECTION	COUNTY	TOTAL SHEETS	SHEET NO.
338	(112 & 113) WRS-5	DUPAGE	963	434
TS-19			CONTRACT NO. 60131	
ILLINOIS FED. AID PROJECT				