

SIGN DETAIL
1:75

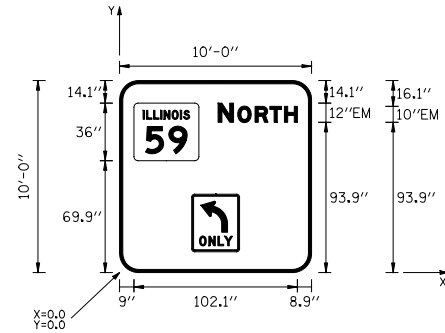

SIGN NUMBER	G-IT-02AL
WIDTH x HGHT.	10'-0" x 10'-0"
BORDER WIDTH	2"
CORNER RADIUS	12"
MOUNTING	Overhead
BACKGROUND	TYPE: ZZ SHEETING COLOR: Green
LEGEND/BORDER	TYPE: ZZ SHEETING COLOR: White/White

SYMBOL	ROT	X	Y	WID	HT
M1-1100A-2-32-15D	0	9	69.9	40.5	36
R3-SL	0	45	13	30	36

Panel Style: guide_exp_advance_intermediata.ssi
Dimensions are in Inches.tenths

Letter locations are panel edge to lower left corner

LETTER POSITIONS (X)					LENGTH	SERIES/SIZE
N	O	R	T	H		EM 2000
61.5	73.8	84.6	93.8	103	49.6	12,10
FOR INFORMATION ONLY						
SIGN PANEL TO BE FURNISHED BY THE ILLINOIS TOLLWAY. CONTRACTOR TO PICK UP SIGN PANELS FROM THE ILLINOIS TOLLWAY SIGN SHOP.						

SIGN DETAIL
1:75

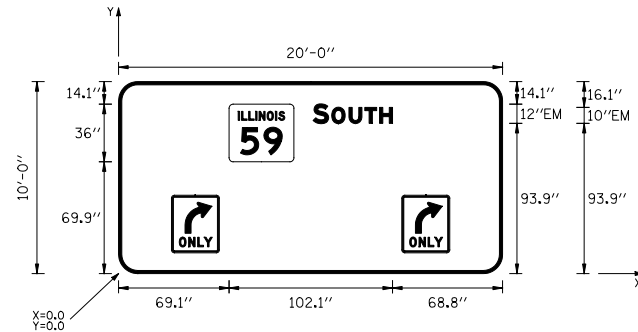

SIGN NUMBER	G-IT-02BR
WIDTH x HGHT.	20'-0" x 10'-0"
BORDER WIDTH	2"
CORNER RADIUS	12"
MOUNTING	Overhead
BACKGROUND	TYPE: ZZ SHEETING COLOR: Green
LEGEND/BORDER	TYPE: ZZ SHEETING COLOR: White/White

SYMBOL	ROT	X	Y	WID	HT
M1-1100A-2-32-15D	0	69.1	69.9	40.5	36
R3-SR	0	33	13	30	36
R3-SR	0	177	13	30	36

Panel Style: guide_exp_advance_intermediata.ssi
Dimensions are in Inches.tenths

Letter locations are panel edge to lower left corner

LETTER POSITIONS (X)					LENGTH	SERIES/SIZE
S	O	U	T	H		EM 2000
121.6	133.2	144	153.9	163.1	49.6	12,10
FOR INFORMATION ONLY						
SIGN PANEL TO BE FURNISHED BY THE ILLINOIS TOLLWAY. CONTRACTOR TO PICK UP SIGN PANELS FROM THE ILLINOIS TOLLWAY SIGN SHOP.						

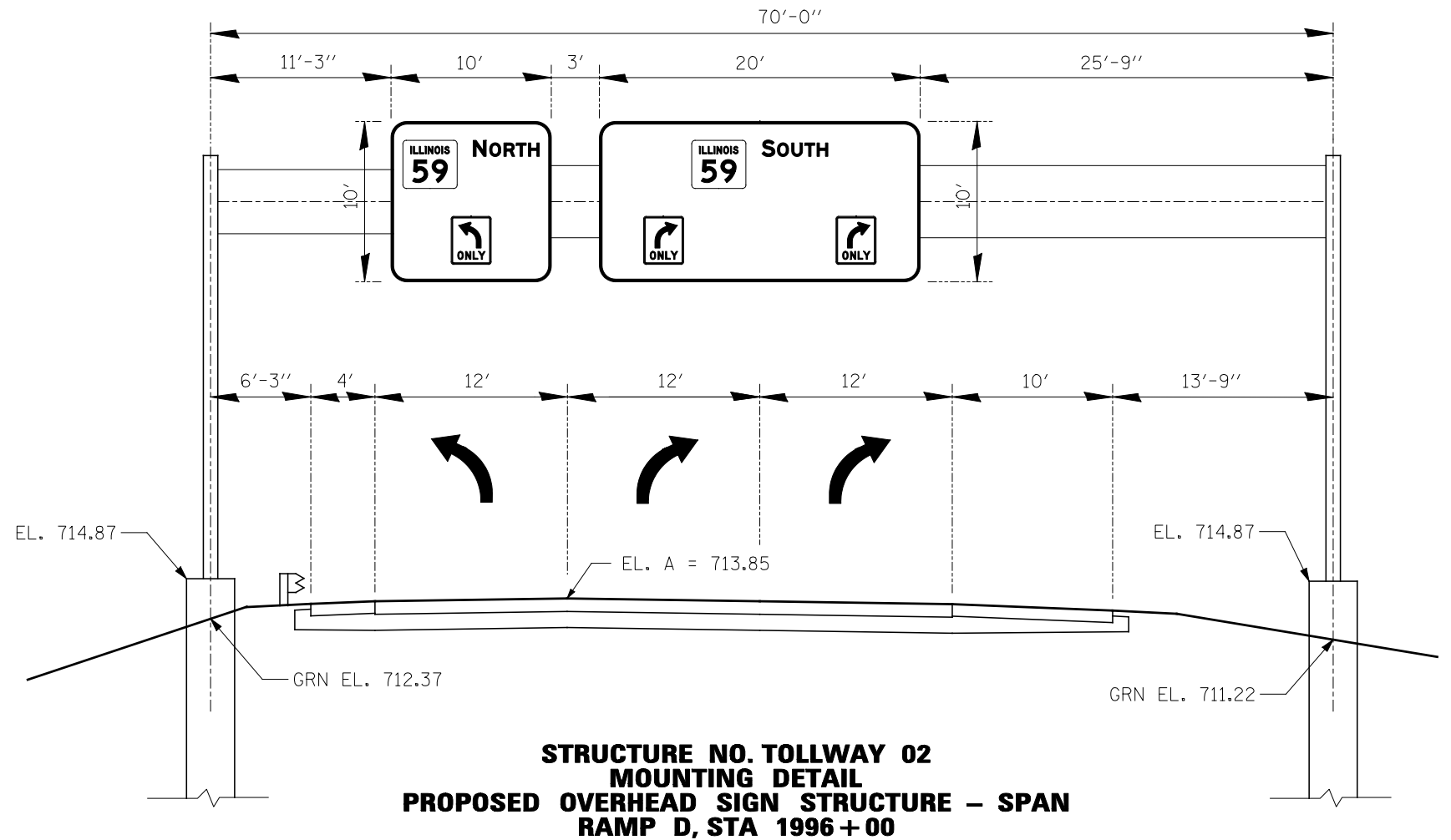

**STRUCTURE NO. TOLLWAY 02
MOUNTING DETAIL
PROPOSED OVERHEAD SIGN STRUCTURE - SPAN
RAMP D, STA 1996+00**

FILE NAME =	USER NAME = #USER#	DESIGNED <i>PJO</i>	REVISED -
#FILEL#		DRAWN <i>KES</i>	REVISED -
	PLOT SCALE = #SCALE#	CHECKED <i>JCM</i>	REVISED -
	PLOT DATE = #DATE#	DATE <i>10/15/2012</i>	REVISED -

**STATE OF ILLINOIS
DEPARTMENT OF TRANSPORTATION**

**SIGN STRUCTURES
SPAN [TOLLWAY 02]**

SCALE: SHEET NO. 15 OF 15 SHEETS STA. 1996+00 TO STA.

F.A.P. RTE.	SECTION	COUNTY	TOTAL SHEETS	SHEET NO.
338	(112 & 113) WRS-5	DUPAGE	963	415
CONTRACT NO. 60I31				
ILLINOIS FED. AID PROJECT				