

MATCH LINE SEE IL 59
PAVEMENT JOINTING SHEET

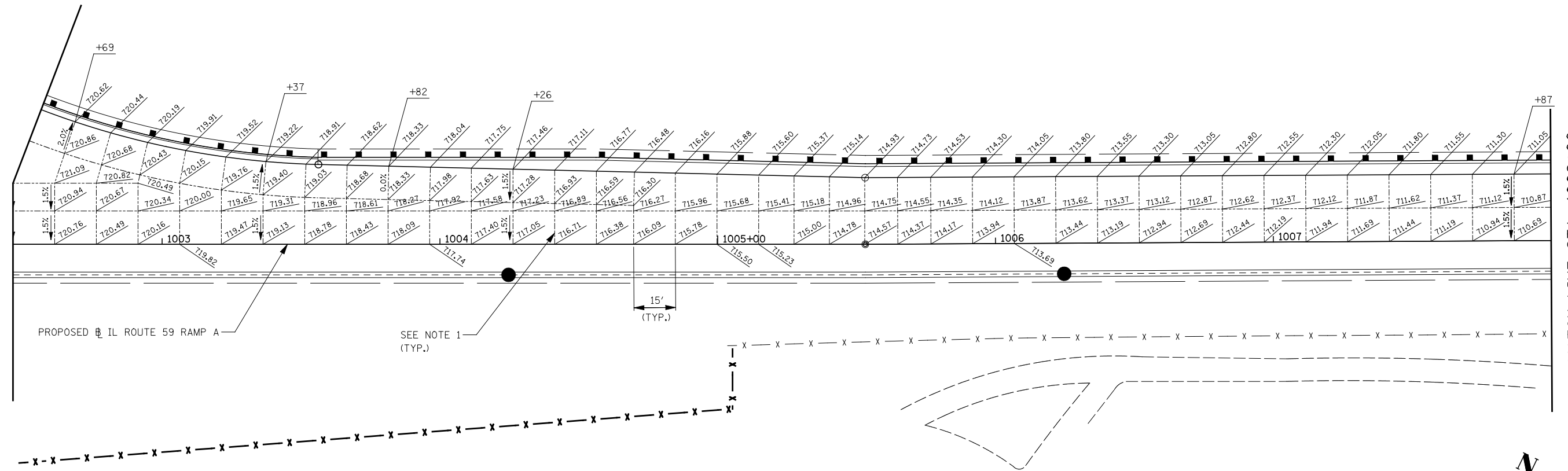

MATCH LINE STA. 1008+00

MATCH LINE STA. 1008+00

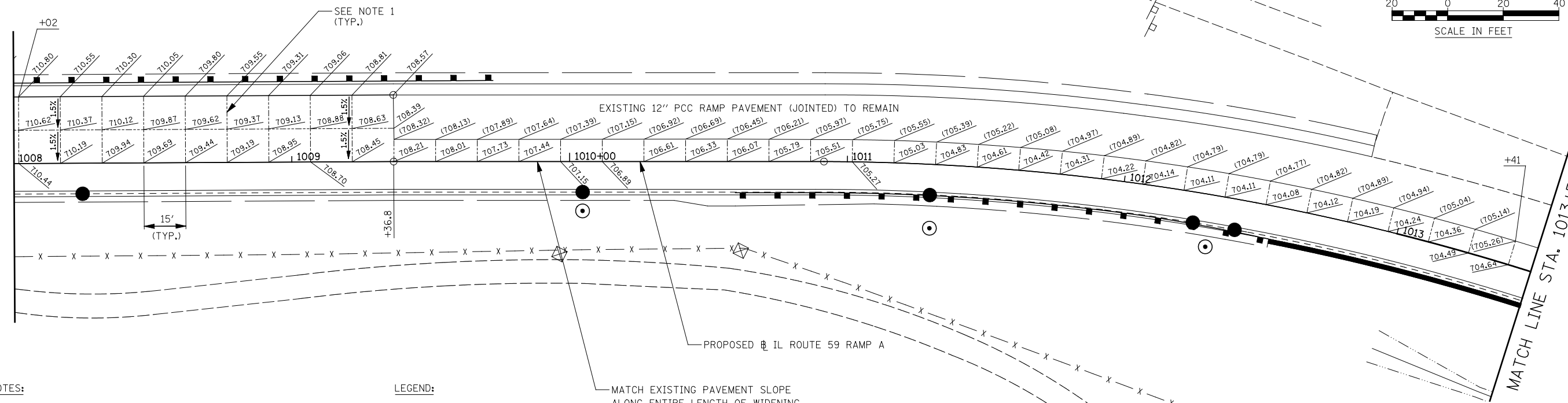

MATCH LINE STA. 1013+50

NOTES:

1. JOINTING PATTERN SHOWN IS FOR GRADING PURPOSES ONLY. THE CONTRACTOR SHALL FOLLOW TOLLWAY STANDARD A5-01 FOR ALL TRANSVERSE JOINTS.

LEGEND:

- (XXX.XX) EXISTING ELEVATION
- XXX.XX PROPOSED ELEVATION

MATCH EXISTING PAVEMENT SLOPE
ALONG ENTIRE LENGTH OF WIDENING
(SEE TYPICAL SECTIONS)

FILE NAME = #FILE#	USER NAME = #USER#	DESIGNED <i>PJO</i>	REVISED -
		DRAWN <i>KES</i>	REVISED -
		CHECKED <i>JCM</i>	REVISED -
		DATE <i>10/15/2012</i>	REVISED -

STATE OF ILLINOIS
DEPARTMENT OF TRANSPORTATION

PAVEMENT JOINTING AND ELEVATION PLAN - RAMP A

SCALE: AS SHOWN SHEET NO. 3 OF 13 SHEETS STA. 1002+50 TO STA. 1013+50

F.A.P. RTE. 338	SECTION (112 & 113) WRS-5	COUNTY DUPAGE	TOTAL SHEETS 963	SHEET NO. 301
CONTRACT NO. 60131				
ILLINOIS FED. AID PROJECT				