

NOTES

- FOR PROPOSED PAVEMENT, CURB & GUTTER, AND PROFILE INFORMATION SEE PLAN / PROFILE - ILLINOIS ROUTE 59 AND PLAN / PROFILE - I-88 RAMP SHEETS.
- FOR PROPOSED PAVEMENT MARKING & SIGNING INFORMATION SEE PAVEMENT MARKING AND SIGNING - ILLINOIS ROUTE 59 AND PAVEMENT MARKING AND SIGNING - I-88 RAMP SHEETS.
- FOR PROPOSED ILLINOIS ROUTE 59 AND I-88 RAMP PAVEMENT GEOMETRY INFORMATION SEE GEOMETRIC LAYOUT - ILLINOIS ROUTE 59 AND GEOMETRIC LAYOUT - I-88 RAMP SHEETS.
- THE 6" SIDE CURB ADJACENT TO SIDEWALK RAMPS SHALL BE INCLUDED IN THE MEASURED AREA FOR PAYMENT FOR PORTLAND CEMENT CONCRETE SIDEWALK, 5". THE 6" SIDE CURB SHALL BE IN ACCORDANCE WITH IDOT HIGHWAY STANDARDS 424001 & 424006.
- FOR DETAILS SEE GEOMETRIC LAYOUT - ILLINOIS ROUTE 59 MEDIAN NOSE DETAIL SHEET.
- SEE SIDEWALK FENCE DETAIL.
- LIMITS OF SIDE CURB SHOWN ON THE PLANS ARE ESTIMATED. ACTUAL LIMITS SHALL BE DETERMINED BY THE ENGINEER IN THE FIELD. ANY ADDITIONAL LENGTH OF SIDE CURB SHALL BE INCLUDED IN THE MEASURED AREA FOR PAYMENT FOR PORTLAND CEMENT CONCRETE SIDEWALK, 5".

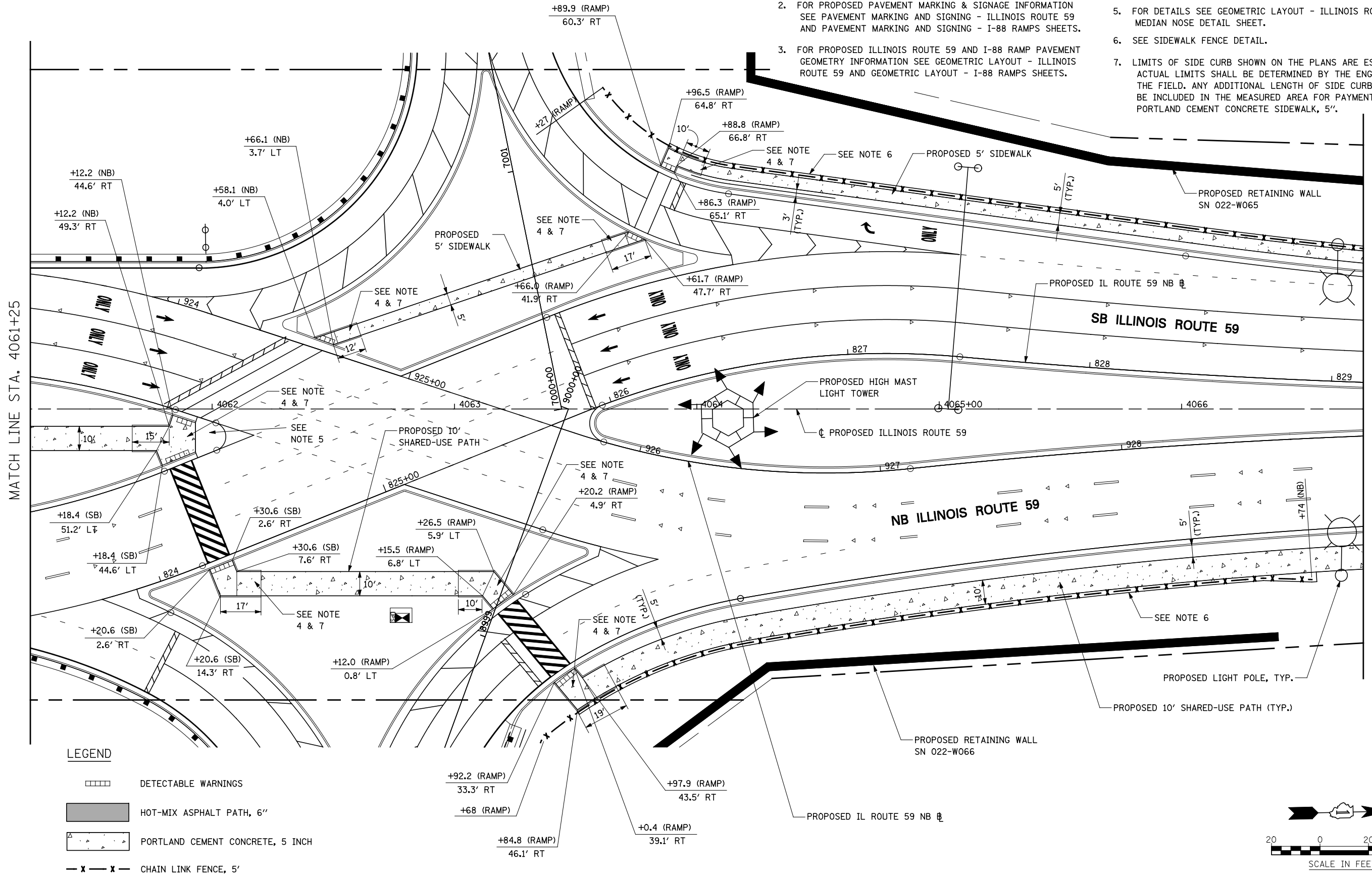

LEGEND

- DETECTABLE WARNINGS
- HOT-MIX ASPHALT PATH, 6"
- PORTLAND CEMENT CONCRETE, 5 INCH
- CHAIN LINK FENCE, 5'

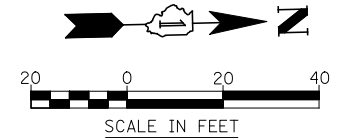

FILE NAME = #FILE#	USER NAME = #USER#	DESIGNED <i>PJO</i>	REVISED -	STATE OF ILLINOIS DEPARTMENT OF TRANSPORTATION	SIDEWALK / SHARED-USE PATH / FENCE PLANS			F.A.P. RTE.	SECTION	COUNTY	TOTAL SHEETS	SHEET NO.
		DRAWN <i>KES</i>	REVISED -		338	(112 & 113) WRS-5	DUPAGE	963	292			
		CHECKED <i>JCM</i>	REVISED -		CONTRACT NO. 60I31							
		DATE <i>10/15/2012</i>	REVISED -		ILLINOIS FED. AID PROJECT							
				SCALE: AS SHOWN	SHEET NO. 4 OF 8 SHEETS	STA. 4061+25 TO STA. 4066+75						