

WORK LIMIT
CONTRACT 60R31
STA. 4045+00 (IL59)

BEGIN WORK
CONTRACT 60I31
STA. 4045+00 (IL59) =
STA. 906+99.34 (IL59 NB) =
STA. 807+00.99 (IL59 SB)

PROPOSED CURVE NB-9
PI STA. = 912+35.24, 51.42' RT
 $\Delta = 1^\circ 19' 56.14''$ (LT)
D = $0^\circ 17' 10.71''$
R = 20,012'
T = 232.67'
L = 465.33'
E = 1.35'
P.C. STA. = 910+04.04, 48.00' RT
P.T. STA. = 914+57.50, 60.77' RT
SE = NORMAL CROWN

PROPOSED CURVE SB-9
PI STA. = 812+53.53, 43.38' LT
 $\Delta = 10^\circ 54' 26.70''$ (LT)
D = $4^\circ 07' 40.57''$
R = 1,388'
T = 132.52'
L = 264.23'
E = 6.31'
P.C. STA. = 811+17.88, 48.00' LT
P.T. STA. = 813+87.75, 54.83' LT
SE = NORMAL CROWN

PROPOSED CURVE SB-11
PI STA. = 809+68.25, 14.50' RT
 $\Delta = 3^\circ 46' 59.87''$ (LT)
D = $1^\circ 15' 23.91''$
R = 4,559.43'
T = 150.59'
L = 301.06'
E = 2.49'
P.C. STA. = 808+18.59, 24.00' RT
P.T. STA. = 811+17.91, 0.00' RT
SE = NORMAL CROWN

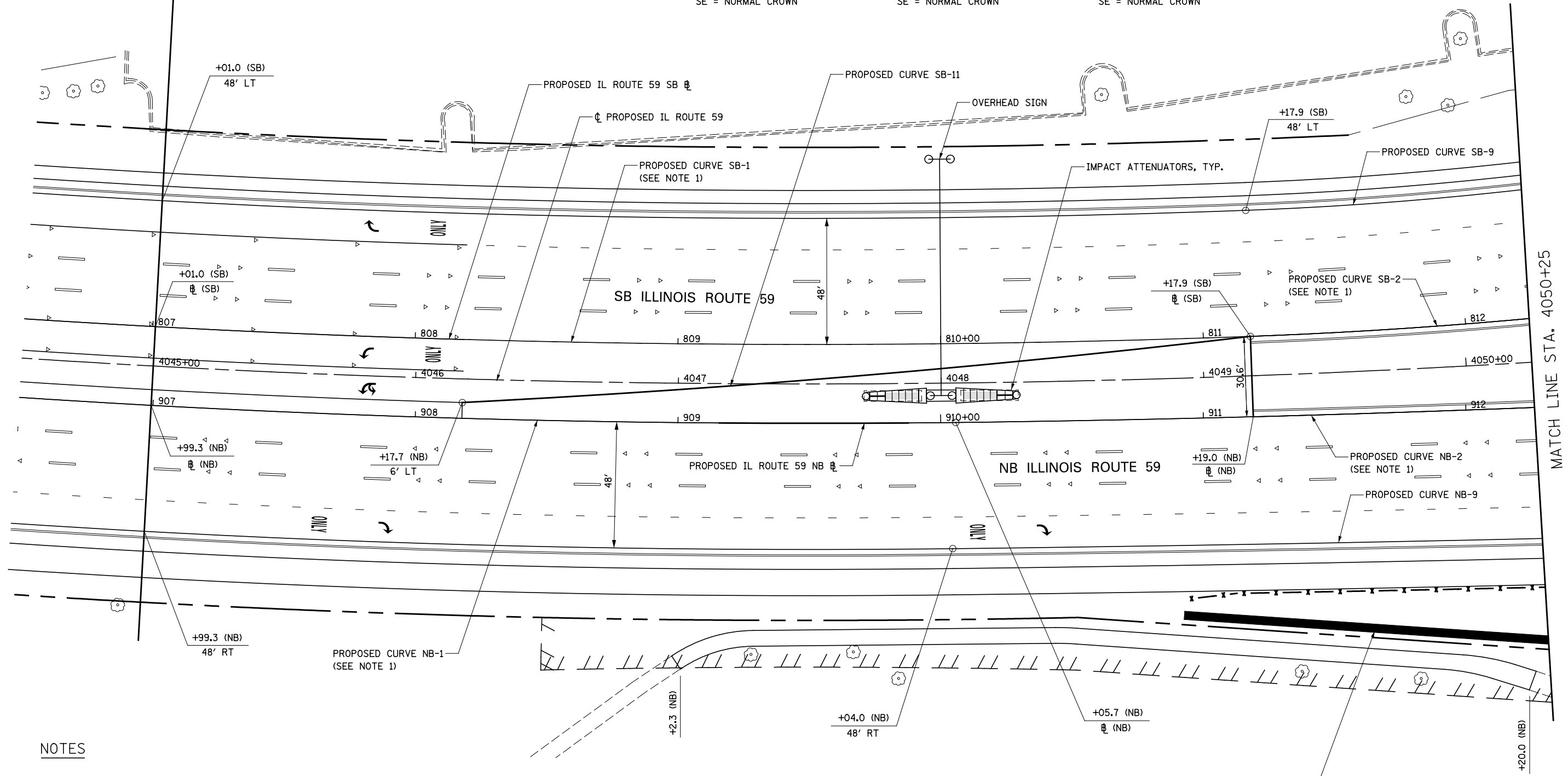

NOTES

- FOR PROPOSED ILLINOIS ROUTE 59 AND I-88 RAMP BASELINE INFORMATION SEE ALIGNMENT, BENCHMARKS, AND TIES - ILLINOIS ROUTE 59 NORTHBOUND & SOUTHBOUND BASELINE AND I-88 RAMP DATA SHEETS.
- FOR PROPOSED PAVEMENT, CURB & GUTTER, AND PROFILE INFORMATION SEE PLAN / PROFILE - ILLINOIS ROUTE 59 AND PLAN / PROFILE - I-88 RAMP SHEETS.
- FOR PROPOSED PAVEMENT MARKING & SIGNAGE INFORMATION SEE PAVEMENT MARKING AND SIGNING - ILLINOIS ROUTE 59 AND PAVEMENT MARKING AND SIGNING - I-88 RAMP SHEETS.
- FOR PROPOSED SIDEWALK AND SHARED-USE PATH INFORMATION SEE SIDEWALK / SHARED-USE PATH PLANS.

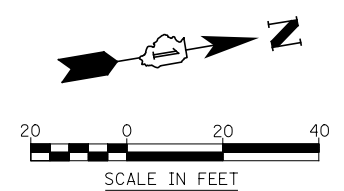

FILE NAME = *FILEL*	USER NAME = *USER*	DESIGNED <i>PJO</i>	REVISED -	STATE OF ILLINOIS DEPARTMENT OF TRANSPORTATION	GEOMETRIC LAYOUT - ILLINOIS ROUTE 59			F.A.P. RTE.	SECTION	COUNTY	TOTAL SHEETS	SHEET NO.		
		DRAWN <i>KES</i>	REVISED -		338	(112 & 113) WRS-5	DUPAGE	963	263	CONTRACT NO. 60I31				
		CHECKED <i>JCM</i>	REVISED -		SCALE: AS SHOWN			SHEET NO. 1 OF 21 SHEETS			STA. 4044+50 TO STA. 4050+25		ILLINOIS FED. AID PROJECT	
		DATE <i>10/15/2012</i>	REVISED -											