

INFORMATION SHOWN IS FOR SOUTHBOUND PROFILE
SEE NORTHBOUND PROFILE SHEETS FOR MORE INFORMATION

PLAN	SURVEYED	CHECKED	DATE
	PLOTTED	AT	
	NOTE BOOK	NO.	
	FILE NAME		

NOTES

- FOR PROPOSED ILLINOIS ROUTE 59 AND I-88 RAMP BASELINE INFORMATION SEE ALIGNMENT, BENCHMARKS AND TIES - ILLINOIS ROUTE 59 NORTHBOUND AND SOUTHBOUND BASELINE AND I-88 RAMP DATA SHEETS.
- FOR PROPOSED ILLINOIS ROUTE 59 AND I-88 RAMP PAVEMENT GEOMETRY INFORMATION SEE GEOMETRIC LAYOUT - ILLINOIS ROUTE 59 AND GEOMETRIC LAYOUT - I-88 RAMP SHEETS.
- FOR PROPOSED SIDEWALK, SHARED-USE PATH, AND FENCE INFORMATION SEE SIDEWALK / SHARED-USE PATH/ FENCE PLANS.
- FOR PROPOSED BRIDGE STRUCTURES, APPROACH PAVEMENTS, AND RETAINING WALLS SEE STRUCTURAL PLANS.
- FOR COMBINATION CURB AND GUTTER INFORMATION SEE GEOMETRIC LAYOUT - ILLINOIS ROUTE 59 CHANNELIZATION ISLAND DETAILS SHEET.
- FOR PROPOSED GRADING INFORMATION SEE PAVEMENT JOINTING AND ELEVATION PLANS.

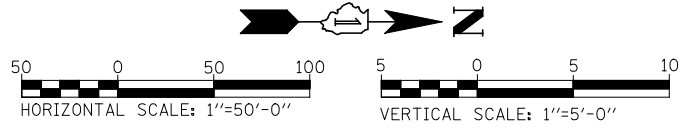
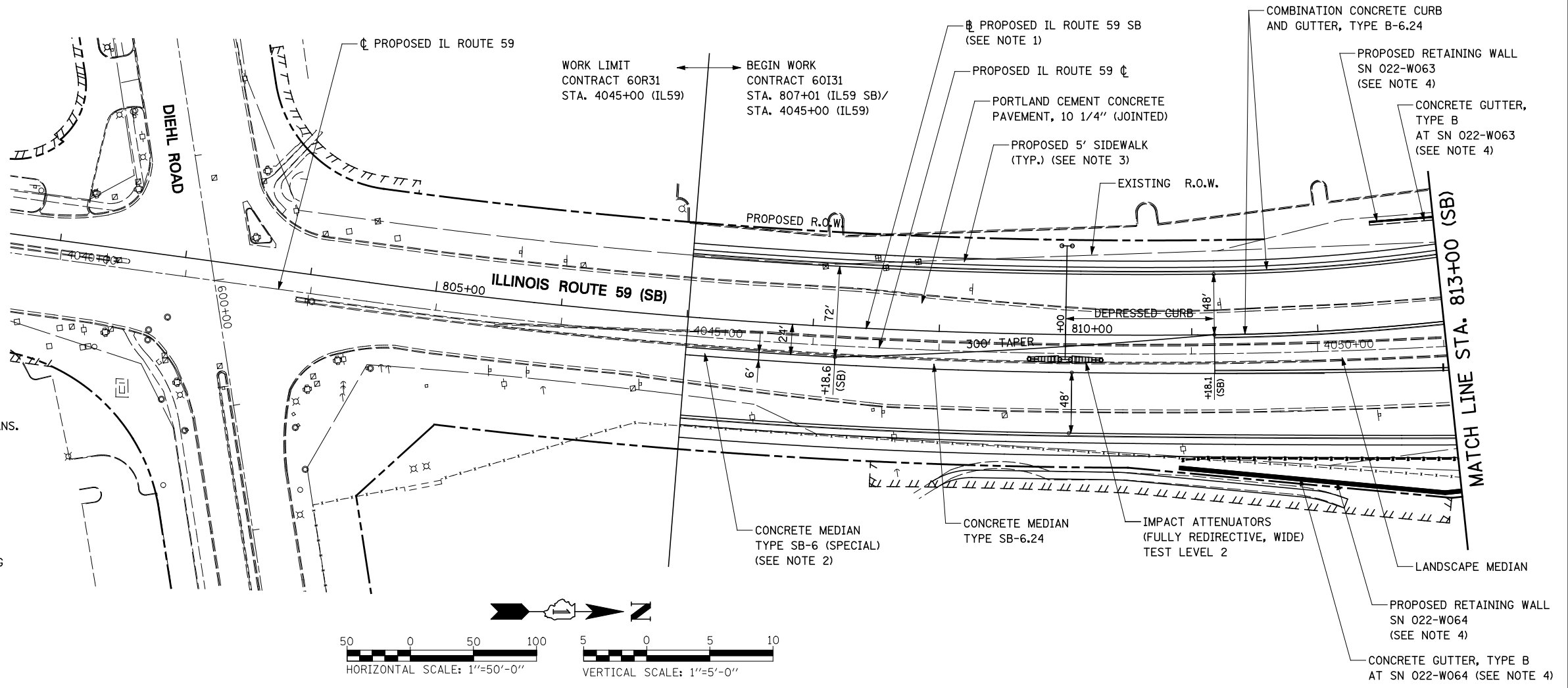

PROFILE	SURVEYED	CHECKED	DATE
	PLOTTED	AT	
	NOTE BOOK	NO.	
	FILE NAME		

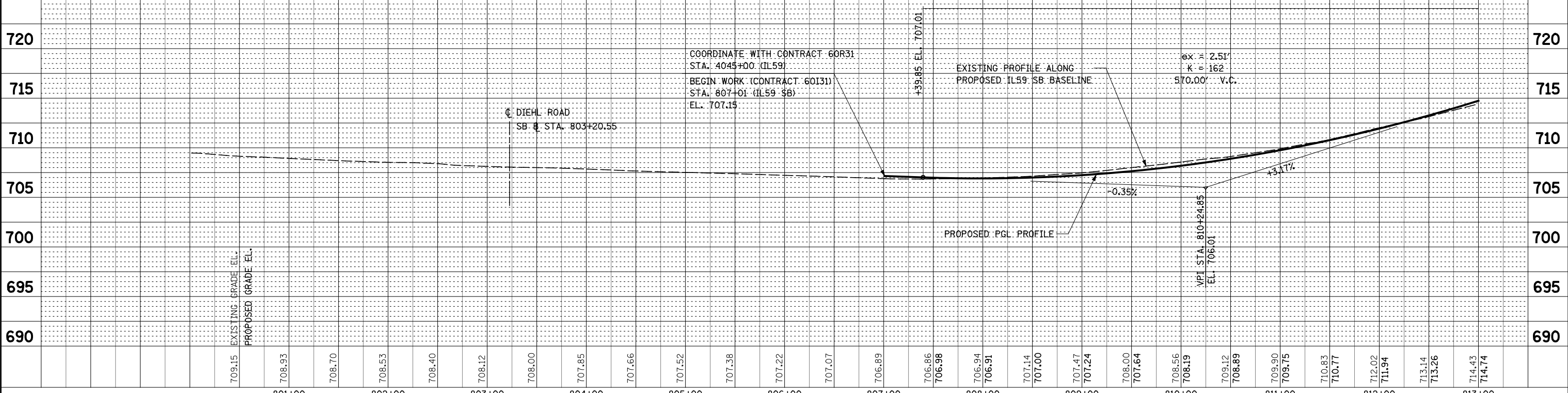

FILE NAME =	USER NAME = #USER#	DESIGNED <i>PJO</i>	REVISED -	STATE OF ILLINOIS DEPARTMENT OF TRANSPORTATION	PLAN AND PROFILE - ILLINOIS ROUTE 59 (SB)	F.A.P. RTE.	SECTION	COUNTY	TOTAL SHEETS	SHEET NO.	
*FILEL#		DRAWN <i>KES</i>	REVISED -			338	(112 & 113) WRS-5	DUPAGE	963	249	
		CHECKED <i>JCM</i>	REVISED -			CONTRACT NO. 60I31					
		DATE <i>10/15/2012</i>	REVISED -			ILLINOIS FED. AID PROJECT					