

MAINTAIN BLANK-OUT PANEL OVER "SOUTH ILLINOIS 59" FROM PREVIOUS STAGE

PERMANENT SIGN STRUCTURE INSTALLED IN A PREVIOUS STAGE

CONST-SPECIAL-4230 (BLACK 5" HWY D LETTERS ON REFLECTIVE ORANGE) SEE NOTE 2

CONST-SPECIAL-3630 (BLACK 5" HWY D LETTERS ON REFLECTIVE ORANGE) SEE NOTE 2

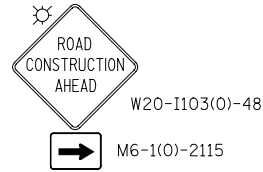

ALIGNMENT LEGEND
 +39.5 INDICATES STATION MEASURED FROM SB BASELINE
 +39.5 INDICATES STATION MEASURED FROM NB BASELINE

MAINTAIN BLANK-OUT PANEL WITH "KEEP LEFT" MESSAGE OVER UPWARD POINTING ARROW FROM PREVIOUS STAGE

PROPOSED SB BASELINE

PROPOSED R.O.W.

ILLINOIS ROUTE 59 (FOR INFORMATION ONLY)

EXISTING R.O.W.

ILLINOIS ROUTE 59

PROPOSED R.O.W.

EXISTING R.O.W.

MATCH LINE STA. 4065+00

MATCH LINE STA. 4079+00 (SEE STAGE 2)

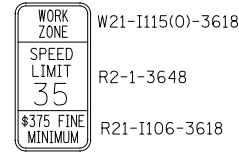
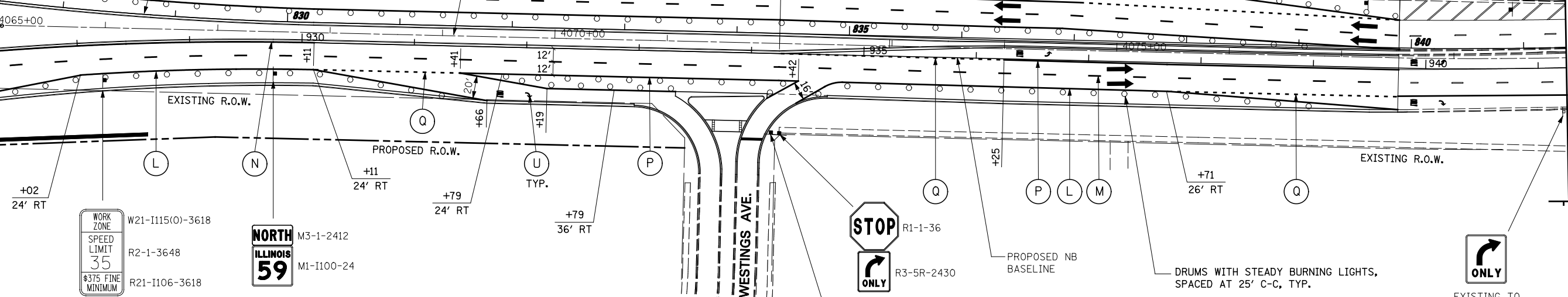

NOTES

- ALL BLANK OUT PANELS AND TEMPORARY SIGN PANELS MOUNTED ON OVERHEAD SIGNS SHALL HAVE AN ORANGE BACKGROUND.
- CONST-SPECIAL SIGNS TO BE MEASURED AND PAID FOR SEPARATELY UNDER TEMPORARY INFORMATION SIGNING. THESE SIGNS WILL NOT BE REMEASURED FOR PAYMENT IN SUBSEQUENT STAGES. THE RELOCATION OF THESE SIGNS SHALL BE INCLUDED IN THE COST FOR TEMPORARY INFORMATION SIGNING.

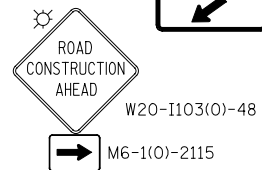

CONST-SPECIAL-4230 (BLACK 5" HWY D LETTERS ON REFLECTIVE ORANGE) SEE NOTE 2

CONST-SPECIAL-3630 (BLACK 5" HWY D LETTERS ON REFLECTIVE ORANGE) SEE NOTE 2

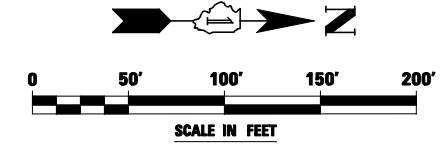

FILE NAME =	USER NAME = #USER#	DESIGNED <i>PJO</i>	REVISED -
#FILE#		DRAWN <i>KES</i>	REVISED -
		CHECKED <i>JCM</i>	REVISED -
		DATE <i>10/15/2012</i>	REVISED -

**STATE OF ILLINOIS
DEPARTMENT OF TRANSPORTATION**

**MAINTENANCE OF TRAFFIC - STAGE 4A
ILLINOIS ROUTE 59**

SCALE: SHEET NO. 113 OF 118 SHEETS STA. 4065+00 TO STA. 4079+00

F.A.P. RTE.	SECTION	COUNTY	TOTAL SHEETS	SHEET NO.
338	(112 & 113) WRS-5	DUPAGE	963	229
CONTRACT NO. 60131				
ILLINOIS FED. AID PROJECT				