

INSTALL BLANK-OUT PANEL OVER "SOUTH ILLINOIS 59" THIS STAGE

PERMANENT SIGN STRUCTURE INSTALLED IN PREVIOUS STAGE (SEE SIGN STRUCTURE DETAIL SHEET)

INSTALL BLANK-OUT PANEL WITH "KEEP LEFT" MESSAGE OVER UPWARD POINTING ARROW THIS STAGE

CONST-SPECIAL-4230 (BLACK 5" HWY D LETTERS ON REFLECTIVE ORANGE) SEE NOTE 2

CONST-SPECIAL-3630 (BLACK 5" HWY D LETTERS ON REFLECTIVE ORANGE) SEE NOTE 2

ROAD CONSTRUCTION AHEAD W20-1103(O)-48  
M6-1(O)-2115

CAUTION NEW LANES OPEN  
STOP AT LINE

STOP ONLY

STOP ONLY

CAUTION NEW LANES OPEN  
STOP AT LINE

CONST-SPECIAL-4230 (BLACK 5" HWY D LETTERS ON REFLECTIVE ORANGE) SEE NOTE 2

CONST-SPECIAL-3630 (BLACK 5" HWY D LETTERS ON REFLECTIVE ORANGE) SEE NOTE 2

M4-15-2412 TOLL TOLL M4-15-2412  
M3-2-2412 EAST WEST M3-4-2412  
M1-1-24 88 88 M1-1-24  
M5-KL-2418 KEEP LEFT KEEP RIGHT M5-KR-2418

JCT TOLL M2-1-2115  
M4-15-2412  
M1-1-36 M1-1-36

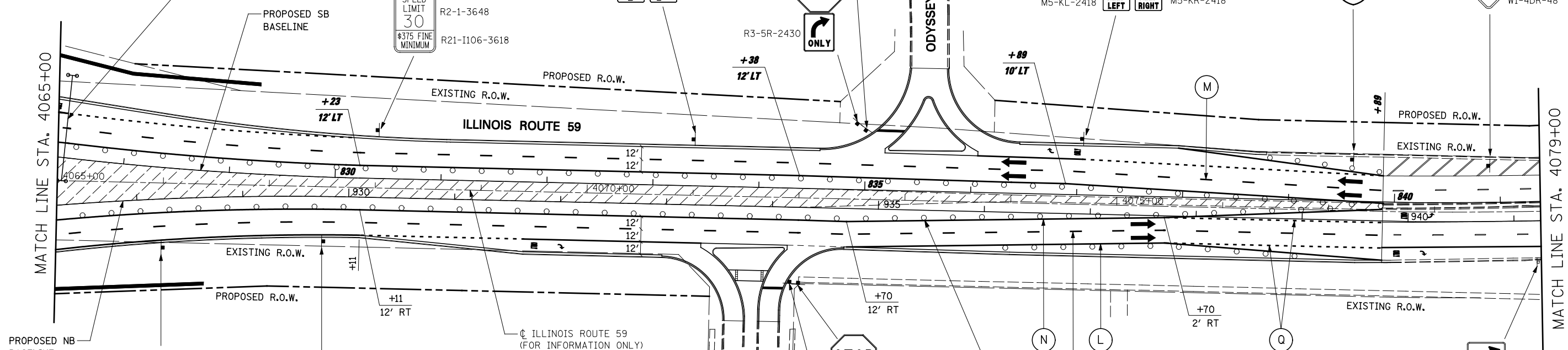

WORK ZONE W21-1115(O)-3618  
SPEED LIMIT 30 R2-1-3648  
\$375 FINE MINIMUM R21-1106-3618

WORK ZONE W21-1115(O)-3618  
SPEED LIMIT 35 R2-1-3648  
\$375 FINE MINIMUM R21-1106-3618

NORTH ILLINOIS 59 M3-1-2412  
M1-100-24

**ALIGNMENT LEGEND**

+39.5 INDICATES STATION MEASURED FROM SB BASELINE

+39.5 INDICATES STATION MEASURED FROM NB BASELINE

**NOTES**

- ALL BLANK OUT PANELS AND TEMPORARY SIGN PANELS MOUNTED ON OVERHEAD SIGNS SHALL HAVE AN ORANGE BACKGROUND.
- CONST-SPECIAL SIGNS TO BE MEASURED AND PAID FOR SEPARATELY UNDER TEMPORARY INFORMATION SIGNING. THESE SIGNS WILL NOT BE REMEASURED FOR PAYMENT IN SUBSEQUENT STAGES. THE RELOCATION OF THESE SIGNS SHALL BE INCLUDED IN THE COST FOR TEMPORARY INFORMATION SIGNING.

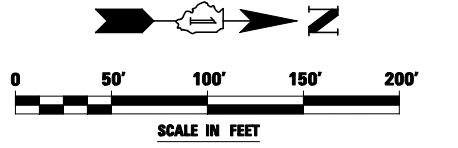

FILE NAME =	USER NAME = #USER*	DESIGNED PJO	REVISED -	<b>STATE OF ILLINOIS DEPARTMENT OF TRANSPORTATION</b>	<b>MAINTENANCE OF TRAFFIC - STAGE 4 ILLINOIS ROUTE 59</b>	F.A.P. RTE.	SECTION	COUNTY	TOTAL SHEETS	SHEET NO.	
#FILE#		DRAWN KES	REVISED -			338	(112 & 113) WRS-5	DUPAGE	963	222	
PLOT SCALE = #SCALE#		CHECKED JCM	REVISED -			CONTRACT NO. 60131					
PLOT DATE = #DATE#		DATE 10/15/2012	REVISED -			ILLINOIS FED. AID PROJECT					
					SCALE:	SHEET NO. 106 OF 118 SHEETS		STA. 4065+00 TO STA. 4079+00			