

DRUMS WITH STEADY BURNING LIGHTS SPACED AT 25' C-C

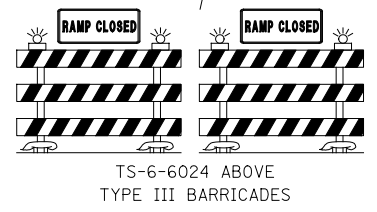

TOLLWAY TRAFFIC CONTROL

TRAFFIC CONTROL ON INTERSTATE 88 AND AT RAMP TERMINALS SHALL BE IN ACCORDANCE WITH THE FOLLOWING ILLINOIS TOLLWAY STANDARDS:

- E1 CONSTRUCTION SIGNS
- E2 LANE CLOSURE DETAILS
- E3 SHOULDER CLOSURE DETAILS
- E4 MAINTENANCE OF TRAFFIC REVERSE CURVE
- E5 TEMPORARY GORE DETAILS

FILE NAME =	USER NAME = \$USER*	DESIGNED <i>PJO</i>	REVISED -
\$FILEL\$		DRAWN <i>KES</i>	REVISED -
	PLOT SCALE = \$SCALE*	CHECKED <i>JCM</i>	REVISED -
	PLOT DATE = \$DATE*	DATE <i>10/15/2012</i>	REVISED -

**STATE OF ILLINOIS
DEPARTMENT OF TRANSPORTATION**

**MAINTENANCE OF TRAFFIC - STAGE 3C
RAMP D / INTERSTATE 88**

SCALE: SHEET NO. 98 OF 118 SHEETS STA. 6510+00 TO STA. 1995+50

F.A.P. RTE.	SECTION	COUNTY	TOTAL SHEETS	SHEET NO.
338	(112 & 113) WRS-5	DUPAGE	963	214
CONTRACT NO. 60I31				
ILLINOIS FED. AID PROJECT				