

ADVANCE WARNING SIGN SEQUENCE DETAIL
WESTBOUND

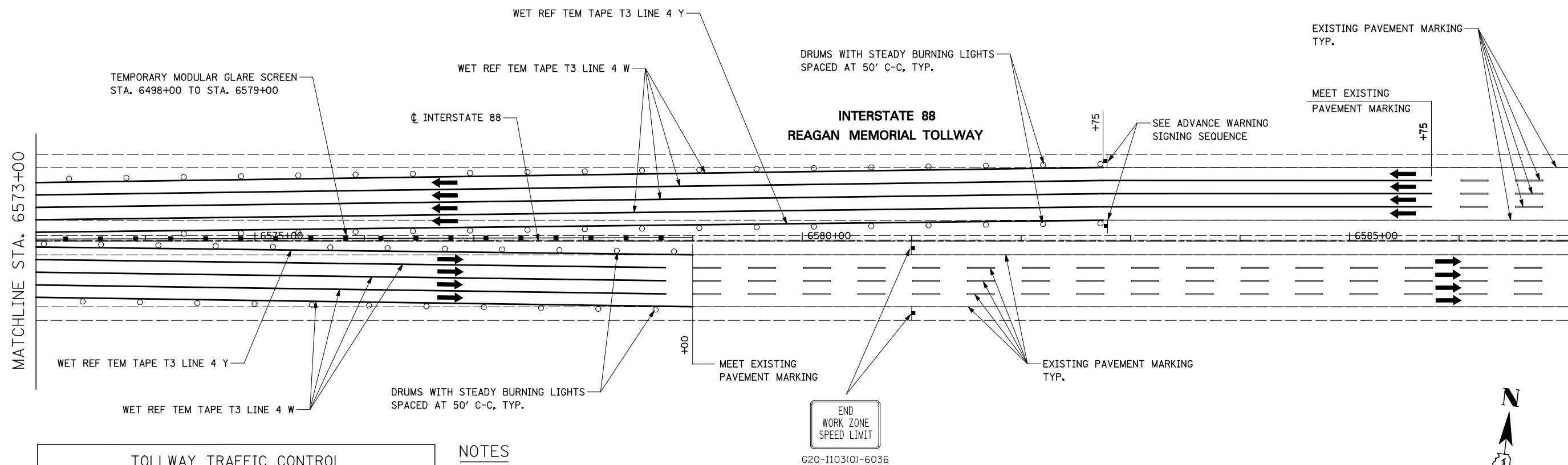

TOLLWAY TRAFFIC CONTROL

TRAFFIC CONTROL ON INTERSTATE 88 AND AT RAMP TERMINALS SHALL BE IN ACCORDANCE WITH THE FOLLOWING ILLINOIS TOLLWAY STANDARDS:

E1-02 CONSTRUCTION SIGNS
E2-02 LANE CLOSURE DETAILS
E3-02 SHOULDER CLOSURE DETAILS
E4-01 MAINTENANCE OF TRAFFIC REVERSE CURVE
E5-01 TEMPORARY GORE DETAILS

NOTES

1. LOCATION OF TRAILER MOUNTED FULL MATRIX PORTABLE CHANGEABLE MESSAGE SIGN SHALL BE COORDINATED WITH THE ENGINEER AND THE ILLINOIS TOLLWAY. MESSAGE TO BE DISPLAYED WILL BE REMOTELY CONTROLLED BY THE ILLINOIS TOLLWAY TRAFFIC MANAGEMENT CENTER.
2. THE TRAILER MOUNTED FULL MATRIX PORTABLE CHANGEABLE MESSAGE SIGN SHALL REMAIN IN PLACE FOR THE ENTIRE DURATION OF THE CONTRACT. NO ADDITIONAL COMPENSATION WILL BE ALLOWED FOR DELAYS EXTENDING THE CONTRACT BEYOND COMPLETION DATE AS SHOWN IN THE SPECIAL PROVISIONS.

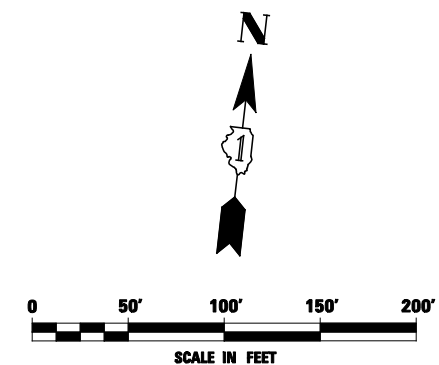

FILE NAME = #FILE#	USER NAME = #USER#	DESIGNED <i>PJO</i>	REVISED -	STATE OF ILLINOIS DEPARTMENT OF TRANSPORTATION	MAINTENANCE OF TRAFFIC - STAGE 1 INTERSTATE 88	F.A.P. RTE.	SECTION	COUNTY	TOTAL SHEETS	SHEET NO.	
		DRAWN <i>KES</i>	REVISED -			338	(112 & 113) WRS-5	DUPAGE	963	135	
		CHECKED <i>JCM</i>	REVISED -			CONTRACT NO. 60I31					
		DATE <i>10/15/2012</i>	REVISED -			ILLINOIS FED. AID PROJECT					
					SCALE:	SHEET NO. 19 OF 118 SHEETS		STA. 6573+00 TO STA. 6587+00			