

FOR TEMPORARY PAVEMENT CONSTRUCTION
USE HIGHWAY STANDARDS NO. 701456, 701606, 701701

FOR STORM SEWER AND WATER MAIN CONSTRUCTION
USE HIGHWAY STANDARDS NO. 701101 & 701106

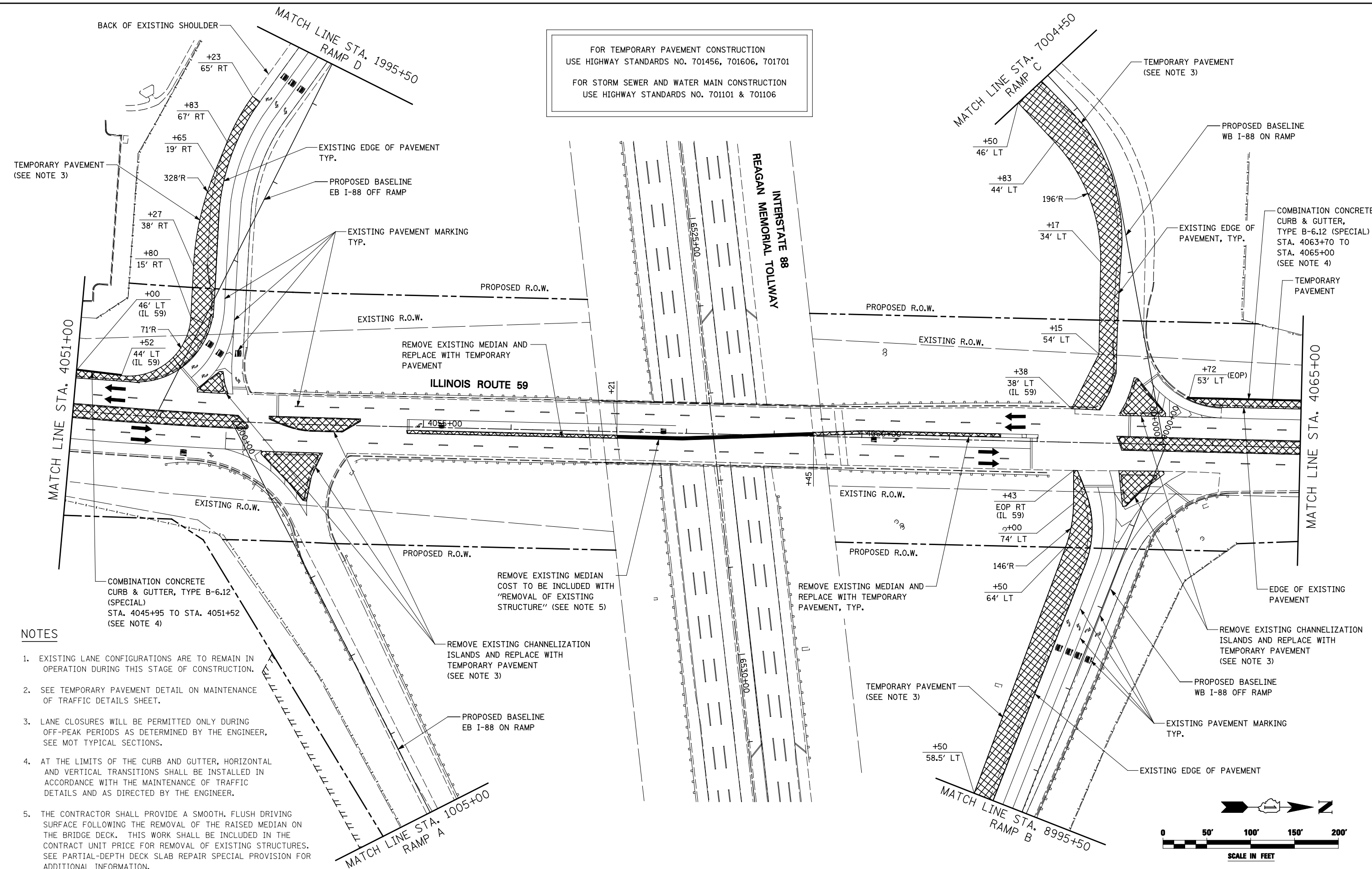

NOTES

- EXISTING LANE CONFIGURATIONS ARE TO REMAIN IN OPERATION DURING THIS STAGE OF CONSTRUCTION.
- SEE TEMPORARY PAVEMENT DETAIL ON MAINTENANCE OF TRAFFIC DETAILS SHEET.
- LANE CLOSURES WILL BE PERMITTED ONLY DURING OFF-PEAK PERIODS AS DETERMINED BY THE ENGINEER, SEE MOT TYPICAL SECTIONS.
- AT THE LIMITS OF THE CURB AND GUTTER, HORIZONTAL AND VERTICAL TRANSITIONS SHALL BE INSTALLED IN ACCORDANCE WITH THE MAINTENANCE OF TRAFFIC DETAILS AND AS DIRECTED BY THE ENGINEER.
- THE CONTRACTOR SHALL PROVIDE A SMOOTH, FLUSH DRIVING SURFACE FOLLOWING THE REMOVAL OF THE RAISED MEDIAN ON THE BRIDGE DECK. THIS WORK SHALL BE INCLUDED IN THE CONTRACT UNIT PRICE FOR REMOVAL OF EXISTING STRUCTURES. SEE PARTIAL-DEPTH DECK SLAB REPAIR SPECIAL PROVISION FOR ADDITIONAL INFORMATION.

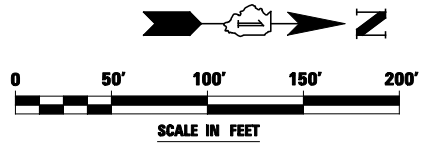

FILE NAME =	USER NAME = #USER#	DESIGNED <i>PJO</i>	REVISED -
#FILEL#		DRAWN <i>KES</i>	REVISED -
	PLOT SCALE = #SCALE#	CHECKED <i>JCM</i>	REVISED -
	PLOT DATE = #DATE#	DATE <i>10/15/2012</i>	REVISED -

**STATE OF ILLINOIS
DEPARTMENT OF TRANSPORTATION**

MAINTENANCE OF TRAFFIC - PRE-STAGE 1	
ILLINOIS ROUTE 59	
SCALE:	SHEET NO. 2 OF 118 SHEETS STA. 4051+00 TO STA. 4065+00

F.A.P. RTE.	SECTION	COUNTY	TOTAL SHEETS	SHEET NO.
338	(112 & 113) WRS-5	DUPAGE	963	118
CONTRACT NO. 60131				
ILLINOIS FED. AID PROJECT				