

ALIGNMENT DATA

1400	N 871690.41 E 19640.74
1401	N 871640.01 E 19361.30
1402	N 871582.12 E 19245.54
1403	N 871413.32 E 19063.94
1404	N 871115.44 E 18430.90
1405	N 870972.56 E 17344.22

PROPOSED CURVE
RAMP C-1
PI STA. = 7003+51.38
 $\Delta = 32^\circ 40' 58''$ (LT)
D = 24° 54' 40"
R = 230.00'
T = 67.44'
L = 131.20'
E = 9.68'
P.C. STA. = 7002+83.95
P.T. STA. = 7004+15.14
SE = 7.1%

PROPOSED CURVE
RAMP C-2
PI STA. = 7010+30.29
 $\Delta = 35^\circ 25' 05''$ (RT)
D = 4° 58' 56"
R = 1,150.00'
T = 367.21'
L = 710.88'
E = 57.20'
P.C. STA. = 7006+63.08
P.T. STA. = 7013+73.97
SE = 8.0%

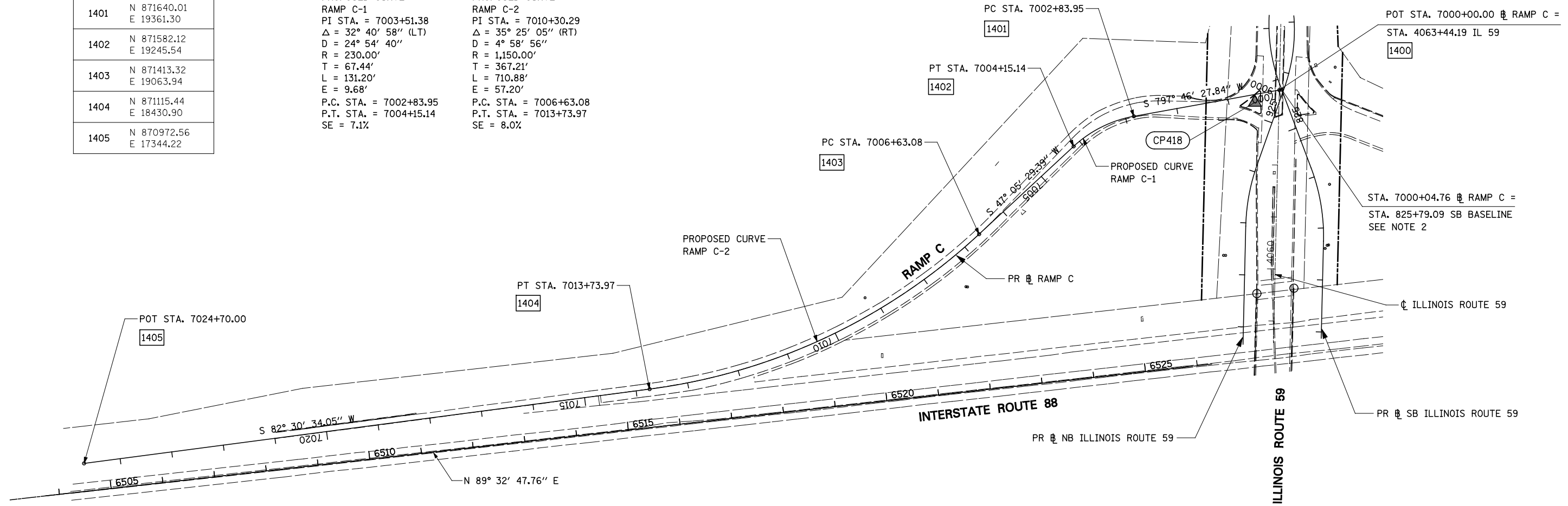

NOTE:

1. PLAT OF HIGHWAYS STATION EQUATION NOT APPLICABLE TO RAMP A. ALIGNMENT WAS CHANGED TO ACCOMODATE DDI DESIGN.
2. PLAT OF HIGHWAYS STATION EQUATION NOT APPLICABLE TO RAMP B, C, D, & FERRY RD.

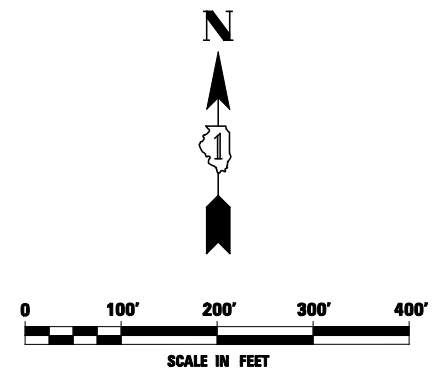

FILE NAME =	USER NAME = #USER#	DESIGNED <i>PJO</i>	REVISED -
#FILE#		DRAWN <i>KES</i>	REVISED -
	PLOT SCALE = #SCALE#	CHECKED <i>JCM</i>	REVISED -
	PLOT DATE = #DATE#	DATE <i>10/15/2012</i>	REVISED -

STATE OF ILLINOIS
DEPARTMENT OF TRANSPORTATION

ALIGNMENT, BENCHMARKS, AND TIES
RAMP C BASELINE DATA

SCALE: SHEET NO. 6 OF 9 SHEETS STA. 7024+70 TO STA. 7000+04.76

F.A.P. RTE.	SECTION	COUNTY	TOTAL SHEETS	SHEET NO.
338	(112 & 113) WRS-5	DUPAGE	963	82
CONTRACT NO. 60I31				
ILLINOIS FED. AID PROJECT				