

ALIGNMENT DATA

1200	N 870627.93 E 19614.42	1204	N 871207.48 E 20857.92
1201	N 870878.26 E 20107.65	1205	N 871409.57 E 22372.64
1202	N 871053.71 E 20448.71	1206	N 871516.37 E 23316.86
1203	N 871123.80 E 20586.84	1207	N 871564.47 E 23613.33

PROPOSED CURVE  
RAMP A-1  
PI STA. = 1012+35.41  
 $\Delta = 19^\circ 06' 41''$  (RT)  
D =  $6^\circ 42' 19''$   
R = 854.50'  
T = 143.85'  
L = 285.02'  
E = 12.02'  
P.C. STA. = 1010+91.56  
P.T. STA. = 1013+76.58  
SE = 8.0%

POT STA. 1000+00.00  
RAMP A =  
STA. 4052+81.36 IL 59  
1200

STA. 1000+17.17 RAMP A =  
STA. 914+92.71 NB BASELINE  
SEE NOTE 1

- NOTE:
1. PLAT OF HIGHWAYS STATION EQUATION NOT APPLICABLE TO RAMP A. ALIGNMENT WAS CHANGED TO ACCOMMODATE DDI DESIGN.
  2. PLAT OF HIGHWAYS STATION EQUATION NOT APPLICABLE TO RAMP B, C, D, & FERRY RD.

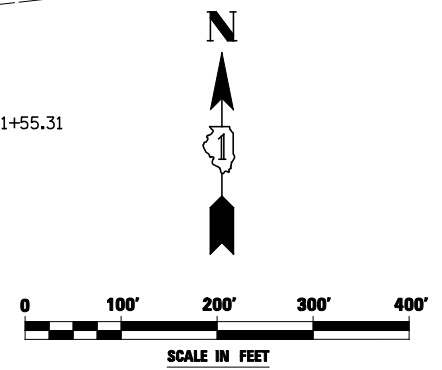

FILE NAME =	USER NAME = #USER#	DESIGNED PJO	REVISED -
#FILEL#		DRAWN KES	REVISED -
		CHECKED JCM	REVISED -
		DATE 10/15/2012	REVISED -

STATE OF ILLINOIS  
DEPARTMENT OF TRANSPORTATION

ALIGNMENT, BENCHMARKS, AND TIES  
RAMP A BASELINE DATA

SCALE: SHEET NO. 4 OF 9 SHEETS STA. 1000+00 TO STA. 1041+55.31

F.A.P. RTE.	SECTION	COUNTY	TOTAL SHEETS	SHEET NO.
338	(112 & 113) WRS-5	DUPAGE	963	80
CONTRACT NO. 60I31				
ILLINOIS FED. AID PROJECT				