

PT STA. 4037+97.72
119

CP436

FOR RAMPS BASELINE INFORMATION SEE
ALIGNMENT, BENCHMARKS, AND TIES
RAMPS BASELINE DATA SHEETS

FOR NB AND SB BASELINE INFORMATION SEE
ALIGNMENT, BENCHMARKS, AND TIES ILLINOIS ROUTE 59
NORTHBOUND AND SOUTHBOUND BASELINE DATA SHEETS

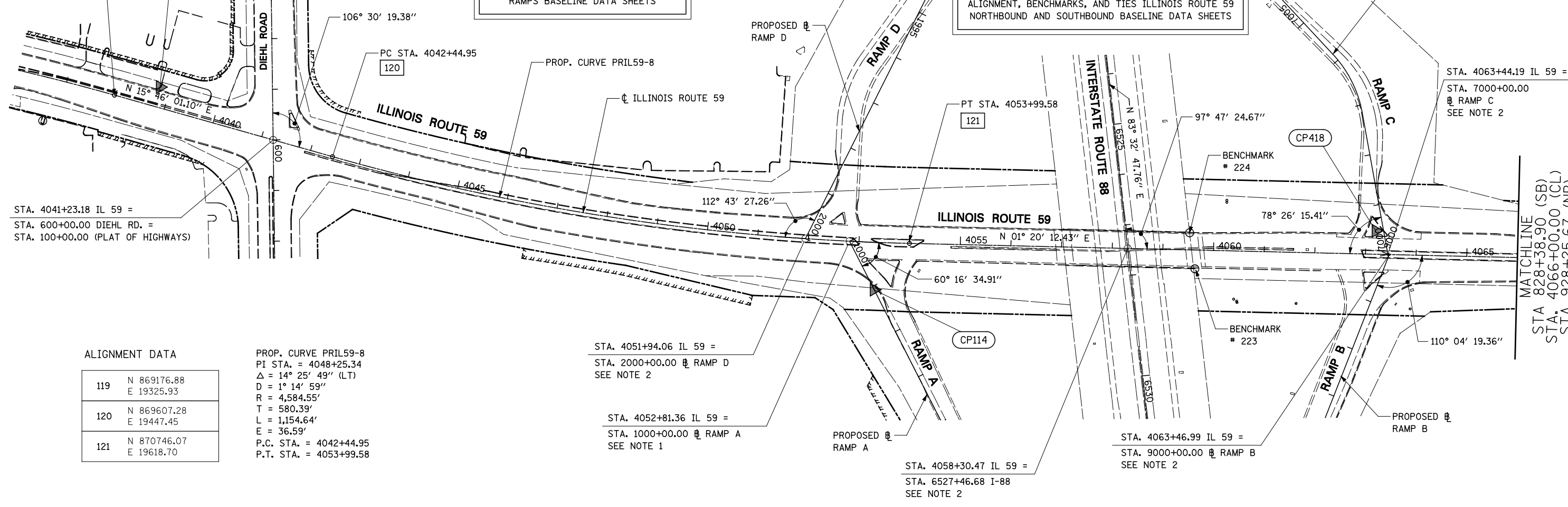

STA. 4041+23.18 IL 59 =
STA. 600+00.00 DIEHL RD. =
STA. 100+00.00 (PLAT OF HIGHWAYS)

ALIGNMENT DATA

| | |
|-----|---------------------------|
| 119 | N 869176.88 E 19325.93 |
| 120 | N 869607.28 E 19447.45 |
| 121 | N 870746.07 E 19618.70 |

PROP. CURVE PRIL59-8
PI STA. = 4048+25.34
 $\Delta = 14^\circ 25' 49''$ (LT)
D = 1° 14' 59"
R = 4,584.55'
T = 580.39'
L = 1,154.64'
E = 36.59'
P.C. STA. = 4042+44.95
P.T. STA. = 4053+99.58

STA. 4051+94.06 IL 59 =
STA. 2000+00.00 RAMP D
SEE NOTE 2

STA. 4052+81.36 IL 59 =
STA. 1000+00.00 RAMP A
SEE NOTE 1

STA. 4058+30.47 IL 59 =
STA. 6527+46.68 I-88
SEE NOTE 2

STA. 4063+46.99 IL 59 =
STA. 9000+00.00 RAMP B
SEE NOTE 2

STA. 4063+44.19 IL 59 =
STA. 7000+00.00
RAMP C
SEE NOTE 2

MATCHLINE
STA 828+38.90 (SB)
STA. 4066+00.00 (CL)
STA 928+25.67 (NB)

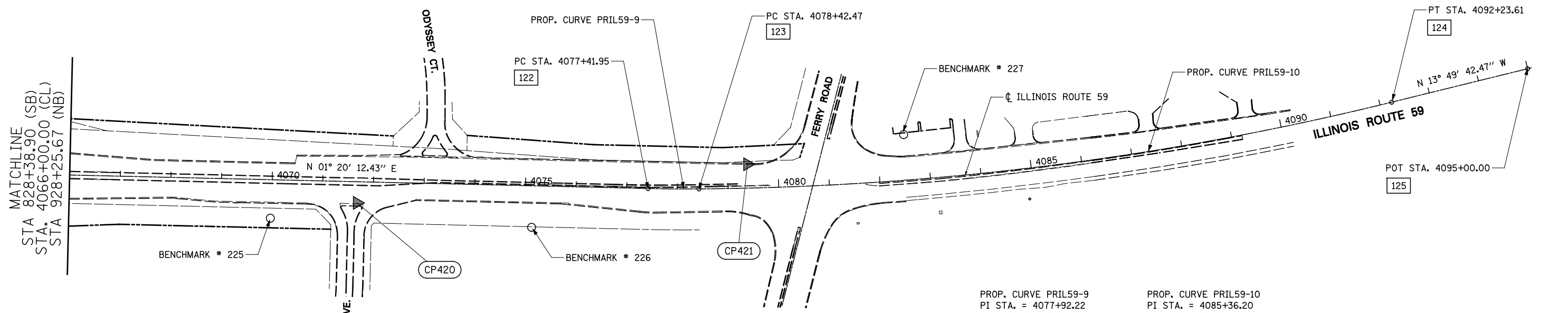

NOTE:

1. PLAT OF HIGHWAYS STATION EQUATION NOT APPLICABLE TO RAMP A. ALIGNMENT WAS CHANGED TO ACCOMODATE DDI DESIGN.
2. PLAT OF HIGHWAYS STATION EQUATION NOT APPLICABLE TO RAMP B, C, D, & FERRY RD.

ALIGNMENT DATA

| | | | |
|-----|---------------------------|-----|---------------------------|
| 122 | N 873087.80 E 19673.34 | 124 | N 874555.65 E 19503.02 |
| 123 | N 873188.31 E 19674.13 | 125 | N 874824.02 E 19436.96 |

PROP. CURVE PRIL59-9
PI STA. = 4077+92.22
 $\Delta = 1^\circ 46' 28''$ (LT)
D = 1° 45' 55"
R = 3,245.62'
T = 50.26'
L = 100.52'
E = 0.39'
P.C. STA. = 4077+41.95
P.C.C. STA. = 4078+42.47

PROP. CURVE PRIL59-10
PI STA. = 4085+36.20
 $\Delta = 13^\circ 23' 27''$ (LT)
D = 0° 58' 10"
R = 5,909.58'
T = 693.73'
L = 1,381.14'
E = 40.58'
P.C.C. STA. = 4078+42.47
P.T. STA. = 4092+23.61

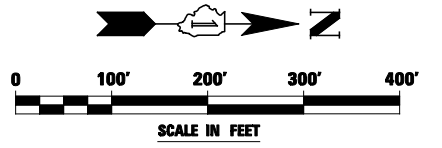

| | | | |
|-------------|--------------------|------------------------|-----------|
| FILE NAME = | USER NAME = *USER* | DESIGNED <i>PJO</i> | REVISED - |
| *FILE# | | DRAWN <i>KES</i> | REVISED - |
| | | CHECKED <i>JCM</i> | REVISED - |
| | | DATE <i>10/15/2012</i> | REVISED - |

STATE OF ILLINOIS
DEPARTMENT OF TRANSPORTATION

ALIGNMENT, BENCHMARKS, AND TIES
ILLINOIS ROUTE 59 CENTERLINE DATA

SCALE: SHEET NO. 1 OF 9 SHEETS STA. 4036+00 TO STA. 4095+00

| F.A.P. RTE. | SECTION | COUNTY | TOTAL SHEETS | SHEET NO. |
|---------------------------|-------------------|--------|--------------|-----------|
| 338 | (112 & 113) WRS-5 | DUPAGE | 963 | 77 |
| CONTRACT NO. 60I31 | | | | |
| ILLINOIS FED. AID PROJECT | | | | |