

198 STA. 231+21, 3' LT.
CB TO BE FILLED

CONTRACT NO. 83980			
F.A.U. RTE.	SECTION	COUNTY	TOTAL SHEET NO.
1338	05-00083-00-FF	COOK	167
STA. 227+50	TO STA. 232+21		
FED. ROAD DIST. NO. 7 ILLINOIS		FED. AID PROJECT M-8003(5)2	



IMPROVEMENT ENDS
STA. 232+21

MATCH LINE STA. 227+50
(SEE SHEET NO. 62)

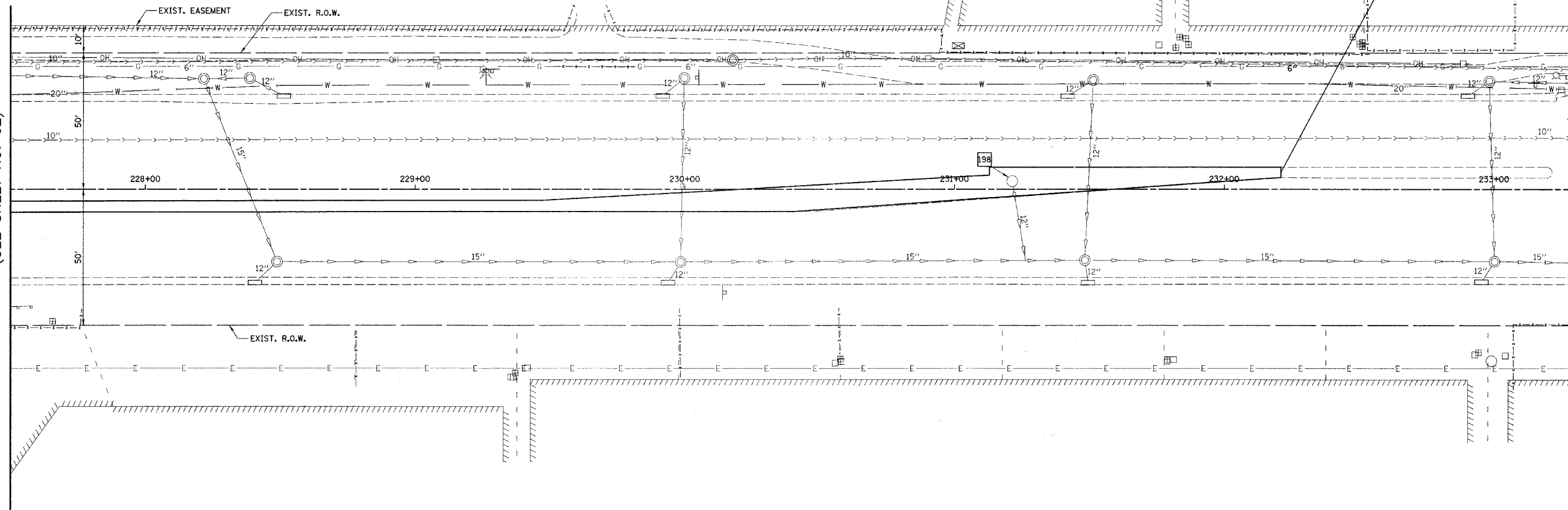

PLUM GROVE ROAD

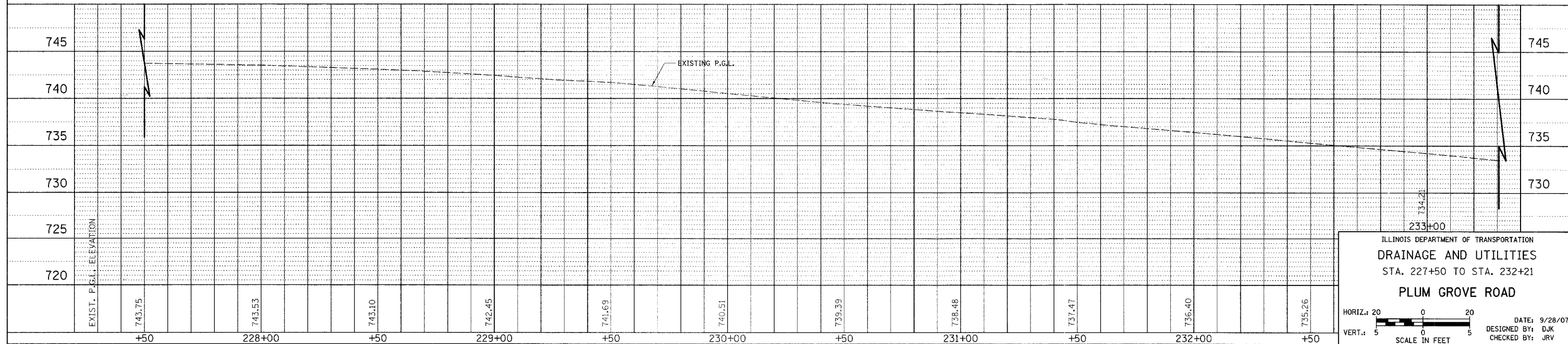

ILLINOIS DEPARTMENT OF TRANSPORTATION
DRAINAGE AND UTILITIES
STA. 227+50 TO STA. 232+21
PLUM GROVE ROAD

HORIZ.: 20
VERT.: 5
SCALE IN FEET

DATE: 9/28/07
DESIGNED BY: DJK
CHECKED BY: JRV