

F.A.U. RTE.	SECTION	COUNTY	TOTAL SHEETS	SHEET NO.
1338	05-00083-00-FF	COOK	167	60
STA. 52+00		TO STA. 57+50		
FED. ROAD DIST. NO. 7		ILLINOIS		FED. AID PROJECT M-8003(512)

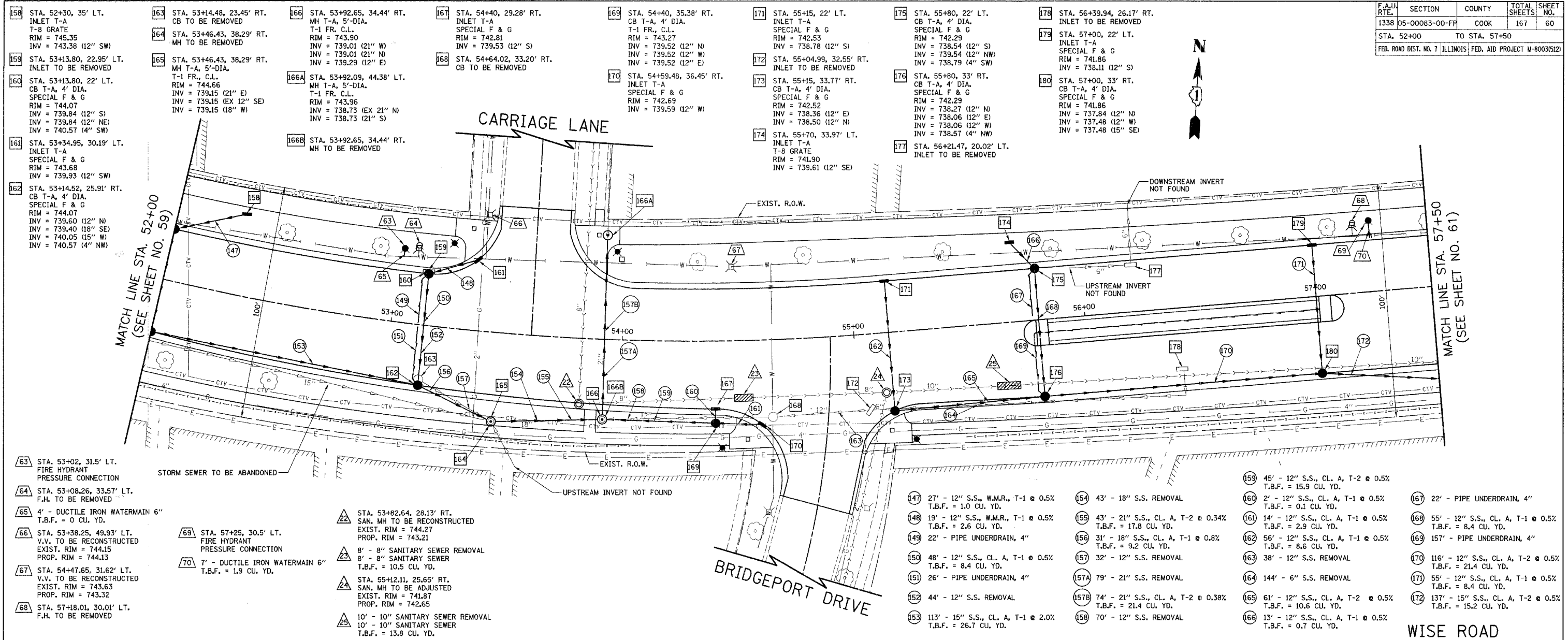

- 158 STA. 52+30, 35' LT. INLET T-A T-8 GRATE RIM = 745.35 INV = 743.38 (12" SW)
- 159 STA. 53+13.80, 22.95' LT. INLET TO BE REMOVED
- 160 STA. 53+13.80, 22' LT. CB T-A, 4' DIA. SPECIAL F & G RIM = 744.07 INV = 739.84 (12" S) INV = 739.84 (12" NE) INV = 740.57 (4" SW)
- 161 STA. 53+34.95, 30.19' LT. INLET T-A SPECIAL F & G RIM = 743.68 INV = 739.93 (12" SW)
- 162 STA. 53+14.52, 25.91' RT. CB T-A, 4' DIA. SPECIAL F & G RIM = 744.07 INV = 739.60 (12" N) INV = 739.40 (18" SE) INV = 740.05 (15" W) INV = 740.57 (4" NW)
- 163 STA. 53+14.48, 23.45' RT. CB TO BE REMOVED
- 164 STA. 53+46.43, 38.29' RT. MH TO BE REMOVED
- 165 STA. 53+46.43, 38.29' RT. MH T-A, 5'-DIA. T-1 FR., C.L. RIM = 744.66 INV = 739.15 (21" E) INV = 739.15 (EX 12" SE) INV = 739.15 (18" W)
- 166 STA. 53+92.65, 34.44' RT. MH T-A, 5'-DIA. T-1 FR., C.L. RIM = 743.90 INV = 739.01 (21" W) INV = 739.01 (21" N) INV = 739.29 (12" E)
- 166A STA. 53+92.09, 44.38' LT. MH T-A, 5'-DIA. T-1 FR., C.L. RIM = 743.96 INV = 738.73 (EX 21" N) INV = 738.73 (21" S)
- 166B STA. 53+92.65, 34.44' RT. MH TO BE REMOVED
- 167 STA. 54+40, 29.28' RT. INLET T-A SPECIAL F & G RIM = 742.81 INV = 739.53 (12" S)
- 168 STA. 54+64.02, 33.20' RT. CB TO BE REMOVED
- 169 STA. 54+40, 35.38' RT. CB T-A, 4' DIA. T-1 FR., C.L. RIM = 743.27 INV = 739.52 (12" N) INV = 739.52 (12" W) INV = 739.52 (12" E)
- 170 STA. 54+59.48, 36.45' RT. INLET T-A SPECIAL F & G RIM = 742.69 INV = 739.59 (12" W)
- 171 STA. 55+15, 22' LT. INLET T-A SPECIAL F & G RIM = 742.53 INV = 738.78 (12" S)
- 172 STA. 55+04.99, 32.55' RT. INLET TO BE REMOVED
- 173 STA. 55+15, 33.77' RT. CB T-A, 4' DIA. SPECIAL F & G RIM = 742.52 INV = 738.36 (12" E) INV = 738.50 (12" N)
- 174 STA. 55+70, 33.97' LT. INLET T-A T-8 GRATE RIM = 741.90 INV = 739.61 (12" SE)
- 175 STA. 55+80, 22' LT. CB T-A, 4' DIA. SPECIAL F & G RIM = 742.29 INV = 738.54 (12" S) INV = 739.54 (12" NW) INV = 738.79 (4" SW)
- 176 STA. 55+80, 33' RT. CB T-A, 4' DIA. SPECIAL F & G RIM = 742.29 INV = 738.27 (12" N) INV = 738.06 (12" E) INV = 738.06 (12" W) INV = 738.57 (4" NW)
- 177 STA. 56+21.47, 20.02' LT. INLET TO BE REMOVED
- 178 STA. 56+39.94, 26.17' RT. INLET TO BE REMOVED
- 179 STA. 57+00, 22' LT. INLET T-A SPECIAL F & G RIM = 741.86 INV = 738.11 (12" S)
- 180 STA. 57+00, 33' RT. CB T-A, 4' DIA. SPECIAL F & G RIM = 741.86 INV = 737.84 (12" N) INV = 737.48 (12" W) INV = 737.48 (15" SE)
- 63 STA. 53+02, 31.5' LT. FIRE HYDRANT PRESSURE CONNECTION
- 64 STA. 53+08.26, 33.57' LT. F.H. TO BE REMOVED
- 65 4' - DUCTILE IRON WATERMAIN 6" T.B.F. = 0 CU. YD.
- 66 STA. 53+38.25, 49.93' LT. V.V. TO BE RECONSTRUCTED EXIST. RIM = 744.15 PROP. RIM = 744.13
- 67 STA. 54+47.65, 31.62' LT. V.V. TO BE RECONSTRUCTED EXIST. RIM = 743.63 PROP. RIM = 743.32
- 68 STA. 57+18.01, 30.01' LT. F.H. TO BE REMOVED
- 22 STA. 53+82.64, 28.13' RT. SAN. MH TO BE RECONSTRUCTED EXIST. RIM = 744.27 PROP. RIM = 743.21
- 23 8' - 8" SANITARY SEWER REMOVAL T.B.F. = 10.5 CU. YD.
- 24 STA. 55+12.11, 25.65' RT. SAN. MH TO BE ADJUSTED EXIST. RIM = 741.87 PROP. RIM = 742.65
- 25 10' - 10" SANITARY SEWER REMOVAL T.B.F. = 13.8 CU. YD.
- 147 27' - 12" S.S., W.M.R., T-1 @ 0.5% T.B.F. = 1.0 CU. YD.
- 148 19' - 12" S.S., W.M.R., T-1 @ 0.5% T.B.F. = 2.6 CU. YD.
- 149 22' - PIPE UNDERDRAIN, 4"
- 150 48' - 12" S.S., CL. A, T-1 @ 0.5% T.B.F. = 8.4 CU. YD.
- 151 26' - PIPE UNDERDRAIN, 4"
- 152 44' - 12" S.S. REMOVAL
- 153 113' - 15" S.S., CL. A, T-1 @ 2.0% T.B.F. = 26.7 CU. YD.
- 154 43' - 18" S.S. REMOVAL
- 155 43' - 21" S.S., CL. A, T-2 @ 0.34% T.B.F. = 17.8 CU. YD.
- 156 31' - 18" S.S., CL. A, T-1 @ 0.8% T.B.F. = 9.2 CU. YD.
- 157 32' - 12" S.S. REMOVAL
- 157A 79' - 21" S.S. REMOVAL
- 157B 74' - 21" S.S., CL. A, T-2 @ 0.38% T.B.F. = 21.4 CU. YD.
- 158 70' - 12" S.S. REMOVAL
- 159 45' - 12" S.S., CL. A, T-2 @ 0.5% T.B.F. = 15.9 CU. YD.
- 160 2' - 12" S.S., CL. A, T-1 @ 0.5% T.B.F. = 0.1 CU. YD.
- 161 14' - 12" S.S., CL. A, T-1 @ 0.5% T.B.F. = 2.9 CU. YD.
- 162 56' - 12" S.S., CL. A, T-1 @ 0.5% T.B.F. = 8.6 CU. YD.
- 163 38' - 12" S.S. REMOVAL
- 164 144' - 6" S.S. REMOVAL
- 165 61' - 12" S.S., CL. A, T-2 @ 0.5% T.B.F. = 10.6 CU. YD.
- 166 13' - 12" S.S., CL. A, T-1 @ 0.5% T.B.F. = 0.7 CU. YD.
- 167 22' - PIPE UNDERDRAIN, 4"
- 168 55' - 12" S.S., CL. A, T-1 @ 0.5% T.B.F. = 8.4 CU. YD.
- 169 157' - PIPE UNDERDRAIN, 4"
- 170 116' - 12" S.S., CL. A, T-2 @ 0.5% T.B.F. = 21.4 CU. YD.
- 171 55' - 12" S.S., CL. A, T-1 @ 0.5% T.B.F. = 8.4 CU. YD.
- 172 137' - 15" S.S., CL. A, T-2 @ 0.5% T.B.F. = 15.2 CU. YD.

EXIST. P.G.L. ELEVATION	PROP. P.G.L. ELEVATION	52+00	+50	53+00	+50	54+00	+50	55+00	+50	56+00	+50	57+00									
750												750									
745												745									
740												740									
735												735									
730												730									
725												725									
		746.46	746.83	745.42	745.67	744.86	744.73	744.49	744.00	743.96	743.49	743.19	743.20	742.37	743.02	742.14	742.84	742.00	742.66	742.10	742.48

ILLINOIS DEPARTMENT OF TRANSPORTATION
 DRAINAGE AND UTILITIES
 STA. 52+00 TO STA. 57+50
WISE ROAD

HORIZ.: 20
 VERT.: 5
 SCALE IN FEET

DATE: 9/28/07
 DESIGNED BY: KRK
 CHECKED BY: JRV