

F.A.U. RTE.	SECTION	COUNTY	TOTAL SHEETS	SHEET NO.
1338	05-00083-00-FF	COOK	167	48
DETOUR PLAN AND ADVANCE CONSTRUCTING SIGNING				
FED. ROAD DIST. NO. 7 ILLINOIS FED. AID PROJECT M-8003(512)				

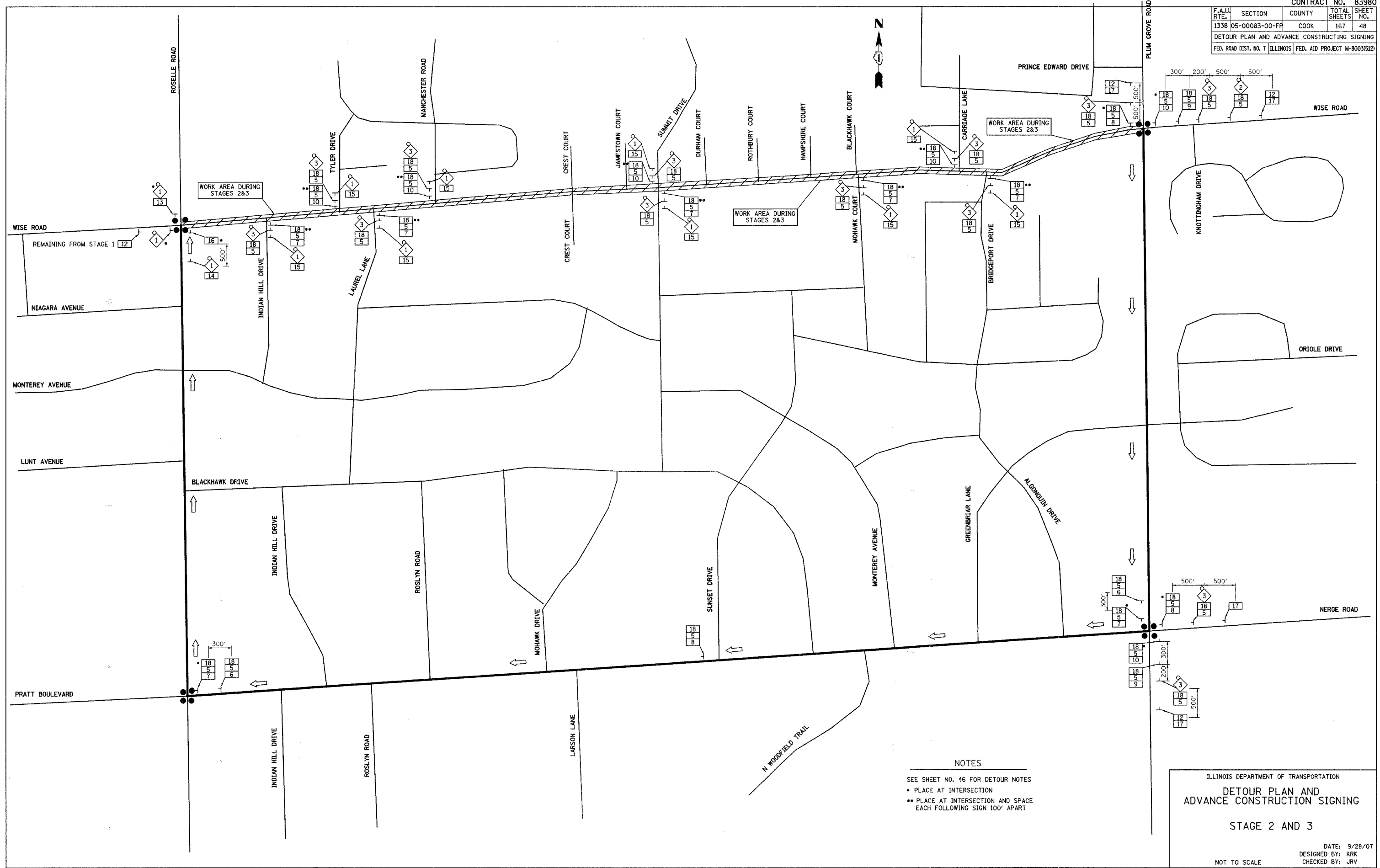

NOTES

- SEE SHEET NO. 46 FOR DETOUR NOTES
- PLACE AT INTERSECTION
- PLACE AT INTERSECTION AND SPACE EACH FOLLOWING SIGN 100' APART

ILLINOIS DEPARTMENT OF TRANSPORTATION
**DETOUR PLAN AND
 ADVANCE CONSTRUCTING SIGNING**
 STAGE 2 AND 3
 DATE: 9/28/07
 DESIGNED BY: KRK
 CHECKED BY: JRV
 NOT TO SCALE