

F.A.U. RTE.	SECTION	COUNTY	TOTAL SHEETS	SHEET NO.
1338	05-00083-00-FF	COOK	167	35
STA. 227+50		TO STA. 232+21		
FED. ROAD DIST. NO. 7 ILLINOIS FED. AID PROJECT W-800345121				

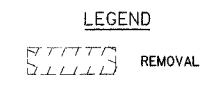

- NOTES:
- ADDITIONAL WIDTH FOR STUB SHALL BE INCLUDED IN COST OF "CORRUGATED MEDIAN, TYPE C-4".
 - SEE TYPICAL SECTIONS AND CCHD DETAIL (SHEET NO. 122) FOR LOCATIONS OF PROPOSED TIE BARS.

PLUM GROVE ROAD

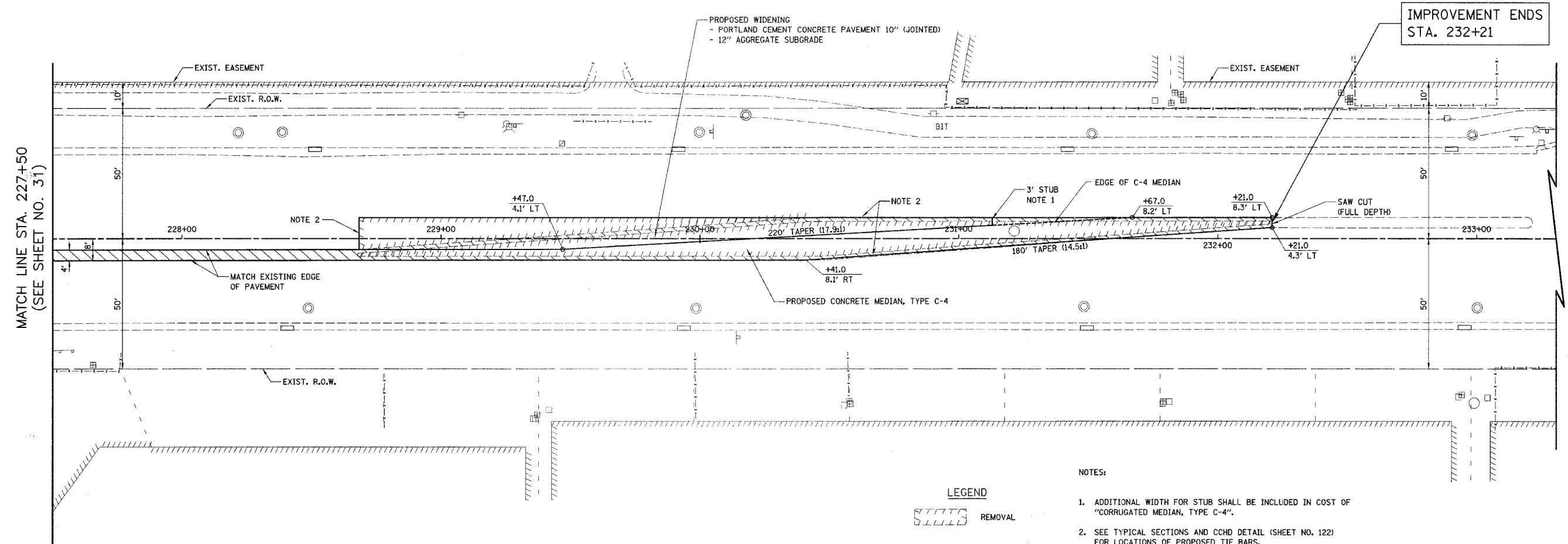
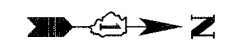
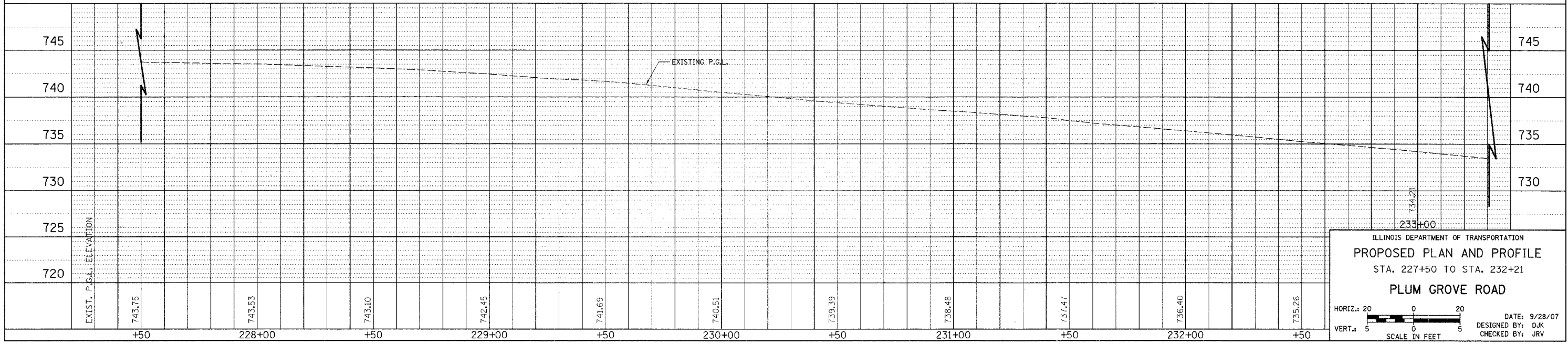

ILLINOIS DEPARTMENT OF TRANSPORTATION
PROPOSED PLAN AND PROFILE
 STA. 227+50 TO STA. 232+21
PLUM GROVE ROAD

HORIZ.: 20
 VERT.: 5
 SCALE IN FEET

DATE: 9/28/07
 DESIGNED BY: DJK
 CHECKED BY: JRJ