

F.A.U. RTE.	SECTION	COUNTY	TOTAL SHEETS	SHEET NO.
1338	05-00083-00-FP	COOK	167	25
STA. 30+50		TO STA. 35+50		
FED. ROAD DIST. NO. 7 ILLINOIS		FED. AID PROJECT M-800315121		

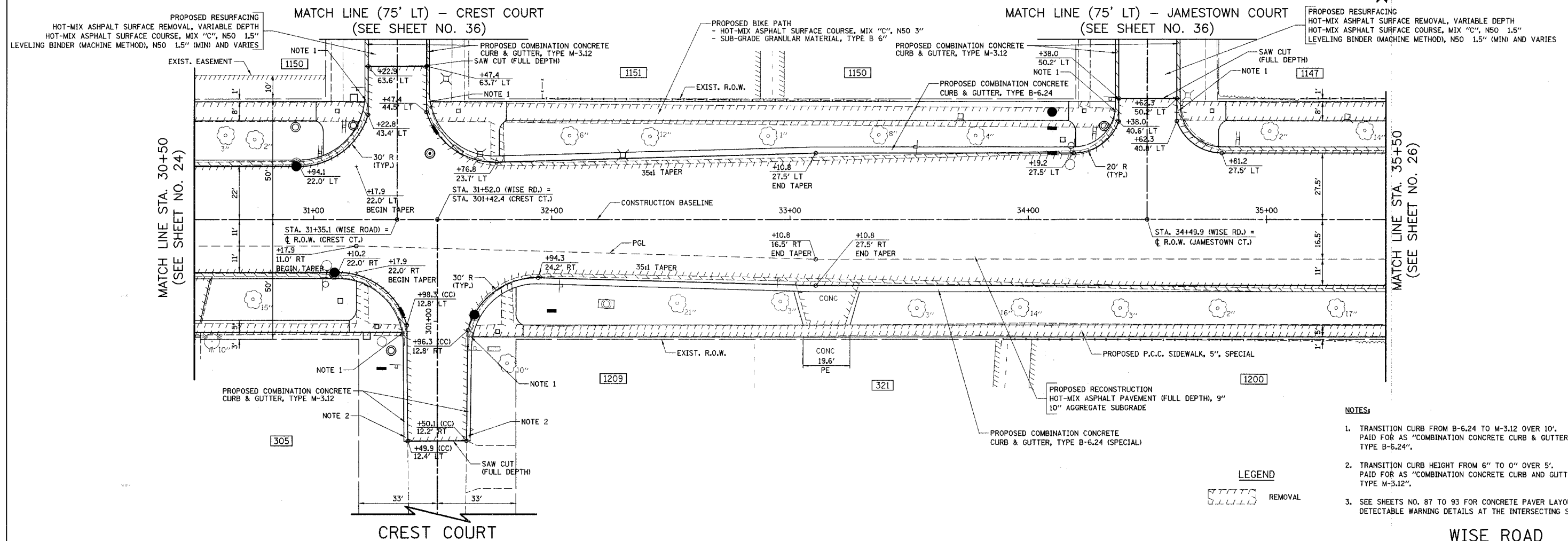

- NOTES:**
1. TRANSITION CURB FROM B-6.24 TO M-3.12 OVER 10'. PAID FOR AS "COMBINATION CONCRETE CURB & GUTTER, TYPE B-6.24".
 2. TRANSITION CURB HEIGHT FROM 6" TO 0" OVER 5'. PAID FOR AS "COMBINATION CONCRETE CURB AND GUTTER, TYPE M-3.12".
 3. SEE SHEETS NO. 87 TO 93 FOR CONCRETE PAVER LAYOUT AND DETECTABLE WARNING DETAILS AT THE INTERSECTING STREETS.

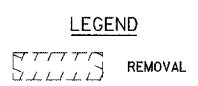

EXIST. P.G.L. ELEVATION	PROP. P.G.L. ELEVATION	STATION	ELEVATION	STATION	ELEVATION	STATION	ELEVATION	STATION	ELEVATION	STATION	ELEVATION	STATION	ELEVATION	STATION	ELEVATION	STATION	ELEVATION	STATION	ELEVATION									
775	768.85	30+50	768.96	31+00	768.19	768.15	767.86	767.75	767.71	767.68	767.67	767.77	767.98	768.14	768.33	768.70	768.42	768.92	768.97	768.41	768.86	768.26	768.31	767.62	767.73	766.95	767.15	775

ILLINOIS DEPARTMENT OF TRANSPORTATION
PROPOSED PLAN AND PROFILE
 STA. 30+50 TO STA. 35+50
WISE ROAD

HORIZ. 1" = 20'
 VERT. 1" = 5'

SCALE IN FEET

DATE: 9/28/07
 DESIGNED BY: DJK
 CHECKED BY: JRV