

F.A.P. RTE.	SECTION	COUNTY	TOTAL SHEETS	SHEET NO.
321	18(N-1,TS)	PIKE	55	15
STA.		TO STA.		
FED. ROAD DIST. NO.	ILLINOIS	FED. AID PROJECT		

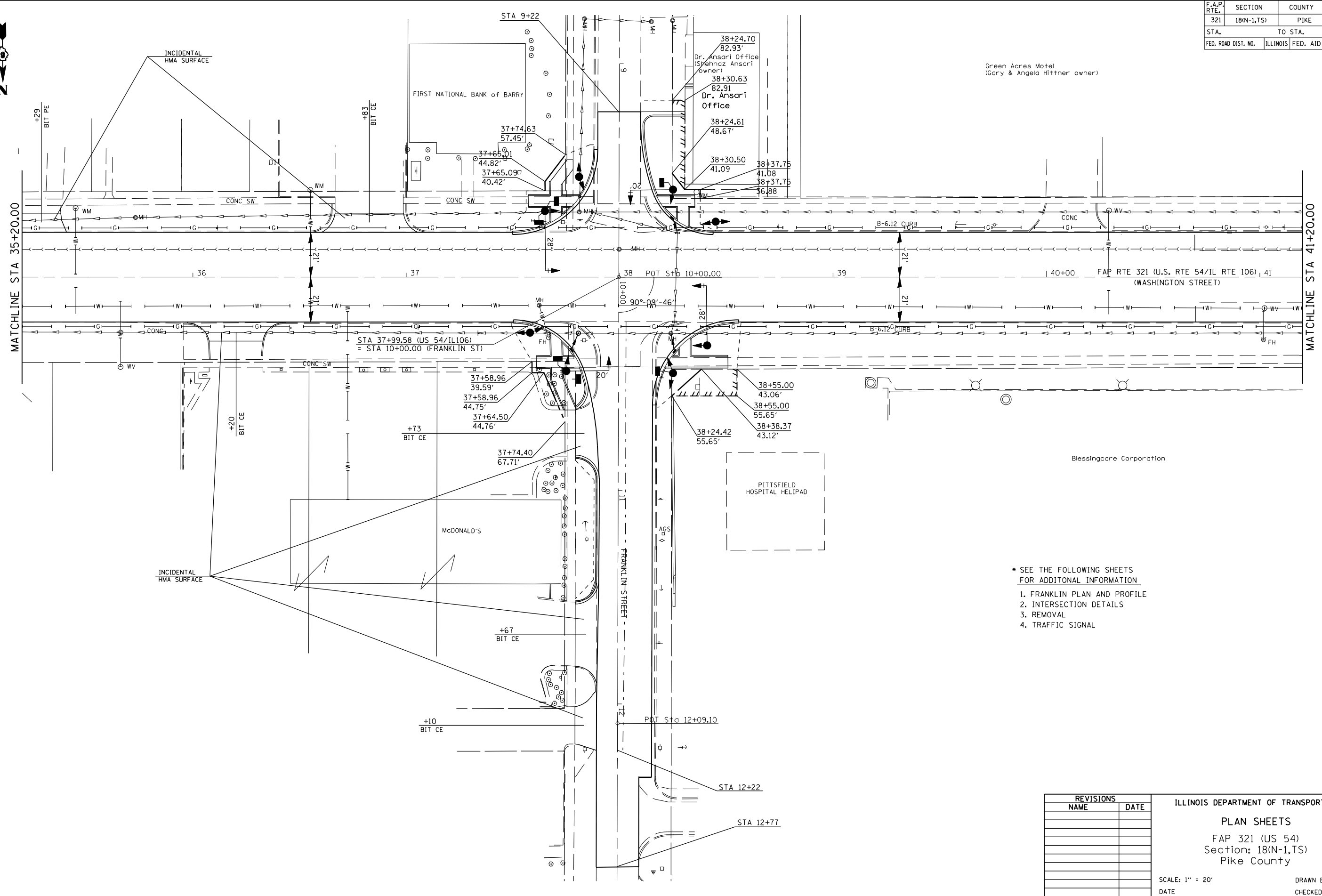

- * SEE THE FOLLOWING SHEETS FOR ADDITIONAL INFORMATION
1. FRANKLIN PLAN AND PROFILE
 2. INTERSECTION DETAILS
 3. REMOVAL
 4. TRAFFIC SIGNAL

REVISIONS	
NAME	DATE

ILLINOIS DEPARTMENT OF TRANSPORTATION

PLAN SHEETS

FAP 321 (US 54)

Section: 18(N-1,TS)

Pike County

SCALE: 1" = 20'

DATE

DRAWN BY

CHECKED BY

PLOT DATE = 04-04-2007 01:05:33PM
 FILE NAME = c:\p\projects\655184\h\h\plan1.dgn
 PLOT SCALE = 42.3525 / IN.
 USER NAME = laughlin-1