

F.A.P. RTE.	SECTION	COUNTY	TOTAL SHEETS	SHEET NO.
321	18(N-1,TS)	PIKE	55	8
STA.		TO STA.		
FED. ROAD DIST. NO.	ILLINOIS	FED. AID PROJECT		

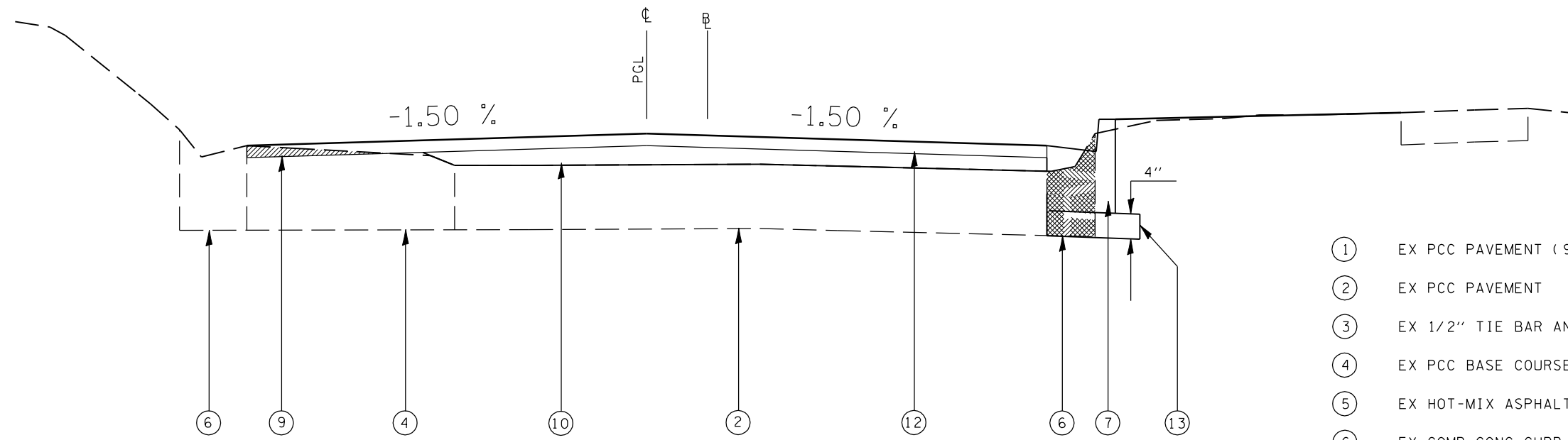

Franklin St.
10+21 to 12+22

PCC BASE COURSE DETAIL

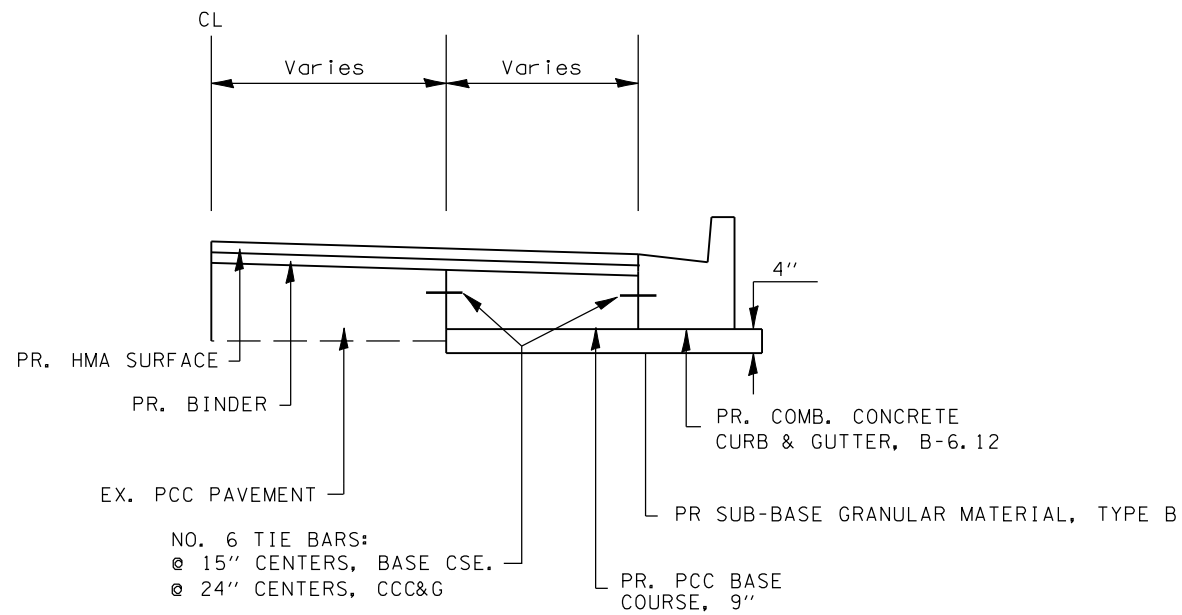

NO. 6 TIE BARS:
@ 15" CENTERS, BASE CSE.
@ 24" CENTERS, CCC&G

- ① EX PCC PAVEMENT (9-7-9)
- ② EX PCC PAVEMENT
- ③ EX 1/2" TIE BAR AND LONGITUDINAL METAL JOINT
- ④ EX PCC BASE COURSE WIDENING, 9"
- ⑤ EX HOT-MIX ASPHALT, 3" & VAR
- ⑥ EX COMB CONC CURB & GUTTER B-6.12
- ⑦ PR COMB CONC CURB & GUTTER B-6.12
- ⑧ PR HOT-MIX ASPHALT SURFACE REMOVAL 2"
- ⑨ PR HOT-MIX ASPHALT SURFACE REMOVAL, VAR. DEPTH
- ⑩ PR HOT-MIX ASPHALT BINDER
- ⑪ PR HOT-MIX ASPHALT SURFACE COURSE 2"
- ⑫ PR HOT-MIX ASPHALT SURFACE COURSE, VAR. 1 1/2"
- ⑬ PR SUB-BASE GRANULAR MATERIAL, TYPE B



- EX CURB & GUTTER REMOVAL

NOTES:

- 1) ALL OF THE PCC BASE COURSE WILL BE PAID FOR AS PCC BASE COURSE, 9' REGARDLESS OF THE WIDTH.
- 2) MILLING OF THE CONCRETE PAVEMENT ON FRANKLIN ST. AND CLINTON ST. SHALL BE PAID FOR AS HMA SURFACE REMOVAL VARIABLE DEPTH.

REVISIONS	
NAME	DATE

ILLINOIS DEPARTMENT OF TRANSPORTATION
TYPICAL SECTIONS
FAP 321 (US 54/IL 106/WASHINGTON ST)
SECTION (18(N-1,TS)
PIKE COUNTY

SCALE: VERT.
HORIZ.
DATE

DRAWN BY
CHECKED BY