

F.A. RTE.	SECTION	COUNTY	TOTAL SHEETS	SHEET NO.
317	36 BR	IROQUOIS	29	1
FED. ROAD DIST. NO.	ILLINOIS	CONTRACT NO. 66646		

P93-010-07  
D93-038-06

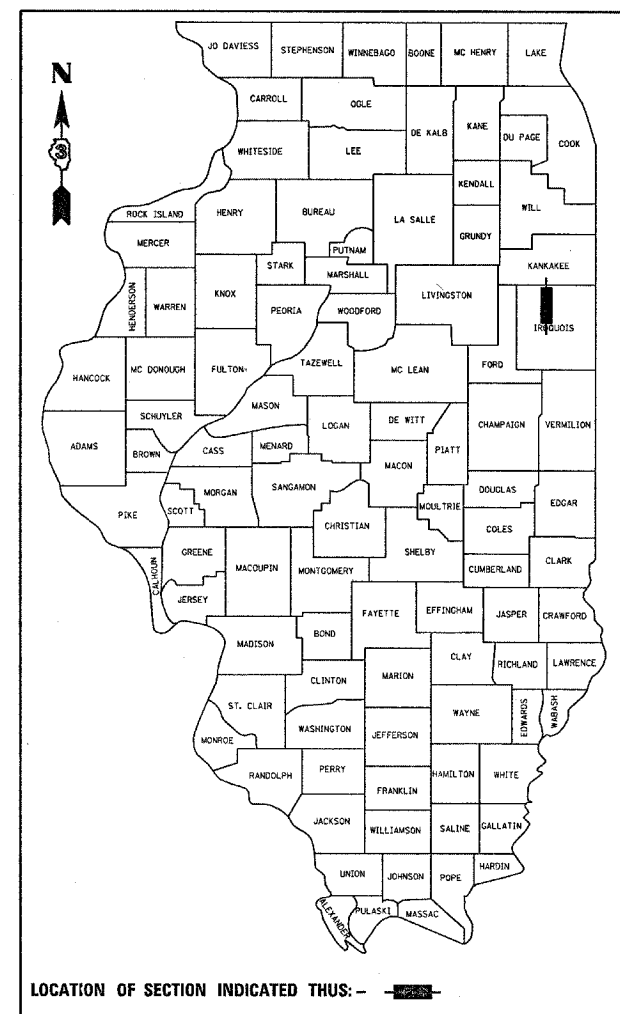

HIGHWAY DESIGNATION: RURAL (MAJOR) COLLECTOR

ADT 2008 - 2150  
PV - 92.1% SU - 6.0% MU - 1.9%

STATE OF ILLINOIS  
DEPARTMENT OF TRANSPORTATION  
DIVISION OF HIGHWAYS

SUBMITTED 11-1 20 07

*[Signature]*  
DEPUTY DIRECTOR OF HIGHWAYS, REGION ENGINEER

December 7, 20 07

*[Signature]*  
ENGINEER OF DESIGN AND ENVIRONMENT

December 7, 20 07

*[Signature]*  
DIRECTOR OF HIGHWAYS, CHIEF ENGINEER

PRINTED BY THE AUTHORITY  
OF THE STATE OF ILLINOIS

STATE OF ILLINOIS  
DEPARTMENT OF TRANSPORTATION  
DIVISION OF HIGHWAYS

**PROPOSED  
HIGHWAY PLANS**

FAS ROUTE 317 (US 45)  
SECTION 36 BR  
PROJECT BRS-0317(110)  
IROQUOIS COUNTY

C93-064-06

REMOVE AND REPLACE S.N. 038-0038 WITH A  
DOUBLE 11' X 9' BOX CULVERT S.N. 038-2017

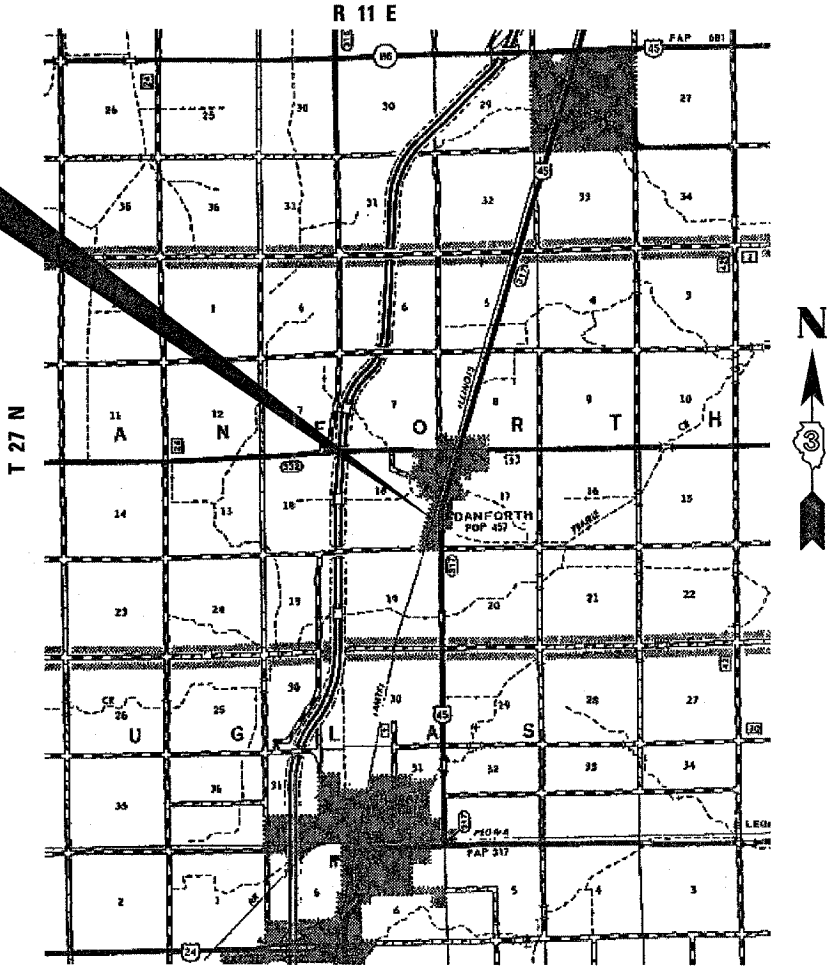

STA. 1118+70 TO STA. 1121+65  
EXISTING S.N. 038-0038  
PROPOSED S.N. 038-2017

GROSS AND NET LENGTH OF NEED = 295 FT = .056 MI.

INDEX OF SHEETS

- 1 COVER SHEET
- 2 GENERAL NOTES & STANDARDS
- 3-4 SUMMARY OF QUANTITIES
- 5 TYPICAL SECTIONS
- 6 SCHEDULES OF QUANTITIES
- 7 ALIGNMENT SHEET
- 8 PLAN & PROFILE
- 9 REMOVAL, LANDSCAPING AND PAVEMENT MARKING PLAN
- 10 GUARDRAIL PLAN SHEET
- 11 RIGHT-OF-WAY PLAN
- 12 DETOUR PLAN SHEET
- 13-17 CULVERT AND WINGWALL PLANS
- 18 BORING LOG SHEET
- 19-24 EXISTING BRIDGE SHEETS
- 25 CADD DETAIL SHEET
- 26-29 ILL 116 CROSS SECTIONS

FOR HIGHWAY STANDARDS,  
SEE SHEET NO. 2

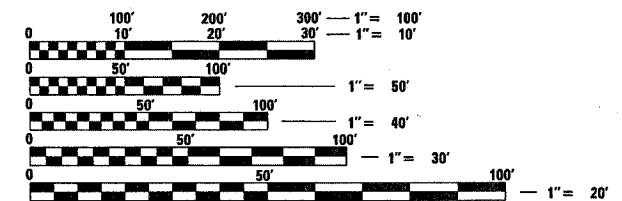

FULL SIZE PLANS HAVE BEEN PREPARED USING STANDARD  
ENGINEERING SCALES. REDUCED SIZED PLANS WILL NOT  
CONFORM TO STANDARD SCALES. IN MAKING MEASUREMENTS  
ON REDUCED PLANS, THE ABOVE SCALES MAY BE USED.

J.U.L.I.E.  
JOINT UTILITY LOCATION INFORMATION FOR EXCAVATION  
1-800-892-0123  
OR 811

PROJECT ENGINEER SCOTT A. FERGUSON  
PROJECT MANAGER DAVE BROVIK

CONTRACT NO. 66646

GENERAL NOTES

THE THICKNESS OF HMA SHOWN ON THE PLANS IS THE NOMINAL THICKNESS. DEVIATIONS FROM THE NOMINAL THICKNESS WILL BE PERMITTED WHEN SUCH DEVIATIONS OCCUR DUE TO IRREGULARITIES IN THE EXISTING SURFACE OR BASE ON WHICH THE HMA IS PLACED.

THE HMA SURFACE OF ALL MAILBOX TURNOUTS, PRIVATE ENTRANCES, COMMERCIAL ENTRANCES, AND SIDE ROADS SHALL BE MADE NEATLY, IN A WORKMANLIKE MANNER, AND SHALL ACCURATELY CONFORM TO THE SHAPES AND DIMENSIONS SHOWN ON THE PLAN DETAILS. IF REQUIRED BY THE ENGINEER, THE CONTRACTOR SHALL BE REQUIRED TO SAW CUT THE HMA SURFACE TO CONFORM TO THE SHAPES AND DIMENSIONS SHOWN ON THE PLAN DETAILS. THIS WORK SHALL BE INCLUDED IN THE COST OF THE HMA SURFACE

EXCEPT AS NOTED ON THE PLANS, PAVEMENT GRADES SHOWN ARE AT THE TOP OF PAVEMENT SURFACES.

BEFORE ORDERING PIPE CULVERTS OR PIPE DRAINS, THE CONTRACTOR SHALL CONSULT THE ENGINEER FOR EXACT LENGTHS.

THE ENGINEER WILL BE THE SOLE JUDGE CONCERNING CURING TIME FOR THE VARIOUS HMA LIFTS.

FOR STABILIZATION, ALL TYPE III BARRICADES SHALL REQUIRE A MINIMUM OF FOUR SAND BAGS PER BARRICADE.

SEEDING SHALL NOT BE PERMITTED AT ANY TIME WHEN THE GROUND IS FROZEN, WET, OR IN AN UNTILLABLE CONDITION. LOCATIONS TO BE SEEDED WILL BE DETERMINED BY THE ENGINEER.

ONLY THOSE TREES DESIGNATED BY THE ENGINEER OR LISTED IN THE TREE REMOVAL SCHEDULE SHALL BE REMOVED. THE CONTRACTOR SHALL PROTECT ALL REMAINING TREES FROM DAMAGE DUE TO HIS OPERATIONS.

THE FINISHED EARTHWORK SHALL HAVE A VEGETATION SUSTAINING SOIL COVERING THE TOP FOUR INCHES IN AREAS TO BE SEEDED OR SODDED. THE VEGETATION SUSTAINING SOIL REQUIRED WILL NOT BE PAID FOR SEPARATELY BUT SHALL BE INCLUDED IN THE COST OF FURNISHED EXCAVATION.

ALL ELEVATIONS REFERRING TO U.S.G.S. MEAN SEA LEVEL DATUM.

ABANDONED UNDERGROUND UTILITIES THAT CONFLICT WITH CONSTRUCTION SHALL BE DISPOSED OF OUTSIDE THE LIMITS OF THE RIGHT OF WAY ACCORDING TO ARTICLE 202.03 OF THE STANDARD SPECIFICATIONS AND AS DIRECTED BY THE ENGINEER. THIS WORK WILL NOT BE PAID FOR SEPARATELY, BUT SHALL BE INCLUDED IN THE COST OF EARTH EXCAVATION.

ANY REFERENCE TO A STANDARD IN THESE PLANS SHALL BE INTERPRETED TO MEAN THE EDITION AS INDICATED BY THE SUBNUMBER SHOWN IN THE LIST OF STANDARDS OR THE COPY INCLUDED IN THESE PLANS.

THE FOLLOWING RATES OF APPLICATION HAVE BEEN USED IN CALCULATING PLAN QUANTITIES:

GRANULAR MATERIALS	2.05	TONS / CU YD
BITUMINOUS MAT PRIME COAT	0.08	GAL / SQ YD OR
	0.375	GAL / SQ YD
AGGREGATE PRIME COAT	0.002	TONS / SQ YD
HMA RESURFACING	112	LBS / SQ YD / IN
SHORT TERM PAVEMENT MARKING	10	FT /100 FT OF APPLICATION
MIX FOR CRACKS, JTS & FLGWYS	0.0003	TONS / SQ YD
LEVEL BINDER (HAND METHOD)	0.0005	TONS / SQ YD
SUPPLEMENTAL WATERING	3	GAL / SQ YD / APPLICATION
CALCIUM CHLORIDE	2	LB / SQ YD / APPLICATION
TEMPORARY DITCH CHECKS	5	TONS AGGREGATE

THE WORK REQUIRED TO CONNECT ANY SEWER TO AN EXISTING DRAINAGE STRUCTURE OR PIPE WILL NOT BE PAID FOR SEPARATELY, BUT SHALL BE CONSIDERED AS INCLUDED IN THE CONTRACT UNIT PRICE BID FOR THE SEWER ITEMS.

MEMBERS OF JULIE KNOWN TO BE WITHIN THE LIMITS OF THE IMPROVEMENT ARE:

Ameren CIPS  
AT & T  
ComCast  
Eastern Illini Electric Co-op  
Nicor SC6019  
Verizon

NON-MEMEBERS WITHIN THE JOB LIMITS ARE:

NONE

	HMA Base Course	HMA Level Binder	HMA Surface	HMA Shoulders
PG Grade	PG58-22	PG58-22	PG64-22	PG58-22
Max % RAP Allowable**	25%	25%	15%	50%
Design Air	4.0% @	4.0% @	4.0% @	3.0% @
Voids	N50	N50	N50	N50
Mixture Composition	IL 19.0	IL 9.5	IL 12.5 or IL 9.5	IL 19.0
Friction Aggregate			Mixture C	
Density Test Method	Nuclear/Cores	Satisfaction of Engineer	Nuclear/Cores	

\* Material shall be compacted to 93.0 - 97.4 percent of the maximum theoretical density except that when placed as first lift on an unimproved subgrade the minimum percent compaction shall be 92.0 percent. The maximum theoretical density shall be determined from the moving average as specified in the QC/QA Specification.

\*\* If RAP option is selected, the asphalt cement grade may need to be adjusted. This will be determined by the Engineer

STANDARDS

- 000001-05 STANDARD SYMBOLS, ABBREVIATIONS AND PATTERNS
- 001001-01 AREAS OF REINFORCEMENT BARS
- 001006 DECIMAL OF AN INCH AND OF A FOOT
- 406201-01 MAILBOX TURNOUT
- 482001-02 HMA SHOULDER ADJACENT TO FLEXIBLE PAVEMENT
- 482011-03 HMA SHOULDER STRIPS/SHOULDERS WITH RS OR WIDENING & RS PROJECTS
- 515001-02 NAME PLATE FOR BRIDGES
- 630001-07 STEEL PLATE BEAM GUARDRAIL
- 630101-07 GUARDRAIL MOUNTED ON EXISTING CULVERTS
- 630201-05 PCC/HMA STABILIZATION AT STEEL PLATE BEAM GUARDRAIL
- 630301-04 SHOULDER WIDENING FOR TYPE 1 (SPECIAL) GUARDRAIL TERMINALS
- 635006-02 REFLECTOR AND TERMINAL MARKER PLACEMENT
- 635011-01 REFLECTOR MARKER AND MOUNTING DETAILS
- 668001 U.S. GEOLOGIC SURVEY AND NATIONAL GEODETIC SURVEY BENCHMARKS, RESETTING METHOD
- 701006-02 OFF-ROAD OPERATIONS 2L, 2W, 4.5 m (15') TO 600 mm (24") FROM PAVEMENT EDGE
- 701201-02 LANE CLOSURE, 2L, 2W, DAY ONLY, FOR SPEEDS P 45 MPH
- 701301-02 LANE CLOSURE, 2L, 2W, SHORT TIME OPERATIONS
- 701311-02 LANE CLOSURE, 2L, 2W, MOVING OPERATIONS - DAY ONLY
- 701901 TRAFFIC CONTROL DEVICES
- 720001 SIGN PANEL MOUNTING DETAILS
- 720006-01 SIGN PANEL ERECTION DETAILS
- 720011 METAL POSTS FOR SIGNS, MARKERS AND DELINEATORS
- 729001 APPLICATIONS OF TYPE A AND B METAL POSTS (FOR SIGNS & MARKERS)
- 781001-02 TYPICAL APPLICATIONS RAISED REFLECTIVE PAVEMENT MARKERS

STATE OF ILLINOIS  
DEPARTMENT OF TRANSPORTATION  
DISTRICT THREE

PREPARED BY: Paul Powell  
DISTRICT STUDIES & PLANS ENGINEER

DATE: 11-1-07

EXAMINED BY: David K...  
DISTRICT CONSTRUCTION ENGINEER

James P. Throckmold III  
DISTRICT MATERIALS ENGINEER

James A. ...  
DISTRICT OPERATIONS ENGINEER

## SUMMARY OF QUANTITIES

CODE NO.	ITEM	UNIT	TOTAL QUANTITY	CONSTRUCTION CODE TYPE:	
				ROADWAY J000	BRIDGE X028-2A
20400800	FURNISHED EXCAVATION	CU YD	92.3	92.3	
20700220	POROUS GRANULAR EMBANKMENT	CU YD	206.4		206.4
20700400	POROUS GRANULAR EMBANKMENT, SPECIAL	CU YD	70.9		70.9
* 25000210	SEEDING, CLASS 2A	ACRE	0.13	0.13	
* 25000400	NITROGEN FERTILIZER NUTRIENT	POUND	11.7	11.7	
* 25000500	PHOSPHOROUS FERTILIZER NUTRIENT	POUND	11.7	11.7	
* 25000600	POTASSIUM FERTILIZER NUTRIENT	POUND	11.7	11.7	
* 25100630	EROSION CONTROL BLANKET	SQ YD	318.3	318.3	
* 25200100	SODDING	SQ YD	149	149	
* 28000250	TEMPORARY EROSION CONTROL SEEDING	POUND	78	78	
* 28000300	TEMPORARY DITCH CHECKS	EACH	1	1	
* 28000400	PERIMETER EROSION BARRIER	FOOT	346	346	
* 28000500	INLET AND PIPE PROTECTION	EACH	3	3	
28100103	STONE RIPRAP, CLASS A2	SQ YD	55.4		55.4
28200200	FILTER FABRIC	SQ YD	55.4		55.4
31100300	SUB-BASE GRANULAR MATERIAL, TYPE A 4"	SQ YD	174	174	
35501327	HOT-MIX ASPHALT BASE COURSE, 10 3/4"	SQ YD	166.7	166.7	
40600100	BITUMINOUS MATERIALS (PRIME COAT)	GALLON	96.2	96.2	
40600300	AGGREGATE (PRIME COAT)	TON	2.4	2.4	
40600625	LEVELING BINDER (MACHINE METHOD), N50	TON	33.3	33.3	
40603310	HOT-MIX ASPHALT SURFACE COURSE, MIX "C", N50	TON	66.4	66.4	
44000100	PAVEMENT REMOVAL	SQ YD	98.5	98.5	
44000158	HOT-MIX ASPHALT SURFACE REMOVAL, 2 1/4"	SQ YD	679.4	679.4	
44000600	SIDEWALK REMOVAL	SQ FT	1283	1283	
48203029	HOT-MIX ASPHALT SHOULDERS, 8"	SQ YD	411.5	411.5	
50100100	REMOVAL OF EXISTING STRUCTURES	EACH	1		1
50200100	STRUCTURE EXCAVATION	CU YD	358		358
50300225	CONCRETE STRUCTURES	CU YD	43.6		43.6

\* SPECIALTY ITEM

FILE NAME = c:\projects\ed93886\sheets.dgn	USER NAME = Ferguson	DESIGNED -	REVISED -	<b>STATE OF ILLINOIS DEPARTMENT OF TRANSPORTATION</b>	<b>SUMMARY OF QUANTITIES</b>	F.A.S. RTE. 317	SECTION 36 BR	COUNTY IROQUOIS	TOTAL SHEETS 29	SHEET NO. 3
		DRAWN -	REVISED -			STA. 1117+00 TO STA. 1123+00		CONTRACT NO. 66646		
		CHECKED -	REVISED -		SCALE:	SHEET NO. OF SHEETS		STA. TO STA.		
		DATE -	REVISED -			FED. ROAD DIST. NO. ILLINOIS FED. AID PROJECT				

## SUMMARY OF QUANTITIES

CODE NO.	ITEM	UNIT	CONSTRUCTION CODE TYPE:		
			TOTAL QUANTITY	ROADWAY J000	BRIDGE X028-2A
50800105	REINFORCEMENT BARS	POUND	3082		3082
50800205	REINFORCEMENT BARS, EPOXY COATED	POUND	1001		1001
51500100	NAME PLATES	EACH	1		1
542D0220	PIPE CULVERTS, CLASS D, TYPE 1 15"	FOOT	18	18	
60240395	INLETS, TYPE B	EACH	2	2	
* 63000000	STEEL PLATE GUARD RAIL, TYPE A	FOOT	25	25	
* 63000025	STEEL PLATE BEAM GUARD RAIL, ATTACHED TO STRUCTURES	FOOT	75	75	
* 63100167	TRAFFIC BARRIER TERMINAL, TYPE 1 (SPECIAL) TANGENT	EACH	4	4	
63200305	STEEL PLATE <sup>BEAM</sup> GUARD RAIL REMOVAL	FOOT	454	454	
67000400	ENGINEER'S FIELD OFFICE, TYPE A	CAL MC	3	3	
67100100	MOBILIZATION	L SUM	1	1	
70101800	TRAFFIC CONTROL AND PROTECTION, (SPECIAL)	L SUM	1	1	
70300100	SHORT-TERM PAVEMENT MARKING	FOOT	30	30	
70300220	TEMPORARY PAINT PAVEMENT MARKING-LINE 4"	FOOT	594	594	
70300240	TEMPORARY PAINT PAVEMENT MARKING-LINE 6"	FOOT	80	80	
70301000	WORK ZONE PAVEMENT MARKING REMOVAL	SQ FT	15	15	
* 78100100	RAISED REFLECTIVE PAVEMENT MARKER	EACH	1	1	
* 78100105	RAISED REFLECTIVE PAVEMENT MARKER (BRIDGE)	EACH	6	6	
* 78200410	GUARDRAIL MARKERS, TYPE A	EACH	12	12	
* 78201000	TERMINAL MARKER - DIRECT APPLIED	EACH	4	4	
78300200	RAISED REFLECTIVE PAVEMENT MARKER REMOVAL	EACH	7	7	
X0321991	CHANNEL CLEANING	FOOT	60	60	
* XX006058	POLYUREA PAVEMENT MARKING - LINE 4"	FOOT	594	594	
* XX006059	POLYUREA PAVEMENT MARKING - LINE 6"	FOOT	80	80	
XX006174	PEDESTRIAN BRIDGE REMOVAL	EACH	1		1
Z0038700	PERMANENT BENCH MARKS	EACH	1		1
54021011	PRECAST CONCRETE BOX CULVERT 11' x 9' (M273)	FOOT	80		80

\* SPECIALTY ITEMS

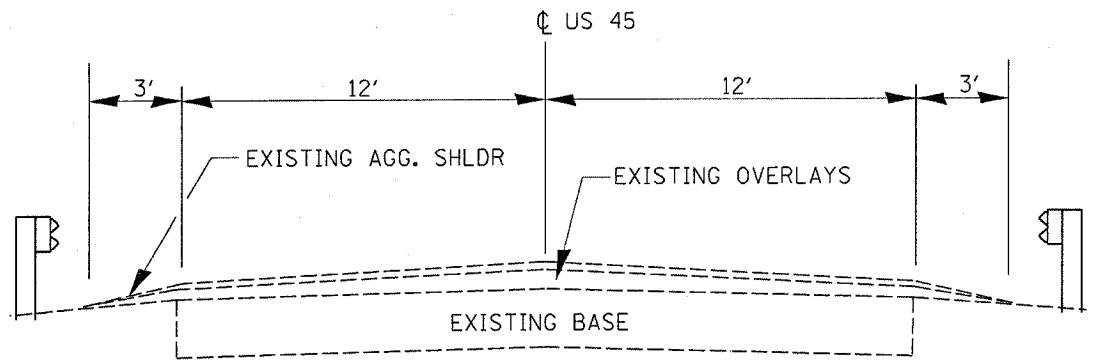

**EXISTING ROADWAY TYPICAL**

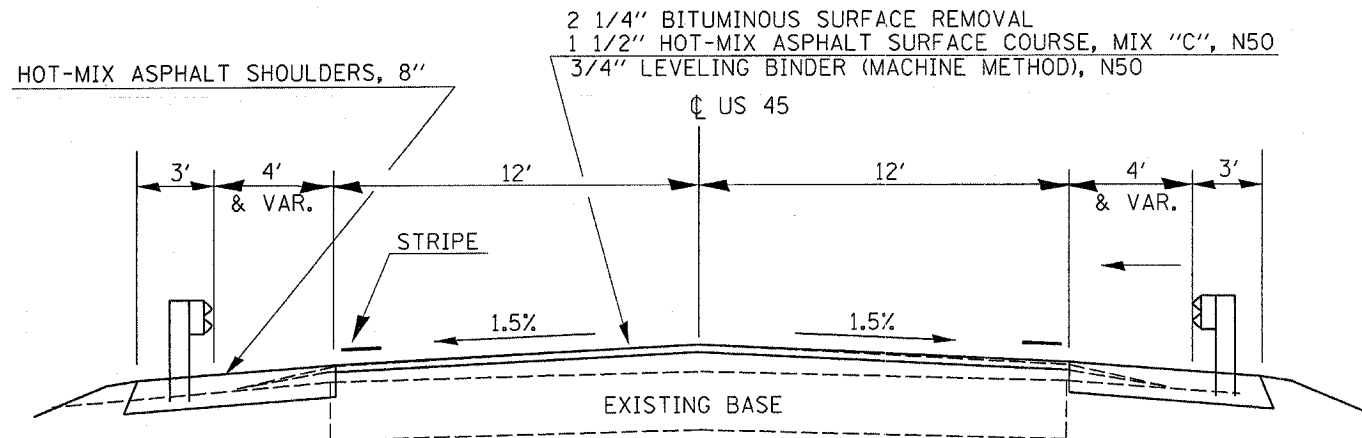

**PROPOSED ROADWAY TYPICAL**

STA. 1118+68.40 TO STA. 1119+85  
STA. 1120+47.5 TO STA. 1121+65

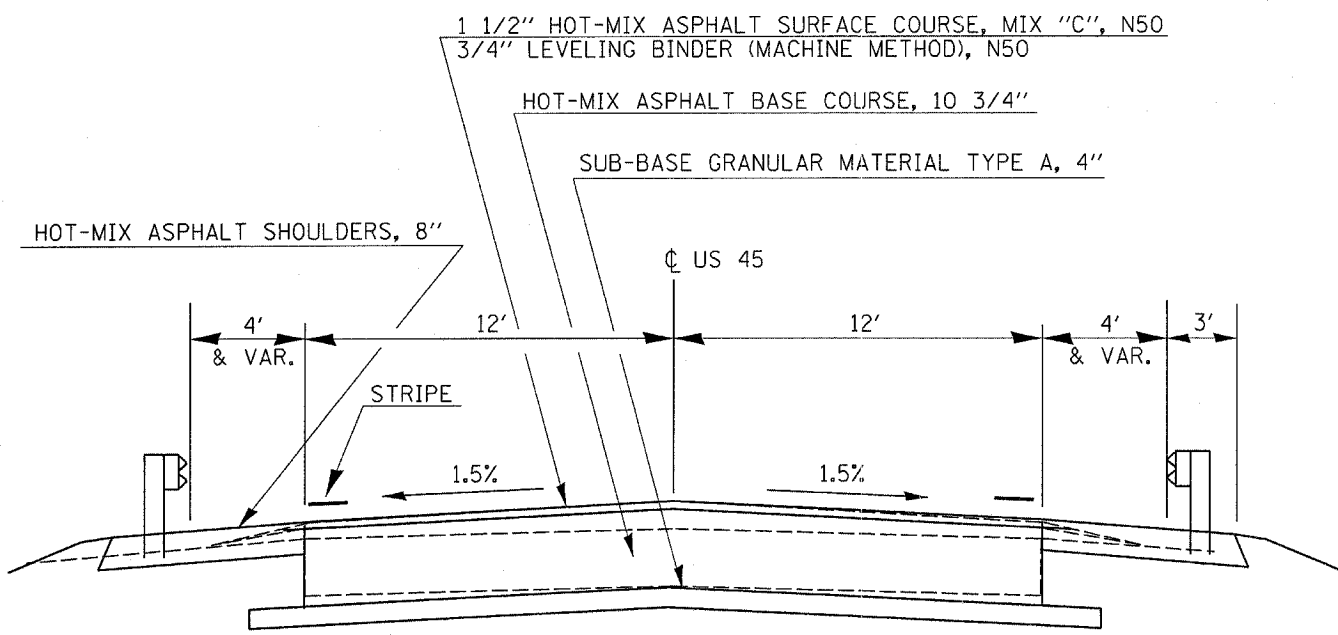

**PROPOSED ROADWAY TYPICAL**

STA. 1119+84 TO STA. 1120+47.5

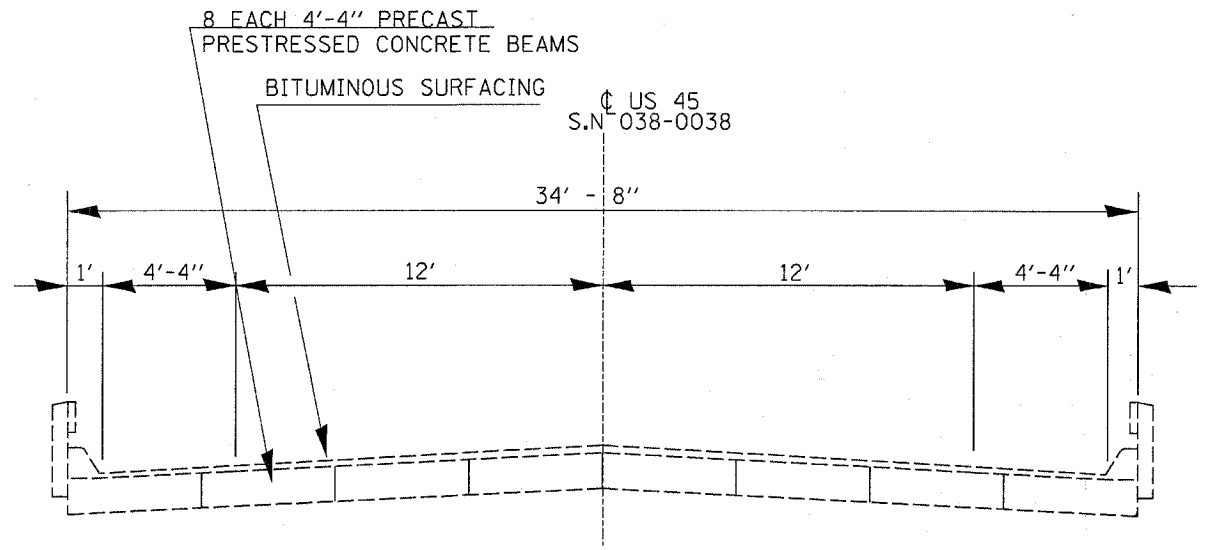

**EXISTING BRIDGE TYPICAL**

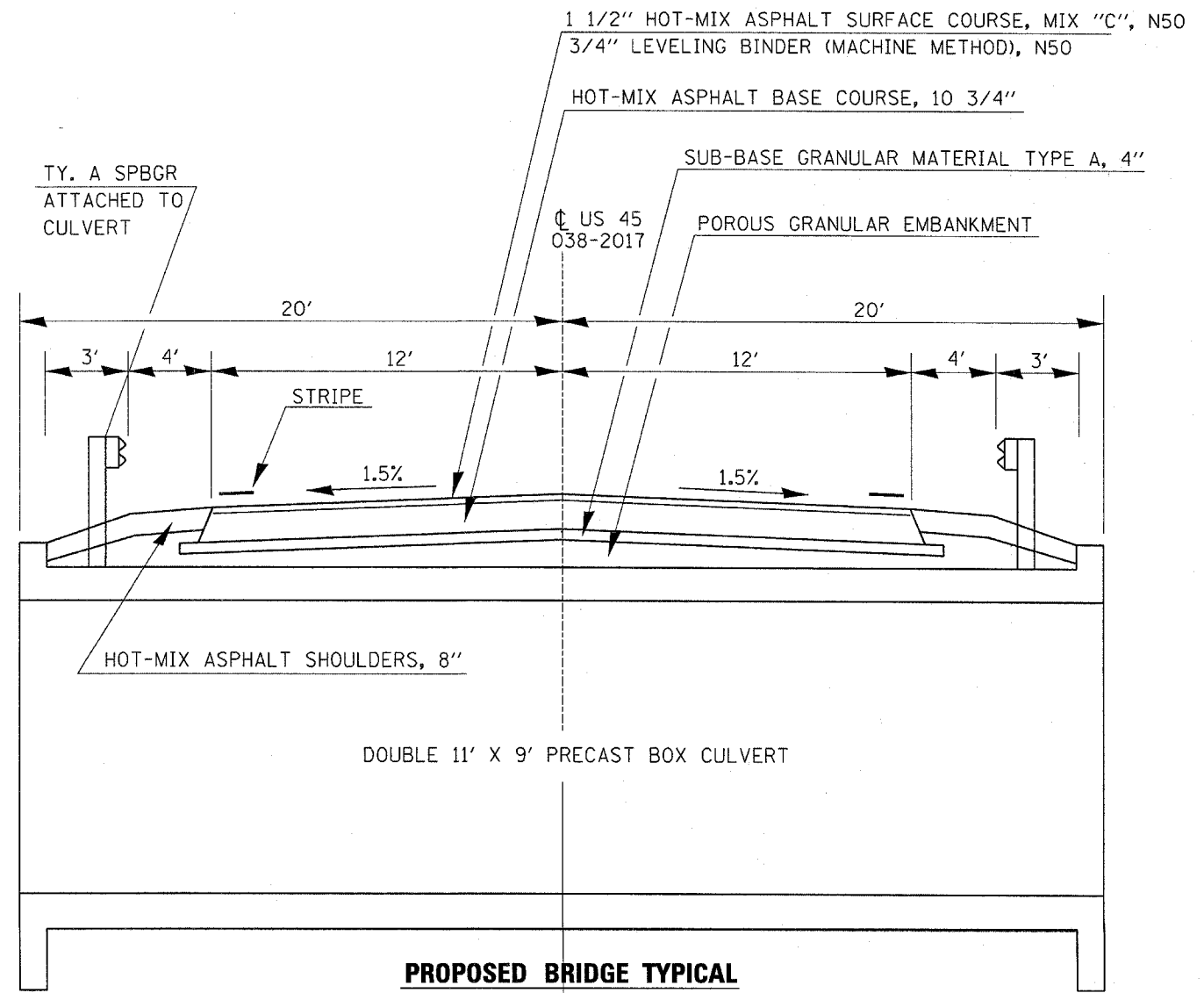

**PROPOSED BRIDGE TYPICAL**

FILE NAME =  
c:\projects\ed03806\sheets.dgn

USER NAME = fergusonsa  
PLOT SCALE = 20,000' / IN.  
PLOT DATE = Oct 31, 2007 - 03:54:07 PM

DESIGNED -  
DRAWN -  
CHECKED -  
DATE -

REVISED -  
REVISED -  
REVISED -  
REVISED -

STATE OF ILLINOIS  
DEPARTMENT OF TRANSPORTATION

**TYPICAL SECTIONS**

SCALE: SHEET NO. OF SHEETS STA. TO STA.

F.A.S. RTE. 317	SECTION 36 BR	COUNTY IROQUOIS	TOTAL SHEETS 20	SHEET NO. 5
STA. 1117+00 TO STA. 1123+00			CONTRACT NO. 66646	
FED. ROAD DIST. NO. ILLINOIS FED. AID PROJECT				

GUARDRAIL SCHEDULE						
LOCATION	STEEL PLATE BEAM GUARD RAIL REMOVAL	STEEL PLATE BEAM GUARD RAIL ATTACHED TO EXIST. CULV.	STEEL PLATE BEAM GUARD RAIL TYPE A	TRAFFIC BARRIER TERMINAL TY 1 SPECIAL FLARED	TERMINAL MARKER DIRECT APPLIED	GUARDRAIL MARKERS TYPE A
	FOOT		FOOT	EACH	EACH	EACH
1119+48.30 TO 1119+98.30				1	1	3
1119+98.30 TO 1120+60.80		37.5	25			
1120+60.80 TO 1121+10.80				1	1	3
1119+53.03 TO 1120+03.30				1	1	3
1120+03.30 TO 1120+40.80		37.5				
1120+40.80 TO 1120+90.80				1	1	3
1118+88.5 TO 1121+49.5	261					
1119+51.5 TO 1121+44.5	193					
<b>TOTAL</b>	<b>454</b>	<b>75</b>	<b>25</b>	<b>4</b>	<b>4</b>	<b>12</b>

MAINLINE SCHEDULE											
LOCATION IL 116	LENGTH	WIDTH	AREA	HOT-MIX ASPHALT SURFACE COURSE MIX C, N50	LEVELING BINDER (MACHINE) (METHOD) N50	HOT-MIX ASPHALT BASE COURSE	HOT-MIX ASPHALT SHOULDERS	SUB-BASE GRANULAR MATERIAL TYPE A	BITUMINOUS PRIME COAT	HOT-MIX ASPHALT SURFACE REMOVAL	AGG PRIME COAT
				1 1/2"	3/4"	10 3/4"	8"	4"	2 1/4"		
	FT	FT	SQ YD	TONS	TONS	SQ YD	SQ YD	SQ YD	GALLONS	SQ YD	TONS
<b>LIVINGSTON COUNTY</b>											
1118+68.40 TO 1119+85	116.6	24.0	310.9	26.1	13.1		150.1		36.9	366.1	0.92
1119+85 TO 1120+47.5	62.5	24.0	166.7	14.0	7.0	166.7	98.0	174.0	21.2		0.53
1120+47.5 TO 1121+65	117.5	24.0	313.3	26.3	13.2		163.4		38.1	313.3	0.96
<b>LINE TOTAL</b>			<b>480.0</b>	<b>66.4</b>	<b>33.3</b>	<b>166.7</b>	<b>411.5</b>	<b>174.0</b>	<b>96.2</b>	<b>679.4</b>	<b>2.4</b>

PAINT PAVEMENT MARKING SCHEDULE										
LOCATION US 45	LENGTH	POLYUREA PAVEMENT MARKING		TEMPORARY PAINT PAVEMENT MARKING		SHORT TERM PVMT MK YELLOW	WORK ZONE PAVT' MK REMOVAL	RAISED REFLECTIVE PAVT MKR	RAISED REFLECTIVE PAVT MKR BRIDGE	RAISED REFLECTIVE PAVT MKR REMOVAL
		WHITE	YELLOW	WHITE	YELLOW					
	FT	4"	6"	4"	6"	6"	SQ FT	EACH	EACH	EACH
STA. 1118+68.40 TO 1121+65	296.6	594	80	594	80	30	15	6	1	7
<b>LINE TOTAL</b>		<b>594</b>	<b>80</b>	<b>594</b>	<b>80</b>	<b>30</b>	<b>15</b>	<b>6</b>	<b>1</b>	<b>7</b>

SEEDING & EROSION CONTROL SCHEDULE										
LOCATION	SEEDING CL 2A	TEMPORARY EROSION CONTROL SEEDING	NITROGEN FERTILIZER	PHOSPHORUS FERTILIZER	POTASSIUM FERTILIZER	EROSION CONTROL BLANKET	PERIMETER EROSION BARRIER	TEMPORARY DITCH CHECK	INLET AND PIPE PROTECTION	SODDING
LOCATION	ACRE	POUNDS	POUNDS	POUNDS	POUNDS	SQ YD	FOOT	EACH	EACH	SQ YD
<b>IROQUOIS COUNTY</b>										
NW QUAD	0.02	12	1.8	1.8	1.8	74.4	55		1	35
SW QUAD	0.03	18	2.7	2.7	2.7	72.2	55		1	114
SE QUAD	0.04	24	3.6	3.6	3.6	77.7	140		1	
NE QUAD	0.04	24	3.6	3.6	3.6	94.0	96	1		
<b>LINE TOTAL</b>	<b>0.13</b>	<b>78</b>	<b>11.7</b>	<b>11.7</b>	<b>11.7</b>	<b>318.3</b>	<b>346</b>	<b>1</b>	<b>3</b>	<b>149</b>

EROSION CONTROL SEEDING QUANTITY ALLOWS FOR 6 APPLICATIONS

FILE NAME = c:\projects\ed83886\sheets.dgn	USER NAME = Fergusonso	DESIGNED -	REVISED -	<b>STATE OF ILLINOIS DEPARTMENT OF TRANSPORTATION</b>	<b>SCHEDULE SHEET</b>	F.A.S. RTE. 317	SECTION 36 BR	COUNTY IROQUOIS	TOTAL SHEETS 29	SHEET NO. 6		
PLOT SCALE = 20.0000' / IN.	CHECKED -	REVISED -	SCALE:			SHEET NO. OF SHEETS	STA. TO STA.	STA. 1117+00 TO STA. 1123+00	CONTRACT NO. 66646			
PLOT DATE = Oct 31, 2007 - 03:53:09 PM	DATE -	REVISED -	FED. ROAD DIST. NO. [ILLINOIS] FED. AID PROJECT									

BENCHMARK: TBM  
 CAP BOLT ON TOP FLANGE OF FIRE HYDRANT  
 BETWEEN THE WORDS VILLE & ALA  
 ELEV. 646.48

BENCHMARK R202:  
 USGS DISK NE WINGWALL OF  
 BRIDGE. RESET1977  
 ELEV. 644.36

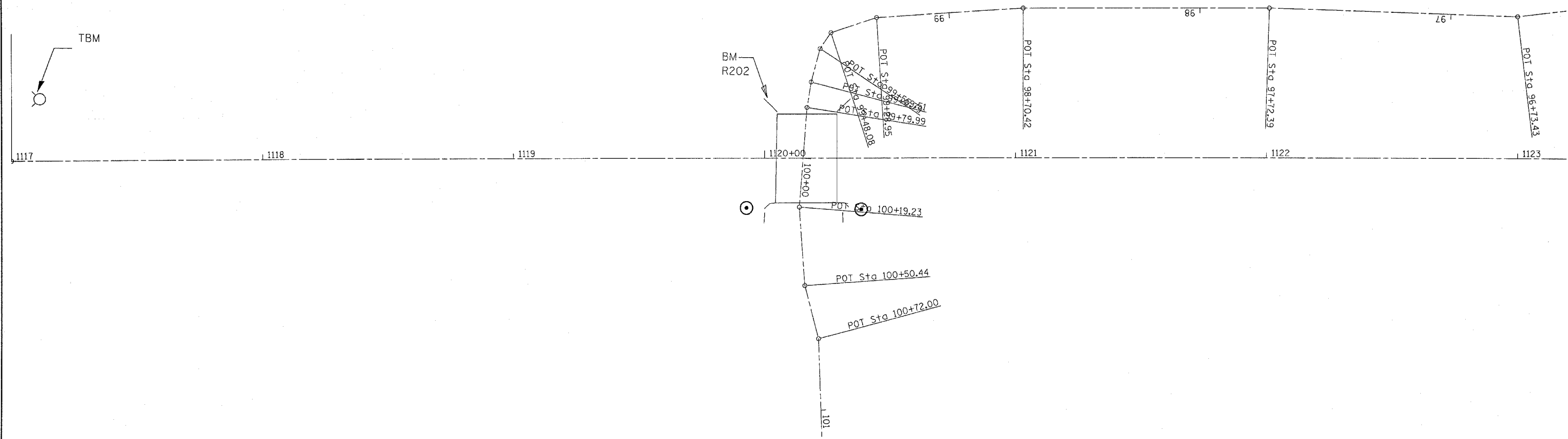

Beginning chain CL\_ROAD description

Point A517 N 1,511,697.6946 E 1,082,303.0858 Sta 1114+00.00

Course from A517 to 517 S 0° 44' 44.43" E Dist 300.0000

Point 517 N 11,397.7200 E 1,082,306.9900 Sta 1117+00.00

Course from 517 to 524 S 0° 44' 44.43" E Dist 700.0093

Point 524 N 1,510,697.7700 E 1,082,316.1000 Sta 1124+00.01

Course from 524 to A524 S 0° 44' 44.43" E Dist 300.0000

Point A524 N 1,510,397.7954 E 1,082,320.0042 Sta 1127+00.01

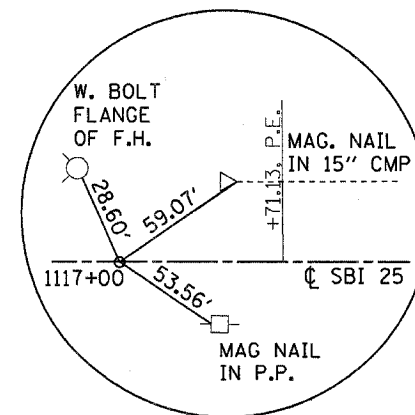

STA. 1117 + 00.00  
 MAG NAIL

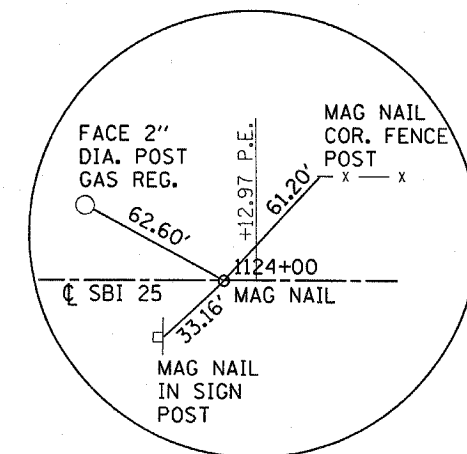

STA. 1124 + 00.00  
 MAG NAIL

FILE NAME =	USER NAME = Fergusonsa	DESIGNED -	REVISED -
ca\projects\ed03806\sheets.dgn		DRAWN -	REVISED -
	PLOT SCALE = 20.0000' / IN.	CHECKED -	REVISED -
	PLOT DATE = Oct 31, 2007 - 03:52:50 PM	DATE -	REVISED -

STATE OF ILLINOIS  
 DEPARTMENT OF TRANSPORTATION

ALIGNMENT SHEET

SCALE: SHEET NO. OF SHEETS STA. TO STA.

F.A.S. RTE.	SECTION	COUNTY	TOTAL SHEETS	SHEET NO.
317	36 BR	IROQUOIS	29	7
STA. 1117+00 TO STA. 1123+00		CONTRACT NO. 66646		
FED. ROAD DIST. NO.		ILLINOIS FED. AID PROJECT		







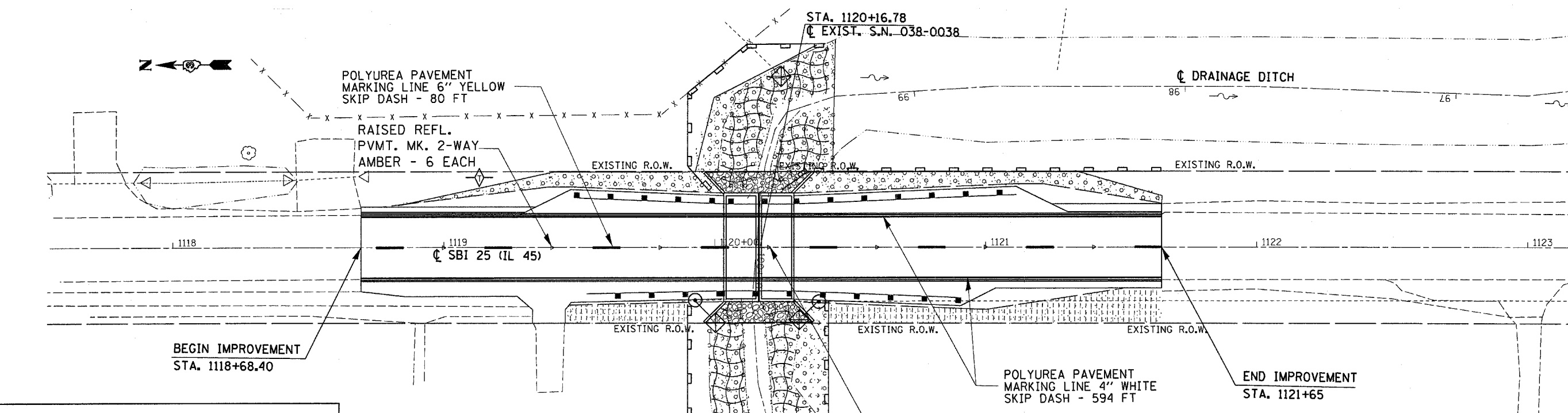
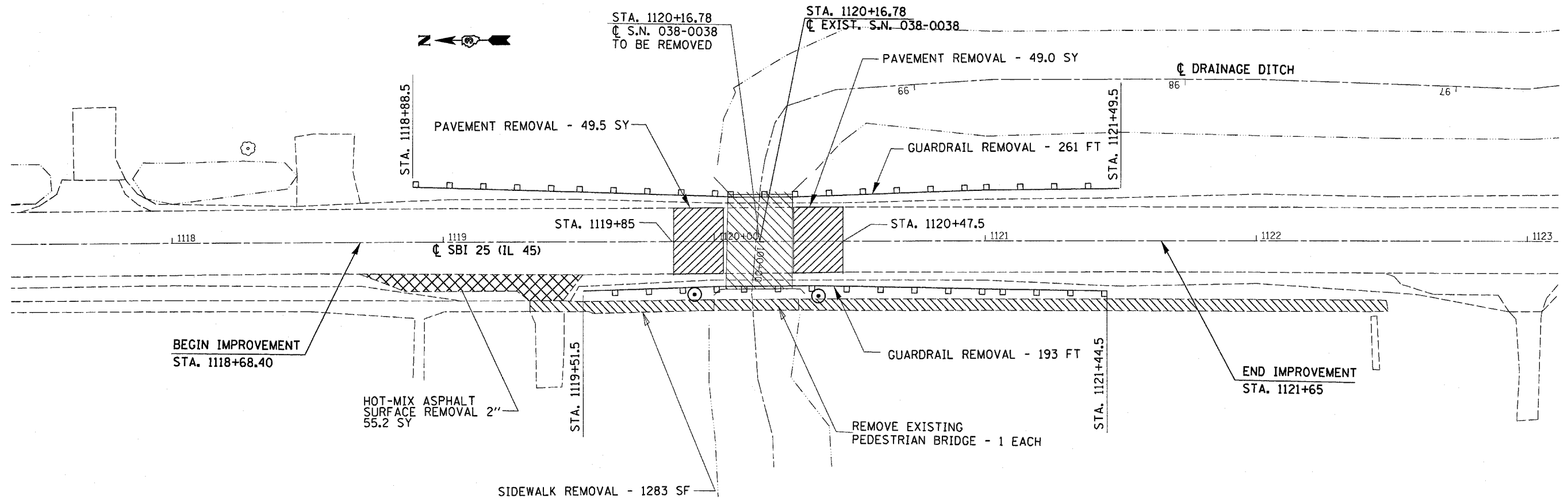



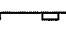

**EROSION CONTROL ITEMS**

- TEMPORARY DITCH CHECK 
- PERIMETER EROSION CONTROL BARRIER 
- INLET AND PIPE PROTECTION 
- TEMPORARY EROSION CONTROL SEEDING 

**LANDSCAPING LEGEND**

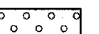
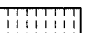
- EROSION CONTROL BLANKET 
- SEEDING CLASS 2A 
- SODDING 

FILE NAME = c:\projects\ed03806\sheets.dgn	USER NAME = ferguson	DESIGNED -	REVISED -	<b>STATE OF ILLINOIS DEPARTMENT OF TRANSPORTATION</b>	<b>REMOVAL AND LANDSCAPING PLAN SHEET</b>	F.A.S. RTE. 317	SECTION 36 BR	COUNTY IROQUOIS	TOTAL SHEETS 29	SHEET NO. 9	
PLOT SCALE = 20,000' / IN.	DRAWN -	REVISED -	SCALE: _____			SHEET NO. _____	OF _____	SHEETS _____	STA. _____	TO STA. _____	CONTRACT NO. 66646
PLOT DATE = Oct 31, 2007 - 03:52:35 PM	CHECKED -	REVISED -	FED. ROAD DIST. NO. [ILLINOIS] FED. AID PROJECT								
DATE -	DATE -	REVISED -									

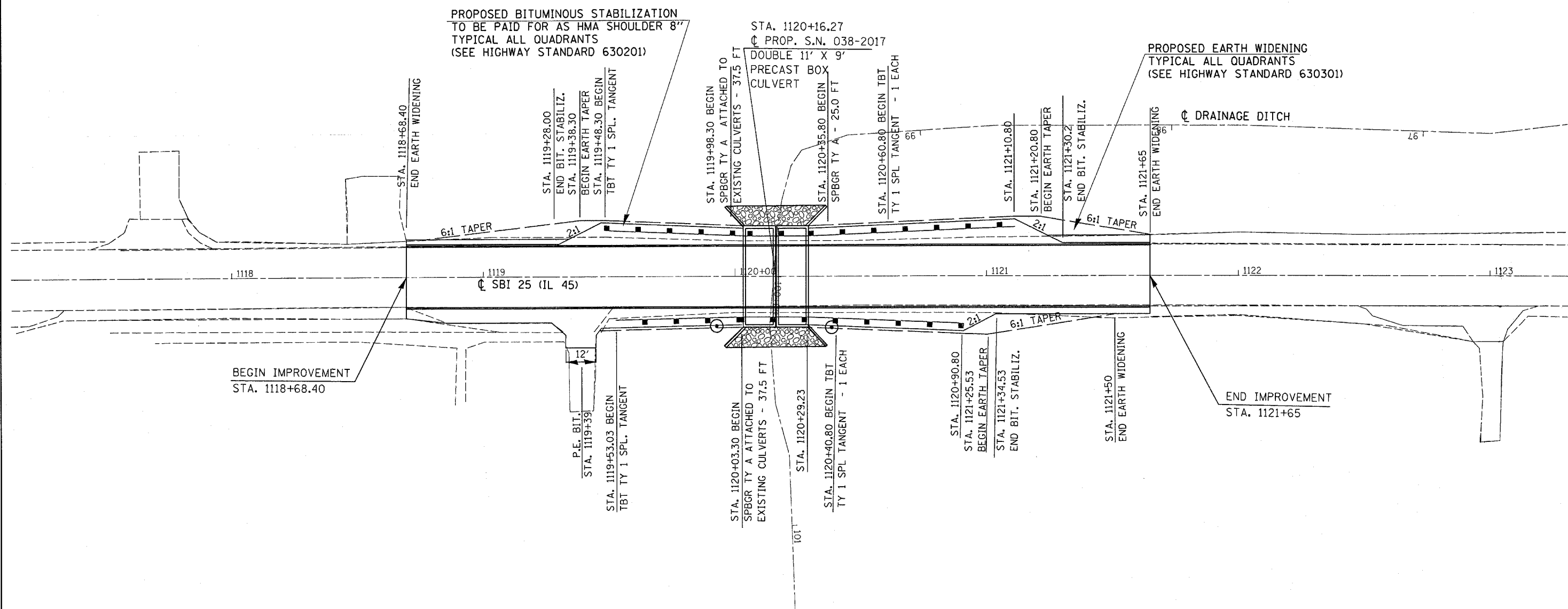

STA. 1120+16.27  
PROP. S.N. 038-2017  
DOUBLE 11' X 9'  
PRECAST BOX  
CULVERT

PROPOSED EARTH WIDENING  
TYPICAL ALL QUADRANTS  
(SEE HIGHWAY STANDARD 630301)

BEGIN IMPROVEMENT  
STA. 1118+68.40

END IMPROVEMENT  
STA. 1121+65

FILE NAME = c:\projects\ed23886\sheets.dgn	USER NAME = Fergusonse	DESIGNED -	REVISED -	<b>STATE OF ILLINOIS</b> <b>DEPARTMENT OF TRANSPORTATION</b>	<b>GUARDRAIL PLAN SHEET</b>	F.A.S. RTE. 317	SECTION 36 BR	COUNTY IROQUOIS	TOTAL SHEETS 29	SHEET NO. 10
	PLDT SCALE = 20,0000' / IN.	DRAWN -	REVISED -			STA. 1117+00 TO STA. 1123+00	CONTRACT NO. 66646			
	PLDT DATE = Oct 31, 2007 - 03:52:44 PM	CHECKED -	REVISED -			FED. ROAD DIST. NO. ILLINOIS	FED. AID PROJECT			
	DATE -	REVISED -		SCALE:	SHEET NO. OF SHEETS STA. TO STA.					



**PARCEL 3UU0001**

**JAMES W. SCHNURR, et ux.**

TOTAL HOLDING = 1.841 AC.±  
 TEMPORARY EASEMENT = 0.055 AC.± (2,392 SQ.FT.)  
 PURPOSE: GRADING FOR DRAINAGE

**PARCEL 3UU0002**

**BEVERLY ANN KUIPERS**

TOTAL HOLDING = 80.485 AC.±  
 TEMPORARY EASEMENT = 0.055 AC.± (2,389 SQ.FT.)  
 PURPOSE: GRADING FOR DRAINAGE

I VINCENT D. BRANDOW, HEREBY CERTIFY THAT I AM A PROFESSIONAL LAND SURVEYOR OF THE STATE OF ILLINOIS, THAT THE SURVEY OF PROPOSED F.A.S. 317 (U.S. 45) WAS MADE BY RENWICK & ASSOCIATES, INC. UNDER MY DIRECTION, AND THAT THE SURVEY IS TRUE AND COMPLETE AS SHOWN TO THE BEST OF MY KNOWLEDGE AND BELIEF, THAT ALL MONUMENTS AND MARKS ARE OF THE CHARACTER AND OCCUPY THE POSITION SHOWN THEREON, AND ARE SUFFICIENT TO ENABLE THE SURVEY TO BE RETRACED. THIS PROFESSIONAL SERVICE CONFORMS TO THE CURRENT ILLINOIS MINIMUM STANDARDS FOR A BOUNDARY SURVEY.

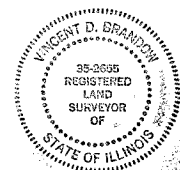

*Vincent D. Brandow*  
 ILLINOIS PROFESSIONAL LAND SURVEYOR  
 NO. 2655

NOTE: BEARINGS ARE REFERENCED TO AN ASSUMED NORTH

SCALE 1" = 50'

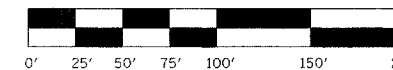

**RIGHT OF WAY PLANS**

ROUTE	FAS 317 (U.S. 45)
SECTION	36BR
PROJECT	
COUNTY	IROQUOIS
JOB NUMBER	R-93-012-07
STATION	1118+00 TO 1124+50
SHEET	11 OF 29 SCALE 1" = 50'

NOTE: EXISTING RIGHT OF WAY LINES ESTABLISHED PER IDOT SURVEY BOOK #245 DATED 8-2-1921

DATE: 7-25-2007

SURVEY BOOK NO. \_\_\_\_\_

11-30-08

EXPIRATION DATE

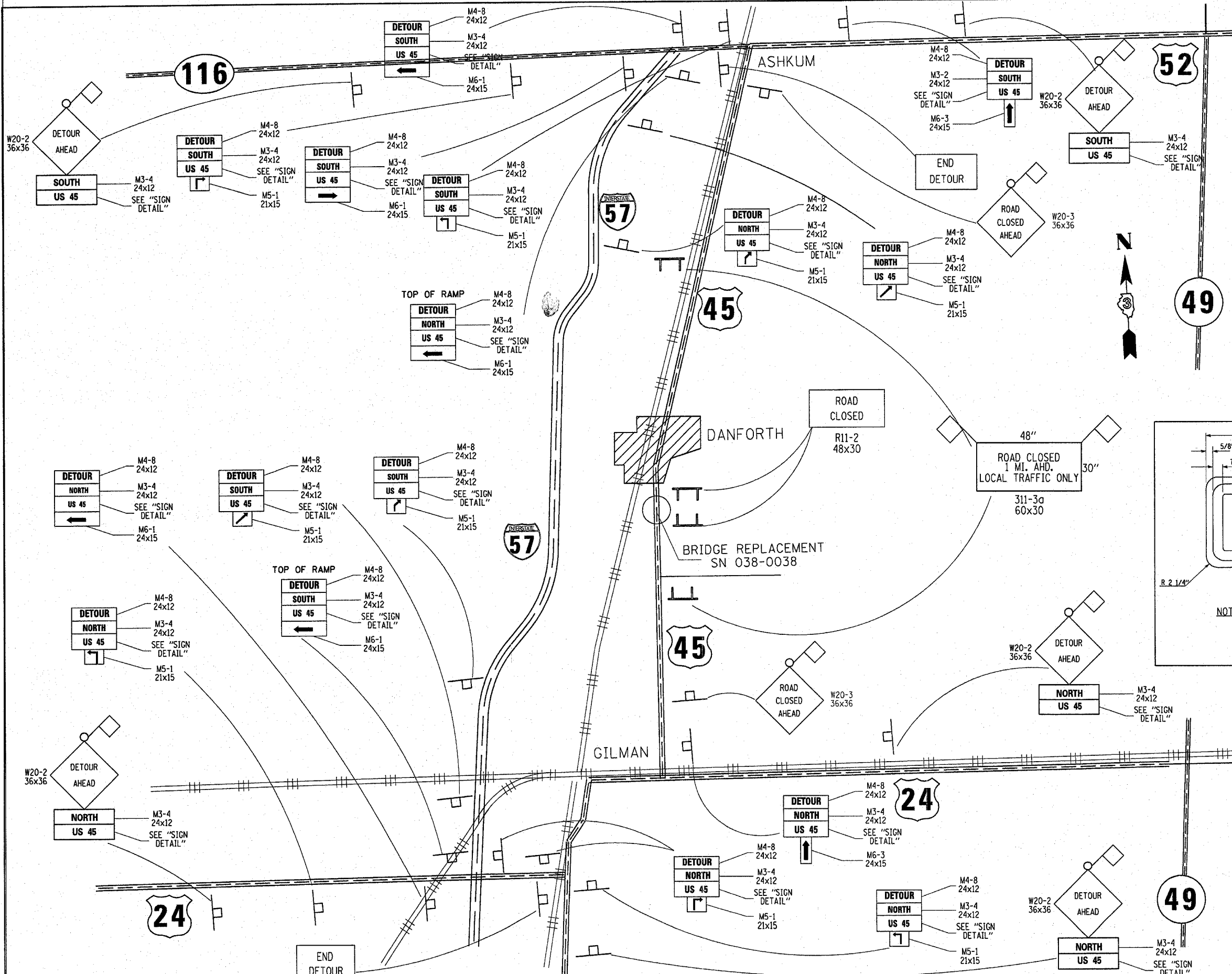

- GENERAL NOTES:**
- 1.) ONLY SIGNS THAT ARE TO BE ADDED ARE SHOWN ON THIS MAP.
  - 2.) ALL SIGNS TO BE POST MOUNTED.
  - 3.) CONTRACTOR IS RESPONSIBLE FOR MAINTAINING ALL SIGNAGE AT ALL TIMES.
  - 4.) WORK SHALL BE DONE IN ACCORDANCE WITH BRL-21
  - 5.) DETOUR SIGNS SHALL BE COVERED WHEN NOT IN USE.
  - 6.) ALL SIGNS WILL BE SUPPLIED AND INSTALLED BY THE CONTRACTOR.
  - 7.) ALL SIGNS SHALL HAVE TYPE A FLASHING LIGHT.
  - 8.) DETOUR CONFIRMATION SIGNING SHALL BE WITHIN 1000 FT. OF THE INTERCHANGE.
  - 9.) COVER ALL CONFLICTING ROUTE MARKER SIGNS.

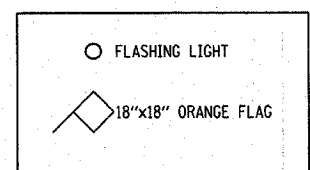
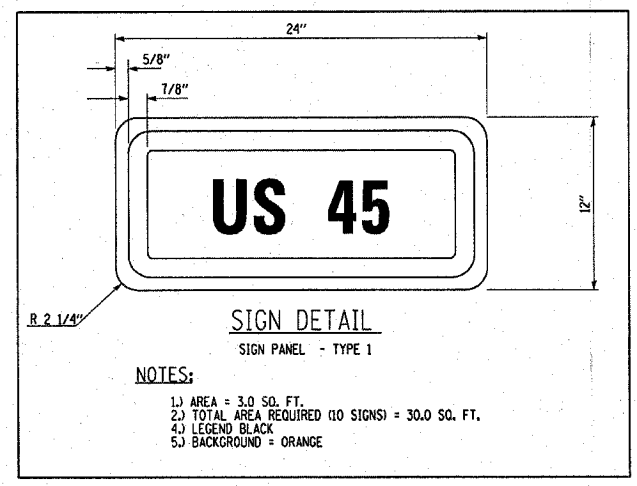

FILE NAME = c:\proje\cta\ed\3885\sheeta.dgn	USER NAME = Fergusonse	DESIGNED -	REVISED -
		DRAWN -	REVISED -
		CHECKED -	REVISED -
		DATE -	REVISED -

**STATE OF ILLINOIS  
DEPARTMENT OF TRANSPORTATION**

**DETOUR PLAN**

SCALE: SHEET NO. OF SHEETS STA. TO STA.

F.A.S. RTE.	SECTION	COUNTY	TOTAL SHEETS	SHEET NO.
317	36 BR	IROQUOIS	29	12
STA. 1117+00 TO STA. 1123+00			CONTRACT NO. 66646	
FED. ROAD DIST. NO. ILLINOIS FED. AID PROJECT				

B.M. - USGS Disk on top of N.E. wingwall, R202 Elev. 644.36

Existing Structure: SN 038-0038 was originally constructed in 1930. The superstructure was replaced and the substructure was widened in 1977. The superstructure consists of a single span of (8) - 11" PPC Beams on closed abutments. The back-to-back abutments dimension measures 18'-0" while the out-to-out width measures 34'-8". The existing superstructure and substructure shall be removed. A state route detour shall be used during construction of the box culvert.

No salvage

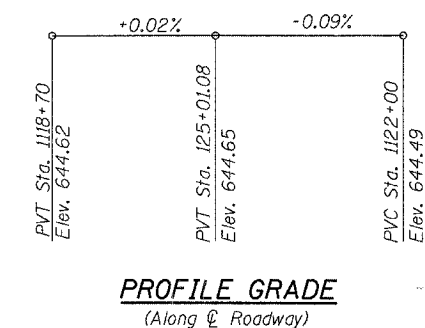
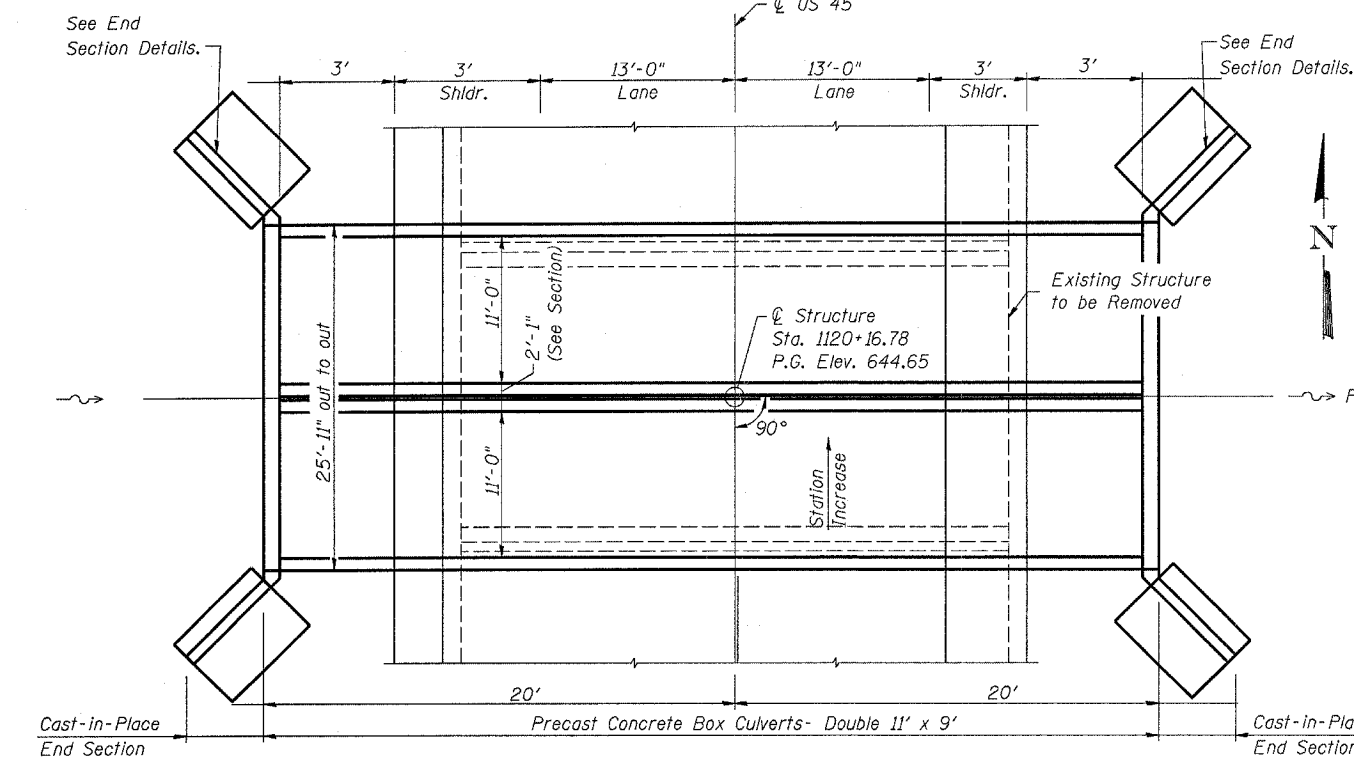
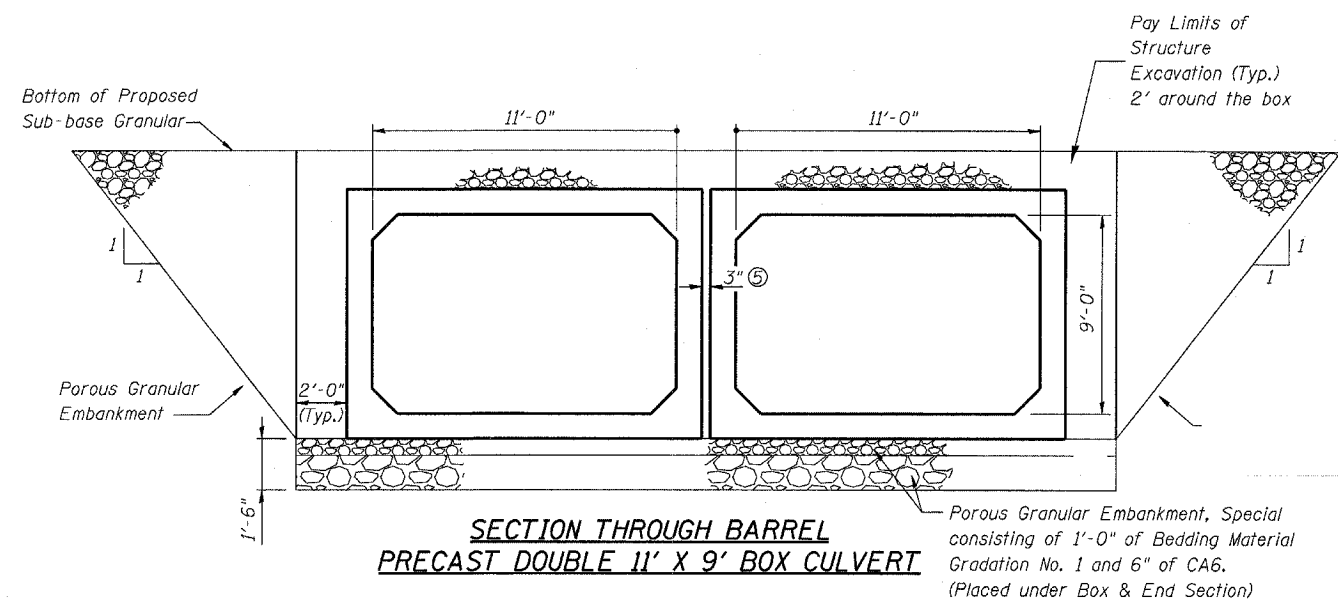
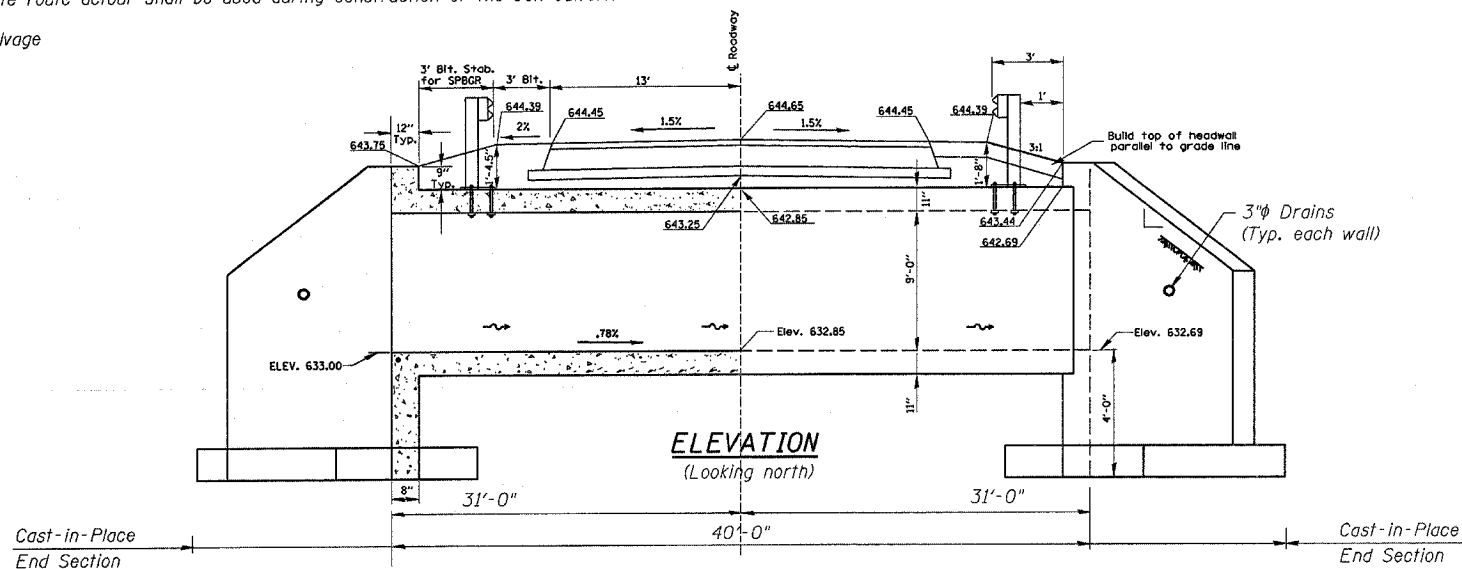

- GENERAL NOTES**
- Precast Concrete Box Culvert sections shall conform to the requirements of Article 540.06 of the Standard Specifications and the applicable requirements of AASHTO M 273.
  - Reinforcement bars shall conform to the requirements of ASTM A 706 Gr 60 (IL Modified). See Special Provisions.
  - Reinforcement bars designated (E) shall be epoxy coated.
  - Lifting holes shall be filled with concrete plugs and mastic after box sections are in place.
  - Fill space between boxes with class SI Concrete in accordance with Article 540.06 of the Standard Specifications. Cost included with Precast Concrete Box Culvert 11'x9' (M273).
  - Excavation behind existing abutment walls shall be performed to balance front and back soil pressure before removing the existing superstructure. The Contractor shall sawcut the upper portion of the existing abutment at the stage removal line before Stage 1 removal to ensure the remaining portion will not be prematurely damaged.

**BILL OF MATERIAL**

Item	Unit	Total
Porous Granular Embankment	Cu. Yd.	206.4
Porous Granular Embankment, Special	Cu. Yd.	70.9
Removal of Existing Structures	L. Sum	1
Structure Excavation	Cu. Yd.	358
Concrete Structures	Cu. Yd.	43.6
Reinforcement Bars	Pound	3082
Pedestrian Bridge Removal	Each	1
Precast Concrete Box Culvert 11'x9' (M273)	Foot	80
Name Plates	Each	1
Reinforcement Bars (Epoxy Coated)	Pound	1001

**DESIGN SPECIFICATIONS**

1996 AASHTO with 1997 thru 2002 Interims

**LOADING HS20-44**

Allow 50#/sq. ft. for future wearing surface.

Design Fill Height = < 2 ft.

**DESIGN STRESSES**

Precast  
 $f'_c = 3500$  psi  
 $f_y = 65,000$  psi (welded wire fabric)  
 Cast-In-Place  
 $f'_c = 3,500$  psi  
 $f_y = 60,000$  psi (reinforcement)  
 Max. Soil Pressure under footing = 2466 psf

**GENERAL PLAN**

**US45 OVER PRAIRIE CREEK  
 FAS ROUTE 317 - SECTION 36BR  
 IROQUOIS COUNTY  
 STATION 1120+16.78  
 PROP. S.N. 038-2017**

**WATERWAY INFORMATION**

Drainage Area = 3.12 sq. mi. Low Grade Elev. 644.48 @ Sta. 1121+50

Flood	Freq. Yr.	Q C.F.S.	Opening Sq. Ft.		Head - Ft.		Headwater El.		
			Exist.	Prop.	H.W.E. Exist.	Prop.	Exist.	Prop.	
Design	10	330	77	139	639.3	0.3	0.2	639.6	639.4
Design	50	484	105	165	640.5	0.5	0.4	641.0	640.9
Base	100	545	115	174	640.9	0.5	0.5	641.4	641.4
Overtopping									
Max. Calc.	500	688	134	191	641.7	0.8	0.8	642.5	642.5

Prop. Low Grade El. = 644.48 @ Sta. 1121+50.  
 10-year velocity through exist. struct. = 4.0 fps  
 10-year velocity through prop. struct. = 2.40 fps

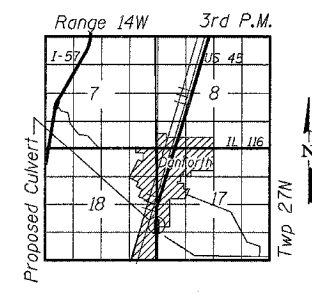
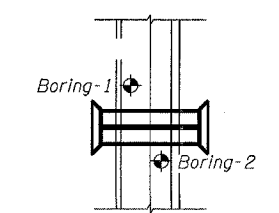

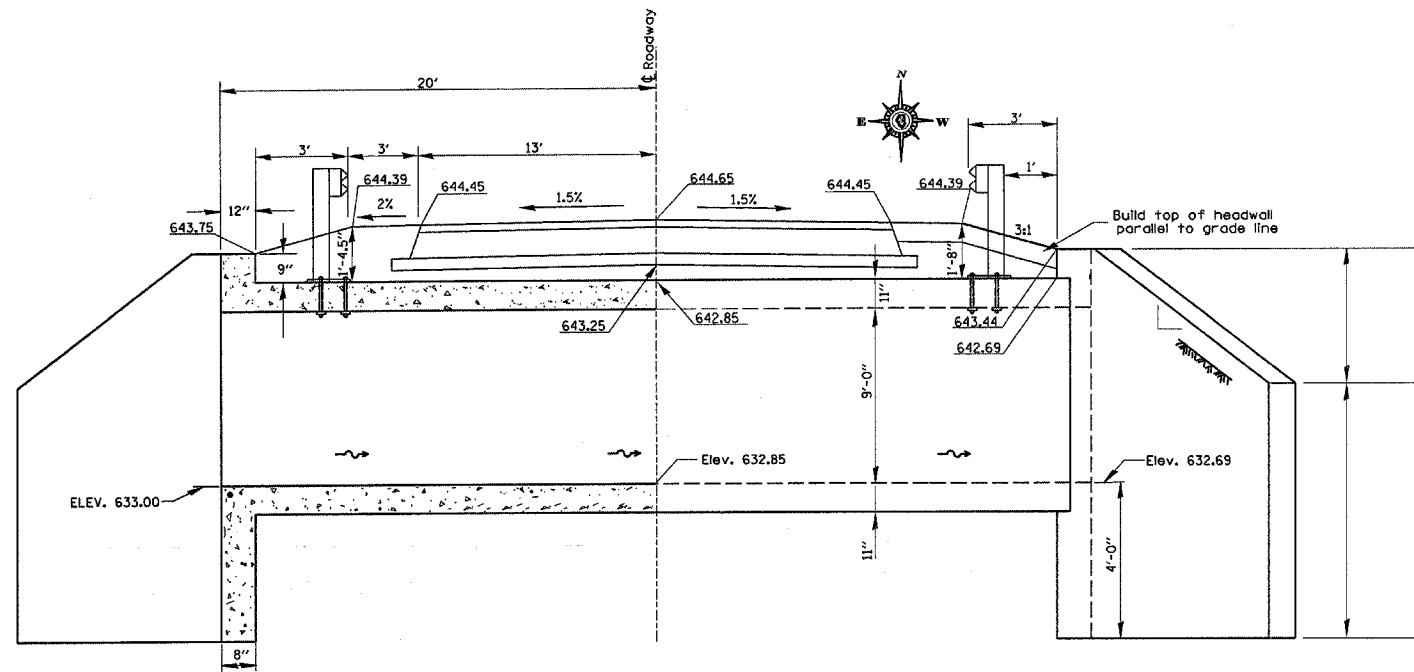

**SECTION THROUGH PRECAST BOX CULVERT**

SPAN, FEET	T <sub>T</sub> , INCHES		T <sub>B</sub> , INCHES		T <sub>S</sub> , INCHES	
	M 259	M 273	M 259	M 273	M 259	M 273
3	4	7	4	6	4	4
4	5	7 1/2	5	6	5	5
5	6	8	6	7	6	6
6	7	8	7	7	7	7
7	8	8	8	8	8	8
8	8	8	8	8	8	8
9	9	9	9	9	9	9
10	10	10	10	10	10	10
11	11	11	11	11	11	11
12	12	12	12	12	12	12

**TYPICAL THICKNESSES**

MINIMUM COVER FOR BOX CULVERTS SHALL BE 6".

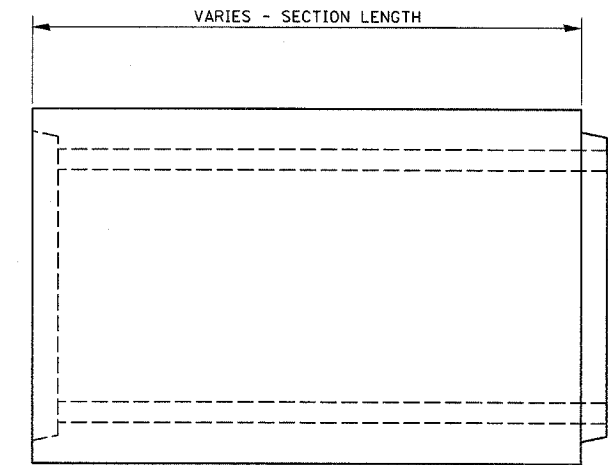

**ELEVATION**

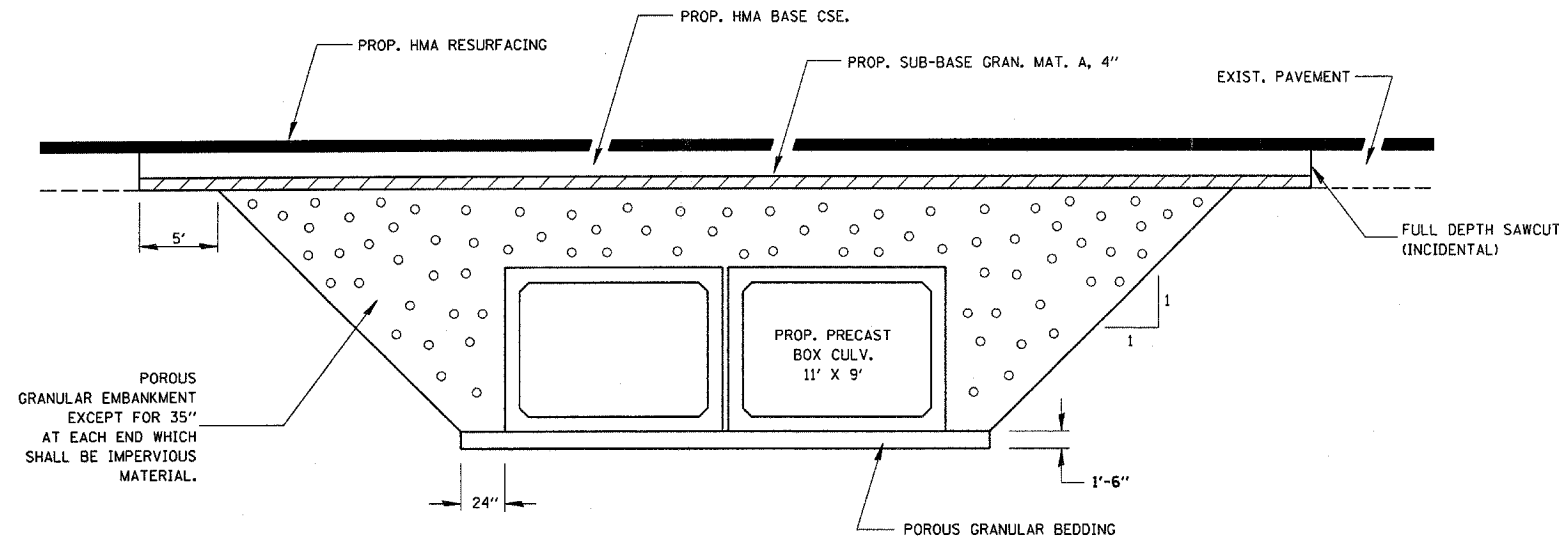

**SECTION THROUGH PRECAST BOX CULVERT**

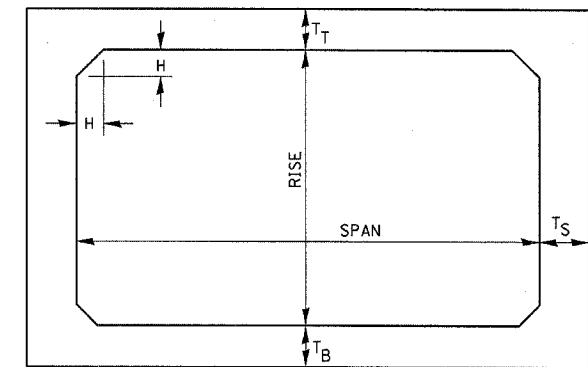

NOTE: THE HAUNCH DIMENSION H, IS EQUAL TO THE WALL THICKNESS T<sub>S</sub>.

**TYPICAL BOX SECTION**

**GENERAL PLAN**  
**US45 OVER PRAIRIE CREEK**  
**FAS ROUTE 317 - SECTION 36BR**  
**IROQUOIS COUNTY**  
**STATION 1120+16.78**  
**PROP. S.N. 038-2017**

FILE NAME = c:\projects\led\3806\sheet.dgn	USER NAME = ferguson	DESIGNED -	REVISED -	<b>STATE OF ILLINOIS DEPARTMENT OF TRANSPORTATION</b>	<b>CULVERT SHEET</b>	F.A.S. RTE. 317	SECTION 36 BR	COUNTY IROQUOIS	TOTAL SHEETS 29	SHEET NO. 14	
PLOT SCALE = 20.0000 / IN.	CHECKED -	REVISED -	REVISED -			SCALE:	SHEET NO. OF SHEETS	STA. TO STA.	CONTRACT NO. 66646		
PLOT DATE = Oct 31, 2007 - 03:53:52 PM	DATE -	REVISED -	REVISED -			FED. ROAD DIST. NO. ILLINOIS FED. AID PROJECT					



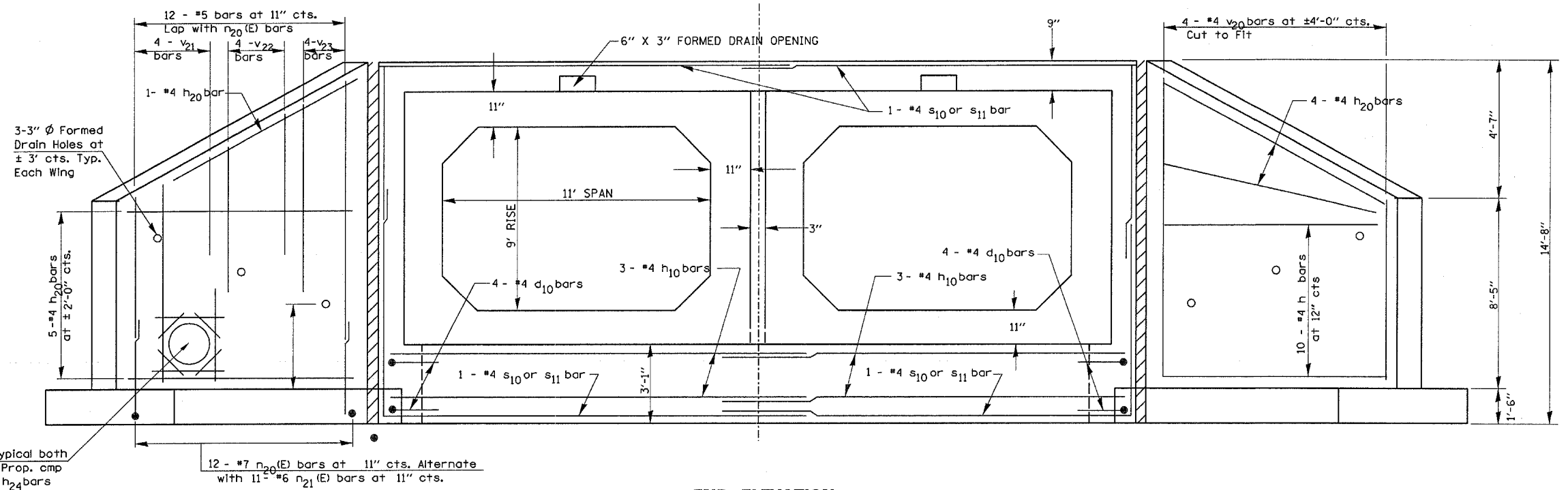

**END ELEVATION**

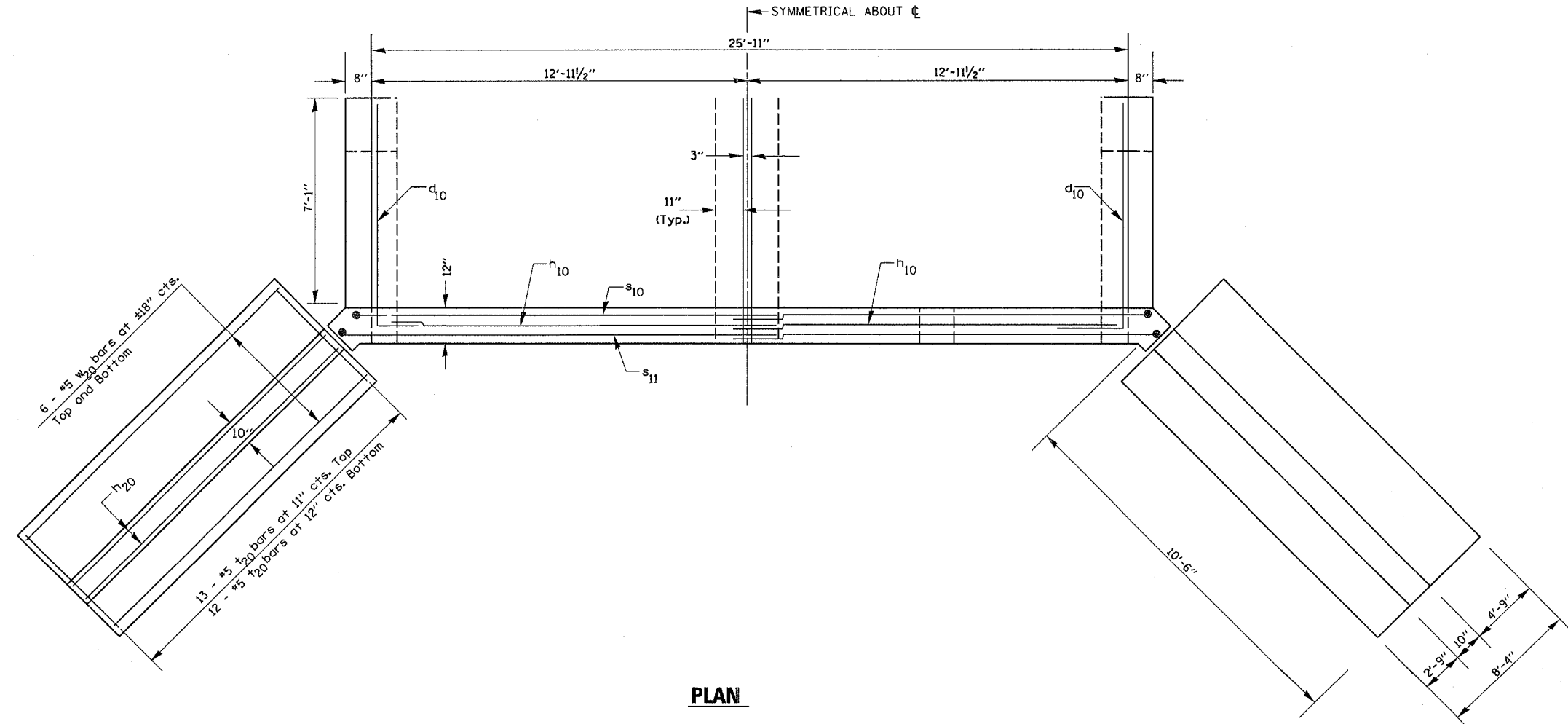

**PLAN**

**GENERAL PLAN**  
**US45 OVER PRAIRIE CREEK**  
**FAS ROUTE 317 - SECTION 36BR**  
**IROQUOIS COUNTY**  
**STATION 1120+16.78**  
**PROP. S.N. 038-2017**

FILE NAME = c:\projects\ed03806\sheeta.dgn	USER NAME = ferguson	DESIGNED -	REVISED -	STATE OF ILLINOIS DEPARTMENT OF TRANSPORTATION	CULVERT SHEET	F.A.S. RTE. 317	SECTION 36 BR	COUNTY IROQUOIS	TOTAL SHEETS 29	SHEET NO. 15
	PLOT SCALE = 20,000 / IN.	DRAWN -	REVISED -			SCALE:	SHEET NO. OF SHEETS STA. TO STA.	FED. ROAD DIST. NO. ILLINOIS	FED. AID PROJECT	CONTRACT NO. 66646
PLOT DATE = Oct 31, 2007 - 03:53:36 PM	CHECKED -	DATE -	REVISED -							

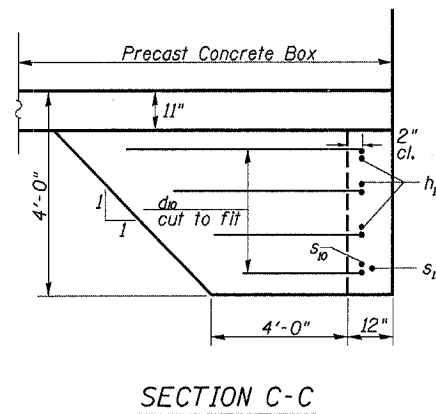
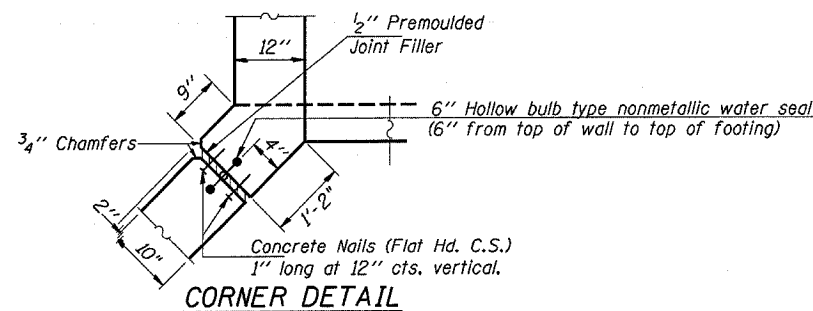
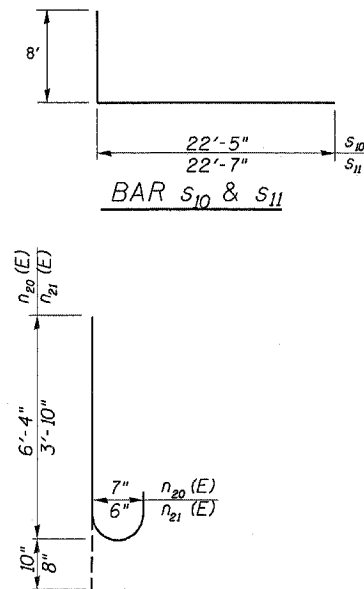
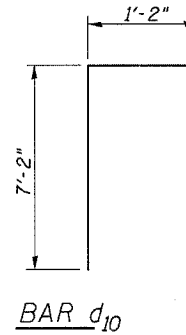
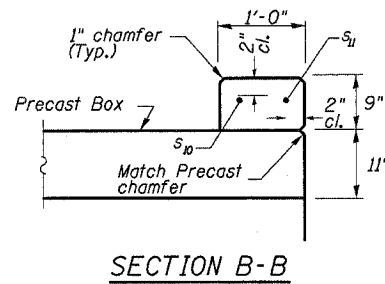
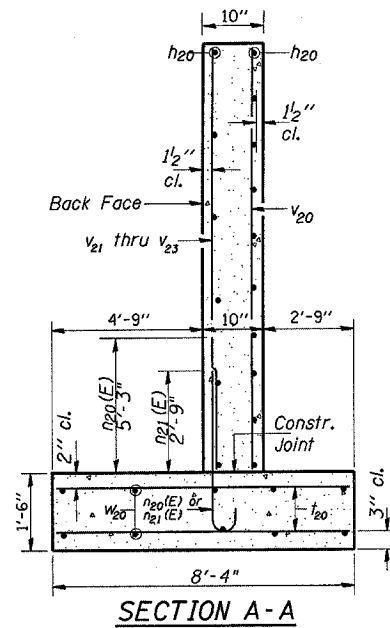

BARS n20(E) & n21(E)

Min. Bar Laps  
 #4 = 1'-8"  
 #5 = 2'-2"  
 #6 = 2'-7"  
 #7 = 3'-5"

BILL OF MATERIAL				
BAR	SIZE	NO.	LENGTH	SHAPE
d6	4	16	8'-4"	—
n20(E)	7	48	7'-2"	—
n21(E)	6	44	4'-6"	—
h10	4	12	14'-7"	—
h20	4	80	10'-2"	—
n24	4	16	1'-6"	—
s10	4	8	23'-2"	—
s11	4	8	23'-4"	—
V20	4	12	12'-8"	—
V21	5	16	6'-6"	—
V22	5	16	8'-0"	—
V23	5	16	9'-6"	—
t20	5	100	8'-0"	—
w20	5	48	10'-0"	—
CONCRETE STRUCTURES			C.Y.	43.6
REINFORCEMENT BARS			LBS.	1001
REIN. BARS (EPOXY CTD.)			LBS.	3082

**NOTES**

Reinforcement Bars shall conform to the requirements of AASHTO M-31, M-42 or M-53, Grade 60.  
 Bars indicated thus 12 x 4-#5 etc. indicates 12 lines of bars with 4 lengths per line.  
 Reinforcement bars designated (E) shall be epoxy coated.  
 All construction joints shall be bonded.

**GENERAL NOTES**

CLASS SI CONCRETE SHALL BE USED THROUGHOUT.  
 EXPOSED EDGES SHALL BE BEVELED 3/4".  
 REINFORCEMENT BARS SHALL CONFORM TO THE REQUIREMENTS OF AASHTO M-31, M-42, OR M-53, GRADE 60.

**GENERAL PLAN**  
**US45 OVER PRAIRIE CREEK**  
**FAS ROUTE 317 - SECTION 36BR**  
**IROQUOIS COUNTY**  
**STATION 1120+16.78**  
**PROP. S.N. 038-2017**

THE CULVERT TIES SHALL BE INCLUDED IN THE COST OF THE CONCRETE PIPE CULVERTS OR THE PRECAST CONCRETE BOX CULVERT. THE MECHANICAL TIES SHALL BE ON THE OUTSIDE OF THE CULVERT. THE NUTS AND WASHERS SHALL BE PLACED ON THE INSIDE OF THE CULVERT AND COVERED WITH MASTIC JOINT SEALER CONFORMING TO ARTICLES 1055 OR 1056 IN THE STANDARD SPECIFICATIONS FOR ROAD AND BRIDGE CONSTRUCTION.

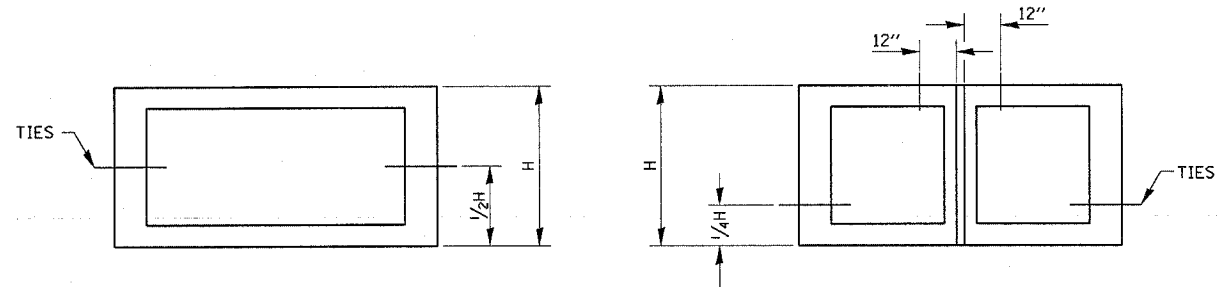

WELD COUPLER TO BOLT

TOP VIEW

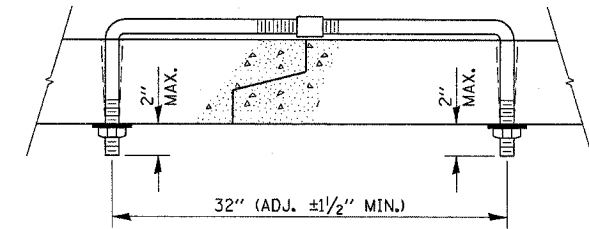

ADJUSTABLE TIE

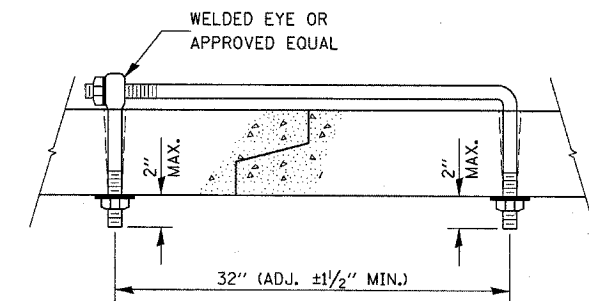

EYE BOLT TIE

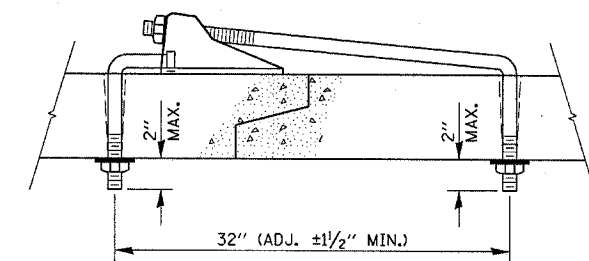

CANOPY TIE

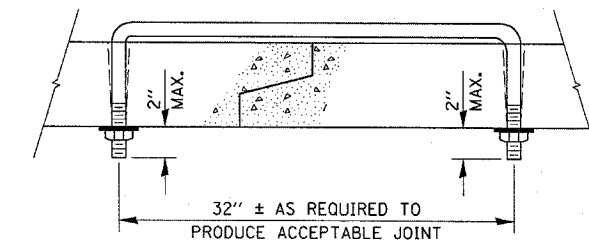

U BOLT TIE

PLACEMENT OF HOLES		
BOX CULVERT FEET	PIPE SIZE INCHES	THREAD DIAMETER INCHES
	12	5/8
	15	ROLLED THREADS (SEE NOTE 4)
	18	
	21	
	24	
	27	
	30	
3 x 2	33	3/4 CUT OR ROLLED
3 x 3	36	
4 x 2	42	
4 x 3	48	
4 x 4	54	
5 x 3	60	1 CUT OR ROLLED
5 x 4	66	
5 x 5	72	
6 x *	78	
7 x *	84	
8 x *	90	
9 x *	96	
10 x *	102	
	108	
	120	
	132	1 1/4
11 x * AND GREATER	138 AND GREATER	

NOTES:

- HOLES SHALL BE CAST-IN OR DRILLED 16" FROM OUTSIDE EDGE OF JOINT.
- NUTS AND WASHERS ARE NOT REQUIRED ON INSIDE OF 27" DIAMETER PIPE OR LESS.
- TIES ARE NOT REQUIRED FOR BELL PIPE 24" AND SMALLER. ON OTHER SIZES TIE MAY BE INSERTED FROM INSIDE.
- CUT THREADS MAY BE USED IF WASHER AND NUT ARE USED.
- PIPE SIZE LISTED IS INSIDE DIAMETER OF ROUND PIPE OR EQUIVALENT DIAMETER OF PIPE ARCH OR ELLIPTICAL.
- GALVANIZING OF TIES IS REQUIRED.

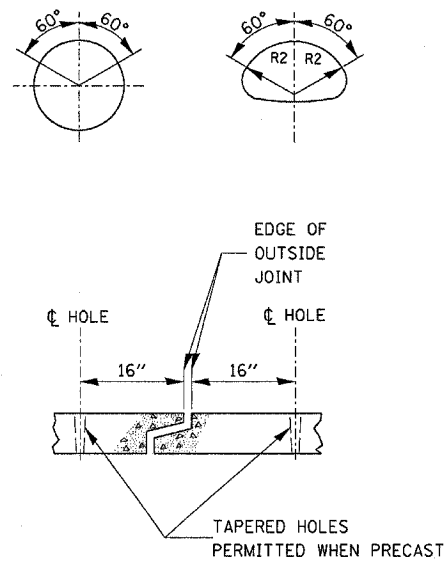



Illinois Department of Transportation  
Division of Highways  
Illinois Department of Transportation

SOIL BORING LOG

Page 1 of 1

Date 2/10/08

ROUTE SBI-25 (IL 45) DESCRIPTION IL 45 over Prairie Creek LOGGED BY Larry Myers

SECTION 36-BR LOCATION SW 14, SEC. 17, TWP. 27N, RNG. 14W

COUNTY Iroquois DRILLING METHOD Hollow Stem Auger HAMMER TYPE CME Automatic

STRUCT. NO.	DEPTH	B	U	M	Surface Water Elev.	DEPTH	B	U	M
Station	HS	W	Qu	S	ft	HS	W	Qu	S
038-0038	1120+17.00				634.19				
#1: NW Quad	1119+88.00								
13.00ft Lt									
644.31									
Augered, white, shoulder stone and black, Silty Clay Loam- fill					Stiff, gray, Silty Clay Till (continued)				
641.81	4				622.31				
Stiff, black, Silty Clay Loam- fill					Medium, gray, Silty Clay Till				
	3	1.3	19.8						
	4	P			wh = weight of the hammer				
639.31	4	1.8	16.3						
Stiff, gray, Silty Clay to Silty Clay Loam- loess									
	5	S							
637.31	2				617.31				
Medium, gray to brown, Silty Clay to Silty Clay Loam- loess					Stiff, gray, Silty Clay Till				
	2	0.7	21.9						
	3	S			wh = weight of the hammer				
634.81	3								
Hard, gray, Silty Clay Loam Till									
	7	4.7	15.4						
	10	S							
	7	7.4	14.3						
	14	S							
	4								
	7	5.6	15.3						
	10	S							
627.31	4				607.81				
Very stiff, gray, Silty Clay Loam Till					End of Boring				
	5	2.7	16.0						
	7	B							
624.81									
Stiff, gray, Silty Clay Till									

The Unconfined Compressive Strength (UCS) Failure Mode is indicated by (B-Bulge, S-Shear, P-Penetrometer)  
The SPT (N value) is the sum of the last two blow values in each sampling zone (AASHTO T206)  
BBS, from 137 (Rev. 8-99)



Illinois Department of Transportation  
Division of Highways  
Illinois Department of Transportation

SOIL BORING LOG

Page 1 of 1

Date 2/10/08

ROUTE SBI-25 (IL 45) DESCRIPTION IL 45 over Prairie Creek LOGGED BY Larry Myers

SECTION 36-BR LOCATION SW 14, SEC. 17, TWP. 27N, RNG. 14W

COUNTY Iroquois DRILLING METHOD Hollow Stem Auger HAMMER TYPE CME Automatic

STRUCT. NO.	DEPTH	B	U	M	Surface Water Elev.	DEPTH	B	U	M
Station	HS	W	Qu	S	ft	HS	W	Qu	S
038-0038	1120+17.00				634.19				
#2: SE Quad	1120+47.00								
13.00ft Lt									
644.44									
Augered, white, shoulder stone and black, Silty Clay to Silty Clay Loam- fill					Medium, gray, Silty Clay Till				
642.44	3				wh = weight of the hammer				
Stiff, black, Silty Clay to Silty Clay Loam- fill									
	2	1.5	21.9						
	4	P							
639.94	2				620.44				
Stiff, gray to brown, Silty Clay- loess					Stiff, gray, Silty Clay Till				
	2	1.7	20.6						
	3	S			wh = weight of the hammer				
	2								
	2	1.7	19.5						
	4	S							
634.94	6				617.31				
Hard, gray, Silty Clay Loam Till					Stiff, gray, Silty Clay Till				
	8	5.4	19.4						
	11	S			wh = weight of the hammer				
632.94	3								
Very stiff, gray, Silty Clay Loam Till									
	5	2.7	14.7						
	7	S							
630.44	2				607.81				
Stiff, gray, Silty Clay Till					End of Boring				
	3	1.2	16.5						
	3	S							
627.94	2								
Medium, gray, Silty Clay Till									
	2	0.7	19.0						
	2	B							

The Unconfined Compressive Strength (UCS) Failure Mode is indicated by (B-Bulge, S-Shear, P-Penetrometer)  
The SPT (N value) is the sum of the last two blow values in each sampling zone (AASHTO T206)  
BBS, from 137 (Rev. 8-99)

FILE NAME = c:\projects\ed03826\borlogs.dgn	USER NAME = ferguson	DESIGNED -	REVISED -	<b>STATE OF ILLINOIS DEPARTMENT OF TRANSPORTATION</b>	<b>SOIL BORING LOGS</b>	F.A.S RTE. 317	SECTION 36 BR	COUNTY IROQUOIS	TOTAL SHEETS 29	SHEET NO. 18		
PLOT SCALE = 1/8" = 1' IN.	CHECKED -	REVISED -	SCALE:			SHEET NO. 1 OF 1 SHEETS	STA. 1117+00 TO STA. 1123+00	CONTRACT NO. 66646		ILLINOIS FED. AID PROJECT		
PLOT DATE = Oct 31, 2007 - 03:56:47 PM	DATE -	REVISED -										

STATE OF ILLINOIS  
DEPARTMENT OF TRANSPORTATION

ROUTE NO.	SECTION	COUNTY	TOTAL SHEETS	SHEET NO.
S.B.I. 25	36 BR	Iroquois	16	8
SHEETS				

B.M. #10 on top N.W. Wingwall 17' Rt. Sta. 1120+02  
Elev. = 100.00  
Existing Structure No. 038-0038, Built as S.B.I.  
Rte. 25, Sec. 36, at Station 1120+17 in 1930.  
The existing R.C. slab superstructure shall be  
removed and the R.C. closed abutment sub-  
structure and Wingwalls rebuilt to accommodate  
the new P.P.C. Slab Beam superstructure.  
Traffic will be detoured during reconstruction.  
Existing steel rail (East side) to be salvaged.  
No other salvags.

GENERAL NOTES

It shall be the responsibility of the Contractor to verify all dimensions and conditions existing in the field prior to construction and ordering of materials.  
The top surface of the beams shall be finished in accordance with Article 505D6 of the Standard Specifications except that the surface shall not be roughened by brooming. The finished surface shall be free of depressions or high spots with sharp corners.  
Expansion bolts shall consist of self drilling expansion anchors and 3/4" x 12" hooked bolts for bonding new concrete to existing concrete.  
Protective Coat shall not be applied to surfaces to which Waterproofing Membrane System is applied.  
Expansion Bolts for temporary bracing shall be 3/4" Hex-headed bolts.  
Reinforcement bars shall conform to the requirements of A.S.T.M. A-307, A-53, Grade 30 unless otherwise specified.

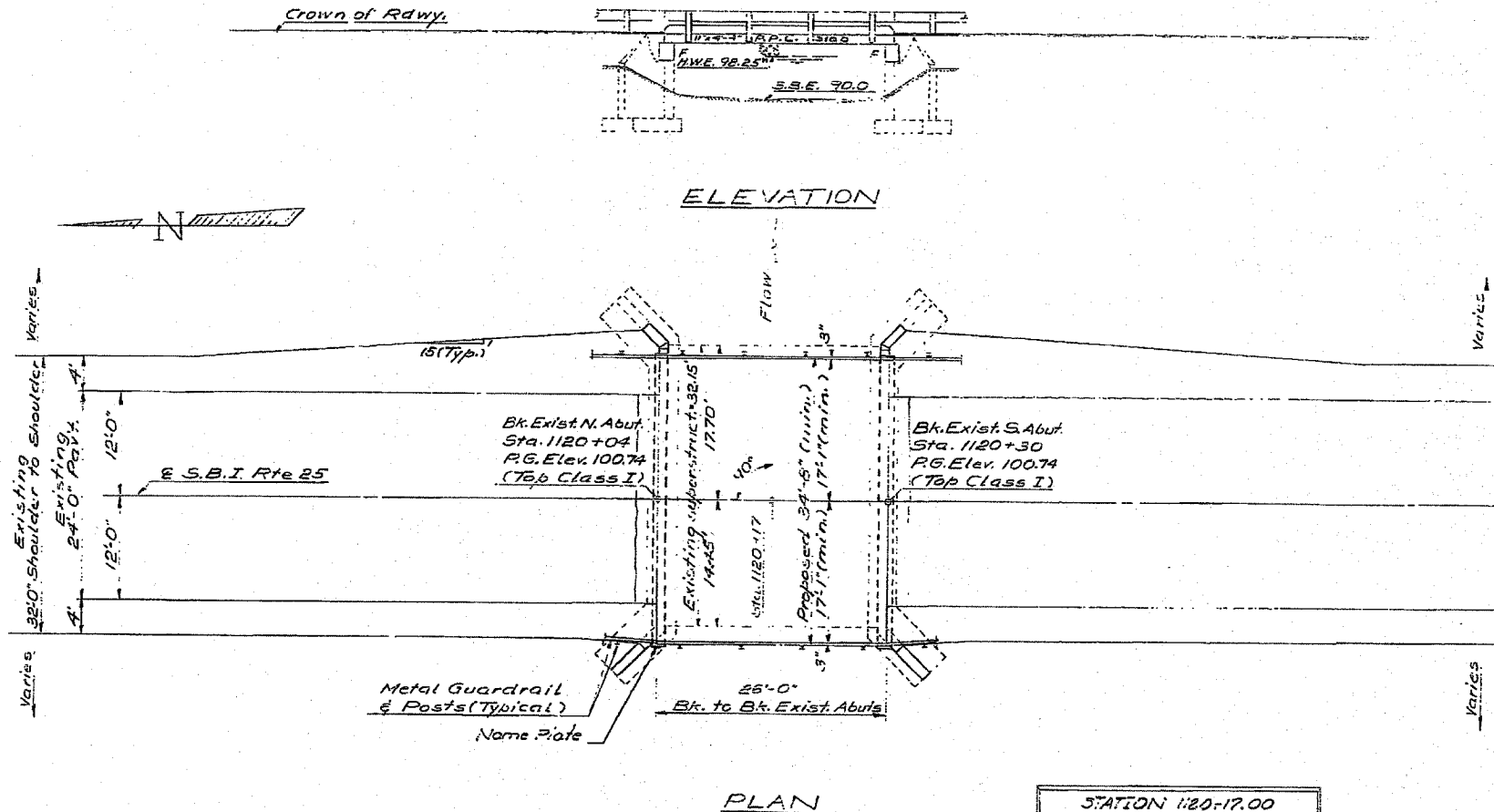

TOTAL BILL OF MATERIAL

ITEM	UNIT	SUPER.	SUB.	TOTAL
Bit. Conc. Surf. Cse. Class I	Sq. Yds.	7		7
Concrete Remova.	Cu. Yds.		4	4
Expansion Bolts (3/4")	Each		58	58
Class X Concrete	Cu. Yds.	1.0	2.0	3.0
Precast Prestressed Conc. Slab 3m (12")	Sq. Ft.	9.3		9.3
Steel Paving Type 5	Sq. Yds.	53		53
Reinforcement Bars	Lbs.	70	1565	1635
Pav. Rem. & P.C. Replace Type 2 (10")	Sq. Yds.	13		13
Removal of Exist. Superstructure	Each			
Waterproofing Membrane Sys.	Sq. Yds.	15		15
Name Plates	Each			
Protective Coat	Sq. Yds.	10		10
Portland Cement Mortar Paving Cse. (1/2")	Sq. Ft.	184		184

\*Does not include expansion bolts for temporary bracing.

STATION 1120+17.00  
REBUILT BY  
STATE OF ILLINOIS  
S.B.I. RTE 25 SEC. 36 BR  
LOADING H 50  
STR. No.

NAME PLATE  
See Sp. 213  
(Structure numbers to be supplied by District.)

DESIGN STRESSES  
PRECAST PRESTRESSED UNITS FIELD UNITS  
fc = 5,000 psi  
fs = 4,000 psi  
fs = 270,000 psi (4' Strands)  
fs = 189,000 psi (2' Strands)  
fc = 3,500 psi  
fy = 60,000 psi  
Loading H S - 20 (New Construction)  
Design Specifications: 1973 AASHTO, 1974, 1975  
1976 Interim Specifications.

WATERWAY INFORMATION  
Drainage Area = 2.6 sq. mi.  
Proposed Opening (below 50% M.W.E.) 143 sq. ft.  
Existing = 143  
Required = 143  
High Water Elev. (50yr) = 98.25  
Created Head (50yr) = 0.2'  
Design Discharge (50yr) = 540 c.f.s.  
High Water Elev. (100yr) = 99.0  
Created Head (100yr) = 0.3'  
Design Discharge (100yr) = 690 c.f.s.

PROPOSED PROFILE & SBIRTE 25  
(Top Class I)  
Sta. 1120+00 Elev. 100.74  
0.00% Sta. Increase  
DESIGNED: J. J. Edmonds  
CHECKED: J. Schneller  
DRAWN: V.H.  
FEBRUARY 27 1977  
APPROVED: [Signature]  
DIRECTOR OF HIGHWAYS

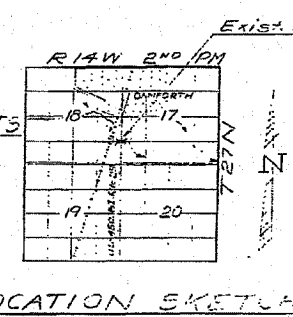

GENERAL PLAN & ELEVATION  
S.B.I. RTE. 25 OVER DRAINAGE  
DISTRICT DITCH  
S.B.I. RTE. 25 SECTION 36 BR  
IROQUOIS COUNTY  
STA. 1120+17.00





STATE OF ILLINOIS  
DEPARTMENT OF TRANSPORTATION

SECTION	NO.	TOTAL SHEETS	SHEET NO.
36 BR	1	2	5

SHEET NO. 5  
OF SHEETS

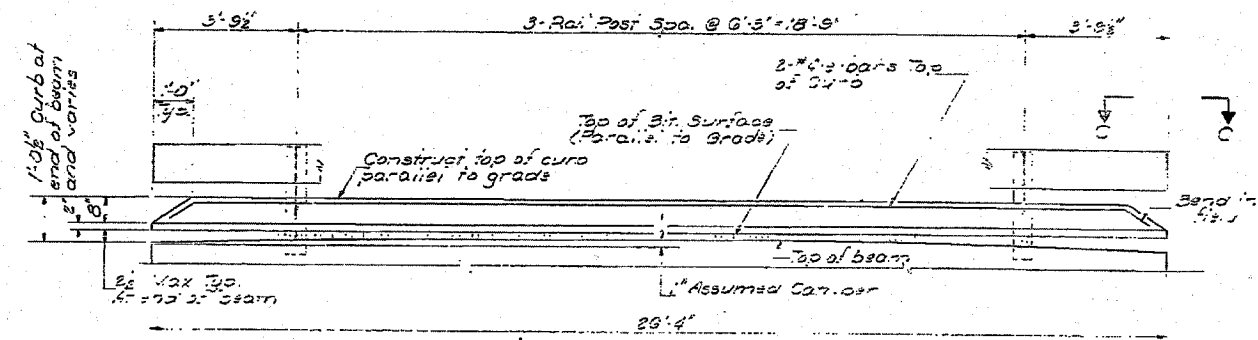

ELEVATION  
(Showing inside face of rail.)

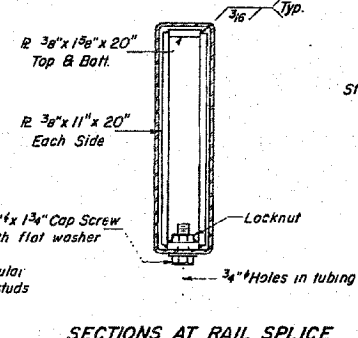
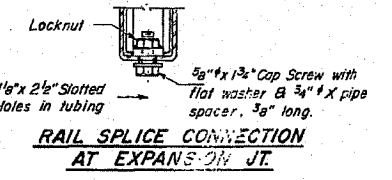
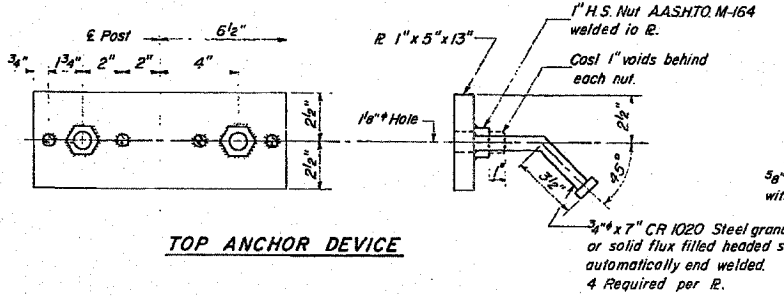
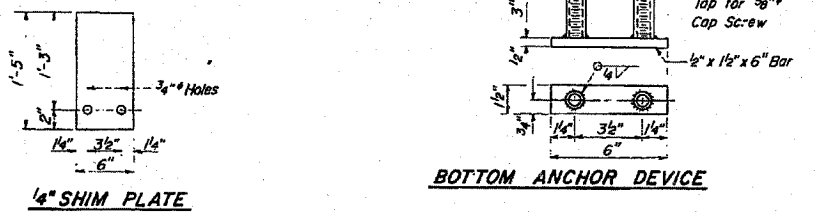
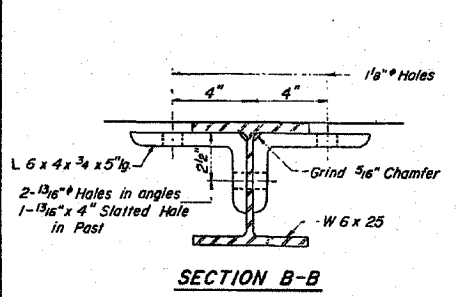
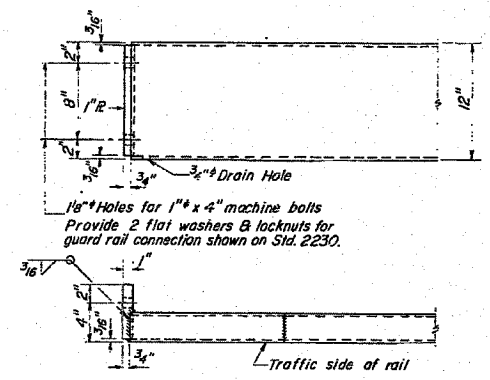
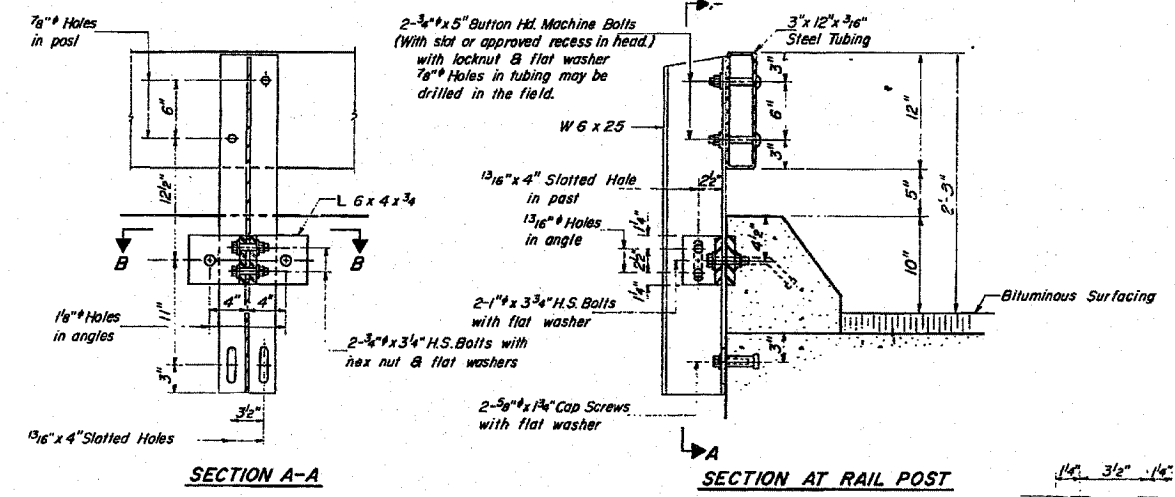

**CURB & RAIL  
BILL OF MATERIAL**

Bar	No.	Size	Length	Shape
e	2	#4	22'-0"	
Reinforcement Bars	Lbs.	75		
Class X Concrete	Cu. Yds.	0.5		
Steel Railing, Type S	Lin. Ft.	25		

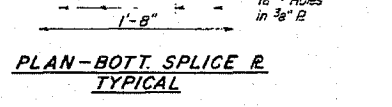

**TYPE S  
STEEL RAILING**  
SEE PLAN SEC. 36 BR  
PROVIDE CURB  
SEE PLAN 36 BR

DESIGNED	J. E. ...	EXAMINED	FEB 22 1977
CHECKED	J. E. ...	PASSED	
DRAWN	J. SCHNEIDER	APPROVED	
CHECKED	J. E. ...	DIRECTOR OF HIGHWAYS	

R-24 B-1-76 (6'-5" Maximum Post Spacing)

STATE OF ILLINOIS  
DEPARTMENT OF TRANSPORTATION

EXISTING BRIDGE PLANS

FILE NAME =  
c:\projects\ed03806\sheet5.dgn

USER NAME = Ferguson	DESIGNED -	REVISED -
PLOT SCALE = 20.0000 / IN.	DRAWN -	REVISED -
PLOT DATE = Nov 01, 2007 - 07:19:59 AM	CHECKED -	REVISED -
	DATE -	REVISED -

SCALE:	SHEET NO. OF SHEETS	STA. TO STA.	F.A.S. RTE.	SECTION	COUNTY	TOTAL SHEETS	SHEET NO.
			317	36 BR	IRROQUOIS	29	21
			STA. 1117+00 TO STA. 1123+00		CONTRACT NO. 66646		
			FED. ROAD DIST. NO. ILLINOIS		FED. AID PROJECT		

STATE OF ILLINOIS  
DEPARTMENT OF TRANSPORTATION

ROUTE NO.	SECTION	COUNTY	TOTAL SHEETS	SHEET NO.
35BR	Iroquois	IL	29	22
SHEETS				

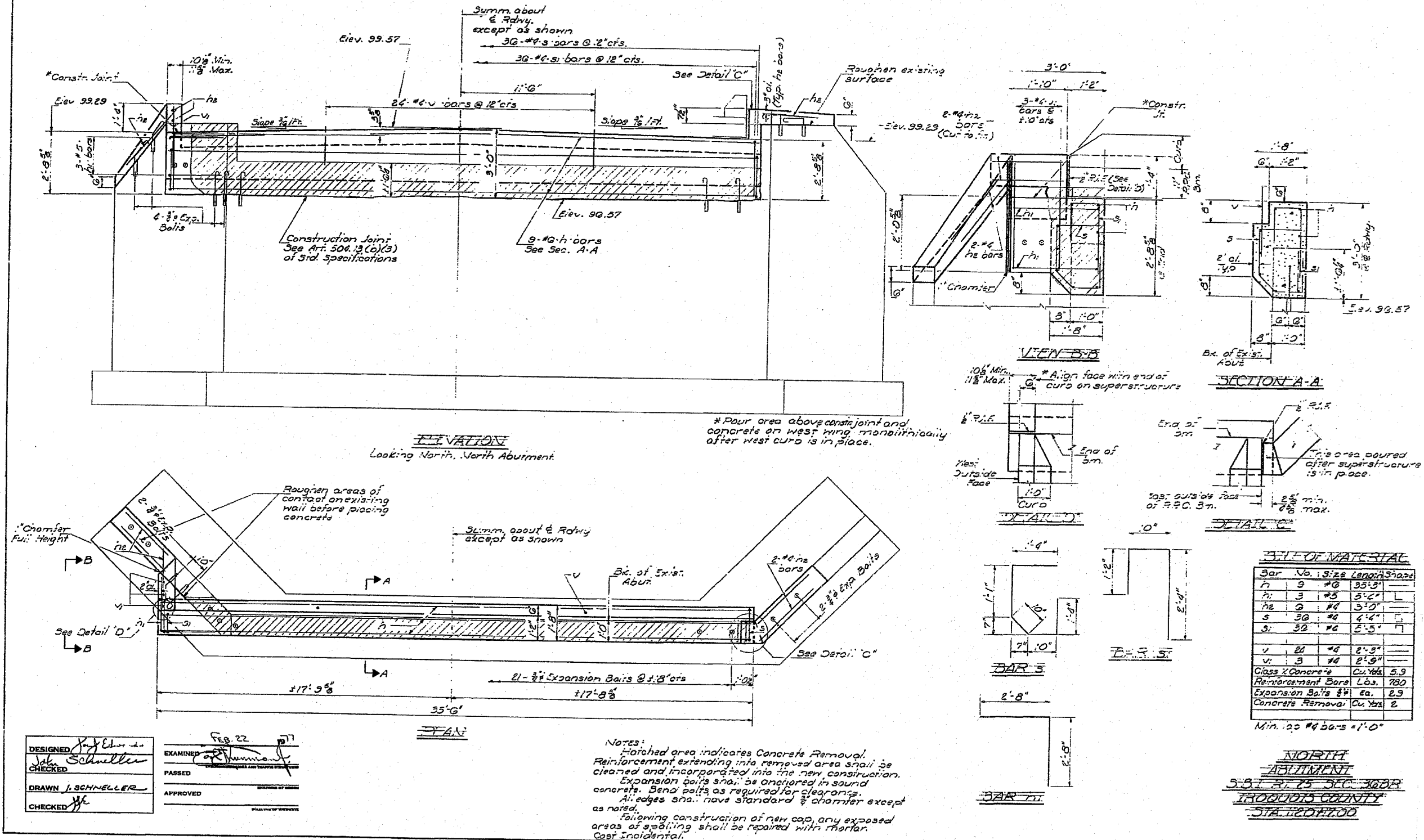

DESIGNED: *[Signature]*  
CHECKED: *[Signature]*  
DRAWN: *[Signature]*  
CHECKED: *[Signature]*

EXAMINED: *[Signature]*  
PASSED: *[Signature]*  
APPROVED: *[Signature]*

FEB. 22 2007



STATE OF ILLINOIS  
DEPARTMENT OF TRANSPORTATION

DATE	BY	CHECKED	TOTAL SHEETS	SHEET NO.
11/25/07	J.E.	J.S.	14	6
PROJECT		SHEET NO.		
36BR Iroquois		11		6 SHEETS

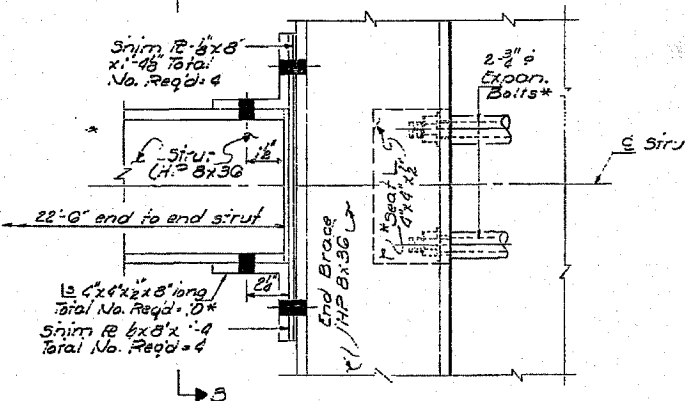
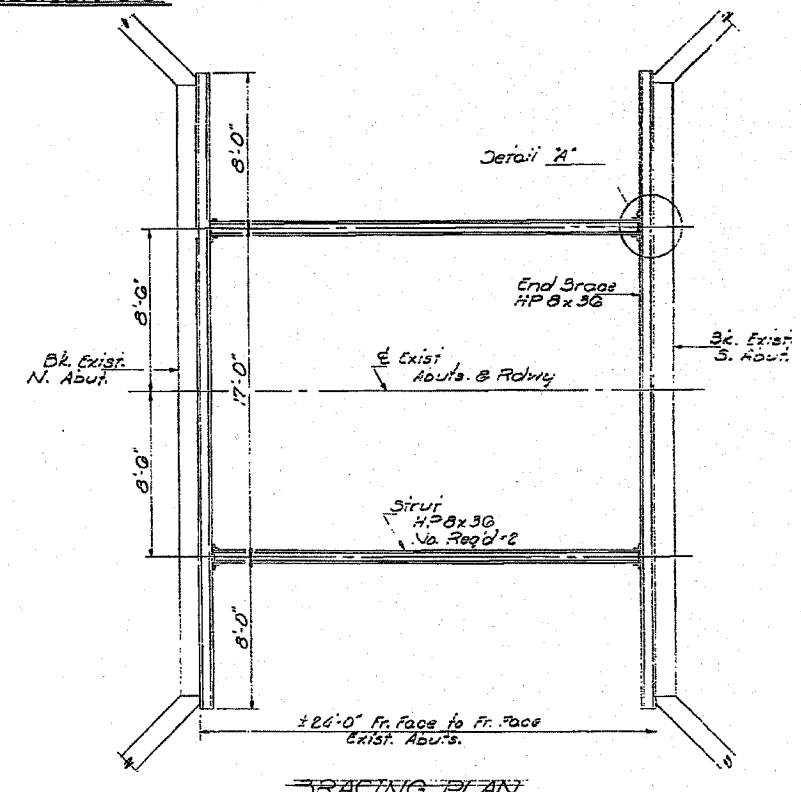
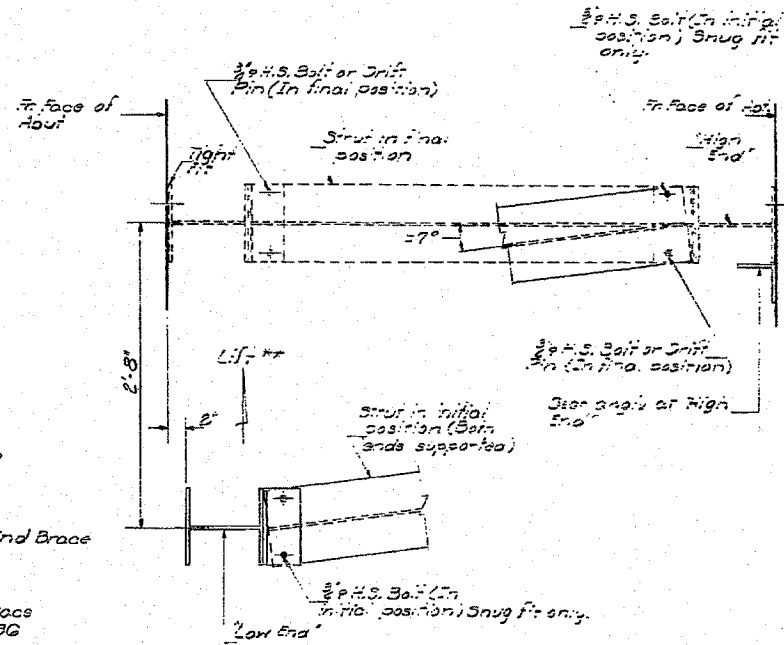
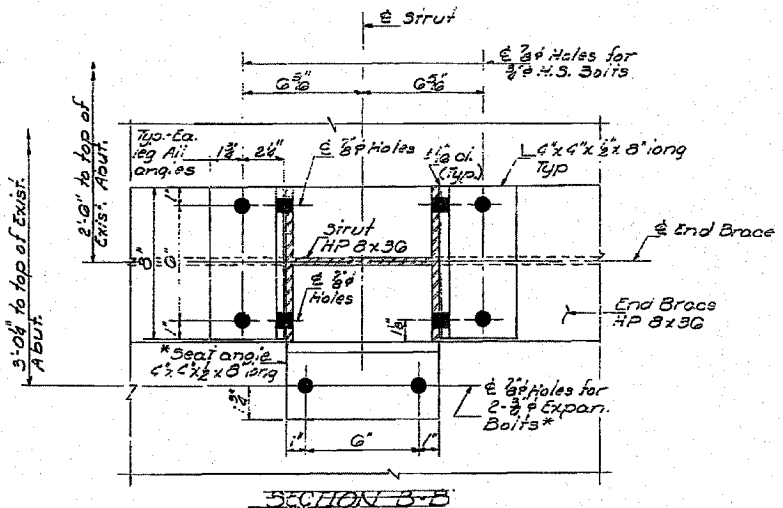
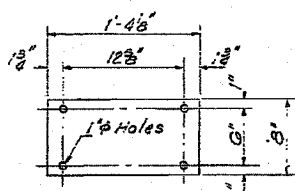
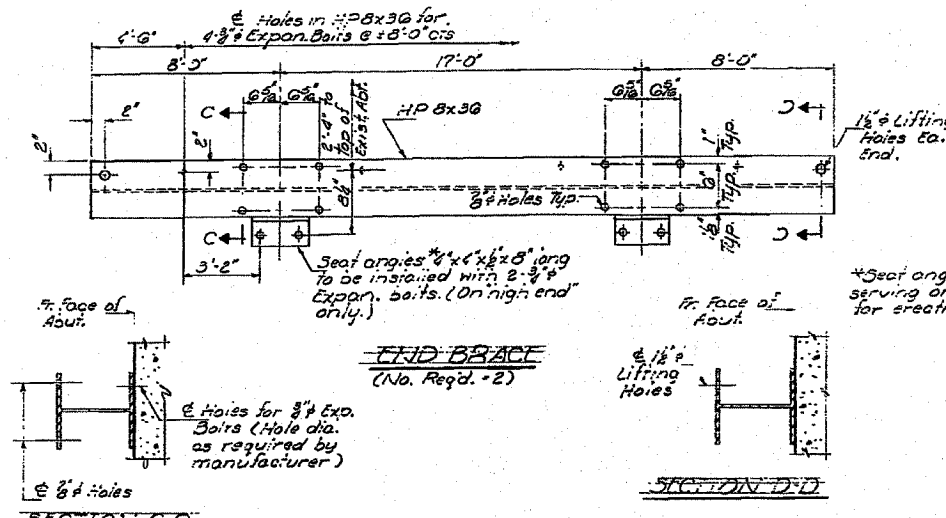

After high end is anchored low end shall continue to be lifted until sirufs are approx. horizontal, and both end braces have a tight contact with abutment faces, then anchor low end, and tighten bolts. Approximate lift required = 1/4" at each end of each brace. (4 total). See Art. 507.04 (1) of Std. Spec. concerning use of drift pins.

NOTES:  
Bracing to be placed prior to removal of existing superstructure, and removed following installation of P.C. Deck Beams.  
All materials shown on this sheet are last incidents to removal of existing superstructure, and shall remain the property of the contractor.  
All expansion bolts shall be anchored in sound concrete. Repair holes with mortar after removal of bolts.  
Contractor may substitute alternative bracing system with the prior written approval of the Engineer.

BRACING DETAILS  
S.B.T. RT-25 SEC. 36BR  
IROQUOIS COUNTY  
STA. 1120+17.00

DESIGNED	J. Edwards	EXAMINED	J. Scheller
CHECKED	J. Scheller	PASSED	J. Scheller
DRAWN	J. SCHNEIDER	APPROVED	J. Scheller
CHECKED	J. Scheller		

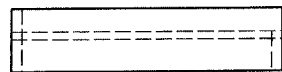

**SHELF SIDE VIEW**



**SHELF FRONT VIEW**

1/2" X 1 1/2" FLAT STOCK WELD TO FORM DOOR FRAME AND ALSO AROUND PERIMETER OF EACH DOOR.

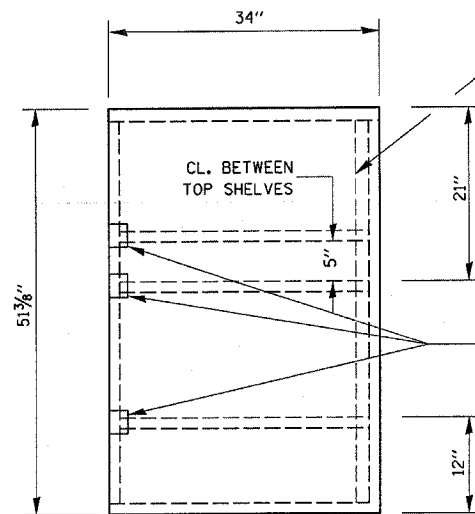

**SIDE VIEW**

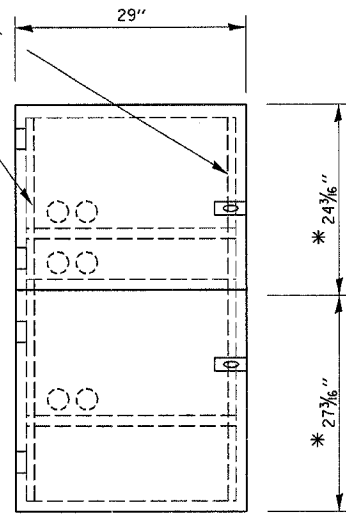

**FRONT VIEW**

\* WELD BACKSTOP TO MAINTAIN 2" CLEARANCE BETWEEN SHELF AND CABINET

\* ALLOWS FOR 1/8" CLEARANCE AT TOP AND BOTTOM OF CABINET AND BETWEEN DOORS.

**NOTES:**

1. USE 16 GAUGE STEEL FOR CABINET.
2. THE TOP SHELF SHALL SLIDE IN OR OUT WITH THE TOP DOOR OPEN.
3. ALL HINGES AND HASPS WILL BE WELDED TO THE CABINET.
4. ALL EDGES SHALL BE GROUND SMOOTH.
5. TWO (2" DIA.) ACCESS HOLES WILL BE REQUIRED FOR EACH SHELF.
6. CABINET SHALL BE PAINTED WITH TWO COATS OF FLAT PAINT.
7. 2 EACH MATCHING KEY PADLOCKS, WITH 3 KEYS PROVIDED, MASTER MODEL 3 T OR EQUIVALENT.
8. 4 EACH PLAIN STEEL, NON-REMOVABLE PIN, NO HOLE 4" X 4" SQUARE CORNER HINGES TO BE WELDED ON.
9. 2 EACH EXTRA HEAVY, PLAIN STEEL, FIXED STAPLE, NO HOLE, 7/4" HASPS TO BE WELDED ON.

FLAT STOCK DIMENSIONS VARY DEPENDING ON TYPE OF ROLLER ASSEMBLY

**LOCKABLE COMPUTER CABINET**

2" ACCESS HOLES IN REAR OF CABINET

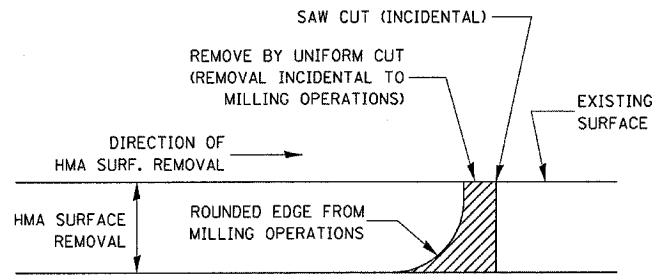
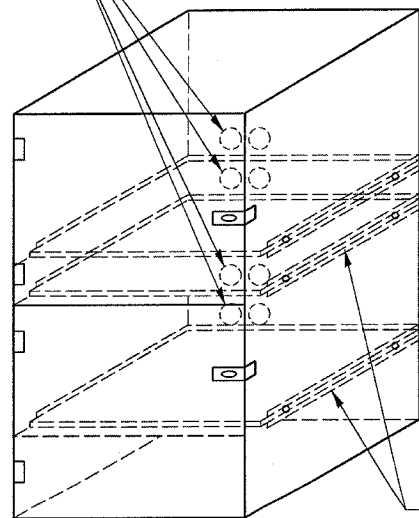

**NOTE:**

WHEN MILLING OPERATIONS PRODUCE A ROUNDED EDGE, THEN A SAW CUT SHALL BE USED TO MANUFACTURE A PERPENDICULAR EDGE AS SHOWN IN THE DETAIL. THE ENGINEER SHALL BE THE SOLE JUDGE CONCERNING THE USE OF THIS DETAIL

**HMA DETAIL AT BUTT JOINTS**

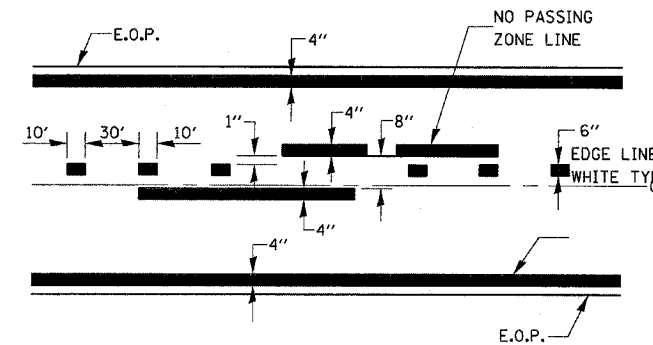

CENTERLIN & NO PASSING ZONE LINES - YELLOW

(SEE TYPICAL SECTIONS)

**PAVEMENT MARKING**

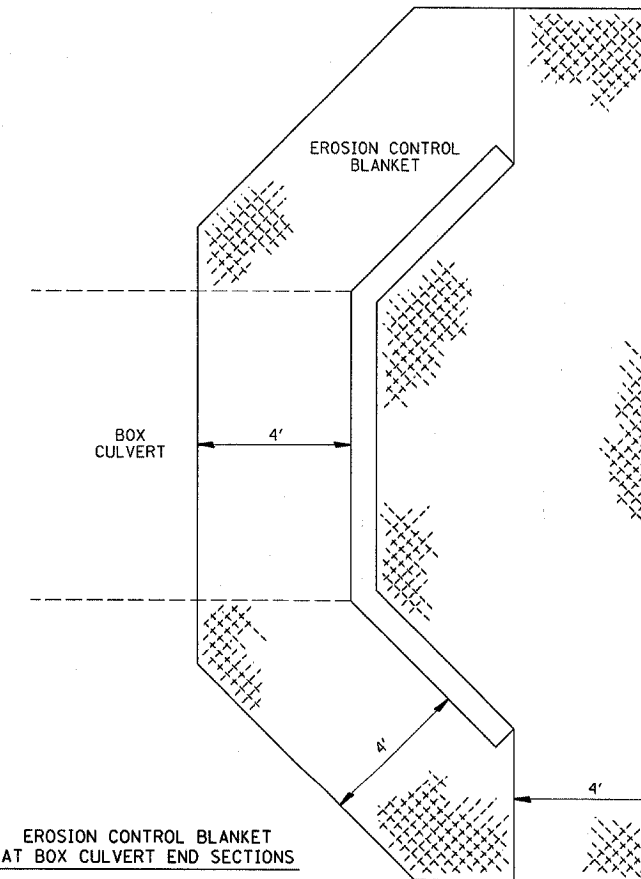

**EROSION CONTROL BLANKET AT BOX CULVERT END SECTIONS**

FILE NAME = c:\projects\ed03886\sheets.dgn	USER NAME = ferguson	DESIGNED -	REVISED -	<b>STATE OF ILLINOIS DEPARTMENT OF TRANSPORTATION</b>	<b>DETAIL SHEET</b>	F.A.S. RTE. 317	SECTION 36 BR	COUNTY IROQUOIS	TOTAL SHEETS 29	SHEET NO. 25
PLOT SCALE = 20.0000' / IN.	CHECKED -	REVISED -	STA. 1117+00 TO STA. 1123+00			CONTRACT NO. 66646				
PLOT DATE = Oct 31, 2007 - 03:54:00 PM	DATE -	REVISED -	FED. ROAD DIST. NO. ILLINOIS FED. AID PROJECT							
			SCALE:			SHEET NO. OF SHEETS	STA. TO STA.			



FINAL SURVEY	SURVEYED	BY	DATE
NOTE BOOK	PLOTTED		
NO.	AREAS CHECKED		

ORIGINAL SURVEY	SURVEYED	BY	DATE
NOTE BOOK	PLOTTED		
NO.	AREAS CHECKED		

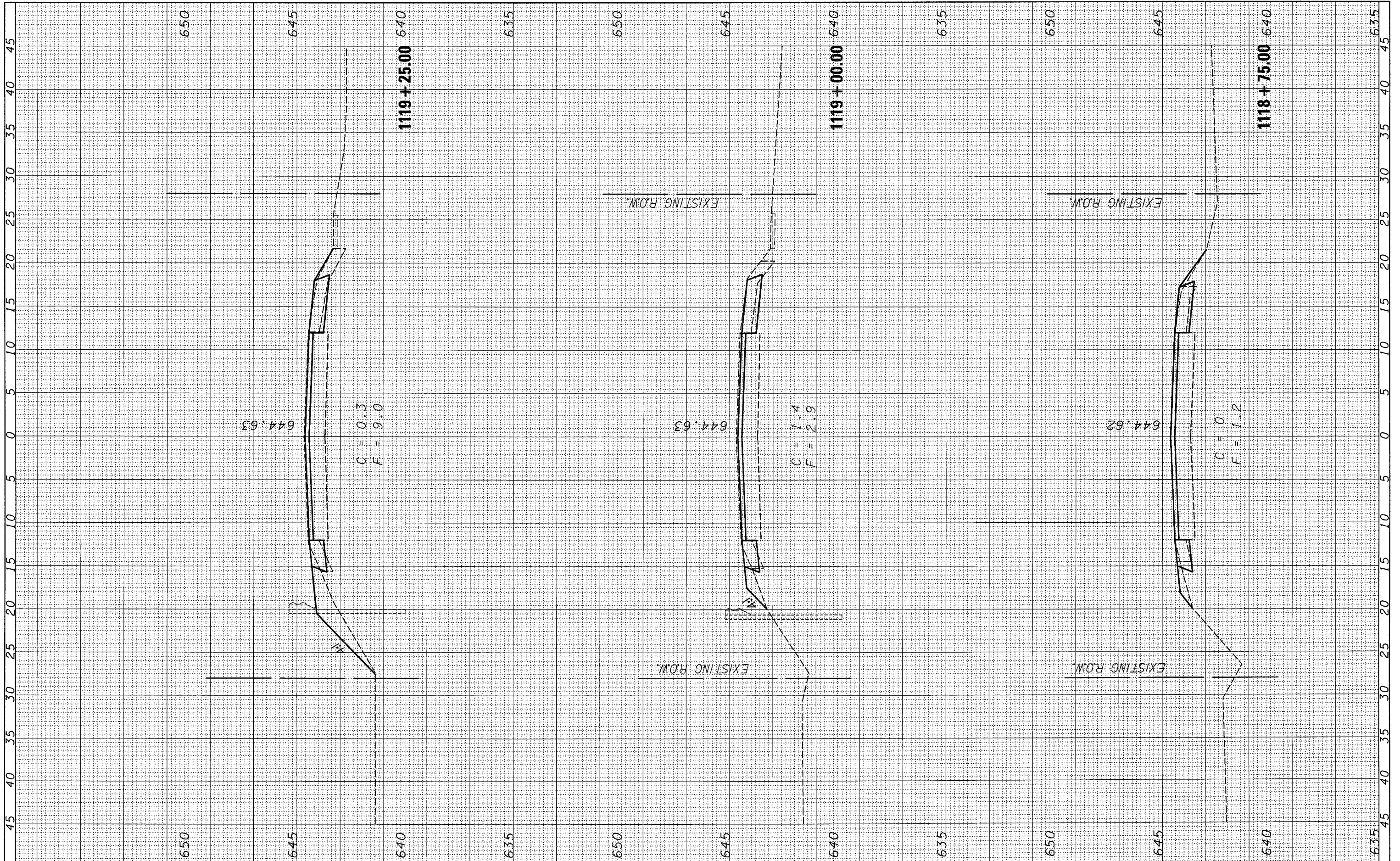

FILE NAME = c:\projects\ed03085\ssht.dgn  
 USER NAME = Ferguson  
 PLOT SCALE = 5.0000' / IN.  
 PLOT DATE = Nov 01, 2007 - 07:17:58 AM

DESIGNED -	REVISED -
DRAWN -	REVISED -
CHECKED -	REVISED -
DATE -	REVISED -

STATE OF ILLINOIS  
 DEPARTMENT OF TRANSPORTATION

CROSS-SECTION SHEETS

SCALE: SHEET NO. OF SHEETS STA. 1118+75.00 TO STA. 1119+25.00

F.A.S. RTE. 317	SECTION 36 BR	COUNTY IROQUOIS	TOTAL SHEETS 29	SHEET NO. 26
CONTRACT NO. 66646				ILLINOIS FED. AID PROJECT



FINAL SURVEY	SURVEYED	DATE
NOTE BOOK	PLOTTED	
NO.	DATE	
	AREAS CHECKED	

ORIGINAL SURVEY	SURVEYED	DATE
NOTE BOOK	PLOTTED	
NO.	DATE	
	AREAS CHECKED	

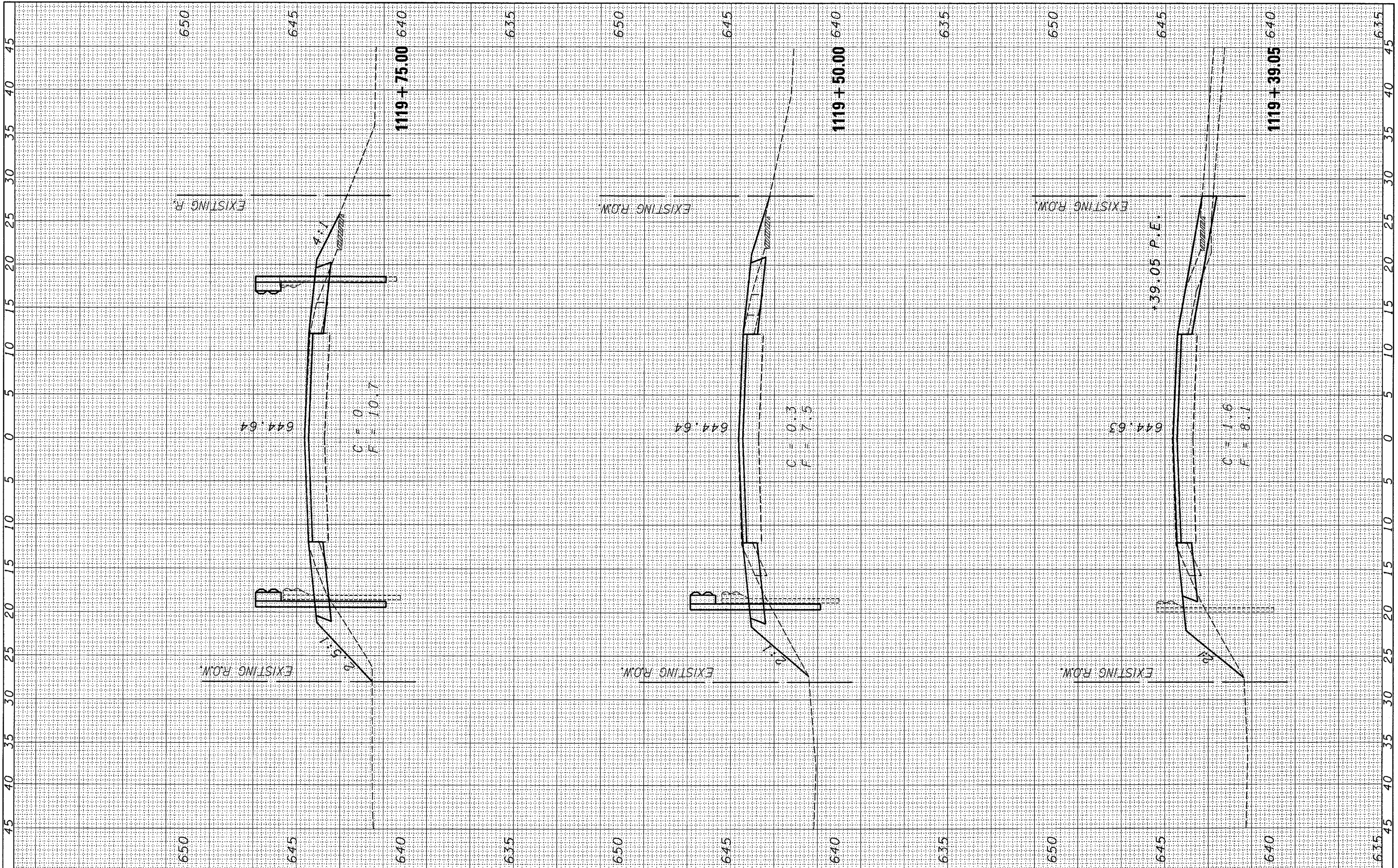

FILE NAME = c:\projects\ed\33806\wash.tdgn  
 USER NAME = Ferguson  
 DESIGNED -  
 DRAWN -  
 CHECKED -  
 DATE -

REVISOR -  
 REVISIONS -  
 REVISIONS -  
 REVISIONS -  
 REVISIONS -

**STATE OF ILLINOIS  
 DEPARTMENT OF TRANSPORTATION**

**CROSS-SECTION SHEETS**

SCALE: SHEET NO. OF SHEETS STA. 1119+39.05 TO STA. 1119+75.00

F.A.S. RTE. 317	SECTION 36 BR	COUNTY IROUOIS	TOTAL SHEETS 29	SHEET NO. 27
FED. ROAD DIST. NO.		ILLINOIS FED. AID PROJECT		
CONTRACT NO. 66646				



FINAL SURVEY NO.	DATE
SURVEYED	
PLOTTED	
NOTE BOOK	
AREAS CHECKED	

ORIGINAL SURVEY NO.	DATE
SURVEYED	
PLOTTED	
NOTE BOOK	
AREAS CHECKED	

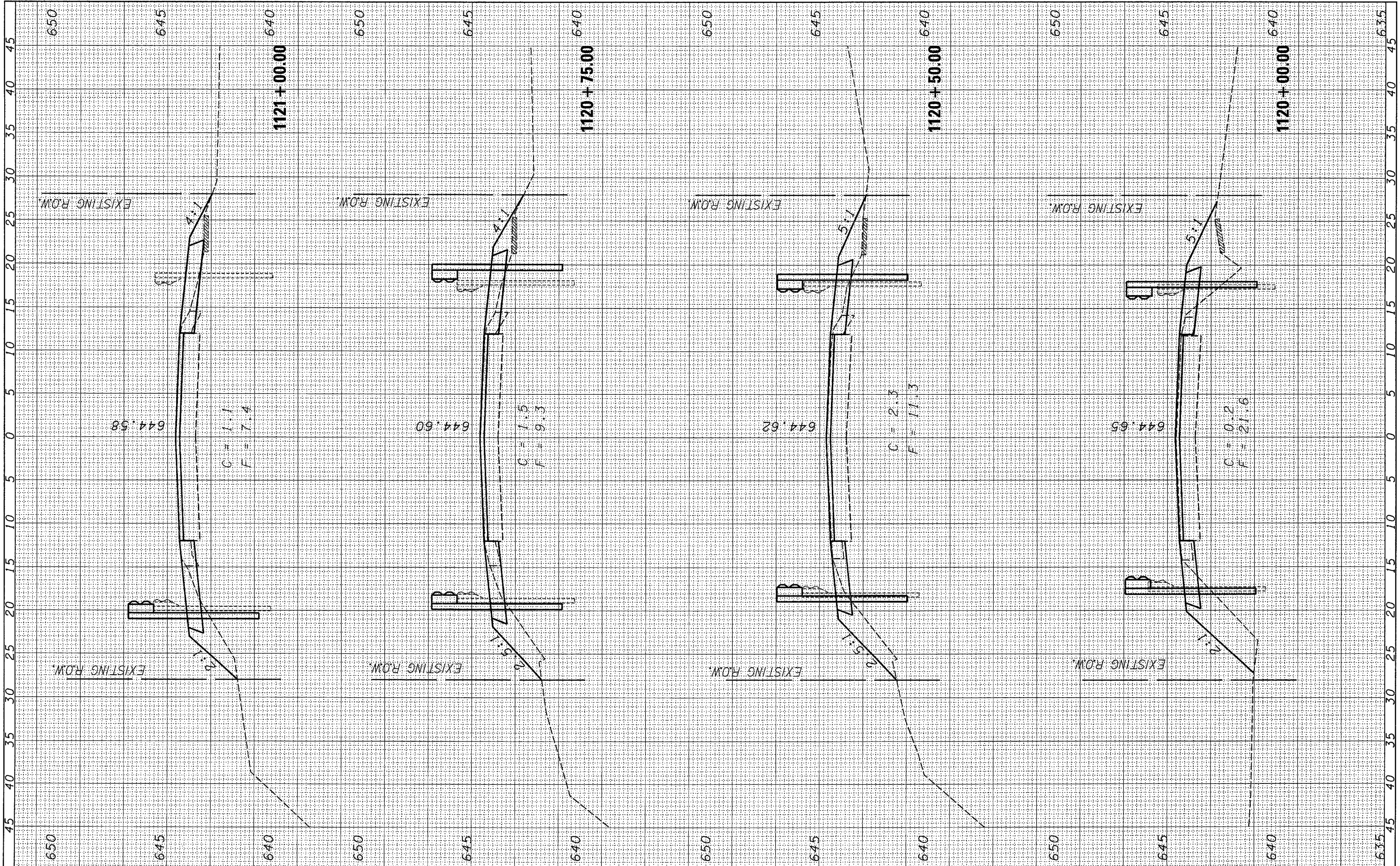

FILE NAME = c:\projects\ed03885\ssht.dgn  
 USER NAME = ferguson  
 DESIGNED -  
 DRAWN -  
 CHECKED -  
 PLOT DATE = Nov 01, 2007 - 07:17:33 AM

DESIGNED -	REVISED -
DRAWN -	REVISED -
CHECKED -	REVISED -
DATE -	REVISED -

STATE OF ILLINOIS  
 DEPARTMENT OF TRANSPORTATION

CROSS-SECTION SHEETS

SCALE: SHEET NO. OF SHEETS STA. 1120+00.00 TO STA. 1120+00.00

F.A.S. RTE. 317	SECTION 36 BR	COUNTY IROQUOIS	TOTAL SHEETS 29	SHEET NO. 28
CONTRACT NO. 66646				
ILLINOIS FED. AID PROJECT				



FINAL SURVEY NO.	SURVEYED	DATE
NOTE BOOK	PLOTTED	BY
TEMPLATE	AREAS CHECKED	
AREAS CHECKED		

ORIGINAL SURVEY NO.	SURVEYED	DATE
NOTE BOOK	PLOTTED	BY
TEMPLATE	AREAS CHECKED	
AREAS CHECKED		



FILE NAME =  
 c:\projects\ed03806\xsst.dgn

USER NAME = fergusonsa  
 PLOT SCALE = 5.0000' / IN.  
 PLOT DATE = Nov 01, 2007 - 07:17:24 AM

DESIGNED -  
 DRAWN -  
 CHECKED -  
 DATE -

REVISED -  
 REVISED -  
 REVISED -  
 REVISED -

STATE OF ILLINOIS  
 DEPARTMENT OF TRANSPORTATION

CROSS-SECTION SHEETS

SCALE: SHEET NO. OF SHEETS STA. TO STA.

F.A.S. RTE. 317	SECTION 36 BR	COUNTY IROQUOIS	TOTAL SHEETS 29	SHEET NO. 29
FED. ROAD DIST. NO. ILLINOIS FED. AID PROJECT			CONTRACT NO. 66646	