

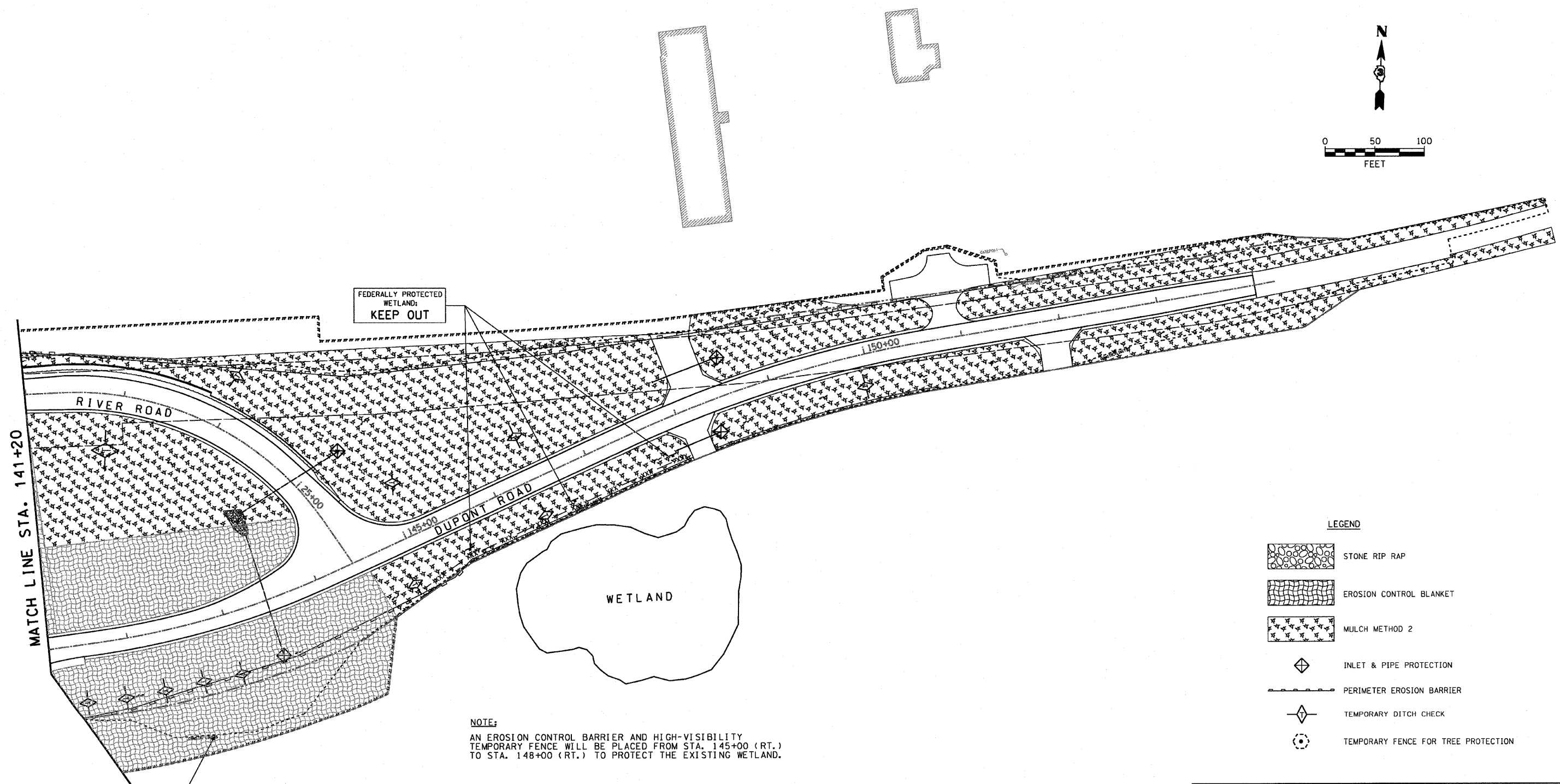

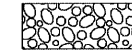

F.A.P. RTE.	SECTION	COUNTY	TOTAL SHEETS	SHEET NO.
786	(109) BR	LASALLE	351	164
STA. 61+50		TO STA. 100+00		
FED. ROAD DIST. NO.	ILLINOIS	FED. AID PROJECT		

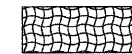
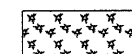

LEGEND

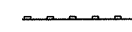
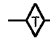
-  STONE RIP RAP
-  EROSION CONTROL BLANKET
-  MULCH METHOD 2
-  INLET & PIPE PROTECTION
-  PERIMETER EROSION BARRIER
-  TEMPORARY DITCH CHECK
-  TEMPORARY FENCE FOR TREE PROTECTION

NOTE:
AN EROSION CONTROL BARRIER AND HIGH-VISIBILITY TEMPORARY FENCE WILL BE PLACED FROM STA. 145+00 (RT.) TO STA. 148+00 (RT.) TO PROTECT THE EXISTING WETLAND.

REVISIONS	
NAME	DATE

ILLINOIS DEPARTMENT OF TRANSPORTATION
EROSION CONTROL AND ENVIRONMENTAL PROTECTION
PROPOSED CONDITIONS
IL170 BRIDGE REPLACEMENT AT SENECA
SCALE: 1" = 50'
DATE: OCTOBER, 2007
DRAWN BY: CJO
CHECKED BY: JCL

PLOT DATE = 10/11/2007
FILE NAME = WETLAND
PLOT SCALE = 1/4" = 100'
USER NAME = project