

F.A.P. RTE.	SECTION	COUNTY	TOTAL SHEETS	SHEET NO.
642	11T	CARROLL	79	36
STA.		TO STA.		
FED. ROAD DIST. NO.		ILLINOIS FED. AID PROJECT		

STAGE 2 STA 813+61

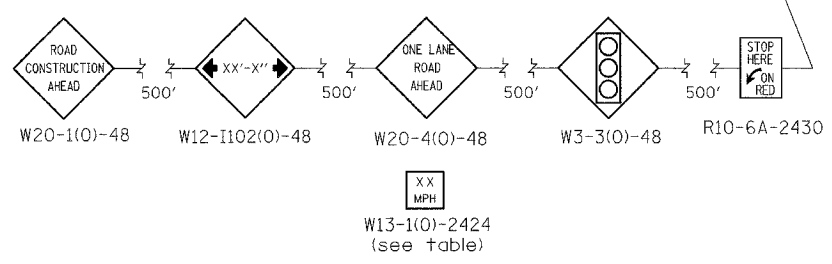
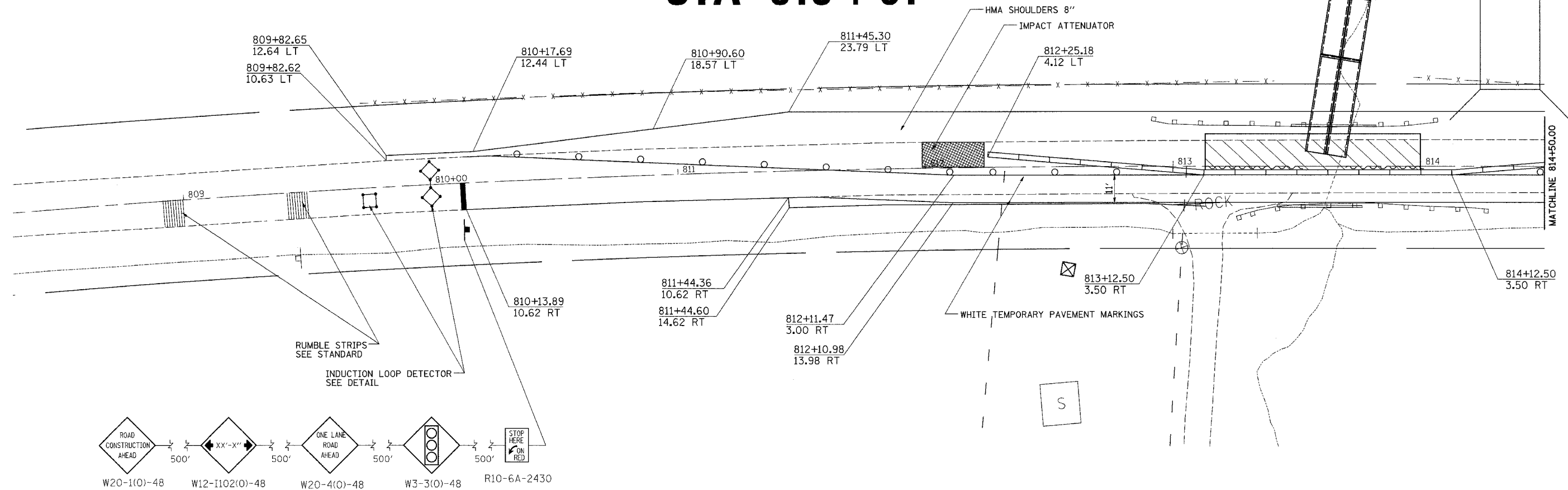

STAGE 2 NOTES

1. USE STANDARD 701321 FOR CULVERT WORK.
2. CONSTRUCT DOWNSTREAM SECTIONS OF CULVERTS INCLUDING END SECTIONS, RIP-RAP, AND EARTH WORK.
3. PLACE HMA SHOULDERS AT FULL WIDTH AND PROPOSED GUARD RAIL IN PREPARATION FOR STAGE 3.

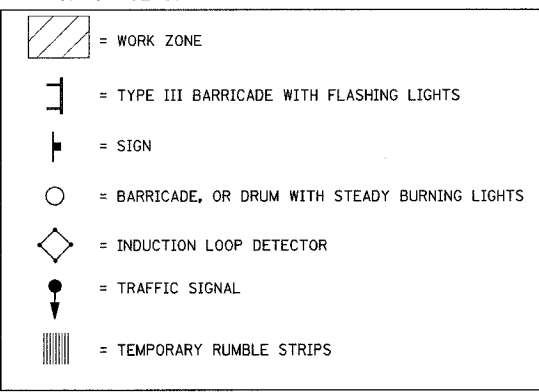

REVISIONS		ILLINOIS DEPARTMENT OF TRANSPORTATION
NAME	DATE	

SCALE: VERT. / HORIZ. / DATE
DRAWN BY / CHECKED BY

STAGING PLAN SHEETS

PLOT DATE = Wed Oct 18 15:26:00 2007
FILE NAME = c:\p\projects\642\642\642\642.dgn
PLOT SCALE = 20.0000' / 1" / IN.
USER NAME = cummerby