

F.A.P. RTE.	SECTION	COUNTY	TOTAL SHEETS	SHEET NO.
642	11T	CARROLL	79	23
STA.		TO STA.		
FED. ROAD DIST. NO.		ILLINOIS FED. AID PROJECT		

STA. 813+61

7' x 7' DOUBLE CELL PRECAST BOX CULVERT

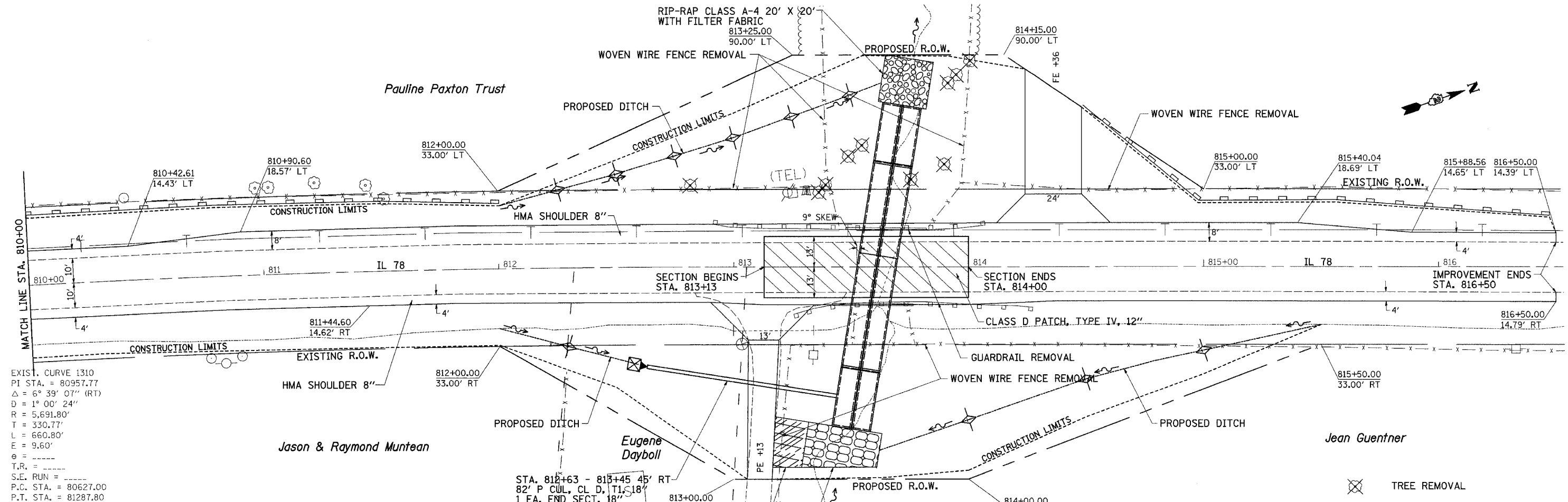

EXIST. CURVE 1310
 PI STA. = 80957.77
 $\Delta = 6^\circ 39' 07''$ (RT)
 $D = 1^\circ 00' 24''$
 $R = 5,691.80'$
 $T = 330.77'$
 $L = 660.80'$
 $E = 9.60'$
 $\theta =$
 $T.R. =$
 $S.E. RUN =$
 $P.C. STA. = 80627.00$
 $P.T. STA. = 81287.80$

Flood Frequency Year	Discharge cfs	Waterway Opening (sq ft)		Natural H.W.E.		Head (ft)		Headwater Elev. (ft)	
		Existing	Proposed	Existing	Proposed	Existing	Proposed	Existing	Proposed
Ten-Year	10	334	56.9	74.9	661.74	0.08	0.00	661.82	658.30
Design	50	544	60.5	78.5	662.04	1.88	0.00	663.92	659.96
Base	100	636		80.0	662.17		0.00		662.08
Overtopping Ex.	68	585	61.1		662.09	2.22		664.31	
Max. Calc.	500	860		83.8	662.48		1.27		663.75

Existing Low Grade Elevation: 664.29 ft @ Sta 817+00
 Proposed Low Grade Elevation: 664.48 ft @ Sta 817+00

10-Year Velocity through Existing Structure = 11.48 fps
 10-Year Velocity through Proposed Structure = 5.23 fps

STA. 812+63 - 813+45 45' RT
 82' P CUL. CL. D. 18"
 1 EA. END SECT. 18"

TURF REINFORCEMENT MAT 13' X 20'
 ARTICULATED BLOCK REVETMENT MAT 31' X 17'
 WITH FILTER FABRIC

STA 813+60.84 @ 9° SKEW
 REMOVE EXISTING 12' x 7' BOX CULVERT
 88' - 7' x 7' DOUBLE CELL PRECAST CONCRETE BOX CULVERT
 $\pm 655.50 - 655.00$ SLOPE= 0.57%
 44' LT - 44' RT
 4 EA. BOX CULVERT END SECTION LT & RT

- TREE REMOVAL
- PERIMETER EROSION BARRIER
- TEMPORARY DITCH CHECK
- INLET & PIPE PROTECTION

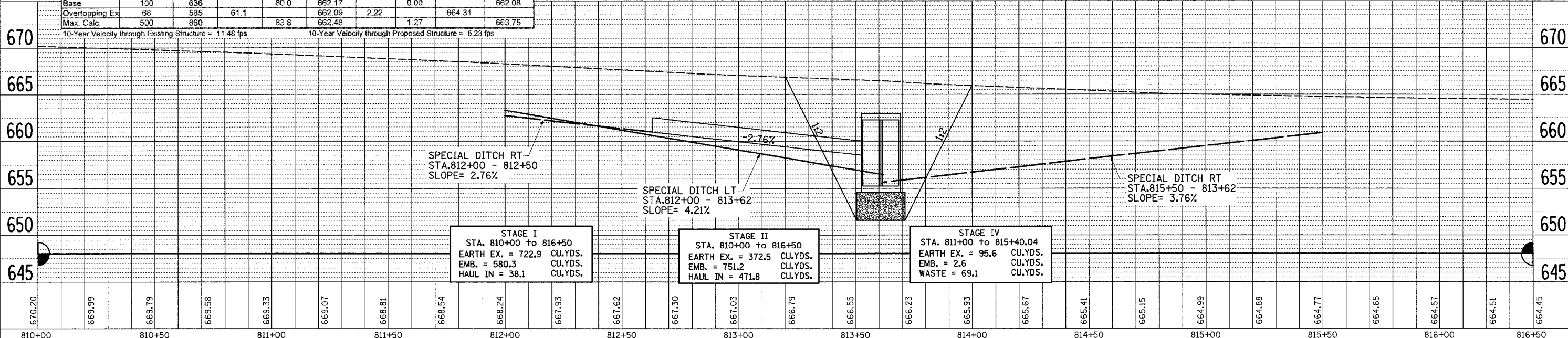

PLAN

DATE	
BY	
REVIEWED	
DESIGNED	
CHECKED	
IN CHARGE	
NOTE BOOK NO.	
ALIGNED CHECKED	
CONSTRUCTION CHECKED	
CADD FILE NAME	

PROFILE

DATE	
BY	
REVIEWED	
DESIGNED	
CHECKED	
IN CHARGE	
NOTE BOOK NO.	
GRADES CHECKED	
STRUCTURE NOTATIONS OK'D	

PLOT DATE = Wed Dec 18 15:24:47 2007
 FILE NAME = c:\pwworkspace\124266888\124266888\124266888.dgn
 USER NAME = c:\user\j...