

F.A.P. RTE.	SECTION	COUNTY	TOTAL SHEETS	SHEET NO.
642	11T	CARROLL	79	22
STA.		TO STA.		
FED. ROAD DIST. NO.		ILLINOIS	FED. AID PROJECT	

STA. 805 + 74.24

10' x 8' PRECAST BOX CULVERT

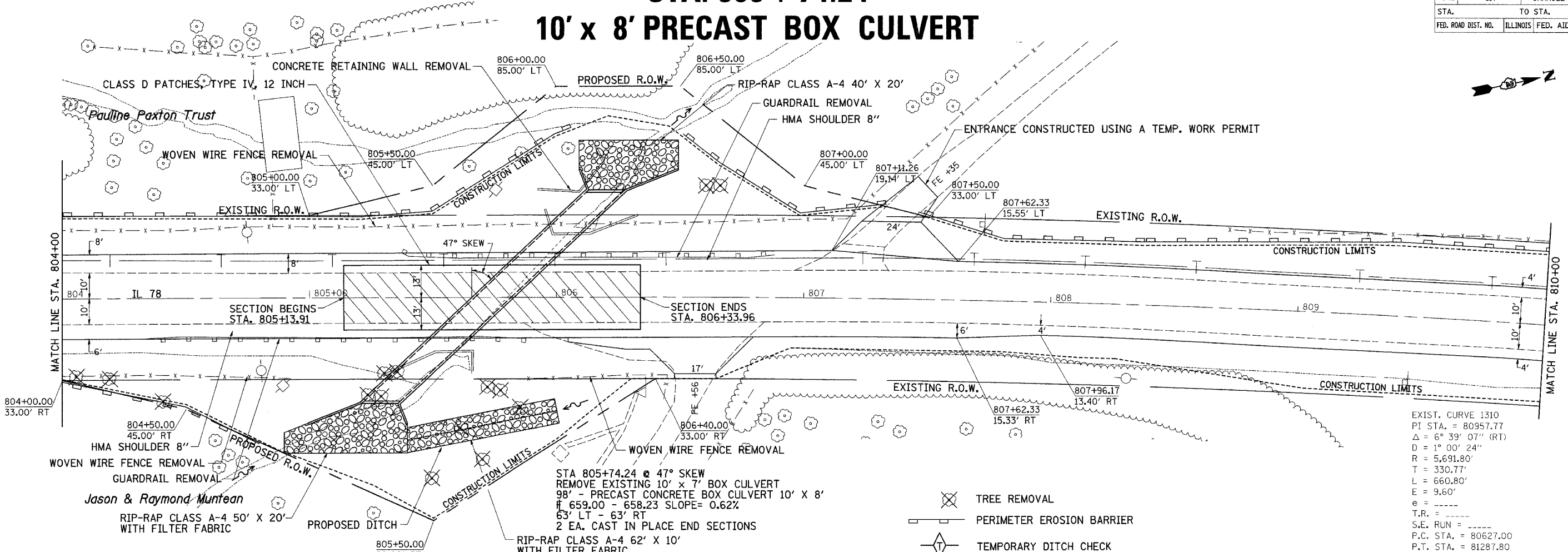

EXIST. CURVE 1310
 PI STA. = 80957.77
 $\Delta = 6^\circ 39' 07''$ (RT)
 $D = 1^\circ 00' 24''$
 $R = 5,691.80'$
 $T = 330.77'$
 $L = 660.80'$
 $E = 9.60'$
 $e =$
 $T.R. =$
 $S.E. RUN =$
 $P.C. STA. = 80627.00$
 $P.T. STA. = 81287.80$

- TREE REMOVAL
- PERIMETER EROSION BARRIER
- TEMPORARY DITCH CHECK

STA 805+74.24 @ 47° SKEW
 REMOVE EXISTING 10' x 7' BOX CULVERT
 # 659.00 - 658.23 SLOPE = 0.62%
 63' LT - 63' RT
 2 EA. CAST IN PLACE END SECTIONS

Elevation	Existing Low Grade Elevation: 672.21 ft @ Sta 805+80										Elevation
	Proposed Low Grade Elevation: 672.41 ft @ Sta 805+80										
685	Flood Year	Discharge cfs	Waterway Opening (sq ft)		Natural H.W.E.	Head (ft)		Headwater Elev. (ft)		685	
			Existing	Proposed		Existing	Proposed	Existing	Proposed		
685	Ten-Year	10	380	60.1	55.6	664.56	0.00	0.00	664.56	664.56	
	Design	50	607	70.0	69.2	665.92	1.29	1.01	667.21	666.93	
	Base	100	704	70.0	75.3	666.53	2.09	1.55	668.62	668.08	
680	Overlapping Ex.										
	Max. Calc.	500	940	70.0	80.0	667.41	4.25	3.40	671.66	670.81	
	10-Year Velocity through Existing Structure = 6.15 fps 10-Year Velocity through Proposed Structure = 5.89 fps										
675										675	
670										670	
665										665	
660										660	
655										655	
650										650	

STAGE I
 STA. 804+00 to 810+00
 EARTH EX. = 448.6 CU.YDS.
 EMB. = 482.1 CU.YDS.
 HAUL IN = 145.6 CU.YDS.

STAGE II
 STA. 804+00 to 810+00
 EARTH EX. = 75.5 CU.YDS.
 EMB. = 552.8 CU.YDS.
 HAUL IN = 496.2 CU.YDS.

STAGE IV
 STA. 803+45 to 807+00
 EARTH EX. = 75.5 CU.YDS.
 EMB. = 47 CU.YDS.
 WASTE = 9.7 CU.YDS.

PLAN
 SURVEYED
 ALIGNED
 CHECKED
 DATE FILE NAME

PROFILE
 SURVEYED
 GRADES CHECKED
 DATE FILE NAME

PLOT DATE = Wed Oct 19 15:24:47 2007
 FILE NAME = c:\pwork\64d82\64d82.dgn
 USER NAME = c:\user