

F.A.P. RTE.	SECTION	COUNTY	TOTAL SHEETS	SHEET NO.
308	(104-BY-1BR)	CARROLL	40	6
STA. 566+37.11		TO STA. 578+50		
FED. ROAD DIST. NO.		ILLINOIS FED. AID PROJECT		

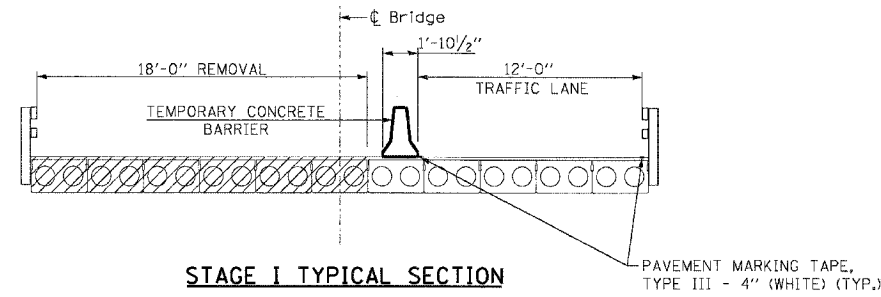

STAGE I

PHASE	SEQUENCE OF OPERATIONS					
	A			B		
INTERVAL	1	2	3	4	5	6
EASTBOUND IL RTE 84 LEFT SIGNAL AND RIGHT SIGNAL	G	Y	R	R	R	R
WESTBOUND IL RTE 84 LEFT SIGNAL AND RIGHT SIGNAL	R	R	R	G	Y	R

NOTES: 1. CALL KRISTIE NYDEREK WITH DISTRICT 2 TRAFFIC AT (815) 284-5474 2 WEEKS BEFORE INSTALLING TEMPORARY SIGNAL.
 2. PROPOSED HOT-MIX ASPHALT SHOULDERS SHALL BE CONSTRUCTED PRIOR TO THE PROPOSED BRIDGE RECONSTRUCTION AND REQUIRED STAGE I AND STAGE II LANE CLOSURES, USING STANDARD DAILY LANE CLOSURES.

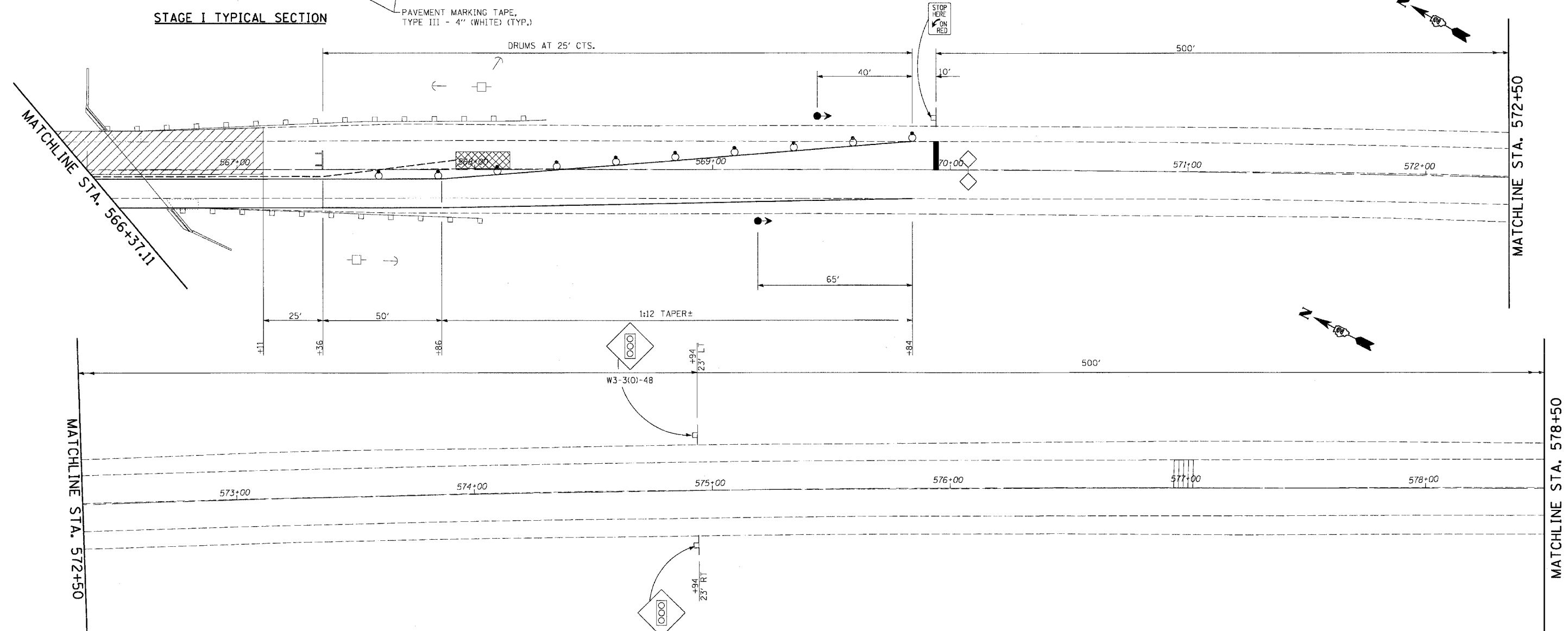

LEGEND

- WORK AREA
- SIGN
- TYPE III BARRICADE
- TRAFFIC SIGNAL
- DETECTOR LOOPS
- IMPACT ATTENUATOR
- DRUM WITH STEADY BURNING LIGHT
- TEMPORARY CONCRETE BARRIER
- TEMPORARY RUMBLE STRIP (WHEN SPECIFIED)
- DOUBLE VERTICAL PANEL
- CRYSTAL, BIDIRECTIONAL BARRIER WALL/GUARDRAIL MARKER

NOTES

1. ALL GUARDRAIL MUST BE RE-INSTALLED PRIOR TO STAGE II CONSTRUCTION.

REVISIONS	
NAME	DATE

ILLINOIS DEPARTMENT OF TRANSPORTATION
MAINTENANCE OF TRAFFIC
STAGE I
 IL-84 OVER A DRAINAGE DITCH
 FAP ROUTE 308 SECTION (104-BY-1BR)D
 CARROLL COUNTY
 STATION 566+38
 STRUCTURE NO. 008-0016
 SCALE: VERT. DATE 10/10/07
 HORIZ. DRAWN BY CKL
 CHECKED BY CAC

PLOT DATE: 10/10/2007
 FILE NAME: G:\ENGINEERING\6799-13\TASKS\CONSTRUCTION\SHIT006_Mot_Stage_01.dwg
 PLOT SCALE: 1"=50'
 USER: SUSER