

INDEX OF SHEETS

STATE STANDARDS

GENERAL NOTES:

SHEET NO.	DESCRIPTION:	
1	COVER SHEET	000001-08 STANDARD SYMBOLS, ABBREVIATIONS AND PATTERNS
2	INDEX OF SHEETS, STATE STANDARDS, AND GENERAL NOTES	424001-12 PERPENDICULAR CURB RAMPS FOR SIDEWALKS
3-4	SUMMARY OF QUANTITIES	424011-05 CORNER PARALLEL CURB RAMPS FOR SIDEWALKS
5-6	EXISTING AND PROPOSED TYPICAL SECTIONS	424021-07 DEPRESSED CORNER
7-10	PROPOSED ROADWAY AND PAVEMENT MARKING PLANS	442201-03 CLASS C AND D PATCHES
11	DETECTOR LOOP REPLACEMENT PLAN	604001-05 FRAME AND LIDS, TYPE 1
12	DETAILS FOR FRAMES AND LIDS ADJUSTMENTS WITH MILLING (BD-08)	604061-03 FRAME AND GRATE, TYPE 12
13	PAVEMENT PATCHING FOR HMA SURFACED PAVEMENT (BD-22)	606001-08 CONCRETE CURB TYPE B AND COMBINATION CONCRETE CURB AND GUTTER
14	CURB OR CURB AND GUTTER REMOVAL AND REPLACEMENT (BD-24)	701001-02 OFF ROAD OPERATIONS, 2L, 2W, MORE THAN 15' (4.5m) AWAY
15	BUTT JOINT AND HMA TAPER DETAILS (BD-32)	701006-05 OFF-ROAD MOVING OPERATIONS, 2L, 2W, 15' (4.5m) TO 24" (600mm) FROM PAVEMENT EDGE
16	PROJECT DETAIL FOR SINGLE PERPENDICULAR CURB RAMPS (PD-01)	701011-04 OFF-ROAD MOVING OPERATIONS, 2L, 2W - DAY ONLY
17	PROJECT DETAIL FOR SINGLE PERPENDICULAR CURB RAMPS (PD-02)	701301-04 LANE CLOSURE, 2L, 2W, SHORT TIME OPERATIONS
18	PROJECT DETAIL FOR SINGLE PERPENDICULAR CURB RAMPS (PD-03)	701311-03 LANE CLOSURE 2L, 2W, MOVING OPERATIONS - DAY ONLY
19	PROJECT DETAIL FOR DOUBLE PERPENDICULAR CURB RAMPS (PD-04)	701501-06 URBAN LANE CLOSURE, 2L, 2W, UNDIVIDED
20	TRAFFIC CONTROL AND PROTECTION FOR SIDE ROADS, INTERSECTIONS, AND DRIVEWAYS (TC-10)	701701-10 URBAN LANE CLOSURE, MULTILANE INTERSECTIONS
21	TYPICAL APPLICATIONS RAISED REFLECTIVE PAVEMENT MARKERS (SNOW-PLOW RESISTANT) (TC-11)	701801-06 SIDEWALK, CORNER OR CROSSWALK CLOSURE
22	DISTRICT ONE TYPICAL PAVEMENT MARKINGS (TC-13)	701901-10 TRAFFIC CONTROL DEVICES
23	SHORT TERM PAVEMENT MARKING LETTERS AND SYMBOLS (TC-16)	780001-05 TYPICAL PAVEMENT MARKINGS
24	ARTERIAL ROAD INFORMATION SIGNING (TC-22)	781001-04 TYPICAL APPLICATIONS FOR RAISED REFLECTIVE PAVEMENT MARKERS

- 1) BEFORE STARTING ANY EXCAVATION THE CONTRACTOR SHALL CALL "JULIE" AT 800-892-0123 FOR FIELD LOCATIONS OF BURIED ELECTRIC, TELEPHONE AND GAS FACILITIES, (48 HOURS NOTIFICATION IS REQUIRED).
- 2) TEN (10) FOOT TRANSITION SHALL BE USED TO MATCH PROPOSED CURB AND GUTTER AND MEDIAN ITEMS OF WORK TO EXISTING CURBS AND GUTTERS AND MEDIANS IN THE FIELD, UNLESS OTHERWISE SHOWN. THE TRANSITION SHALL BE PAID FOR AT THE CONTRACT UNIT PRICE FOR THE PROPOSED ITEMS OF WORK SPECIFIED.
- 3) THE CONTRACTOR SHALL COORDINATE CONSTRUCTION ACTIVITIES WITH THE UTILITY COMPANIES AND THE CITY OF DARIEN.
- 4) THE CONTRACTOR WILL NOT BE ALLOWED TO SET UP A YARD OR FIELD OFFICE ON STATE PROPERTY WITHOUT WRITTEN PERMISSION FROM THE DEPARTMENT.
- 5) ANY PAVEMENT MARKINGS AND RAISED REFLECTIVE PAVEMENT MARKERS OBLITERATED BY MILLING AND RESURFACING OPERATIONS ON SIDE STREETS AND ENTRANCES SHALL BE REPLACED AND PAID FOR IN KIND.
- 6) ALL DAMAGE TO EXISTING PAVEMENT MARKINGS OR RAISED REFLECTIVE PAVEMENT MARKERS OUTSIDE THE REMOVAL LINE SHOWN ON THE PLANS SHALL BE REPLACED AT NO ADDITIONAL COST TO THE DEPARTMENT.
- 7) ALL PAVEMENT PATCHING LOCATIONS WILL BE DETERMINED IN THE FIELD BY THE ENGINEER.
- 8) LOCATION OF COMBINATION CONCRETE CURB AND GUTTER REMOVAL AND REPLACEMENT [OR COMBINATION CURB AND GUTTER (THE TYPE SPECIFIED ON THE PLANS)], WILL BE DETERMINED IN THE FIELD BY THE ENGINEER.
- 9) DRAINAGE ADJUSTMENT OR RECONSTRUCTION LOCATIONS WILL BE DETERMINED IN THE FIELD BY THE ENGINEER.
- 10) IT SHALL BE THE CONTRACTORS RESPONSIBILITY TO VERIFY ALL DIMENSIONS AND EXISTING CONDITIONS IN THE FIELD PRIOR TO CONSTRUCTION AND ORDERING OF MATERIALS.
- 11) FRAMES AND GRATES ADJUSTMENT OF PRIVATE UTILITIES WITHIN THE LIMITS OF THE IMPROVEMENT SHALL BE DONE BY THEIR RESPECTIVE OWNERS AND ARE NOT IN PART OF THIS CONTRACT.
- 12) BEFORE BEGINNING ANY WORK, THE CONTRACTOR SHALL RETAIN AND RECORD FOR FUTURE REFERENCE, ALL EXISTING PAVEMENT MARKING LINES (RAISED REFLECTIVE PAVEMENT MARKERS) IN ORDER THAT THESE LOCATIONS CAN BE RE-ESTABLISHED FOR STRIPING. EXACT LOCATIONS OF ALL PAVEMENT MARKINGS SHALL BE AS SHOWN ON THE PLANS OR AS DIRECTED BY THE ENGINEER.
- 13) WHEN THE MILLED PAVEMENT IS OPEN TO TRAFFIC THE MAXIMUM GRADE DIFFERENTIAL BETWEEN PASSES OF THE MILLING MACHINE SHALL NOT EXCEED $\frac{1}{2}$ INCHES (40 mm) WHERE THE SPEED LIMIT IS 40 MPH (80 km/ h) OR LESS AND 1 INCH (25 mm) WHERE THE SPEED LIMIT IS GREATER THAN 40 MPH (80 km/ h). WITH WRITTEN APPROVAL OF THE ENGINEER, A MAXIMUM GRADE DIFFERENTIAL OF 3 INCHES (75 mm) MAY BE ALLOWED IF THE EDGE OF THE MILLING MACHINE IS SLOPED A MINIMUM (1:3).
- 14) THE CONTRACTOR SHALL CONTACT KALPANA-KANNAN-HOUSADRUG, THE DISTRICT ONE TRAFFIC CONTROL SUPERVISOR AT KALPANA.KANNAN-HOUSADURGA@ILLINOIS.GOV A MINIMUM OF 72 HOURS IN ADVANCE OF BEGINNING WORK.
- 15) PERMANENT PAVEMENT MARKINGS SHALL BE THERMOPLASTIC (OF THE EXTRUDED TYPE) AND SHOULD BE PLACED IN ACCORDANCE WITH THE "DISTRICT ONE TYPICAL PAVEMENT MARKINGS" DETAIL. (TC-13)
- 16) THE RESIDENT ENGINEER SHALL CONTACT MR. ERIC CAMPOS , AREA TRAFFIC FIELD ENGINEER, AT ERIC.CAMPOS@ILLINOIS.GOV, A MINIMUM OF TWO (2) WEEKS PRIOR TO THE PLACEMENT OF PERMANENT PAVEMENT MARKINGS.
- 17) THE CONTRACTOR SHALL MAINTAIN PEDESTRIAN ACCESS AT ALL TIMES DURING CONSTRUCTION.
- 18) THE CONTRACTOR SHALL CONTACT THE ROADSIDE DEVELOPMENT UNIT AT (847) 705-4171 AT LEAST TWO WEEKS PRIOR TO BEGINNING LANDSCAPE AND FORESTRY WORK FOR LAYOUT.
- 19) PAVEMENT MARKING TAPE, TYPE III SHALL BE USED FOR SHORT-TERM PAVEMENT MARKINGS ON ALL FINAL SURFACES.
- 20) ALL MILLED SURFACES SHALL BE AT A UNIFORM CROSS SLOPE PER LANE AND FREE OF RIDGES BETWEEN PASSES. ANY DEVIATIONS SHALL BE CORRECTED AT NO COST TO THE DEPARTMENT.
- 21) THE "ROAD CONSTRUCTION AHEAD" SIGNS SHALL REMAIN INSTALLED UNTIL THE COMPLETION OF THE PROJECT OR WHEN NO ROADWAY HAZARDS REMAIN WITHIN THE WORK ZONE.
- 22) NO REMOVAL OF TREES MEASURING THREE (3) INCHES IN DIAMETER OR GREATER AT BREAST HEIGHT SHALL OCCUR BETWEEN APRIL 1 AND OCTOBER 31 OF ANY GIVEN YEAR TO CONSERVE THE THREATEN AND ENDANGERED NORTHERN LONG-EARED BAT (NLEB).
- 23) IT WILL BE THE RESPONSIBILITY OF THE CONTRACTOR TO CONTACT ROADSIDE DEVELOPMENT UNIT AT 847.705.4171 TO SCHEDULE A WALK THROUGH TO DETERMINE TREE PROTECTION, TREE REMOVAL, SELECTIVE CLEARING, AND OTHER FORESTRY WORK A MINIMUM OF 14 DAYS PRIOR TO THE COMMENCEMENT OF CONSTRUCTION. AT NO TIME SHALL THE CONTRACTOR PRUNE OR REMOVE ANY TREES UNLESS SPECIFICALLY DIRECTED BY THE ROADSIDE DEVELOPMENT UNIT.
- 24) EXISTING VEGETATED AREAS (TREES, SHRUBS, VEGETATIVE BUFFERS, TURF AREAS, ETC.) WHERE DISTURBANCE IS NOT OCCURRING (INCLUDING AREAS OUTSIDE THE PROJECT LIMITS) SHALL NOT BE DISTURBED TO ENSURE THAT EXISTING VEGETATION IS PRESERVED HEALTHY TO MINIMIZE SOIL EROSION AND TO ELIMINATE SOIL COMPACTION. NO MATERIALS ARE TO BE STORED OR VEHICLES DRIVEN OR PARKED WITHIN THESE UNDISTURBED AREAS AT ANY TIME.
- 25) PHOSPHORUS FERTILIZER HAS BEEN INTENTIONALLY OMITTED FROM CONTRACT BECAUSE IT WOULD BE DETRIMENTAL TO NEARBY SAWMILL CREEK. A PHOSPHORUS-FREE FERTILIZER SHALL BE USED (MIDDLE NUMBER SHOULD EQUAL 0).

MODEL: GenNotesSh01 [Sheet]
FILE NAME: c:\pw_workspace\data\darim\0926529\0113324-shit-gennote.dgn

	USER NAME = Zaid.Salah	DESIGNED =	REVISED =	STATE OF ILLINOIS DEPARTMENT OF TRANSPORTATION	INDEX OF SHEETS, STATE STANDARDS & GENERAL NOTES I-55 N. FRONTAGE RD. (CASS AVE. TO CLARENDON HILLS RD.)			F.A.I. RTE.	SECTION	COUNTY	TOTAL SHEETS	SHEET NO.
	PLOT SCALE = 0.16666633' / in	CHECKED =	REVISED =					55	2023-927-RS,SW	DUPAGE	24	2
	PLOT DATE = 10/30/2024	DATE =	REVISED =		SCALE:			CONTRACT NO. 62W49				
					SHEET 1 OF 1 SHEETS			ILLINOIS FED. AID PROJECT				

MODEL: sop-5 [Sheet]
FILE NAME: c:\pwworking\dwg\plan\m0926529\0113324-shl-SOO.dgn

Code No.	ITEM	UNIT	TOTAL QUANTITIES	STND OVERLAY 100% STATE 0005	
20200100	EARTH EXCAVATION	CU YD	20	20	
21101615	TOPSOIL FURNISH AND PLACE, 4"	SQ YD	25	25	
25200110	SODDING, SALT TOLERANT	SQ YD	25	25	
40600290	BITUMINOUS MATERIALS (TACK COAT)	POUND	17800	17800	
40600370	LONGITUDINAL JOINT SEALANT	FOOT	7410	7410	
40600400	MIXTURE FOR CRACKS, JOINTS, AND FLANGEWAYS	TON	40	40	
40600982	HOT-MIX ASPHALT SURFACE REMOVAL - BUTT JOINT	SQ YD	265	265	
40601005	HOT-MIX ASPHALT REPLACEMENT OVER PATCHES	TON	250	250	
40602978	HOT-MIX ASPHALT BINDER COURSE, IL-9.5, N50	TON	2951	2951	
40604060	HOT-MIX ASPHALT SURFACE COURSE, IL-9.5, MIX "D", N50	TON	2582	2582	
42001300	PROTECTIVE COAT	SQ YD	105	105	
42400200	PORTLAND CEMENT CONCRETE SIDEWALK 5 INCH	SQ FT	775	775	
42400800	DETECTABLE WARNINGS	SQ FT	95	95	
44000164	HOT-MIX ASPHALT SURFACE REMOVAL, 3 3/4"	SQ YD	26340	26340	
44000500	COMBINATION CURB AND GUTTER REMOVAL	FOOT	295	295	
44000600	SIDEWALK REMOVAL	SQ FT	775	775	
44002215	HOT-MIX ASPHALT REMOVAL OVER PATCHES, 3 3/4"	SQ YD	1195	1195	
44201777	CLASS D PATCHES, TYPE II, 11 INCH	SQ YD	630	630	
44201781	CLASS D PATCHES, TYPE III, 11 INCH	SQ YD	110	110	
44201783	CLASS D PATCHES, TYPE IV, 11 INCH	SQ YD	455	455	

Code No.	ITEM	UNIT	TOTAL QUANTITIES	STND OVERLAY 100% STATE 0005	
48102100	AGGREGATE WEDGE SHOULDER, TYPE B	TON	97	97	
60603800	COMBINATION CONCRETE CURB AND GUTTER, TYPE B-6.12	FOOT	245	245	
60605000	COMBINATION CONCRETE CURB AND GUTTER, TYPE B-6.24	FOOT	50	50	
* 66900200	NON-SPECIAL WASTE DISPOSAL	CU YD	20	20	
* 66900530	SOIL DISPOSAL ANALYSIS	EACH	3	3	
* 66901001	REGULATED SUBSTANCES PRE-CONSTRUCTION PLAN	L SUM	1	1	
* 66901003	REGULATED SUBSTANCES FINAL CONSTRUCTION REPORT	L SUM	1	1	
* 66901006	REGULATED SUBSTANCES MONITORING	CAL DA	6	6	
67100100	MOBILIZATION	L SUM	1	1	
70102620	TRAFFIC CONTROL AND PROTECTION, STANDARD 701501	L SUM	1	1	
70102635	TRAFFIC CONTROL AND PROTECTION, STANDARD 701701	L SUM	1	1	
70102640	TRAFFIC CONTROL AND PROTECTION, STANDARD 701801	L SUM	1	1	
70300100	SHORT TERM PAVEMENT MARKING	FOOT	67765	67765	
70300150	SHORT TERM PAVEMENT MARKING REMOVAL	SQ FT	16945	16945	
70300211	TEMPORARY PAVEMENT MARKING LETTERS AND SYMBOLS - PAINT	SQ FT	70	70	
70300221	TEMPORARY PAVEMENT MARKING - LINE 4"- PAINT	FOOT	23796	23796	
70300241	TEMPORARY PAVEMENT MARKING - LINE 6"- PAINT	FOOT	215	215	
70300261	TEMPORARY PAVEMENT MARKING - LINE 12"- PAINT	FOOT	1180	1180	
70300281	TEMPORARY PAVEMENT MARKING - LINE 24"- PAINT	FOOT	235	235	

* = SPECIALITY ITEM

	USER NAME = Zaid.Salah	DESIGNED -	REVISED -	STATE OF ILLINOIS DEPARTMENT OF TRANSPORTATION	SUMMARY OF QUANTITIES I-55 N. FRONTAGE RD. (CASS AVE. TO CLARENDON HILLS RD.)			F.A.I. RTE	SECTION	COUNTY	TOTAL SHEETS	SHEET NO.
		DRAWN -	REVISED -					55	2023-927-RS,SW	DUPAGE	24	3
		CHECKED -	REVISED -					CONTRACT NO. 62W49				
	PLOT DATE = 10/24/2024	DATE -	REVISED -		SCALE:	SHEET	OF	SHEETS	STA.	TO STA.	ILLINOIS FED. AID PROJECT	

MODEL: soh-6 [Sheet]
FILE NAME: c:\p\work\pwr\qarut\m\40926529\0113324-shl-SOO.dgn

Code No.	ITEM	UNIT	TOTAL QUANTITIES	STND OVERLAY 100% STATE 0005	
70307120	TEMPORARY PAVEMENT MARKING - LINE 4" - TYPE IV TAPE	FOOT	5290	5290	
* 78000100	THERMOPLASTIC PAVEMENT MARKING - LETTERS AND SYMBOLS	SQ FT	70	70	
* 78000200	THERMOPLASTIC PAVEMENT MARKING - LINE 4"	FOOT	23796	23796	
* 78000400	THERMOPLASTIC PAVEMENT MARKING - LINE 6"	FOOT	215	215	
* 78000600	THERMOPLASTIC PAVEMENT MARKING - LINE 12"	FOOT	1180	1180	
* 78000650	THERMOPLASTIC PAVEMENT MARKING - LINE 24"	FOOT	235	235	
* 78100100	RAISED REFLECTIVE PAVEMENT MARKER	EACH	235	235	
78300200	RAISED REFLECTIVE PAVEMENT MARKER REMOVAL	EACH	235	235	
* X8860105	DETECTOR LOOP REPLACEMENT	FOOT	222	222	
X0320050	CONSTRUCTION LAYOUT (SPECIAL)	L SUM	1	1	
X2020110	GRADING AND SHAPING SHOULDERS	UNIT	49	49	
X5537800	STORM SEWERS TO BE CLEANED 12"	FOOT	150	150	
X6700407	ENGINEER'S FIELD OFFICE, TYPE A (D1)	CAL MO	12	12	
Z0018500	DRAINAGE STRUCTURES TO BE CLEANED	EACH	10	10	
Z0030850	TEMPORARY INFORMATION SIGNING	SQ FT	52	52	
X2010350	TREE REMOVAL, ACRE (SPECIAL)	ACRE	0.45	0.45	
X2010514	SELECTIVE CLEARING	ACRE	0.50	0.50	
25000210	SEEDING, CLASS 2A	ACRE	0.93	0.93	
25100630	EROSION CONTROL BLANKET	SQ YD	4512	4512	
25000400	NITROGEN FERTILIZER NUTRIENT	POUND	56	56	
25000600	POTASSIUM FERTILIZER NUTRIENT	POUND	56	56	

* = SPECIALITY ITEM

	USER NAME = Nedal.Qarut	DESIGNED -	REVISED -	STATE OF ILLINOIS DEPARTMENT OF TRANSPORTATION	SUMMARY OF QUANTITIES I-55 N. FRONTAGE RD. (CASS AVE. TO CLARENDON HILLS RD.)		F.A.I RTE.	SECTION	COUNTY	TOTAL SHEETS	SHEET NO.
		DRAWN -	REVISED -				55	2023-927-RS,SW	DUPAGE	24	4
		CHECKED -	REVISED -		CONTRACT NO. 62W49						
	PLOT DATE = 10/25/2024	DATE -	REVISED -		SCALE:	SHEET	OF	SHEETS	STA.	TO STA.	ILLINOIS FED. AID PROJECT

LEGEND – EXISTING

- (A) PORTLAND CEMENT CONCRETE PAVEMENT 9"±
- (B) HOT-MIX ASPHALT PAVEMENT 3¾"
- (C) HOT-MIX ASPHALT SHOULDER 8"±
- (D) AGGREGATE SHOULDER 6"±

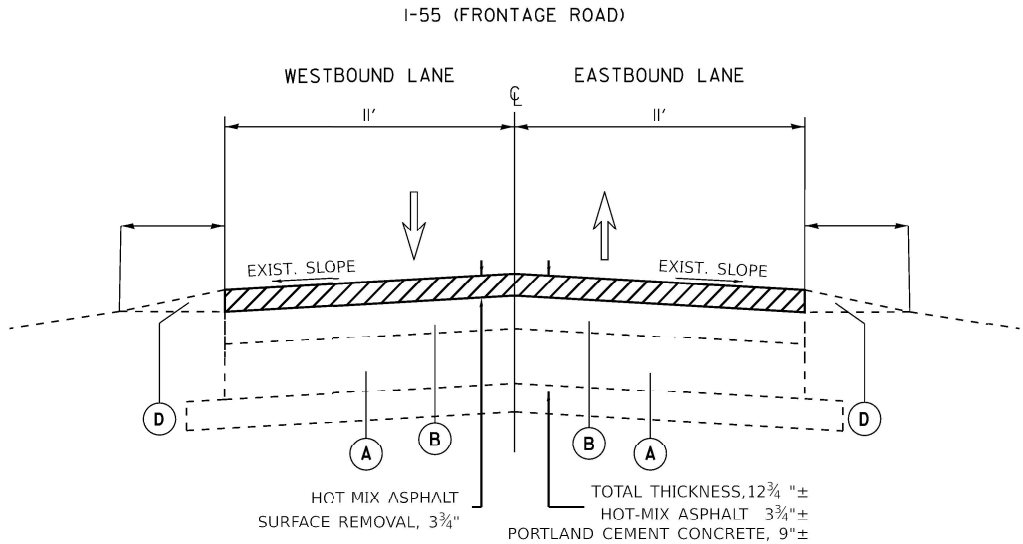

EXISTING TYPICAL

STA 15+36 TO STA 34+30
STA 59+85 TO STA 87+59

LEGEND – PROPOSED

- (1) HOT-MIX ASPHALT SURFACE COURSE, MIX "D", IL-9.5, N50, 1¾"
- (2) HOT-MIX ASPHALT BINDER COURSE, IL-9.5, N50, 2"
- (3) GRADING AND SHAPING SHOULDERS
- (4) AGGREGATE WEDGE SHOULDER, TYPE B

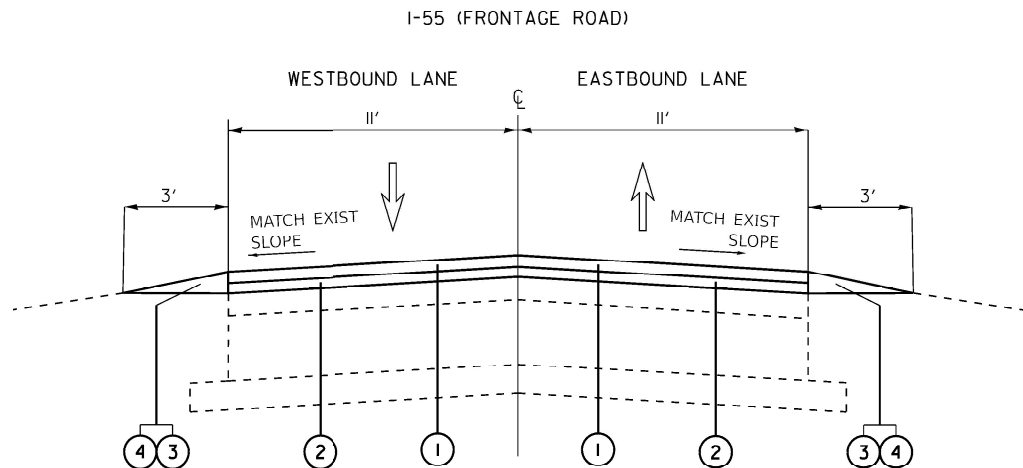

PROPOSED TYPICAL

STA 15+36 TO STA 34+30
STA 59+85 TO STA 87+59

NOTES :

NOTE 1: THE CONTRACTOR SHALL PATCH FIRST, THEN MILL.

NOTE 2: LONGITUDINAL JOINT SEALANT SHALL BE PLACED OVER THE HMA BINDER COURSE IL-9.5.

HOT-MIX ASPHALT MIXTURE REQUIREMENTS		QUALITY MANAGEMENT PROGRAM (OMP)
MIXTURE TYPE	AIR VOIDS(%) @ Ndes	
PAVEMENT		
HOT-MIX ASPHALT SURFACE COURSE, MIX "D", IL-9.5, N50, 1 3/4"	4.0% @ 50 GYR.	OCP
HOT-MIX ASPHALT BINDER COURSE, IL-9.5, N50, 2"	3.5% @ 50 GYR.	OCP
PATCHING		
CLASS D PATCHES (HMA BINDER IL-19 MM)	4% @ 70 GYR.	OC/OA
HOT-MIX ASPHALT REPLACEMENT OVER PATCHES (HMA BINDER IL-19 MM)	4% @ 70 GYR.	OC/OA
OMP DESIGNATION: QUALITY CONTROL/QUALITY ASSURANCE (OC/OA); QUALITY CONTROL FOR PERFORMANCE (OCP); PAY FOR PERFORMANCE (PFP)		

• THE UNIT WEIGHT USED TO CALCULATE ALL HOT-MIX ASPHALT SURFACE MIXTURE QUANTITIES IS 112 LBS/SQ YD/IN.

• THE "AC TYPE" FOR POLYMERIZED HMA MIXES SHALL BE "SBS/SBR PG 76 -22" AND AND FOR NON-POLYMERIZED HMA THE "AC TYPE" SHALL BE "PG 64 -22" UNLESS MODIFIED BY RECLAIMED MATERIALS SPECIFICATIONS.

	USER NAME = Nedat.Qarut	DESIGNED -	REVISED -	STATE OF ILLINOIS DEPARTMENT OF TRANSPORTATION	TYPICAL SECTION I 55 N. FRONTAGE RD: (CASS AVE. TO CLARENDON HILLS RD.)				F.A.I. RTE.	SECTION	COUNTY	TOTAL SHEETS	SHEET NO.
		DRAWN -	REVISED -						55	2023-927-RS,SW	DUPAGE	24	5
	PLOT SCALE = 100,000' / in.	CHECKED -	REVISED -						CONTRACT NO. 62W49				
	PLOT DATE = 10/25/2024	DATE -	REVISED -		ILLINOIS FED. AID PROJECT								
	SCALE:		SHEET OF SHEETS							STA. TO STA.			

LEGEND – EXISTING

- (A) PORTLAND CEMENT CONCRETE PAVEMENT 9"±
- (B) HOT-MIX ASPHALT PAVEMENT 3¾"
- (C) HOT-MIX ASPHALT SHOULDER 8"±
- (D) AGGREGATE SHOULDER 6"±

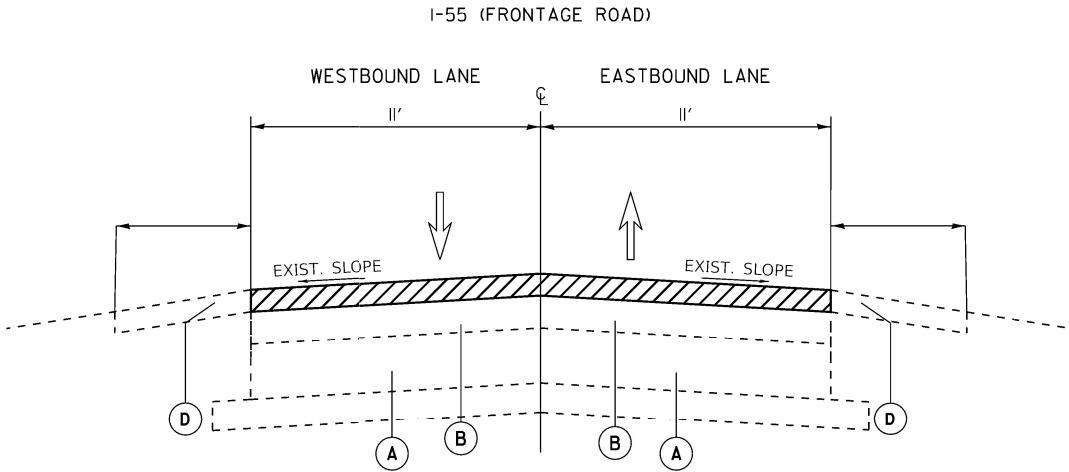

EXISTING TYPICAL

STA 34+30 - STA 59+85
STA 73+20 - STA 77+00 - SHOULDER RESURFACING

LEGEND – PROPOSED

- (1) HOT-MIX ASPHALT SURFACE COURSE, MIX 'D', IL-9.5, N50, 1¾"
- (2) HOT-MIX ASPHALT BINDER COURSE, IL-9.5, N50, 2"
- (3) GRADING AND SHAPING SHOULDERS
- (4) AGGREGATE WEDGE SHOULDER, TYPE B

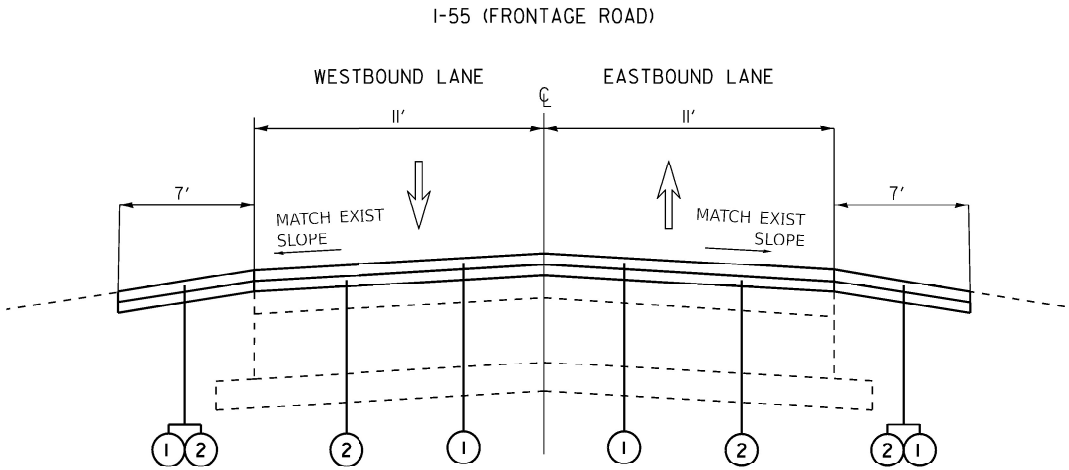

PROPOSED TYPICAL

STA 34+30 - STA 59+85
STA 73+20 - STA 77+00 - SHOULDER RESURFACING

	USER NAME = Nedat.Qarut	DESIGNED -	REVISED -	STATE OF ILLINOIS DEPARTMENT OF TRANSPORTATION	TYPICAL SECTION I 55 N. FRONTAGE RD: (CASS AVE. TO CLARENDON HILLS RD.)			F.A.I. RTE.	SECTION	COUNTY	TOTAL SHEETS	SHEET NO.
		DRAWN -	REVISED -					55	2023-927-RS,SW	DUPAGE	24	6
	PLOT SCALE = 100,000 / 1 in.	CHECKED -	REVISED -					CONTRACT NO. 62W49				
	PLOT DATE = 10/25/2024	DATE -	REVISED -		SCALE:	SHEET	OF	SHEETS	STA.	TO STA.	ILLINOIS FED. AID PROJECT	

- ROADWAY PLAN GENERAL NOTES:
- 1) LIMIT OF RESURFACING ON THE SIDE-STREETS THROUGHOUT THE PROJECT SHALL BE TO THE RADIUS RETURN, UNLESS OTHERWISE SHOWN ON PLANS, OR AS DIRECTED BY THE RESIDENT ENGINEER / TECHNICIAN.
 - 2) ALL FINAL PAVEMENT MARKINGS ON HMA SHALL BE THERMOPLASTIC PAVEMENT MARKINGS (OF THE EXTRUDED TYPE).
 - 3) ALL FINAL PAVEMENT MARKINGS SHALL BE PLACED IN ACCORDANCE WITH TC-13 "DISTRICT ONE TYPICAL PAVEMENT MARKINGS" STANDARD DETAIL.
 - 4) ALL RAISED REFLECTIVE PAVEMENT MARKERS SHALL BE PLACED IN ACCORDANCE WITH TC-11 "TYPICAL APPLICATIONS RAISED REFLECTIVE PAVEMENT MARKERS (SNOW-PLOW RESISTANT)" STANDARD DETAIL.
 - 5) BEGINNING OF NO PASSING ZONE SHALL MATCH EXISTING NPZ SIGN.

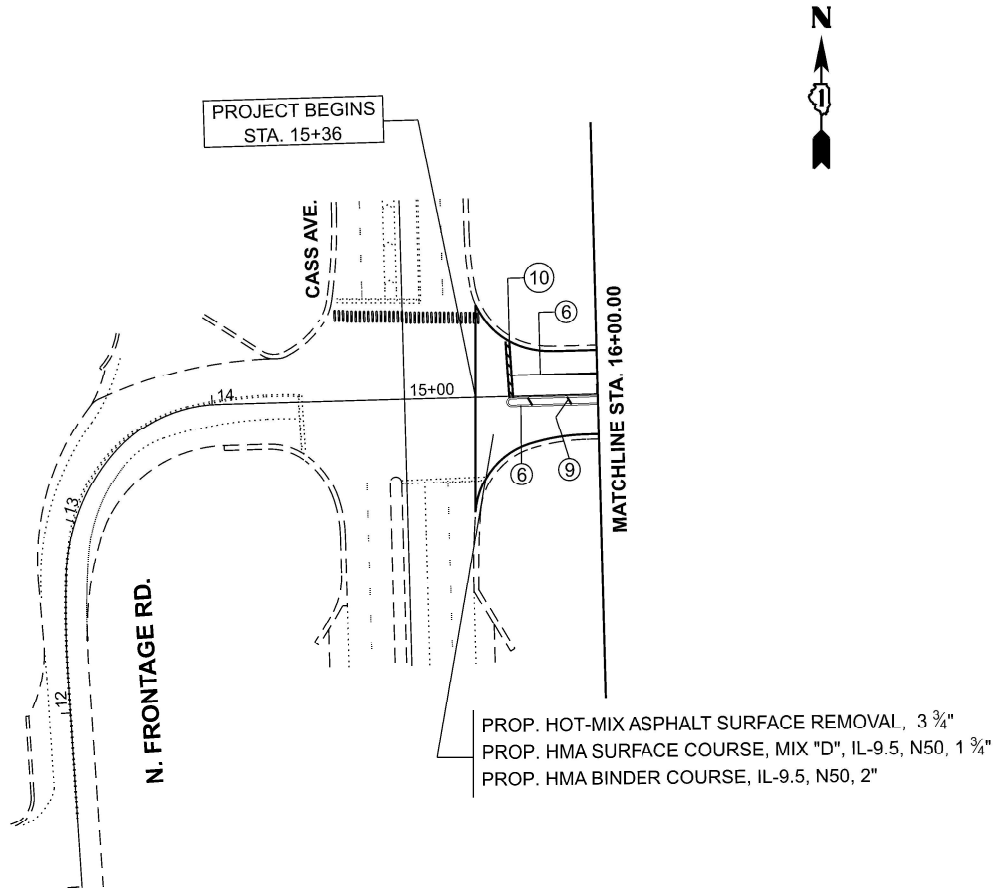

PAVEMENT MARKING LEGEND:

- 1) PROP. THERMOPLASTIC PAVEMENT MARKING, SKIP DASH, 4", 10' DASH - 30' SKIP YELLOW (TYP.)
- 2) PROP. THERMOPLASTIC PAVEMENT MARKING, EDGE LINE MARKING LINE 4", WHITE SOLID (TYP.)
- 3) PROP. THERMOPLASTIC PAVEMENT MARKING, CENTERLINE MARKING-LINE 4", YELLOW SOLID (TYP.)
- 4) PROP. THERMOPLASTIC PAVEMENT MARKING, CENTERLINE 2 @ 4" @ 11" C-C, YELLOW (TYP.)
- 5) PROP. THERMOPLASTIC PAVEMENT MARKING, DOUBLE LINES MEDIAN 4" @ 11" C-C, YELLOW (TYP.)
- 6) PROP. THERMOPLASTIC PAVEMENT MARKING LINE 6" SOLID WHITE TURN LANE (TYP.)
- 7) PROP. THERMOPLASTIC PAVEMENT MARKING LINE 12" WHITE 6' PARALLEL LINES SPACED AT 3' C-C (TYP.)
- 8) PROP. THERMOPLASTIC PAVEMENT MARKING-LINE 12", DIAGONAL @ 45° WHITE (TYP.)
- 9) PROP. THERMOPLASTIC PAVEMENT MARKING-LINE 12", DIAGONAL @ 45° YELLOW (TYP.)
- 10) PROP. THERMOPLASTIC PAVEMENT MARKING, STOP BAR, 24" WHITE (TYP.)
- 11) PROP. THERMOPLASTIC PAVEMENT MARKING, LETTERS & SYMBOLS, WHITE SOLID (TYP.)

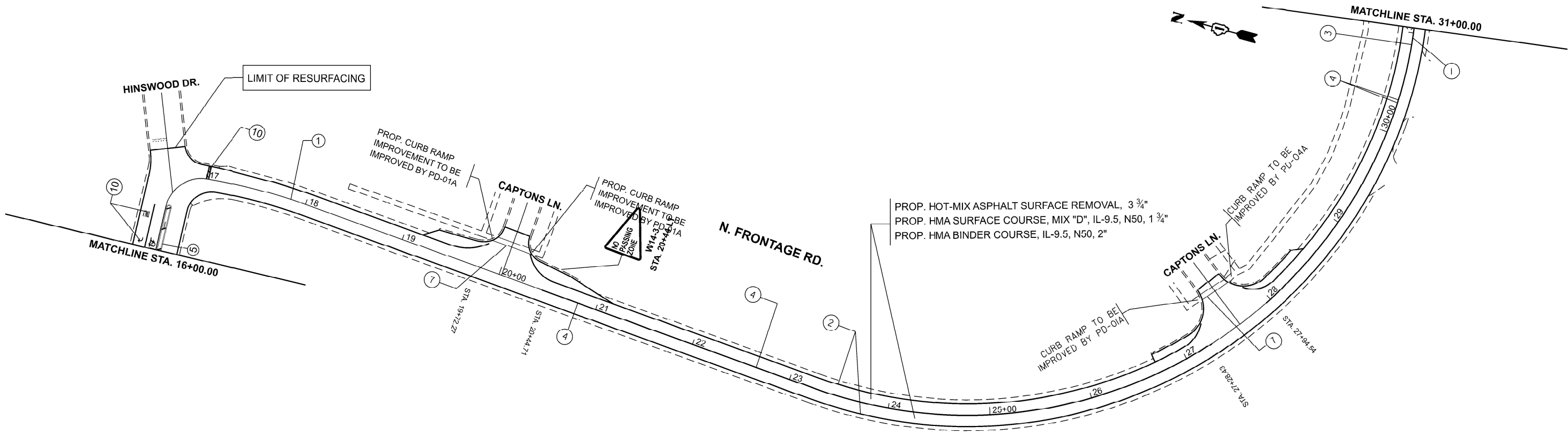

MODEL: I56_E - RoadPlan_1 [Sheet]
FILE NAME: c:\pwworking\qarut\mcd0926529\I-13324-shr-plan.dgn

USER NAME	= Nedal.Qarut	DESIGNED	-	REVISED	-
		DRAWN	-	REVISED	-
PLOT SCALE	= 0.16666633' / in.	CHECKED	-	REVISED	-
PLOT DATE	= 11/27/2024	DATE	-	REVISED	-

STATE OF ILLINOIS
DEPARTMENT OF TRANSPORTATION

ROADWAY AND PAVEMENT MARKING PLAN
I-55 N. FRONTAGE RD. (CASS AVE. TO CLARENDON HILLS RD.)

SCALE: SHEET 1 OF 4 SHEETS STA. 10+00.00 TO STA. 31+00.00

F.A.I RTE.	SECTION	COUNTY	TOTAL SHEETS	SHEET NO.
55	2023-927-RS,SW	DUPAGE	24	7
CONTRACT NO. 62W49				
ILLINOIS FED. AID PROJECT				

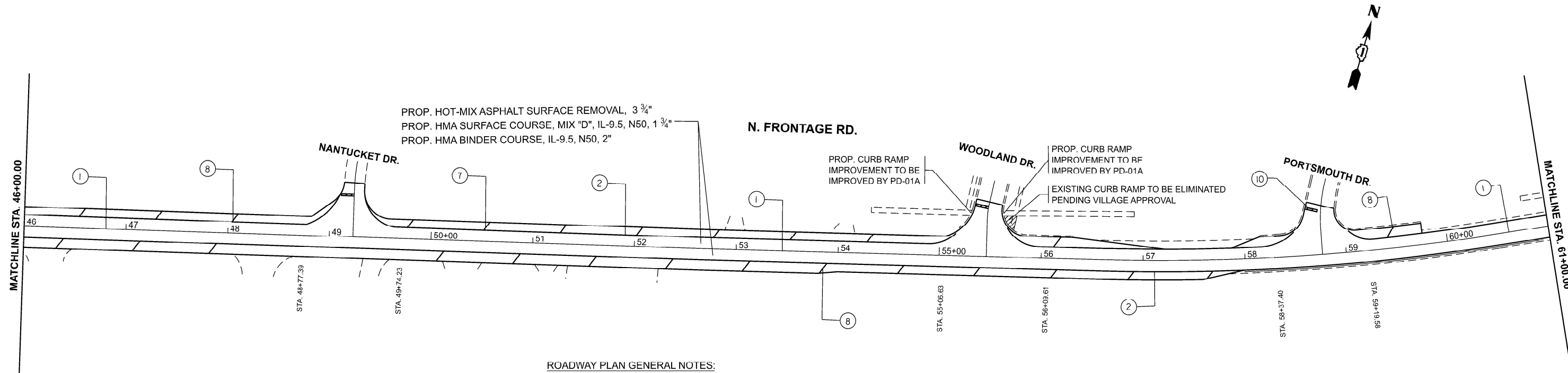
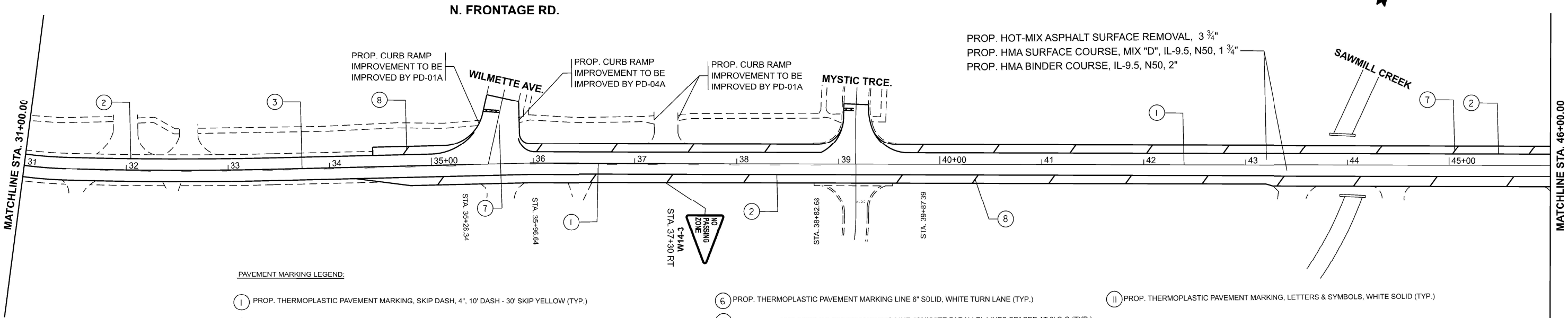

MODEL: I55_E - RoadPlan 3 (Sheet)
FILE NAME: c:\pwworking\qarut\m0926529\I-13324-shr-plan.dgn

USER NAME = Nedal.Qarut	DESIGNED -	REVISED -
	DRAWN -	REVISED -
PLOT SCALE = 0.16666633' / in.	CHECKED -	REVISED -
PLOT DATE = 11/27/2024	DATE -	REVISED -

STATE OF ILLINOIS
DEPARTMENT OF TRANSPORTATION

ROADWAY AND PAVEMENT MARKING PLAN
I-55 N. FRONTAGE RD. (CASS AVE. TO CLARENDON HILLS RD.)

SCALE: 1"=50' SHEET 2 OF 4 SHEETS STA. 31+00.00 TO STA. 61+00.00

F.A.I RTE.	SECTION	COUNTY	TOTAL SHEETS	SHEET NO.
55	2023-927-RS,SW	DUPAGE	24	8
CONTRACT NO. 62W49				
ILLINOIS FED. AID PROJECT				

MODEL: I55_E - RdwyPlan 5 (Sheet)
FILE NAME: c:\pwworking\dupage\mfd0926529\I-13324-shr-plan.dgn

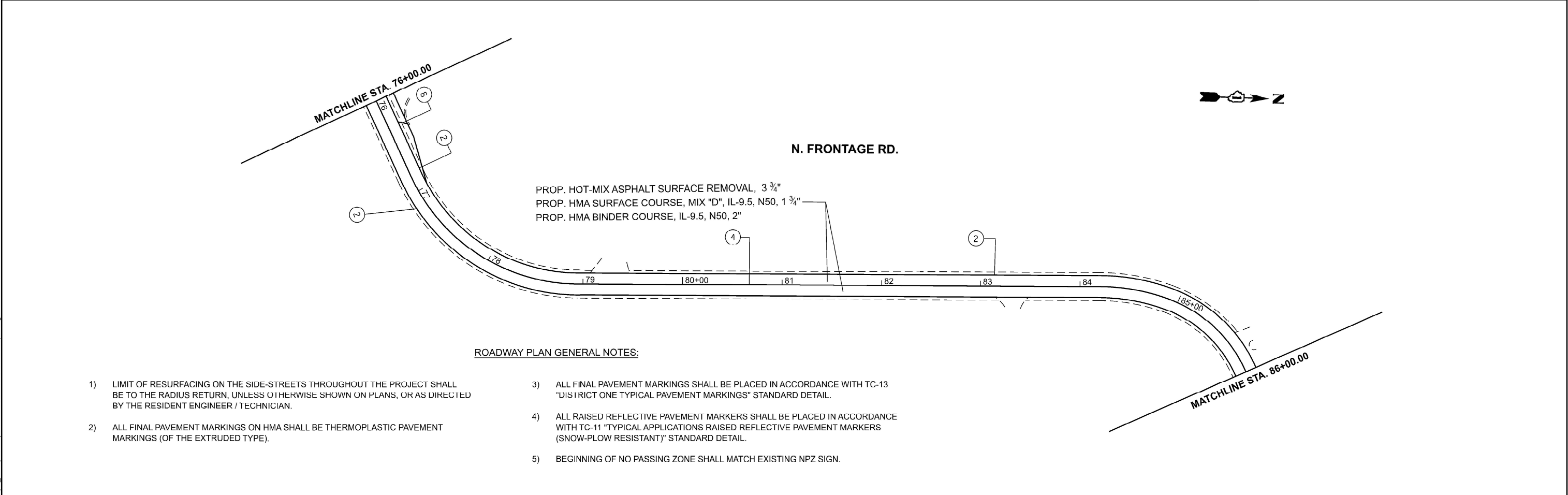
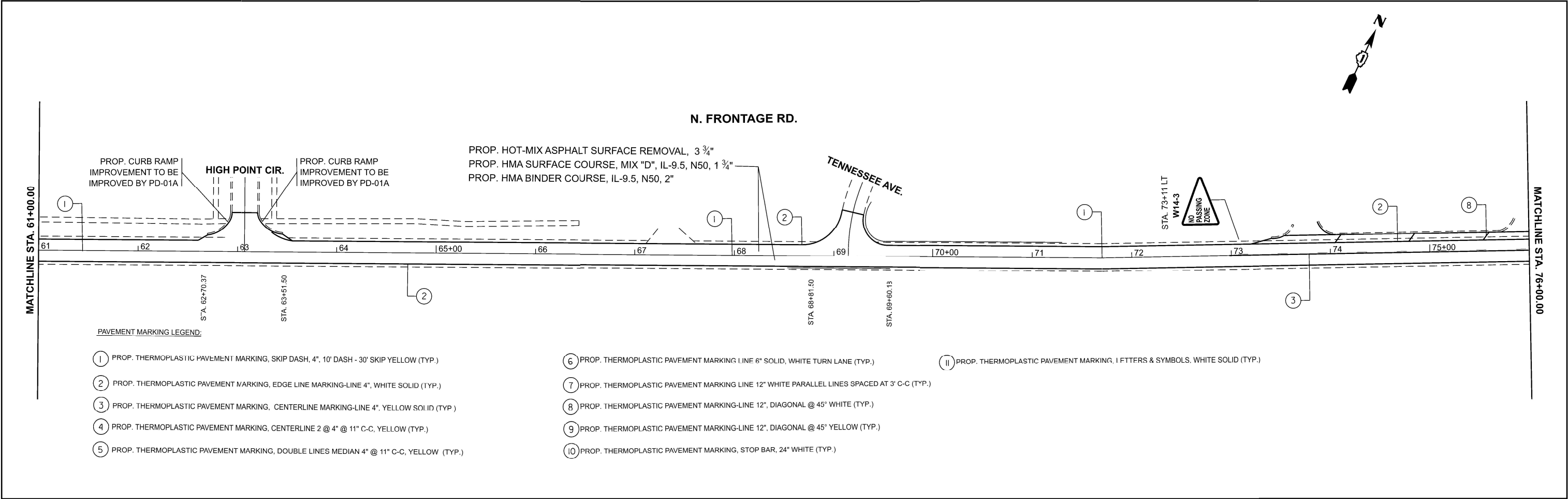

	USER NAME = Nedal.Qarut	DESIGNED -	REVISED -	STATE OF ILLINOIS DEPARTMENT OF TRANSPORTATION	ROADWAY AND PAVEMENT MARKING PLAN I-55 N. FRONTAGE RD. (CASS AVE. TO CLARENDON HILLS RD.)				F.A.I RTE.	SECTION	COUNTY	TOTAL SHEETS	SHEET NO.
	PLOT SCALE = \$SCALE\$	DRAWN -	REVISED -						55	2023-927-RS,SW	DUPAGE	24	9
	PLOT DATE = 11/27/2024	CHECKED -	REVISED -		SCALE: 1"=50'				CONTRACT NO. 62W49				
		DATE -	REVISED -		SHEET 3	OF 4	SHEETS	STA. 61+00.00	TO STA. 86+00.00				

ILLINOIS | FED. AID PROJECT

MODEL: I55_E - RoadPlan 7 [Sheet]
FILE NAME: c:\pwworking\qarunm\0926529\013324-sht-plan.dgn

N. FRONTAGE RD.

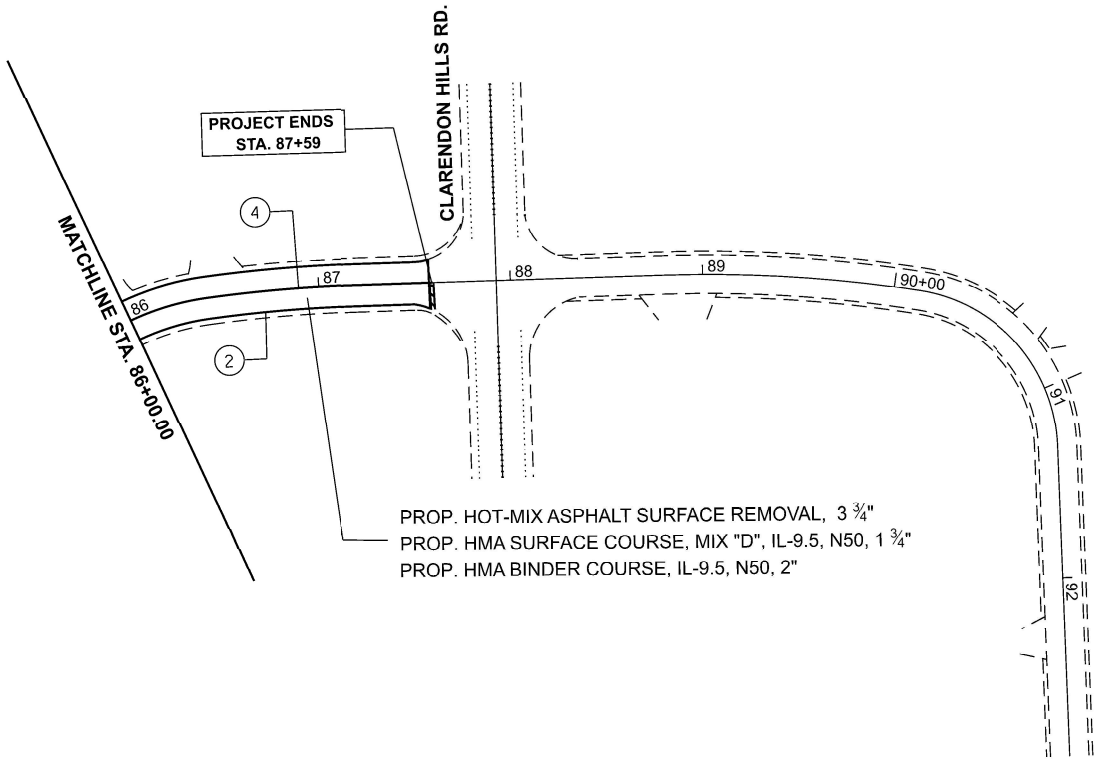

ROADWAY PLAN GENERAL NOTES:

- 1) LIMIT OF RESURFACING ON THE SIDE-STREETS THROUGHOUT THE PROJECT SHALL BE TO THE RADIUS RETURN, UNLESS OTHERWISE SHOWN ON PLANS, OR AS DIRECTED BY THE RESIDENT ENGINEER / TECHNICIAN.
- 2) ALL FINAL PAVEMENT MARKINGS ON HMA SHALL BE THERMOPLASTIC PAVEMENT MARKINGS (OF THE EXTRUDED TYPE).
- 3) ALL FINAL PAVEMENT MARKINGS SHALL BE PLACED IN ACCORDANCE WITH TC-13 "DISTRICT ONE TYPICAL PAVEMENT MARKINGS" STANDARD DETAIL.
- 4) ALL RAISED REFLECTIVE PAVEMENT MARKERS SHALL BE PLACED IN ACCORDANCE WITH TC-11 "TYPICAL APPLICATIONS RAISED REFLECTIVE PAVEMENT MARKERS (SNOW-PLOW RESISTANT)" STANDARD DETAIL.
- 5) BEGINNING OF NO PASSING ZONE SHALL MATCH EXISTING NPZ SIGN.

PAVEMENT MARKING LEGEND:

- 1) PROP. THERMOPLASTIC PAVEMENT MARKING, SKIP DASH, 4", 10' DASH - 30' SKIP YELLOW (TYP.)
- 2) PROP. THERMOPLASTIC PAVEMENT MARKING, EDGE LINE MARKING LINE 4", WHITE SOLID (TYP.)
- 3) PROP. THERMOPLASTIC PAVEMENT MARKING, CENTERLINE MARKING-LINE 4", YELLOW SOLID (TYP.)
- 4) PROP. THERMOPLASTIC PAVEMENT MARKING, CENTERLINE 2 @ 4" @ 11" C-C, YELLOW (TYP.)
- 5) PROP. THERMOPLASTIC PAVEMENT MARKING, DOUBLE LINES MEDIAN 4" @ 11" C-C, YELLOW (TYP.)
- 6) PROP. THERMOPLASTIC PAVEMENT MARKING LINE 6" SOLID WHITE TURN LANE (TYP.)
- 7) PROP. THERMOPLASTIC PAVEMENT MARKING LINE 12" WHITE PARALLEL LINES SPACED AT 3' C-C (TYP.)
- 8) PROP. THERMOPLASTIC PAVEMENT MARKING-LINE 12", DIAGONAL @ 45° WHITE (TYP.)
- 9) PROP. THERMOPLASTIC PAVEMENT MARKING-LINE 12", DIAGONAL @ 45° YELLOW (TYP.)
- 10) PROP. THERMOPLASTIC PAVEMENT MARKING, STOP BAR, 24" WHITE (TYP.)
- 11) PROP. THERMOPLASTIC PAVEMENT MARKING, LETTERS & SYMBOLS, WHITE SOLID (TYP.)

	USER NAME = Nedal.Qarut	DESIGNED -	REVISED -	STATE OF ILLINOIS DEPARTMENT OF TRANSPORTATION	ROADWAY AND PAVEMENT MARKING PLAN I-55 N. FRONTAGE RD. (CASS AVE. TO CLARENDON HILLS RD.)			F.A.I RTE.	SECTION	COUNTY	TOTAL SHEETS	SHEET NO.
		DRAWN -	REVISED -					55	2023-927-RS,SW	DUPAGE	24	10
	PLOT SCALE = \$SCALE\$	CHECKED -	REVISED -					CONTRACT NO. 62W49				
	PLOT DATE = 11/27/2024	DATE -	REVISED -		SCALE: 1"=50'	SHEET 4	OF 4 SHEETS	STA. 86+00.00	TO STA. 101+00.00	ILLINOIS FED. AID PROJECT		

1. THE WORK SHALL MEET THE REQUIREMENTS OF THE SPECIAL PROVISION, "DETECTOR LOOP REPLACEMENT AND/OR INSTALLATION (ROADWAY GRINDING, RESURFACING & PATCHING OPERATIONS).
2. THIS PLAN IS FOR THE SOLE PURPOSE OF DETECTOR LOOP REPLACEMENT.
3. THE PROPOSED LOOPS ARE TO BE CENTERED ON THE LANE.

CODE	ITEM	QUANTITY	UNIT
88600600	DETECTOR LOOP REPLACEMENT	222	FOOT

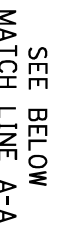

MATCH LINE A-A
SEE ABOVE

F.A.I. RTE.	SECTION	COUNTY	TOTAL SHEETS	SHEET NO.
55	2023-927-RS,SW	DUPAGE	24	11
		CONTRACT NO. 62W49		
ILLINOIS		FED. AID PROJECT		

MODEL: Default
FILE NAME: S:\WIP\Design\Ivan\02_InHouse_Design\Let1_Phase2\627W49_Cass@1-55FrontageRd\LogoReplacement\627W49-shr-ts.dgn

ADA DETAIL FOR SINGLE PERPENDICULAR CURB RAMPS W/ EXIST. 5% OR LESS RUN. SLOPE

PD-01A

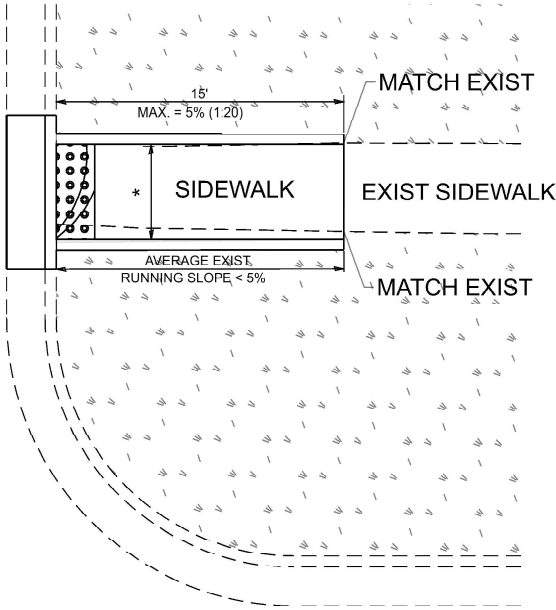

PD-01B

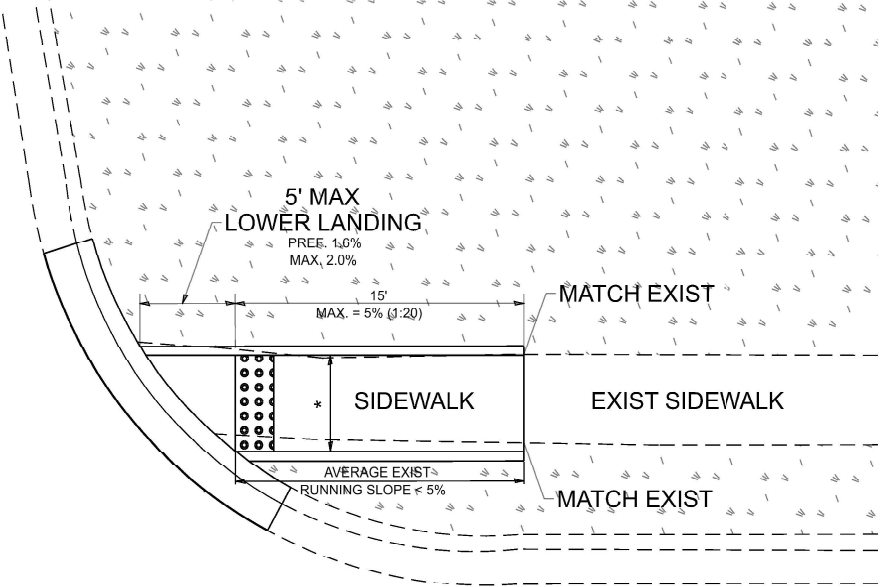

PD-01C

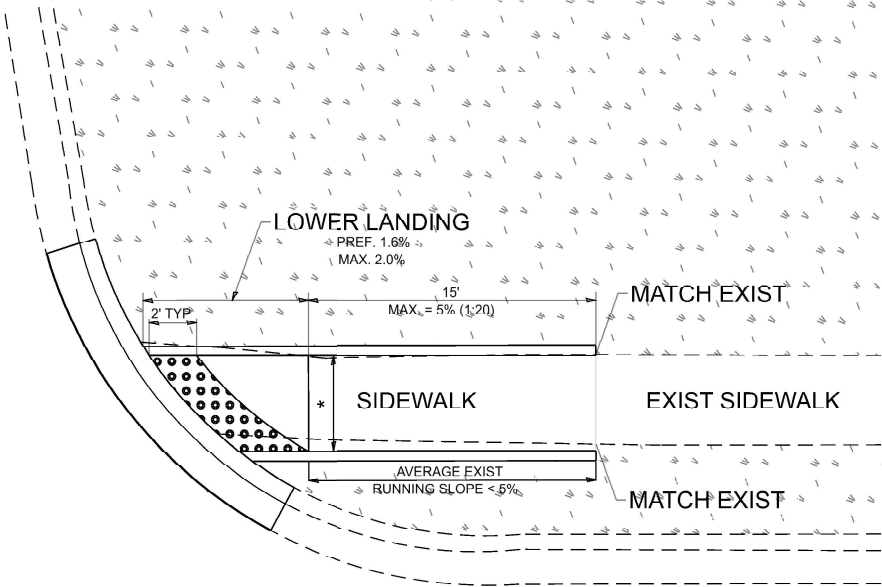

LEGEND

- EXIST. GRASS
- PROPOSED SIDEWALK
- PROPOSED SIDE CURB
- DETECTABLE WARNINGS

CONSTRUCTION NOTES:

- 1) ALL CROSS SLOPES ARE PREFERRED 1.6% (1:64), MAXIMUM 2% (1:50) EXCEPT WHEN TRANSITIONING TO EXISTING SIDEWALK
- * MATCH EXISTING SIDEWALK WIDTH

STATE OF ILLINOIS
DEPARTMENT OF TRANSPORTATION

PROJECT DETAIL FOR SINGLE PERPENDICULAR CURB RAMPS
(PD-01)

SCALE: NONE SHEET 1 OF 1 SHEETS STA. TO STA.

F.A.I RTE.	SECTION	COUNTY	TOTAL SHEETS	SHEET NO.
55	2023-927-RS,SW	DUPAGE	24	12
PD-01		CONTRACT NO. 62W49		
ILLINOIS		FED. AID PROJECT		

USER NAME	= eric.l.thomas	DESIGNED	-	REVISED	-
DRAWN	- R. LEDEZMA	CHECKED	-	REVISED	-
PLOT SCALE	= 0.16666633' / in	DATE	- 10/02/2019	REVISED	-
PLOT DATE	= 8/30/2023				

ADA DETAIL FOR SINGLE PERPENDICULAR CURB RAMPS W/ EXIST. 5% OR GREATER RUN. SLOPE

PD-02A

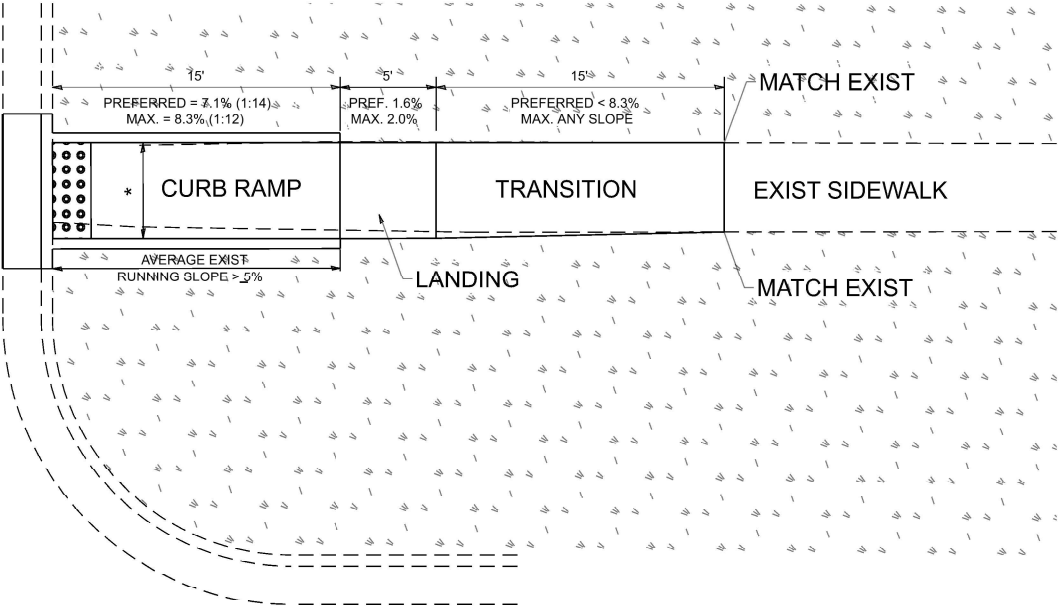

PD-02B

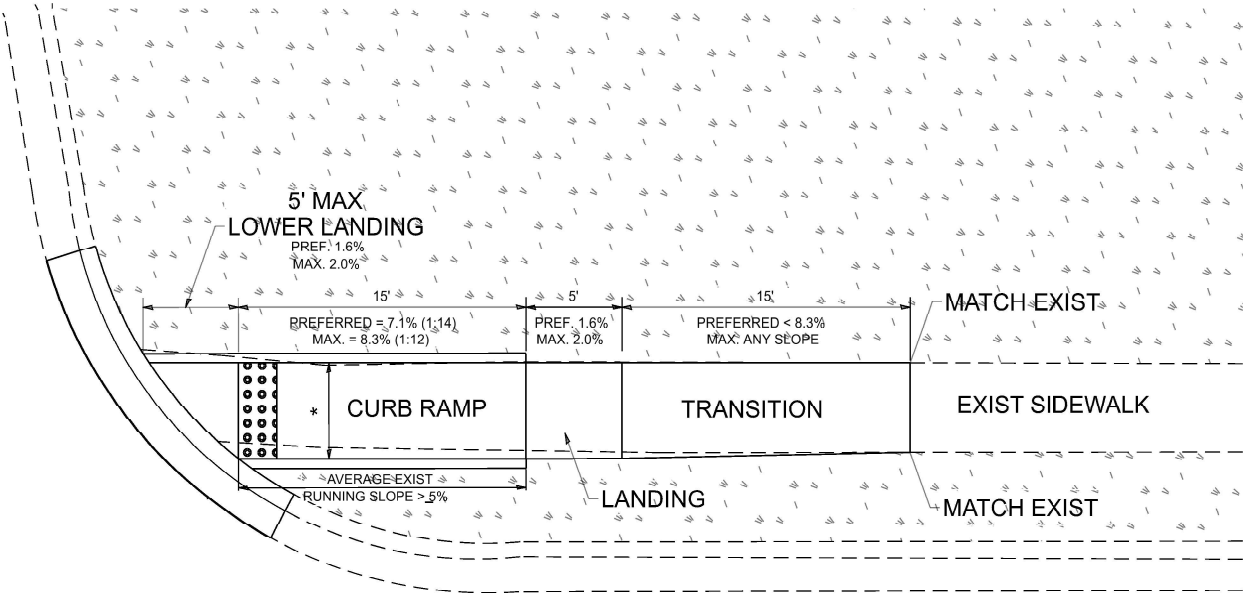

PD-02C

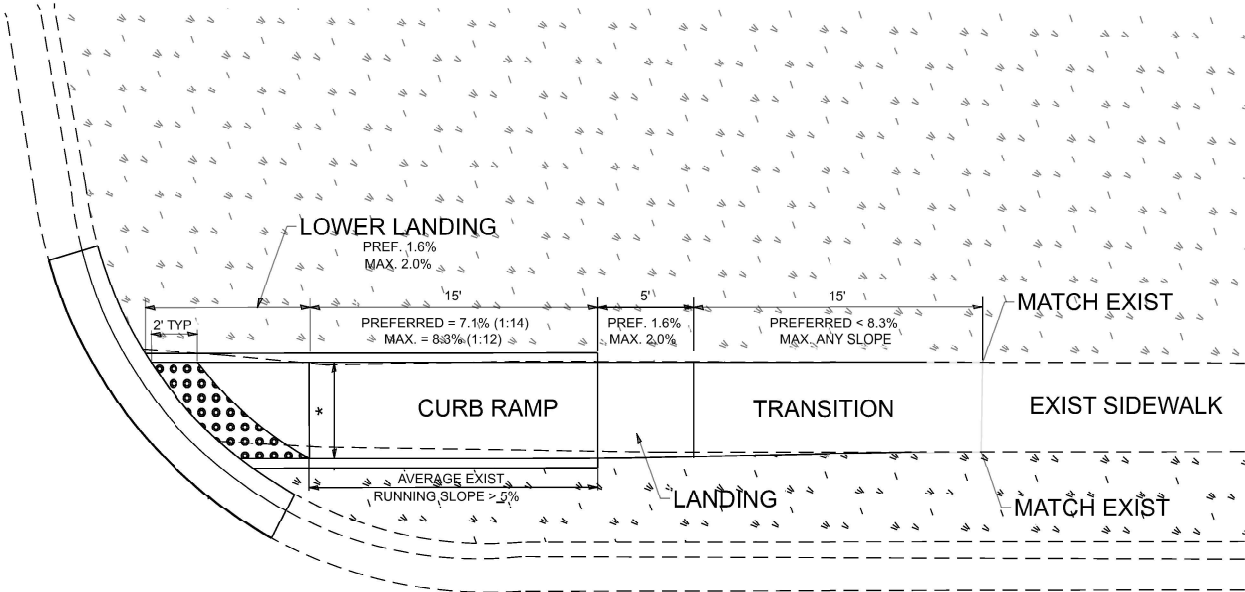

LEGEND

PROPOSED SIDE CURB

EXIST. GRASS

PROPOSED SIDEWALK

DETECTABLE WARNINGS

CONSTRUCTION NOTES:

1) ALL CROSS SLOPES ARE PREFERRED 1.6% (1:64), MAXIMUM 2% (1:50) EXCEPT WHEN TRANSITIONING TO EXISTING SIDEWALK

* MATCH EXISTING SIDEWALK WIDTH

STATE OF ILLINOIS
DEPARTMENT OF TRANSPORTATION

PROJECT DETAIL FOR SINGLE PERPENDICULAR CURB RAMPS
(PD-02)

SCALE: NONE SHEET 1 OF 1 SHEETS STA. TO STA.

F.A.I RTE.	SECTION	COUNTY	TOTAL SHEETS	SHEET NO.
55	2023-927-RS,SW	DUPAGE	24	13
PD-02		CONTRACT NO. 62W49		
ILLINOIS		FED. AID PROJECT		

MODEL: Plan Single (Sheet)
FILE NAME: Z:\DOT\CAD ORD Folder Master\Master Files\DOTCAD_Connect\Configuration\Organization-Civil\DOT_Standards\Details\Sheet Seeds\Civil_Named_Boundary_SheetSeeds.dgn

ADA DETAIL FOR DOUBLE PERPENDICULAR CURB RAMPS

PD-03A

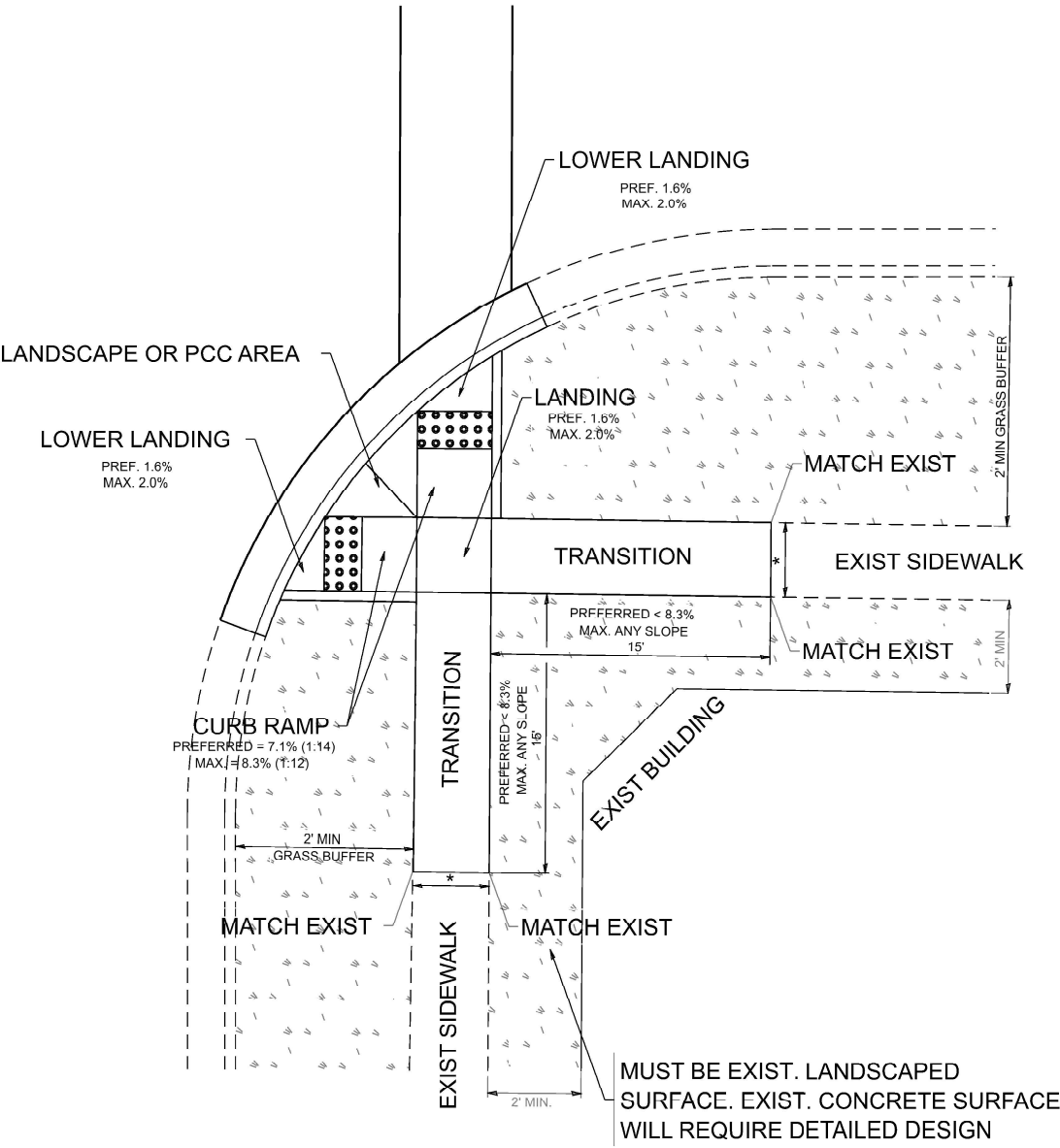

PD-03B

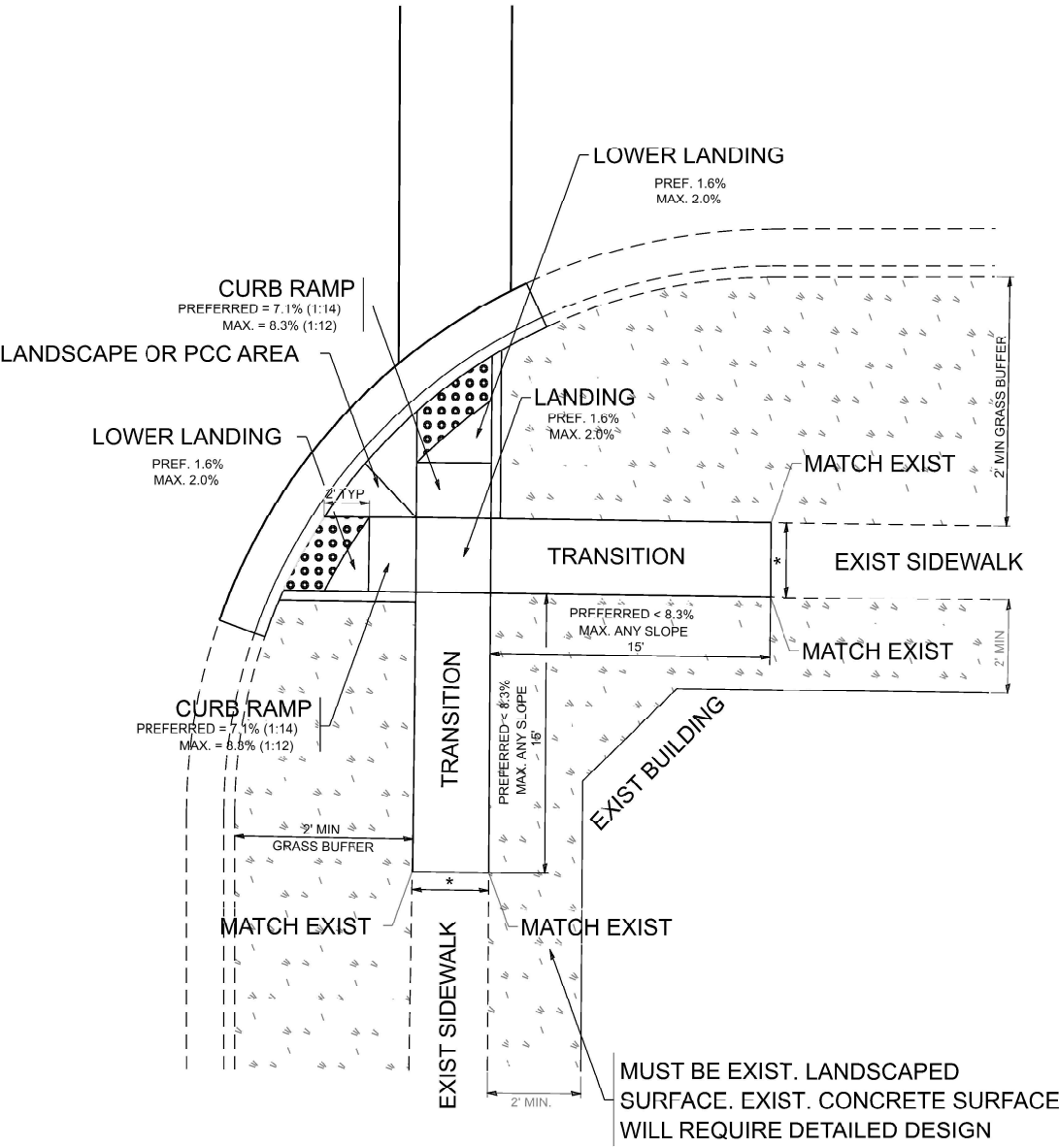

LEGEND

PROPOSED SIDE CURB

EXIST. GRASS

PROPOSED SIDEWALK

DETECTABLE WARNINGS

CONSTRUCTION NOTES:

- 1) ALL CROSS SLOPES ARE PREFERRED 1.6% (1:64), MAXIMUM 2% (1:50) EXCEPT WHEN TRANSITIONING TO EXISTING SIDEWALK
- * MATCH EXISTING SIDEWALK WIDTH

STATE OF ILLINOIS
DEPARTMENT OF TRANSPORTATION

PROJECT DETAIL FOR DOUBLE PERPENDICULAR CURB RAMPS
(PD-03)

SCALE: NONE SHEET 1 OF 1 SHEETS STA. TO STA.

F.A.I RTE.	SECTION	COUNTY	TOTAL SHEETS	SHEET NO.
55	2023-927-RS,SW	DUPAGE	24	14
PD-03		CONTRACT NO. 62W49		
ILLINOIS		FED. AID PROJECT		

MODEL: Plan Styles (Sheet)
FILE NAME: Z:\DOT\CAD OPD Folder Master\Master Files\DOTCAD CONNECT\Configuration\Organization-Civil\DOT_Standards\Details\Sheet Sections.dgn

ADA DETAIL FOR SINGLE PERPENDICULAR CURB RAMPS W/ TURNING SPACE

PD-04A

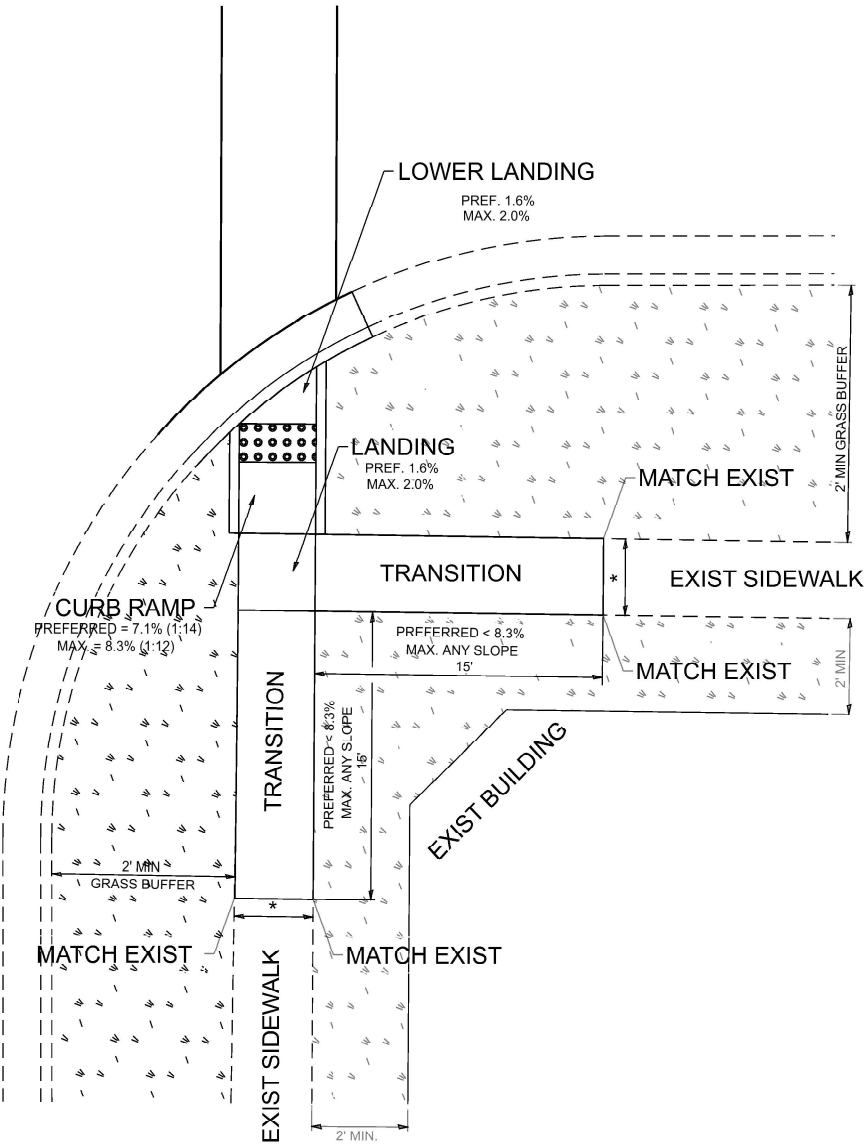

PD-04B

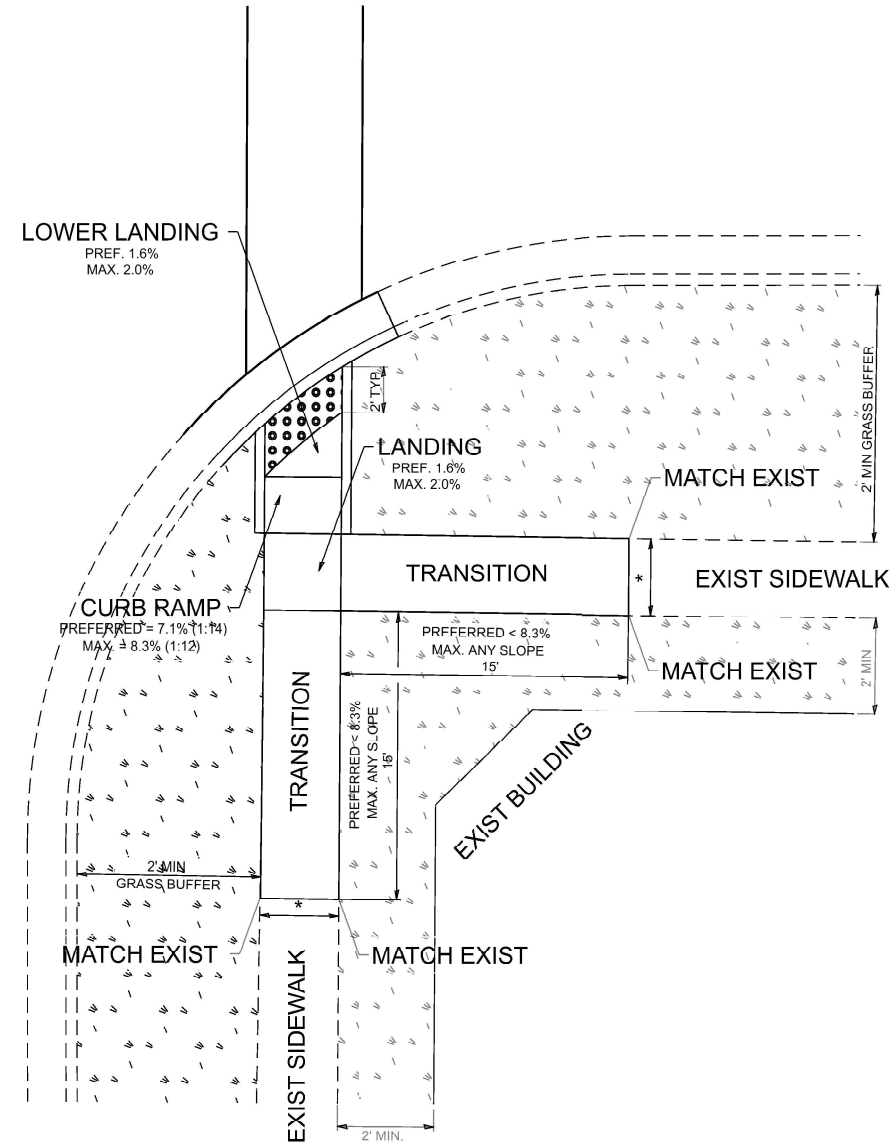

LEGEND

PROPOSED SIDE CURB



EXIST. GRASS



PROPOSED SIDEWALK



DETECTABLE WARNINGS

CONSTRUCTION NOTES:

1) ALL CROSS SLOPES ARE PREFERRED 1.6% (1:64), MAXIMUM 2% (1:50) EXCEPT WHEN TRANSITIONING TO EXISTING SIDEWALK

* MATCH EXISTING SIDEWALK WIDTH

STATE OF ILLINOIS
DEPARTMENT OF TRANSPORTATION

PROJECT DETAIL FOR SINGLE PERPENDICULAR CURB RAMPS WITH
TURNING SPACE (PD-04)

SCALE: NONE SHEET 1 OF 1 SHEETS STA. TO STA.

USER NAME	= eric.l.thomas	DESIGNED	-	REVISED	-
DRAWN	- R. LEDEZMA	REVISION	-	REVISION	-
PLOT SCALE	= 0.16666633' / in	CHECKED	-	REVISION	-
PLOT DATE	= 8/30/2023	DATE	= 10/02/2019	REVISION	-

F.A.I RTE.	SECTION	COUNTY	TOTAL SHEETS	SHEET NO.
55	2023-927-RS,SW	DUPAGE	24	15
PD-04		CONTRACT NO. 62W49		
ILLINOIS		FED. AID PROJECT		

MODEL: Plan Single Sheet
FILE NAME: Z:\DOT\CAD\ORD\Folder Master\Master Files\DOT\CAD\CONNECT\Configuration\Organization-Civil\DOT_Standards\Detail\Sheet Seeds\Civil_Named_Boundary_SheetSeeds.dgn

MODEL: Plan Single (Sheet)
FILE NAME: Z:\DOT\CAD_ORF\Folder Master\Master Files\DOTCAD_CONNECT\Configuration\Organization-Civil\DOT_Standards\Detail\Sheet Seeds\Civil_Named_Boundary_Sheet\Seeds.dgnlb

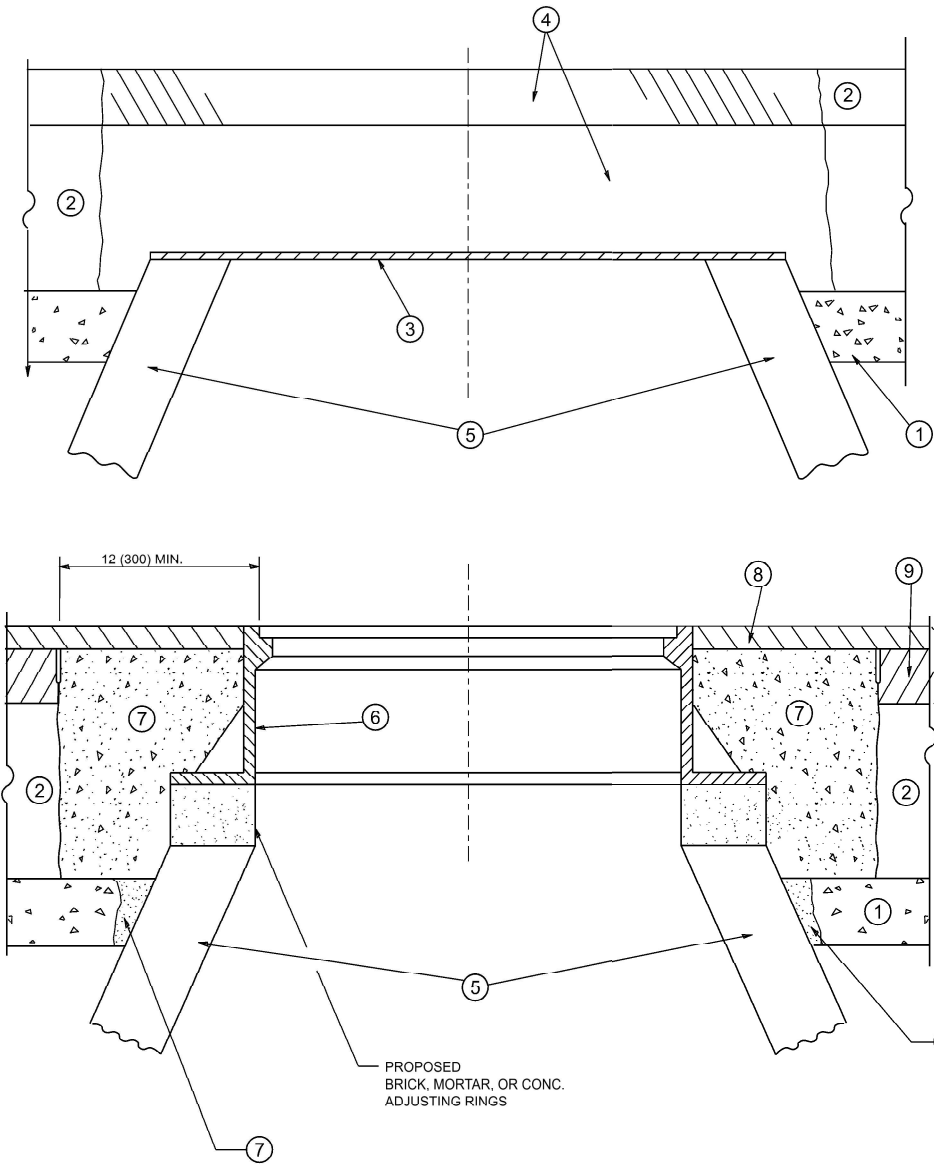

**DETAILS FOR FRAMES AND LIDS ADJUSTMENT
WITH MILLING**

NOTES

- EXISTING BROKEN FRAMES AND LIDS SHALL BE REMOVED AND DISPOSED OF BY THE CONTRACTOR AND SHALL BE REPLACED AS DIRECTED BY THE ENGINEER. REPLACEMENT FRAMES AND LIDS WILL BE PAID FOR IN ACCORDANCE WITH ARTICLE 109.04 OF THE STANDARD SPECIFICATIONS UNLESS A SEPARATE PAY ITEM HAS BEEN PROVIDED.
- IF THE EXISTING LIDS ARE OPEN, THE FRAME WILL BE ADJUSTED TO THE ELEVATION OF THE MILLED PAVEMENT SURFACE PRIOR TO THE MILLING OPERATION. THE FRAME WILL NOT BE REMOVED AND COVERED BY THE METAL PLATE.
- CITY OF CHICAGO CASTINGS ARE THE PROPERTY OF THE CITY AND THE CONTRACTOR SHALL NOTIFY THE CITY FOR REMOVAL AND DISPOSITION OF THE CASTINGS.
- THE METAL PLATE USED TO COVER THE STRUCTURE SHALL REMAIN THE PROPERTY OF THE CONTRACTOR.
- THE CONTRACTOR SHALL REMOVE ALL TRAFFIC CONTROL DEVICES BY THE END OF EACH WORK SHIFT.

CONSTRUCTION PROCEDURES

STAGE 1 (BEFORE PAVEMENT MILLING)

- REMOVE A MINIMUM OF 12 (300) OF THE PAVEMENT FROM AROUND THE STRUCTURE.
- REMOVE THE EXISTING FRAME AND LID FROM THE STRUCTURE.
- COVER THE STRUCTURE OPENING WITH A 36 (900) DIAMETER METAL PLATE.
- BACKFILL WITH CRUSHED STONE AND HMA SURFACE MIX APPROVED BY THE ENGINEER. (MIN. 3 (80) HMA TO REMAIN AFTER MILLING).

STAGE 2 (AFTER PAVEMENT MILLING)

- REMOVE THE HMA SURFACE MIX AND CRUSHED STONE.
- INSTALL THE FRAME AND LID; ADJUST THE FRAME TO ITS FINAL SURFACE ELEVATION.
- THE SURROUNDING SPACE SHALL BE FILLED WITH CLASS PP-2* CONCRETE TO THE ELEVATION OF THE SURFACE OF THE EXISTING BASE COURSE OR THE BINDER COURSE.

* UNLESS OTHERWISE SPECIFIED IN THE PLANS.

THE PROCEDURE EXPLAINED ABOVE SHALL CONFORM TO THE APPLICABLE PORTIONS OF SECTIONS 353, 406, 602, AND 603 OF THE STANDARD SPECIFICATIONS EXCEPT THAT "THE CONTRACTOR SHALL ADJUST THE STRUCTURES TO THE FINISHED PAVEMENT ELEVATION NO MORE THAN 5 CALENDAR DAYS PRIOR TO PLACEMENT OF THE FINAL LIFT OF SURFACE UNLESS APPROVED BY THE ENGINEER."

LEGEND

- | | |
|--|-------------------------------|
| ① SUB-BASE GRANULAR MATERIAL | ⑥ FRAME AND LID (SEE NOTES) |
| ② EXISTING PAVEMENT | ⑦ CLASS PP-2* CONCRETE |
| ③ 36 (900) DIAMETER METAL PLATE | ⑧ PROPOSED HMA SURFACE COURSE |
| ④ PROPOSED CRUSHED STONE AND HMA SURFACE MIX | ⑨ PROPOSED HMA BINDER COURSE |
| ⑤ EXISTING STRUCTURE | |

LOCATION OF STRUCTURES

THE CONTRACTOR WILL BE REQUIRED TO KEEP A RECORD OF THE LOCATIONS OF THE BURIED STRUCTURES ACCORDING TO THE STATION AND DISTANCE LEFT OR RIGHT OF THE CENTERLINE OF PAVEMENT. UPON COMPLETION OF THE WORK, THE CONTRACTOR WILL DELIVER THE RECORD TO THE ENGINEER.

BASIS OF PAYMENT

- REMOVING FRAMES AND LIDS ON DRAINAGE AND UTILITY STRUCTURES IN THE PAVEMENT PRIOR TO MILLING, AND ADJUSTING TO FINAL GRADE PRIOR TO PLACING THE SURFACE COURSE, WILL BE PAID FOR AT THE CONTRACT UNIT PRICE EACH FOR "FRAMES AND LIDS TO BE ADJUSTED (SPECIAL)."
- THIS WORK WILL NOT BE PAID FOR WHEN DRAINAGE AND UTILITY STRUCTURES ARE SPECIFIED FOR PAYMENT AS STRUCTURE RECONSTRUCTION.
- NEW FRAMES AND LIDS, WHEN SPECIFIED, WILL BE PAID FOR SEPARATELY.
- WHEN STRUCTURES ARE TO BE ADJUSTED OR RECONSTRUCTED, THE LOWERING AND RAISING OF THE FRAMES AND LIDS WILL NOT BE PAID FOR SEPARATELY BUT WILL BE INCLUDED IN THE COST OF THE CORRESPONDING PAY ITEM.

ALL DIMENSIONS ARE IN INCHES (MILLIMETERS) UNLESS OTHERWISE SHOWN

	USER NAME = eric.l.thomas	DESIGNED - R. SHAH	REVISED - R. BORO 03-09-11	STATE OF ILLINOIS DEPARTMENT OF TRANSPORTATION	DETAILS FOR FRAMES AND LIDS ADJUSTMENT WITH MILLING	SCALE: NONE	SHEET 1	OF 1	SHEETS	STA.	TO STA.	F&I RTE.	SECTION	COUNTY	TOTAL SHEETS	SHEET NO.
		DRAWN -	REVISED - R. BORO 12-06-11									55	2023-927-RS,SW	DUPAGE	24	16
	PLOT SCALE = \$SCALE\$	CHECKED -	REVISED - K. SMITH 11-18-22									BD600-03 (BD-08)		CONTRACT NO. 62W49		
	PLOT DATE = 8/30/2023	DATE - 10-25-94	REVISED - K. SMITH 09-15-23									ILLINOIS FED. AID PROJECT				

METHOD OF MEASUREMENT

REFER TO SECTION 442 OF THE STANDARD SPECIFICATIONS FOR ROAD AND BRIDGE CONSTRUCTION AND THE RECURRING SPECIAL PROVISION "PATCHING WITH HOT-MIX ASPHALT OVERLAY REMOVAL."

BASIS OF PAYMENT

- 1. REFER TO SECTION 442 OF THE STANDARD SPECIFICATIONS FOR ROAD AND BRIDGE CONSTRUCTION AND THE RECURRING SPECIAL PROVISION "PATCHING WITH HOT-MIX ASPHALT OVERLAY REMOVAL."
- 2. SAW CUT/SCORING OF EXISTING HMA OVERLAY IS INCLUDED IN THE COST OF PAVEMENT PATCHING.
- 3. SAW CUT/SCORING OF EXISTING PAVEMENT IS INCLUDED IN THE COST OF PAVEMENT PATCHING.

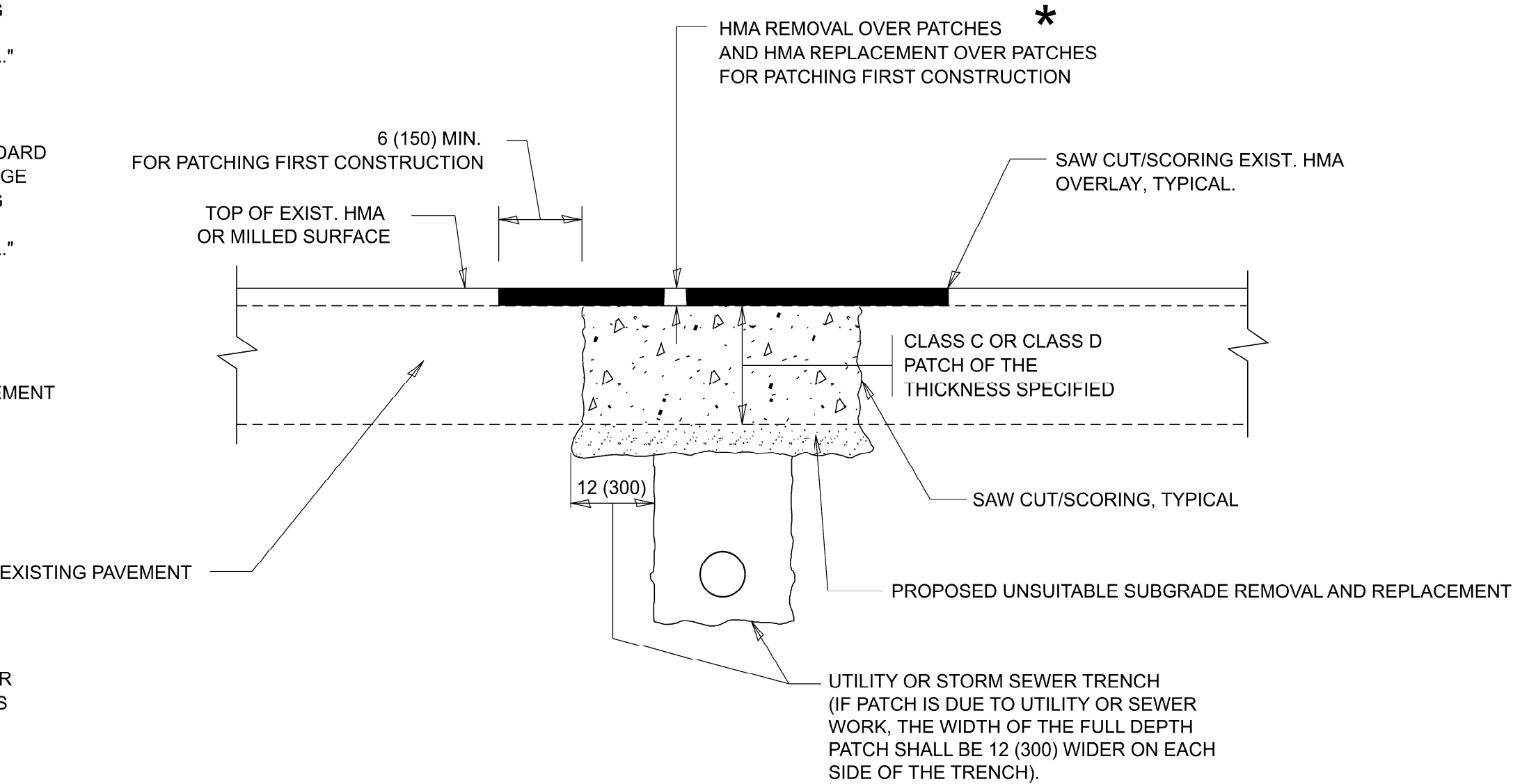

* SEE TYPICAL SECTIONS FOR THICKNESS AND MATERIALS

SEQUENCE OF CONSTRUCTION (PATCHING FIRST)

- 1. REMOVE THE EXISTING HMA MATERIAL OVER THE AREA TO BE PATCHED.
- 2. REMOVE AND REPLACE WITH CLASS C OR D PATCH.
- 3. REPLACE HMA MATERIAL OVER THE AREA TO BE PATCHED.

SEQUENCE OF CONSTRUCTION (MILLING FIRST)

- 1. MILL HMA FIRST IF THERE IS AT LEAST 4 1/2 INCHES OR MORE OF HMA MATERIAL ON TOP OF THE EXISTING PAVEMENT OR IF THE PAVEMENT IS FULL DEPTH HMA. A MINIMUM OF 2 INCHES OF HMA MATERIAL SHALL BE IN PLACE AFTER MILLING.
- 2. REMOVE AND REPLACE WITH FULL DEPTH CLASS D PATCHES TO TOP OF MILLED SURFACE.

ALL DIMENSIONS ARE IN INCHES (MILLIMETERS) UNLESS OTHERWISE SHOWN.

MODEL: Plan Styles (Sheet)
FILE NAME: Z:\DOT\CAD ORF Folder Master\Master Files\DOTCAD CONNECT\Configuration\Organization-Civil\DOT_Standards\Digital\Sheet Seeds\Civil_Named_Boundary_SheetSeeds.dgnlib

	USER NAME = eric.l.honias	DESIGNED - R. SHAH	REVISED - R. BORO 01-01-07	STATE OF ILLINOIS DEPARTMENT OF TRANSPORTATION	PAVEMENT PATCHING FOR HMA SURFACED PAVEMENT				F.A.I RTE.	SECTION	COUNTY	TOTAL SHEETS	SHEET NO.
		DRAWN -	REVISED - R. BORO 09-04-07						55	2023-927-RS,SW	DUPAGE	24	17
	PLOT SCALE = \$SCALE\$	CHECKED -	REVISED - K. ENG 10-27-08						BD400-04 (BD-22)		CONTRACT NO. 62W49		
	PLOT DATE = 8/30/2023	DATE - 10-25-94	REVISED - K. SMITH 11-18-22		ILLINOIS FED. AID PROJECT								
					SCALE: NONE	SHEET 1	OF 1	SHEETS	STA.	TO STA.			

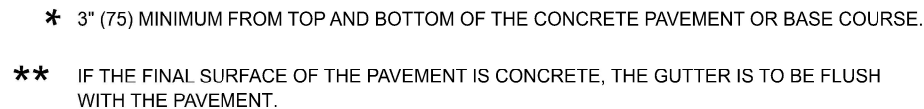

ALL DIMENSIONS ARE IN INCHES (MILLIMETERS)
UNLESS OTHERWISE SHOWN.

FILE NAME:	USER NAME = eric.l.thomas	DESIGNED - A. HOUSEH	REVISED - A. ABBAS 03-21-97	STATE OF ILLINOIS DEPARTMENT OF TRANSPORTATION	CURB OR CURB AND GUTTER REMOVAL AND REPLACEMENT				F&I RTE.	SECTION	COUNTY	TOTAL SHEETS	SHEET NO.	
		DRAWN -	REVISED - R. GOMEZ 01-22-01						55	2023-927-RS,SW	DUPAGE	24	18	
	PLOT SCALE = \$\$\$ALES	CHECKED -	REVISED - R. BORO 12-15-09		BD600-06 (BD-24)				CONTRACT NO. 62W49					
	PLOT DATE = 8/30/2023	DATE = 03-11-94	REVISED - K. SMITH 07-11-19		SCALE: NONE	SHEET 1	OF 1	SHEETS	STA.	TO STA.				

MODEL: Plan Single (Sheet)
FILE NAME: Z:\DOT\CAD_ORFD\Folder Master\Master Files\DOTCAD_CONNECT\Configuration\Organization-Civil\DOT_Standards\DigitalSheet Seeds\Civil_Named_Boundary_SheetSeeds.dgnlib

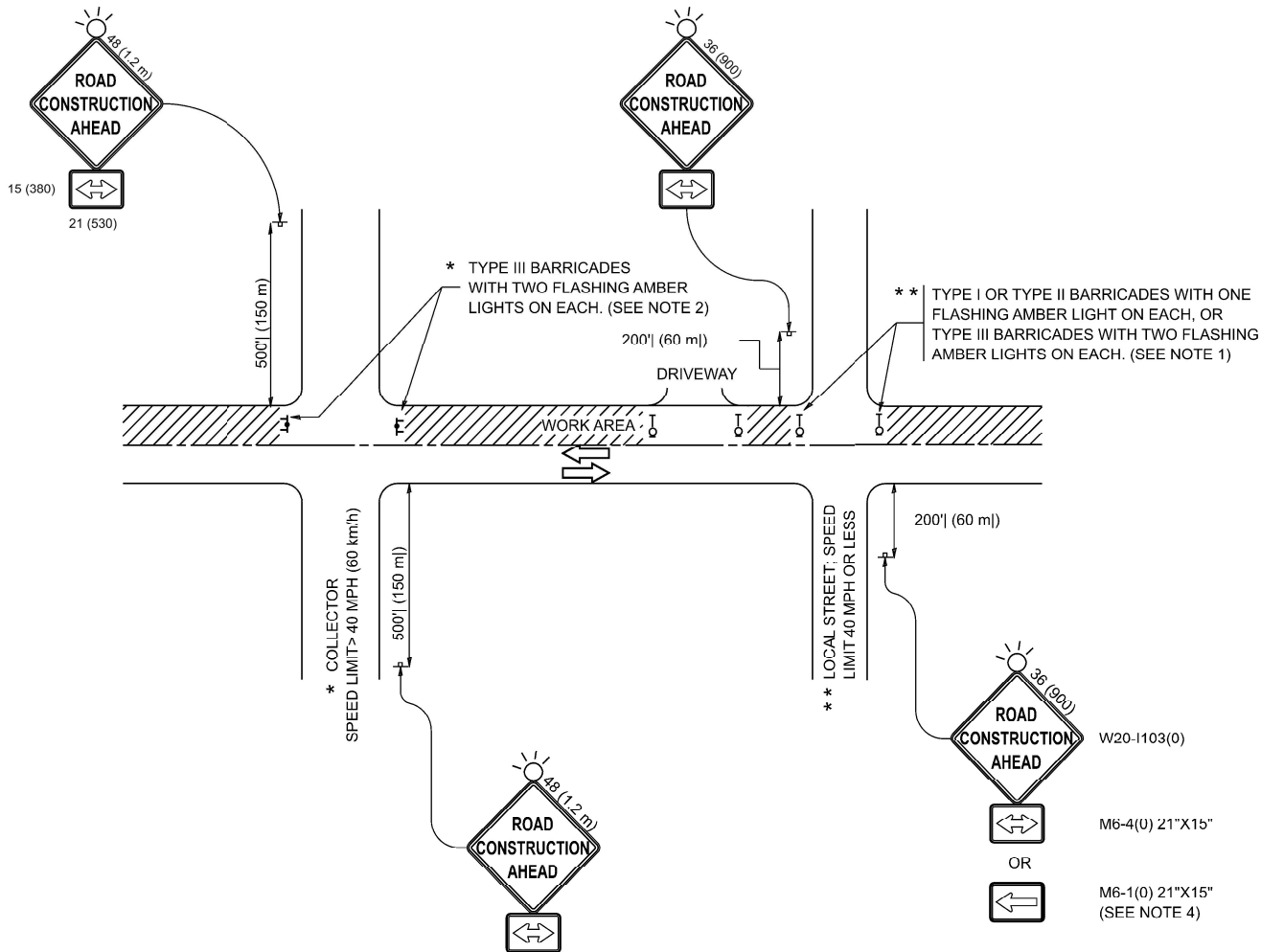

NOTES:

1. SIDE ROAD WITH A SPEED LIMIT OF 40 MPH (60 km/h) OR LESS AS SHOWN ON THE DRAWING AND AS DIRECTED BY THE ENGINEER:

a) ONE "ROAD CONSTRUCTION AHEAD" SIGN 36 x 36 (900x900) WITH A FLASHER MOUNTED ON IT APPROXIMATELY 200' (60 m) IN ADVANCE OF THE MAIN ROUTE.

b) THE CLOSED PORTION OF THE MAIN ROUTE SHALL BE PROTECTED BY BLOCKING WITH TYPE I, TYPE II OR TYPE III BARRICADES, 1/3 OF THE CROSS SECTION OF THE CLOSED PORTION.

2. SIDE ROAD WITH A SPEED LIMIT GREATER THAN 40 MPH (60 km/h) AS SHOWN ON THE DRAWING AND AS DIRECTED BY THE ENGINEER:

a) ONE "ROAD CONSTRUCTION AHEAD" SIGN 48 x 48 (1.2 m x 1.2 m) WITH A FLASHER MOUNTED ON IT APPROXIMATELY 500' (150 m) IN ADVANCE OF THE MAIN ROUTE.

b) THE CLOSED PORTION OF THE MAIN ROUTE SHALL BE PROTECTED BY BLOCKING WITH TYPE III BARRICADES, 1/2 OF THE CROSS SECTION OF THE CLOSED PORTION.

3. CONES MAY BE SUBSTITUTED FOR BARRICADES OR DRUMS AT HALF THE SPACING DURING DAY OPERATIONS. CONES SHALL BE A MINIMUM OF 28 (710) IN HEIGHT.

4. WHEN THE SIDE ROAD LIES BETWEEN THE BEGINNING OF THE MAINLINE SIGNING AND THE WORK ZONE, A SINGLE HEADED ARROW (M6-1) SHALL BE USED IN LIEU OF THE DOUBLE HEADED ARROW (M6-4).

5. WHEN WORK IS BEING PERFORMED ON A SIDE ROAD OR DRIVEWAY, FOLLOW THE APPLICABLE STANDARD(S). THE DIRECTIONAL ARROW (M6-1 OR M6-4) SHALL BE COVERED OR REMOVED WHEN NO LONGER CONSISTENT WITH THE TRAFFIC CONTROL SET-UP.

6. ADVANCE WARNING SIGNS ARE TO BE OMITTED ON DRIVEWAYS UNLESS OTHERWISE SPECIFIED IN THE PLANS OR BY THE ENGINEER.

7. THE TRAFFIC CONTROL AND PROTECTION FOR SIDE ROADS, INTERSECTIONS, AND DRIVEWAYS SHALL BE INCLUDED IN THE COST OF SPECIFIED TRAFFIC CONTROL STANDARDS OR ITEMS.
- All dimensions are in inches (millimeters) unless otherwise shown.
- | | | | | | | | | | | | | | | | | |
|--|---------------------------|-------------------|---------------------------------|---|--|--------|-------|----|--------|------|---------|-----------------------------|----------------|--------------------|-----------------|--------------|
| | USER NAME = eric.l.thomas | DESIGNED - L.H.A. | REVISED - T. RAMMACHER 01-06-00 | STATE OF ILLINOIS
DEPARTMENT OF TRANSPORTATION | TRAFFIC CONTROL AND PROTECTION FOR
SIDE ROADS, INTERSECTIONS, AND DRIVEWAYS | SCALE: | SHEET | OF | SHEETS | STA. | TO STA. | F.A.I
RTE. | SECTION | COUNTY | TOTAL
SHEETS | SHEET
NO. |
| | | DRAWN - | REVISED - A. SCHUETZE 07-01-13 | | | | | | | | | 55 | 2023-927-RS,SW | DUPAGE | 24 | 20 |
| | PLOT SCALE = \$SCALE\$ | CHECKED - | REVISED - A. SCHUETZE 09-15-06 | | | | | | | | | TC-10 | | CONTRACT NO. 62W49 | | |
| | PLOT DATE = 8/30/2023 | DATE - 06-89 | REVISED - D. SENDERAK 05-03-24 | | | | | | | | | ILLINOIS FED. AID PROJECT | | | | |

MODEL: Plan Single (Sheet)
FILE NAME: Z:\DOT\CAD_ORFD Folder Master\Master Files\DOTCAD_CONNECT\Configuration\Organization\Civil\DOT_Standards\Digital\Sheet Seeds\Civil_Named_Boundary_SheetSeeds.dgnlib

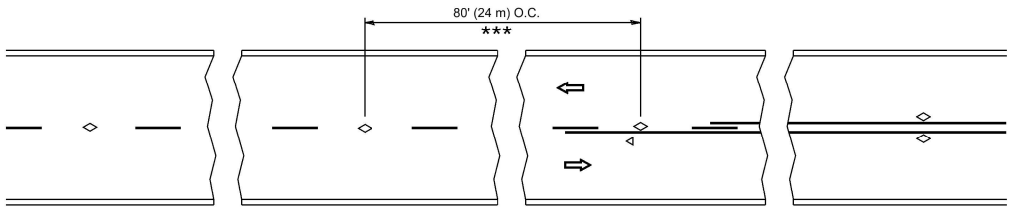

*** REDUCE TO 40' (12 m) O.C. ON CURVES WITH POSTED OR ADVISORY SPEED 45 M.P.H. (70 km/h) OR LESS.

TWO-LANE/TWO-WAY

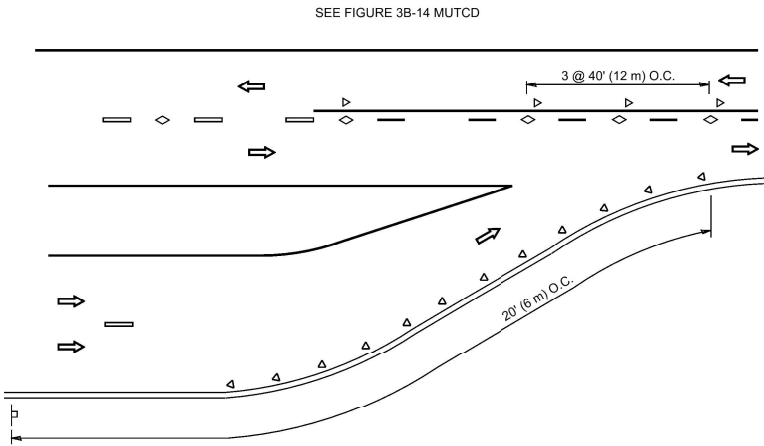

LANE REDUCTION TRANSITION

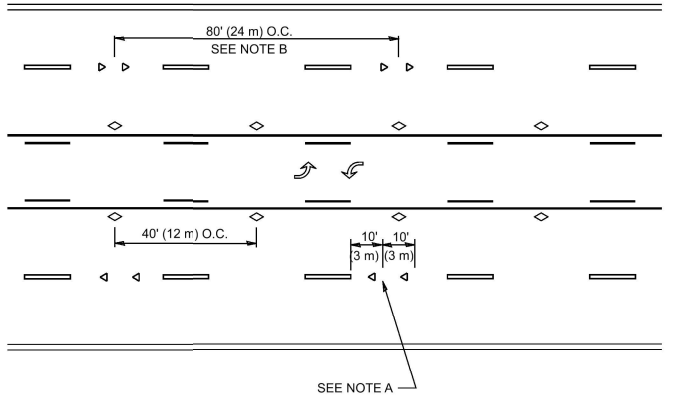

TWO-WAY LEFT TURN

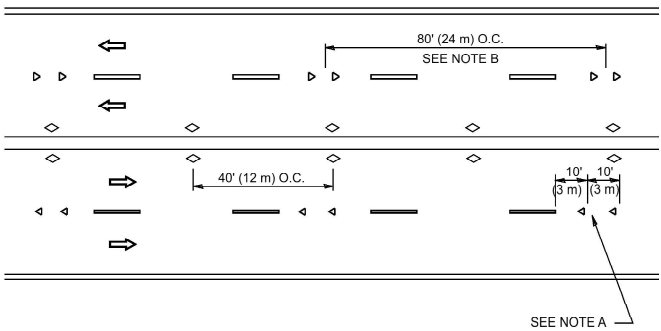

MULTI-LANE/UNDIVIDED

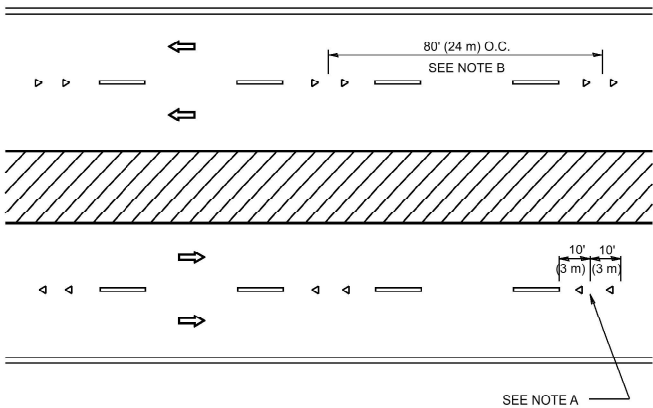

MULTI-LANE/DIVIDED

GENERAL NOTES

- MARKERS USED WITH DASHED LINES SHALL BE CENTERED IN THE GAP BETWEEN SEGMENTS.
 - MARKERS USED ADJACENT TO SOLID LINES SHALL BE OFFSET 2 TO 3 (50 TO 75) TOWARD TRAFFIC AS SHOWN.
 - MARKERS THROUGH TANGENTS LESS THAN 500' (150 m) IN LENGTH BETWEEN CURVES SHALL BE INSTALLED AT THE LESSER OF THE TWO CURVE SPACINGS.
 - MARKERS ARE TO BE USED ADJACENT TO BOTH SOLID WHITE LINES IN DUAL LEFT TURN LANES
- A. USE DOUBLE LANE LINE MARKERS SPACED AS SHOWN.
- B. REDUCE TO 40' (12 m) O.C. ON CURVES WHERE ADVISORY SPEEDS ARE 10 M.P.H (20 km/h) LOWER THAN POSTED SPEEDS.

SYMBOLS

- YELLOW STRIPE
- WHITE STRIPE
- ONE-WAY AMBER MARKER
- ONE-WAY CRYSTAL MARKER (W/O)
- TWO-WAY AMBER MARKER

LANE MARKER NOTES

DESIGN NOTES

- DOUBLE LANE LINE MARKERS SHALL BE USED UNLESS SPECIFIED OTHERWISE.
- EXCEPT AS SHOWN ON THE LANE REDUCTION TRANSITION AND FREEWAY EXIT RAMP DETAIL, MARKERS ARE NOT TO BE SPECIFIED ON RIGI IT EDGE LINES.
- THE EXACT MARKER LIMITS, SPACING, AND COLOR SHALL BE INCLUDED IN THE PLANS WHEN STANDARD SPECIFICATIONS ARE NOT BEING USED.
- MARKERS SHOULD NOT BE USED ALONGSIDE CURBS EXCEPT FOR EXTREMELY SHORT SECTIONS OF CURBS WHERE NOT MORE THAN TWO MARKERS WOULD BE INVOLVED.

All dimensions are in inches (millimeters) unless otherwise shown.

USER NAME = eric.l.thomas	DESIGNED -	REVISED - T. RAMMACHER 03-12-99
	DRAWN -	REVISED - T. RAMMACHER 01-06-00
PLOT SCALE = \$SCALE\$	CHECKED -	REVISED - C. JUCIUS 09-09-09
PLOT DATE = 8/30/2023	DATE -	REVISED - C. JUCIUS 07-01-13

STATE OF ILLINOIS
DEPARTMENT OF TRANSPORTATION

TYPICAL APPLICATIONS
RAISED REFLECTIVE PAVEMENT MARKERS (SNOW-PLOW RESISTANT)

SCALE: NONE SHEET 1 OF 1 SHEETS STA. TO STA.

F.A.I RTE.	SECTION	COUNTY	TOTAL SHEETS	SHEET NO.
55	2023-927-RS,SW	DUPAGE	24	21
TC-11		CONTRACT NO. 62W49		
		ILLINOIS FED. AID PROJECT		

MODEL: Plan Single (Sheet)
FILE NAME: Z:\DOT\CAD ORF Folder Master\Master Files\DOTCAD CONNECT\Configuration\Organization-Civil\DOT_Standards\DigitalSheet Seals\Civil_Named_Boundary_SheetSeals.dgn

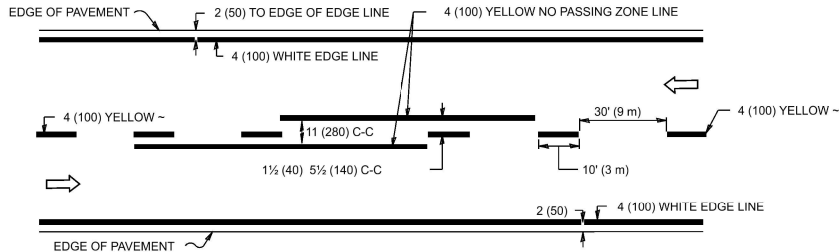

2-LANE ROADWAY

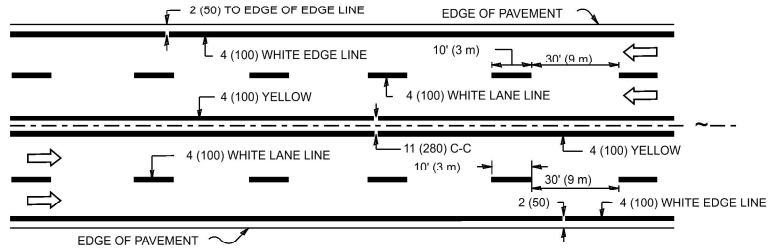

MULTI-LANE UNDIVIDED

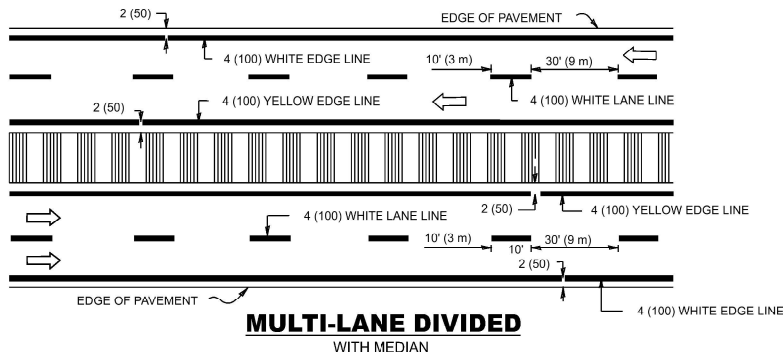

TYPICAL LANE AND EDGE LINE MARKING

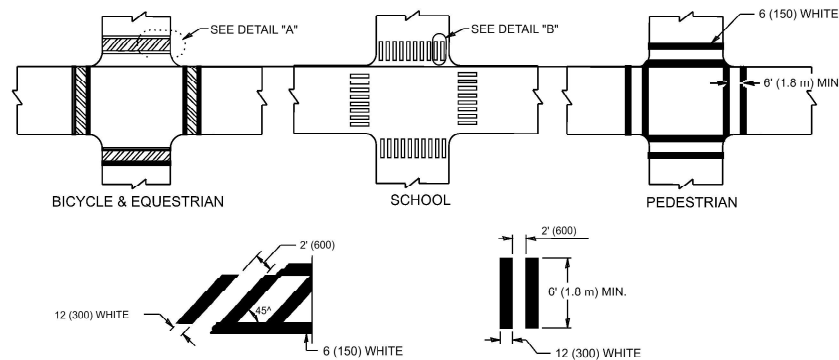

DETAIL "A"

DETAIL "B"

TYPICAL CROSSWALK MARKING

* MARKINGS SHALL BE INSTALLED PARALLEL TO THE CENTERLINE OF THE ROAD WHICH IT CROSSES

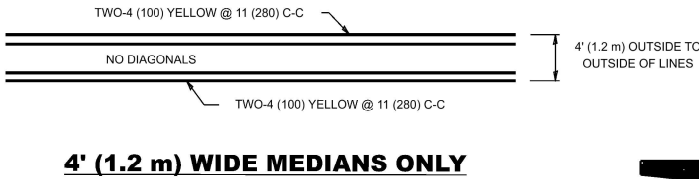

4' (1.2 m) WIDE MEDIANS ONLY

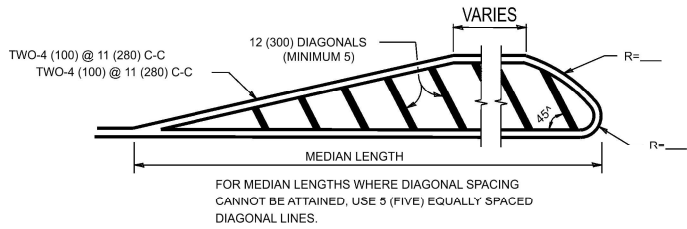

DIAGONAL LINE SPACING: 50' (15 m) C-C (LESS THAN 30MPH (50 km/h))
75' (25 m) C-C 30MPH (50 km/h) TO 45MPH (70 km/h)
150' (45 m) C-C (MORE THAN 45MPH (70 km/h))

MEDIANS OVER 4' (1.2 m) WIDE

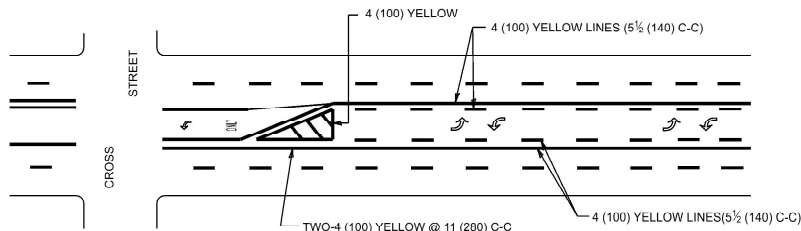

MEDIAN WITH TWO-WAY LEFT TURN LANE TYPICAL PAINTED MEDIAN MARKING

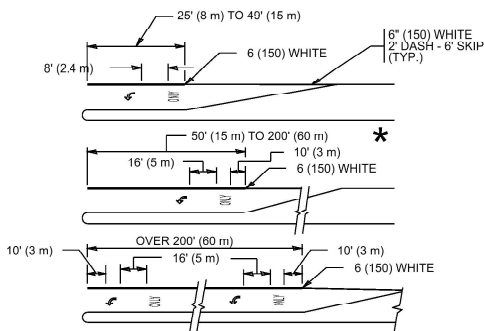

FULL SIZE LETTERS 8' (2.4 m) AND ARROWS SHALL BE USED.
AREA = 15.6 SQ. FT. (1.5 m²) ONLY AREA = 20.8 SQ. FT. (1.9 m²)

* TURN LANES IN EXCESS OF 400' (120 m) IN LENGTH MAY HAVE AN ADDITIONAL SET OF ARROW - "ONLY" INSTALLED MIDWAY BETWEEN THE OTHER TWO SETS OF ARROW - "ONLY".

TYPICAL LEFT (OR RIGHT) TURN LANE

TYPICAL TURN LANE MARKING

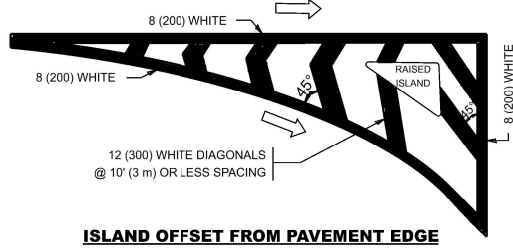

ISLAND OFFSET FROM PAVEMENT EDGE

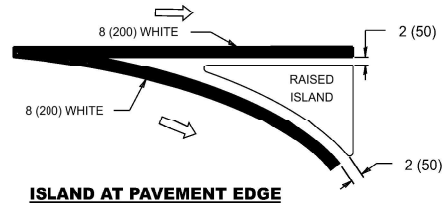

ISLAND AT PAVEMENT EDGE

TYPICAL ISLAND MARKING

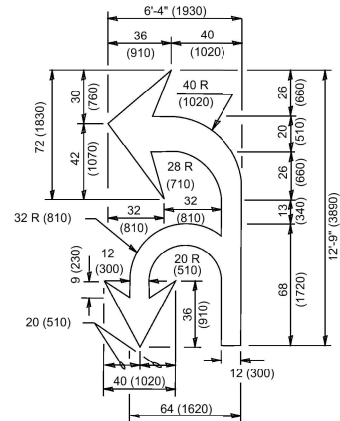

COMBINATION LEFT AND U-TURN

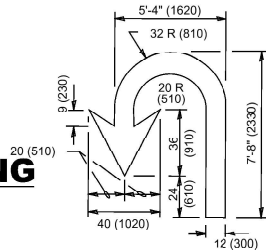

U-TURN

LANE REDUCTION TRANSITION

* LANE REDUCTION ARROWS REQUIRED AT SPEEDS OF 45 MPH OR GREATER OR WHEN SPECIFIED IN PLANS.

TYPE OF MARKING	WIDTH OF LINE	PATTERN	COLOR	SPACING / REMARKS
CENTERLINE ON 2 LANE PAVEMENT	4 (100)	SKIP-DASH	YELLOW	10' (3 m) LINE WITH 30' (9 m) SPACE
CENTERLINE ON MULTI-LANE UNDIVIDED PAVEMENT	2 @ 4 (100)	SOLID	YELLOW	11 (280) C-C
NO PASSING ZONE LINES: FOR ONE DIRECTION FOR BOTH DIRECTIONS	4 (100) 2 @ 4 (100)	SOLID SOLID	YELLOW YELLOW	5 1/2 (140) C-C FROM SKIP-DASH CENTERLINE 11 (280) C-C OMIT SKIP-DASH CENTERLINE BETWEEN
LANE LINES	4 (100) 5 (125) ON FREEWAYS	SKIP-DASH SKIP-DASH	WHITE WHITE	10' (3 m) LINE WITH 30' (9 m) SPACE
DOTTED LINES (EXTENSIONS OF CENTER, LANE OR TURN LANE MARKINGS)	SAME AS LINE BEING EXTENDED	SKIP-DASH	SAME AS LINE BEING EXTENDED	2' (600) LINE WITH 6' (1.8 m) SPACE
EDGE LINES	4 (100)	SOLID	YELLOW-LEFT WHITE-RIGHT	OUTLINE MEDIANS IN YELLOW
TURN LANE MARKINGS	6 (150) LINE: FULL SIZE LETTERS & SYMBOLS 8' (2.4 m))	SOLID	WHITE	SEE TYPICAL TURN LANE MARKING DETAIL
TWO WAY LEFT TURN MARKING	2 @ 4 (100) EACH DIRECTION 8' (2.4 m)) LEFT ARROW	SKIP-DASH AND SOLID IN PAIRS	YELLOW WHITE	10' (3 m) LINE WITH 30' (9 m) SPACE FOR SKIP-DASH; 5 1/2 (140) C-C BETWEEN SOLID LINE AND SKIP-DASH LINE SEE TYPICAL TWO-WAY LEFT TURN MARKING DETAIL
CROSSWALK LINES (PEDESTRIAN) A. DIAGONALS (BIKE & EQUESTRIAN) B. LONGITUDINAL BARS (SCHOOL)	2 @ 6 (150) 12 (300) @ 45° 12 (300) @ 90°	SOLID SOLID SOLID	WHITE WHITE WHITE	NOT LESS THAN 6' (1.8 m) APART 2' (600) APART 2' (600) APART SEE TYPICAL CROSSWALK MARKING DETAILS.
STOP LINES	24 (600)	SOLID	WHITE	PLACE 4' (1.2 m) IN ADVANCE OF AND PARALLEL TO CROSSWALK, IF PRESENT. OTHERWISE, PLACE AT DESIRED STOPPING POINT, PARALLEL TO CROSSROAD CENTERLINE, WHERE POSSIBLE.
PAINTED MEDIANS	2 @ 4 (100) WITH 12 (300) DIAGONALS @ 45° NO DIAGONALS USED FOR 4' (1.2 m) WIDE MEDIANS	SOLID	YELLOW; TWO WAY TRAFFIC WHITE; ONE WAY TRAFFIC	11 (280) C-C FOR THE DOUBLE LINE SEE TYPICAL PAINTED MEDIAN MARKING.
GORE MARKING AND CHANNELIZING LINES	8 (200) WITH 12 (300) DIAGONALS @ 45°	SOLID	WHITE	DIAGONALS: 15' (4.5 m) C-C (LESS THAN 30MPH (50 km/h)) 20' (6 m) C-C 30MPH (50 km/h) TO 45MPH (70 km/h) 30' (9 m) C-C (OVER 45MPH (70 km/h))
RAILROAD CROSSING	24 (600) TRANSVERSE LINES: "RR" IS 6' (1.8 m) LETTERS: 16 (400) LINE FOR "X"	SOLID	WHITE	SEE STATE STANDARD 780001 AREA OF: "R"=3.6 SQ. FT. (0.33 m ²) EACH "X"=54.0 SQ. FT. (5.0 m ²)
SHOULDER DIAGONALS (REQUIRED FOR SHOULDERS ≥ 8')	12 (300) @ 45°	SOLID	WHITE - RIGHT YELLOW - LEFT	50' (15 m) C-C (LESS THAN 30MPH (50 km/h)) 75' (26 m) C C 30 MPH (50 km/h) TO 45MPH (70 km/h) 150' (45 m) C-C (OVER 45MPH (70 km/h))
U TURN ARROW	SEE DETAIL	SOLID	WHITE	16.3 SF
2 ARROW COMBINATION LEFT AND U TURN	SEE DETAIL	SOLID	WHITE	30.4 SF

FOR FURTHER DETAILS ON PAVEMENT MARKING REFER TO STANDARD SPECIFICATIONS FOR ROAD AND BRIDGE CONSTRUCTION AND STATE STANDARD 780001.

All dimensions are in inches (millimeters) unless otherwise shown.

USER NAME = eric.l.hillman	DESIGNED - EVERS	REVISED - C. JUCIUS 09-09-09
	DRAWN -	REVISED - C. JUCIUS 07-01-13
PLOT SCALE = \$SCALE\$	CHECKED -	REVISED - C. JUCIUS 12-21-15
PLOT DATE = 8/30/2023	DATE - 03-19-90	REVISED - C. JUCIUS 04-12-16

STATE OF ILLINOIS
DEPARTMENT OF TRANSPORTATION

DISTRICT ONE
TYPICAL PAVEMENT MARKINGS

SCALE: NONE SHEET 1 OF 1 SHEETS STA. TO STA.

F.A.I RTE.	SECTION	COUNTY	TOTAL SHEETS	SHEET NO.
55	2023-927-RS,SW	DUPAGE	24	22
TC-13		CONTRACT NO. 62W49		
		ILLINOIS	FED. AID PROJECT	

Diagram illustrating the layout of a 6' (2 m) wide deck. The layout consists of four 16' (400) sections and four 8' (200) sections, totaling 6' (2 m). The sections are separated by gaps, with a total gap width of 12' (300). The layout is shown with dimensions and a total width of 6' (2 m).

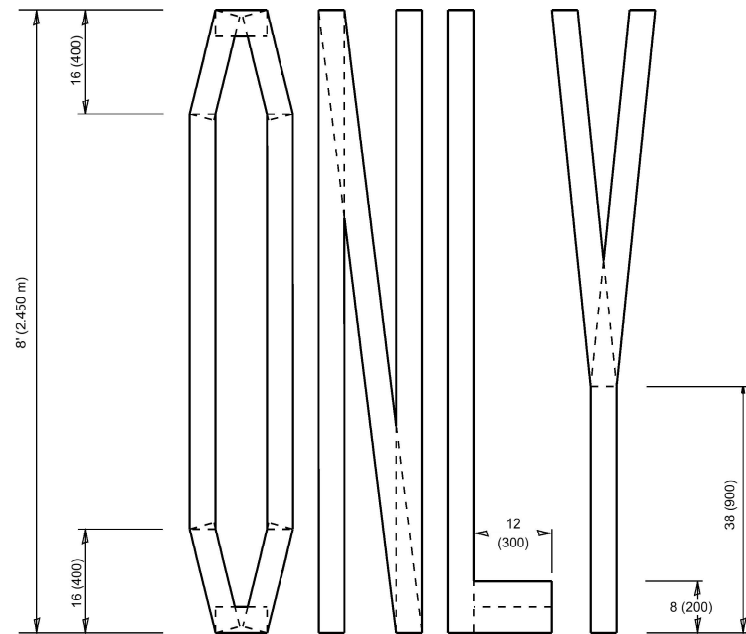

USER NAME = eric.l.thomas	DESIGNED -	REVISED - T. RAMMACHER 03-02-98
	DRAWN -	REVISED - E. GOMEZ 08-28-00
PLOT SCALE = \$SCALE\$	CHECKED -	REVISED - E. GOMEZ 08-28-00
PLOT DATE = 8/30/2023	DATE - 09-18-94	REVISED A. SCHUETZE 09-15-16

SCALE: NONE	SHEET 1	OF 1	SHEETS	STA.	TO STA.
-------------	---------	------	--------	------	---------

F.A.I RTE.	SECTION	COUNTY	TOTAL SHEETS	SHEET NO.
55	2023-927-RS,SW	DUPAGE	24	23
TC-16		CONTRACT NO. 62W49		
ILLINOIS		FED. AID PROJECT		

MODEL: Plan Symbols (Sheet)
FILE NAME: Z:\DOT\CAD_ORFD\Folder Master\Master Files\DOTCAD_CONNECT\Configuration\Organization-Civil\DOT_Standards\Digital\Sheet Seeds\Civil_Named_Boundary_Sheet\Seeds.dgn1b

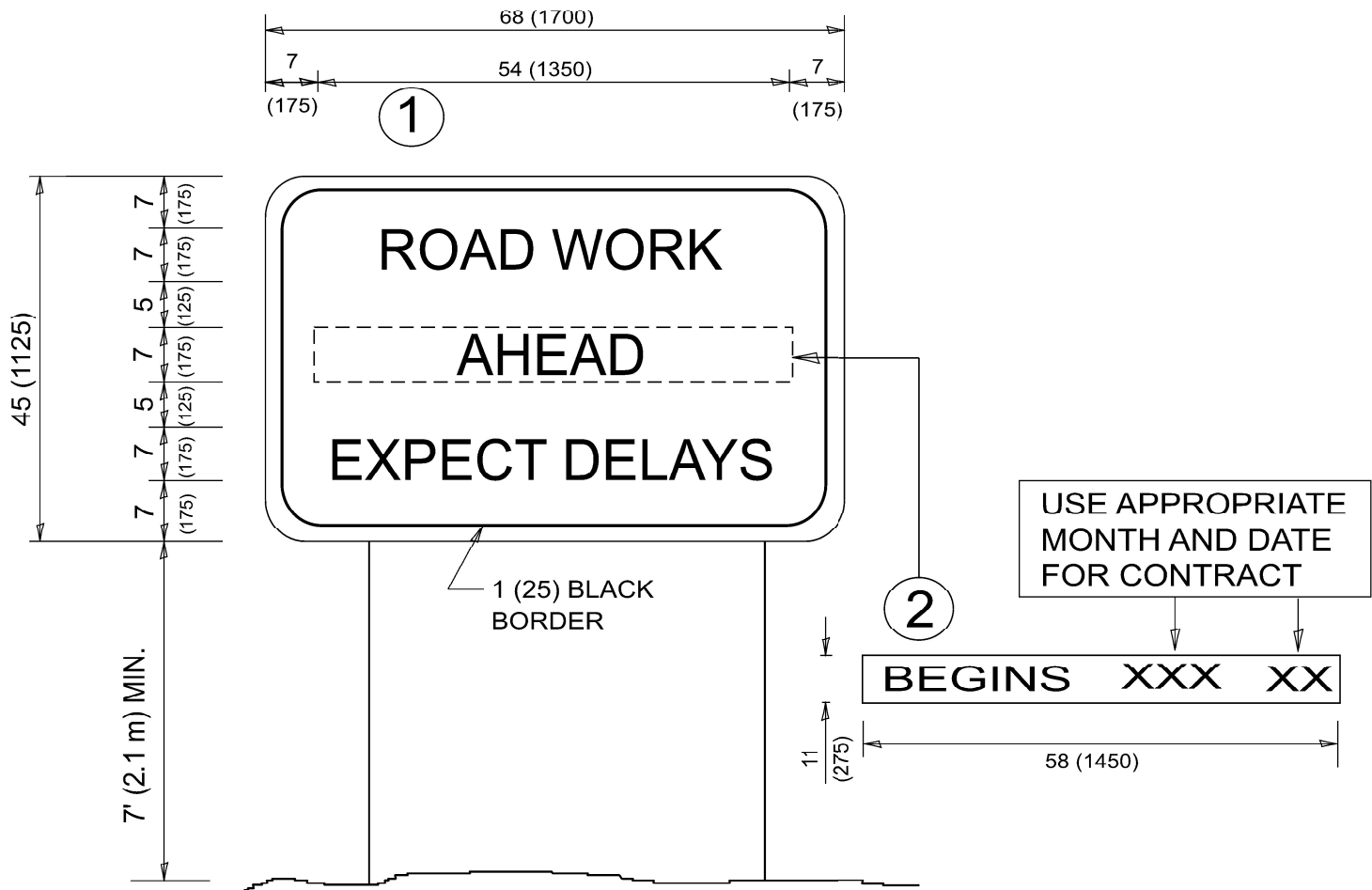

NOTES:

1. USE BLACK LETTERING ON ORANGE BACKGROUND.
2. ERECT SIGNS IN ADVANCE OF THE LOCATION FOR THE "ROAD CONSTRUCTION AHEAD" SIGN AT LOCATIONS AS DIRECTED BY THE ENGINEER.
3. ERECT SIGN ① WITH INSTALLED PANEL ② ONE WEEK PRIOR TO THE START OF CONSTRUCTION.
4. REMOVE PANEL ② SOON AFTER THE START OF CONSTRUCTION.
5. SEE SPECIAL PROVISION FOR "TEMPORARY INFORMATION SIGNING" FOR ADDITIONAL INFORMATION.
6. ONE SIGN ASSEMBLY EQUALS 25.70 SQ. FT. (2.3 SQ. M.)
7. SHALL BE PAID FOR AS TEMPORARY INFORMATION SIGNING.

ALL DIMENSIONS ARE IN INCHES (MILLIMETERS)
UNLESS OTHERWISE SHOWN.

	USER NAME = eric.l.thomas	DESIGNED -	REVISED - R. MIRS 09-15-97	STATE OF ILLINOIS DEPARTMENT OF TRANSPORTATION	ARTERIAL ROAD INFORMATION SIGN				F.A.I RTE.	SECTION	COUNTY	TOTAL SHEETS	SHEET NO.
		DRAWN -	REVISED - R. MIRS 12-11-97						55	2023-927-RS,SW	DuPage	24	24
	PLOT SCALE = \$SCALE\$	CHECKED -	REVISED - T. RAMMACHER 02-02-99						TC-22		CONTRACT NO. 62W49		
	PLOT DATE = 8/30/2023	DATE -	REVISED - C. JUCIUS 01-31-07		ILLINOIS FED. AID PROJECT								
						SCALE: NONE	SHEET 1	OF 1 SHEETS	STA.	TO STA.			