

NOTE: REMOVAL OF THE EXISTING HMA SHOULDER CURB TO BE PAID AS CURB REMOVAL.

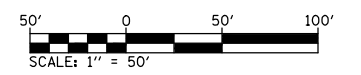
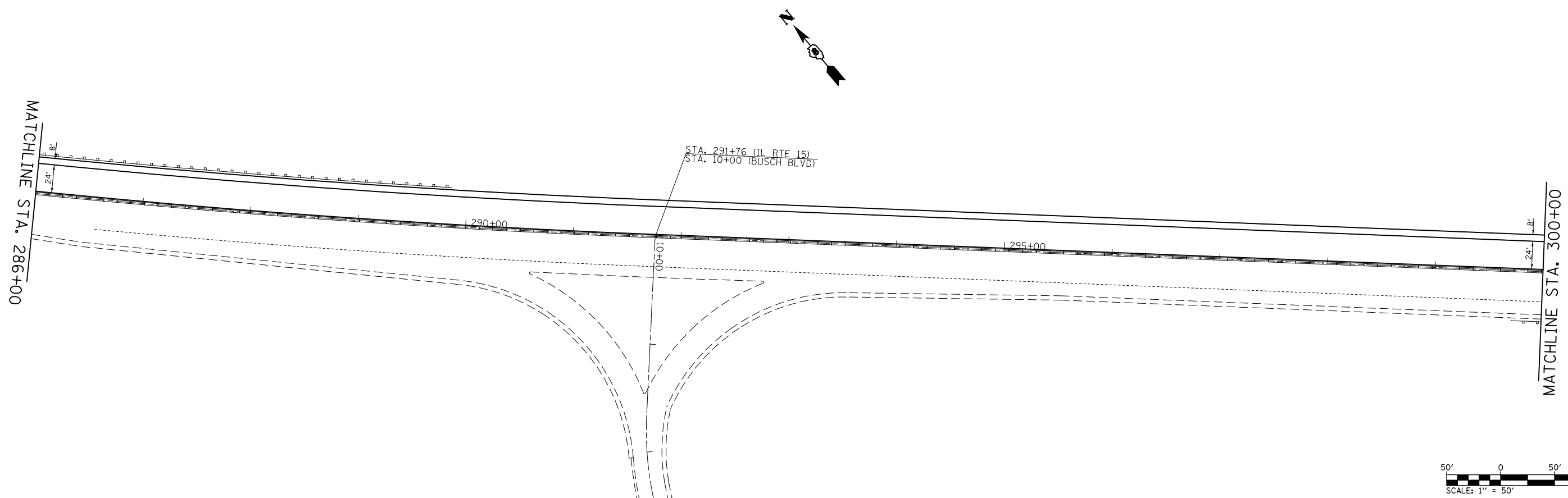
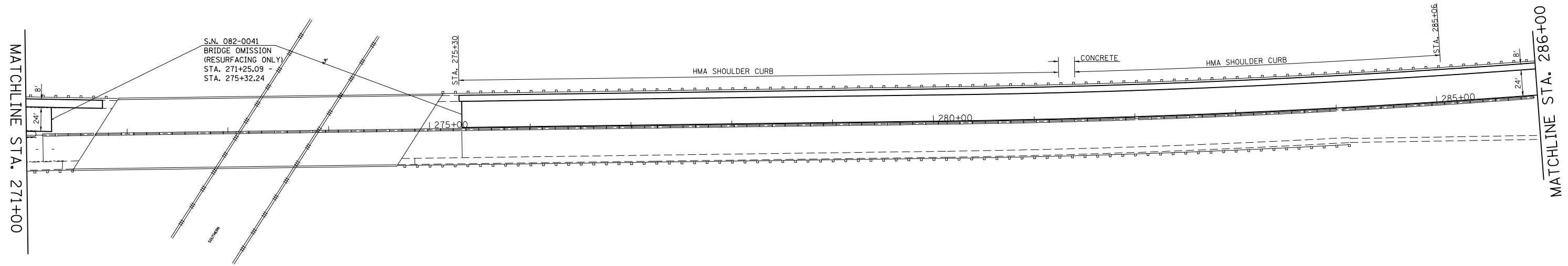

FILE NAME =	USER NAME = conoverpj	DESIGNED -	REVISED -
et:\pw\work\p\dot\conoverpj\d0340760\d076g38-sht-plan.dgn		DRAWN -	REVISED -
	PLOT SCALE = 100.0000' / in.	CHECKED -	REVISED -
	PLOT DATE = 10/18/2013	DATE -	REVISED -

**STATE OF ILLINOIS
DEPARTMENT OF TRANSPORTATION**

PLAN SHEET

SCALE: 1" = 50' SHEET NO. 5 OF 23 SHEETS STA. 271+00 TO STA. 300+00

F.A.P. RTE.	SECTION	COUNTY	TOTAL SHEETS	SHEET NO.
103	(29-1,28-1,28-2,26-1)RS-2	ST. CLAIR	97	43
CONTRACT NO. 76G38				
FED. ROAD DIST. NO.		ILLINOIS FED. AID PROJECT		