

SIDE ROAD  
(74TH STREET\*\*)

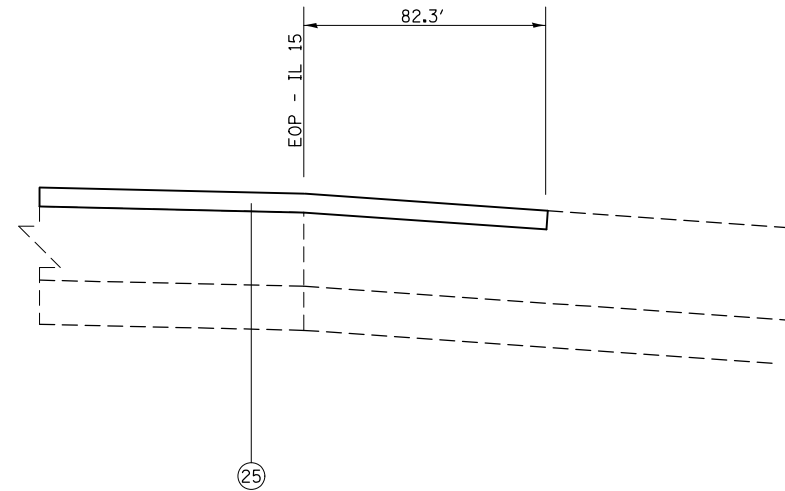

SECTION A-A

- LEGEND**
- ① EXISTING SUB-BASE GRANULAR MATERIAL, VARIES 4" TO 12"
  - ② EXISTING BASE COURSE, 13.5"
  - ③ EXISTING LIME MODIFIED SOIL, 12"
  - ④ EXISTING PCC PAVEMENT
  - ⑤ OMIT
  - ⑥ EXISTING PCC JOINTED PAVEMENT, 14"
  - ⑦ EXISTING PCC BASE COURSE WIDENING, 9"
  - ⑧ EXISTING WIDENING
  - ⑨ EXISTING HMA PAVEMENT (FULL DEPTH)
  - ⑩ EXISTING HMA RESURFACING, 6" TO 7.5"
  - ⑪ EXISTING HMA RESURFACING
  - ⑫ EXISTING HMA BINDER COURSE, 12"
  - ⑬ EXISTING HMA SHOULDER
  - ⑭ EXISTING HMA SHOULDER RESURFACING, VAR. DEPTH
  - ⑮ EXISTING CONCRETE MEDIAN
  - ⑯ EXISTING CONCRETE CURB, SPECIAL, 12"
  - ⑰ EXISTING CONCRETE CURB
  - ⑱ EXISTING PCC MEDIAN SURFACE, 4"
  - ⑲ EXISTING CONCRETE BARRIER
  - ⑳ EXISTING HMA SHOULDER CURB
  - ㉑ EXISTING CONCRETE GUTTER
  - ㉒ EXISTING CONCRETE CURB & GUTTER
  - ㉓ EXISTING PIPE UNDERDRAINS
  - ㉔ EXISTING AGGREGATE SHOULDERS
  - ㉕ PROPOSED POLYMER HMA SURFACE COURSE, MIX E, N90, 2 1/4"
  - ㉖ PROPOSED HMA SHOULDERS, 2 1/4"
  - ㉗ PROPOSED AGGREGATE SHOULDER WEDGE, TYPE B
  - ㉘ PROPOSED HMA SHOULDER CURB

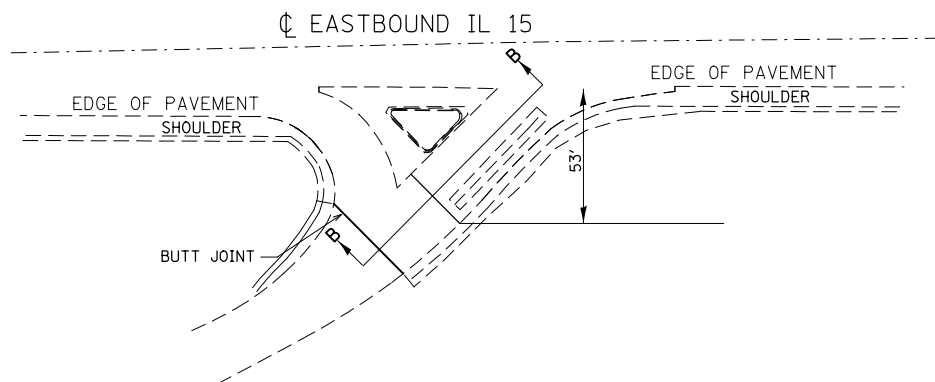

11TH STREET

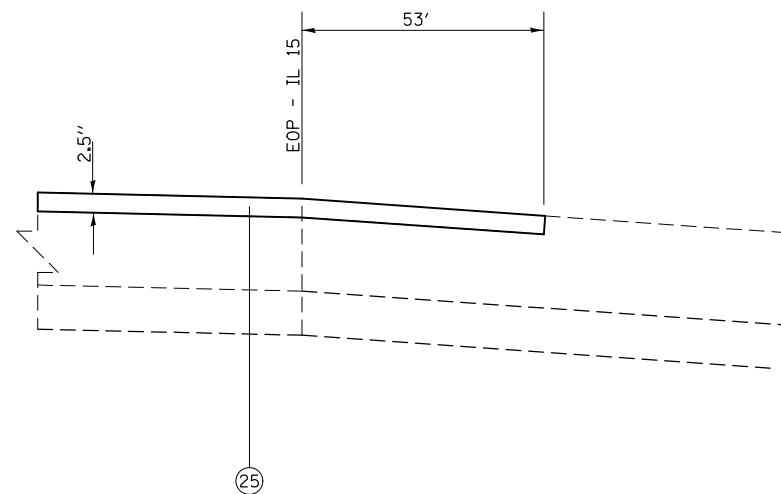

SECTION B-B

FILE NAME =	USER NAME = conoverpj	DESIGNED -	REVISED -
et:\pw\work\p\dot\conoverpj\d0340733\d076g37-sh-typical.dgn		DRAWN -	REVISED -
	PLOT SCALE = 100.0000' / 1in.	CHECKED -	REVISED -
	PLOT DATE = 10/18/2013	DATE -	REVISED -

**STATE OF ILLINOIS  
DEPARTMENT OF TRANSPORTATION**

**PROPOSED TYPICAL SECTIONS**

SCALE: SHEET NO. 13 OF 14 SHEETS STA. TO STA.

F.A.P. RTE.	SECTION	COUNTY	TOTAL SHEETS	SHEET NO.
103	(29-1,28-1,28-2,26-1)RS-1	ST. CLAIR	96	32
FED. ROAD DIST. NO. ILLINOIS FED. AID PROJECT			CONTRACT NO. 76G37	