

NOTES

1. TRAFFIC CONTROL ON RAMPS SHALL CONFORM TO STD 701456.
2. TRAFFIC CONTROL AT RAMP/MAINLINE JUNCTIONS SHALL BE PER STD 701411.
3. STAGING SHOWN IS FOR STAGE 1 RAMP CONSTRUCTION. PROVIDE SIMILAR TRAFFIC CONTROL FOR STAGE 2 RAMP CONSTRUCTION IN ACCORDANCE WITH THE TRAFFIC CONTROL TYPICAL SECTIONS.
4. PRE-STAGE CONSTRUCTION, NOT SHOWN, INCLUDES TEMPORARY PAVEMENT (SEE MAINLINE TRAFFIC CONTROL PLANS) AND SHOULDER PATCHING OR RECONSTRUCTION WHERE INDICATED (SEE PAVING PLANS AND TEMPORARY TRAFFIC CONTROL TYPICAL SECTIONS).
5. CONTRACTOR MAY REQUEST APPROVAL FOR NIGHTTIME CLOSURE OF RAMPS A, B, C & D. SEE "TEMPORARY TRAFFIC CONTROL NOTES."
6. RAMP STAGES 1 & 2 DO NOT NECESSARILY COINCIDE WITH MAINLINE STAGES 1 & 2.

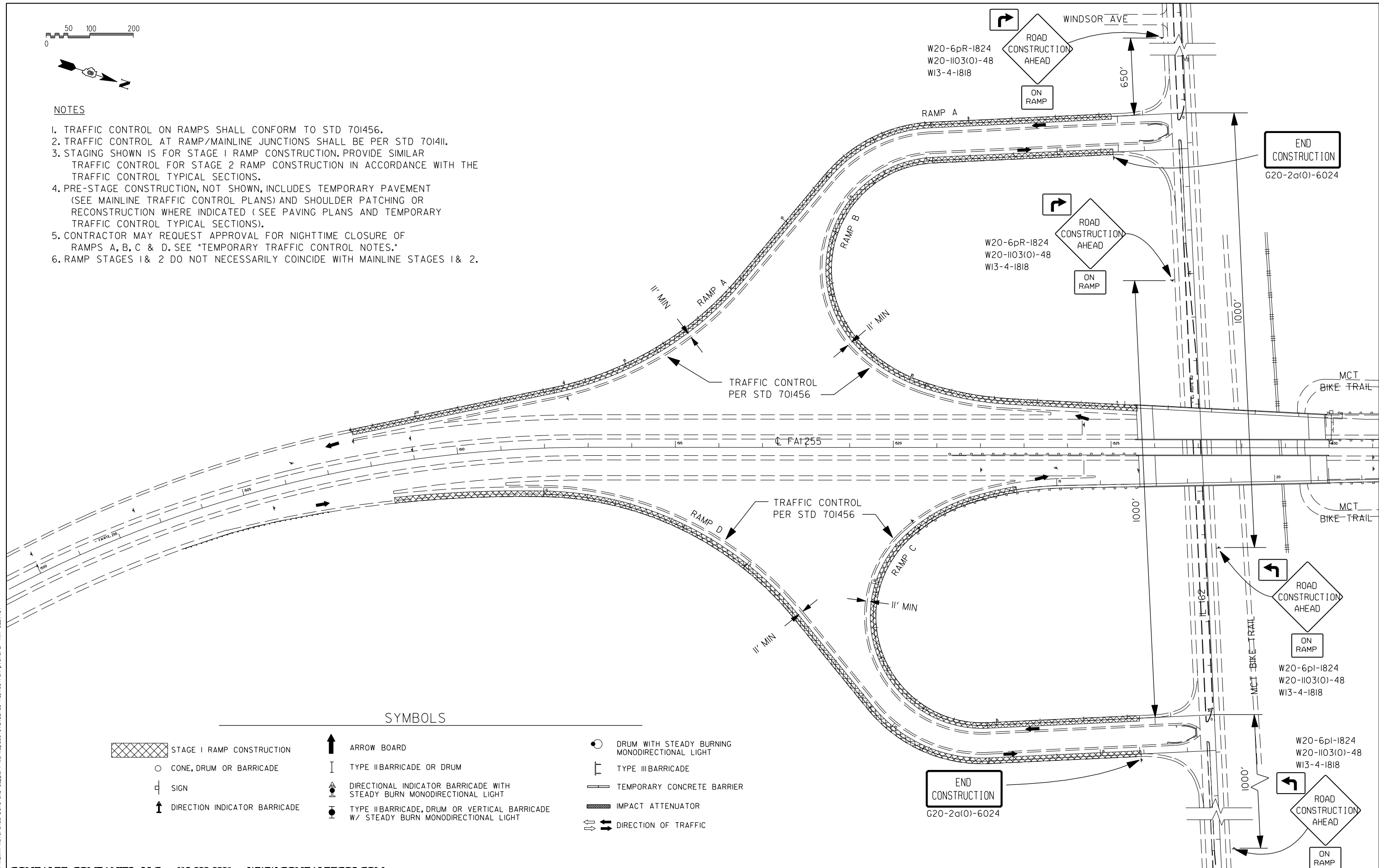

SYMBOLS

- | | | |
|-------------------------------|--|--|
| STAGE I RAMP CONSTRUCTION | ARROW BOARD | DRUM WITH STEADY BURNING MONODIRECTIONAL LIGHT |
| CONE, DRUM OR BARRICADE | TYPE II BARRICADE OR DRUM | TYPE III BARRICADE |
| SIGN | DIRECTIONAL INDICATOR BARRICADE WITH STEADY BURN MONODIRECTIONAL LIGHT | TEMPORARY CONCRETE BARRIER |
| DIRECTION INDICATOR BARRICADE | TYPE II BARRICADE, DRUM OR VERTICAL BARRICADE W/ STEADY BURN MONODIRECTIONAL LIGHT | IMPACT ATTENUATOR |
| | | DIRECTION OF TRAFFIC |

PLOT DRIVER = M:\Admin\Reference Data\CAD_Support\Workspaces\standard\plot\wpr\inter-hot1.f.plt
 PEN TABLE = M:\Admin\Reference Data\CAD_Support\Workspaces\standard\plot\wpr\inter-hot1-sub.tbl

GONZALEZ COMPANIES, LLC 618-222-2221 WWW.GONZALEZCOS.COM

FILE NAME = D876F10-sh151-RAMPS ABCD-stage1	DESIGNED - JG	REVISED - -
DESCRIPTION = Note	DRAWN - NC	REVISED - -
PLOT SCALE = 200.0000' / IN.	CHECKED - CH	REVISED - -
PLOT DATE = 11/20/2013	DATE - 09/23/2013	REVISED - -

**STATE OF ILLINOIS
DEPARTMENT OF TRANSPORTATION**

TEMPORARY TRAFFIC CONTROL - RAMPS A, B, C & D

SCALE: 1"=100' SHEET NO. 8 OF 37 SHEETS STA. TO STA.

F.A.I. RTE.	SECTION	COUNTY	TOTAL SHEETS	SHEET NO.
255	60-(8,9)RS-1	MADISON	206	51
CONTRACT NO. 76F10			ILLINOIS FED. AID PROJECT	