

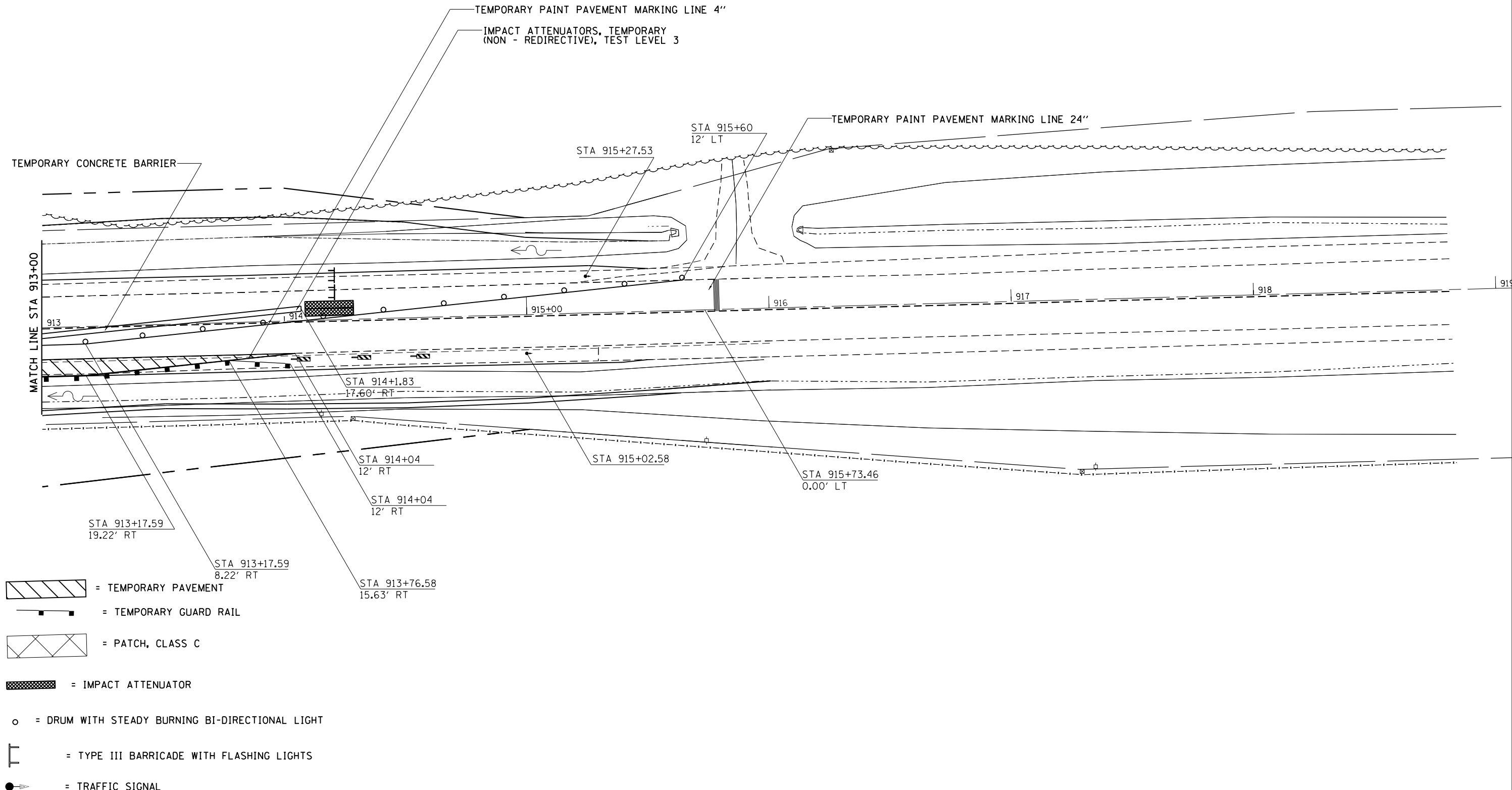





STAGE 1

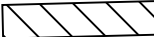

NOTES:

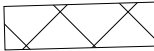
- PRESTAGE WORK SHALL INCLUDE CONSTRUCTION THE TEMPORARY WIDENING AND GUARDRAIL ON THE EAST SIDE OF IL 78 AS SHOWN ON THE STAGING TYPICAL SECTION AND STAGING PLANS. THIS WORK SHALL BE DONE USING TRAFFIC CONTROL AND PROTECTION STANDARD 701326. THE THICKNESS AND COMPOSITION OF THE TRMPORARY PAVEMENT IS AS SHOWN IN THE SPECIAL PROVISIONS.
- DURING STAGE 1 AND 2 USE STANDARD 701321 FOR TRAFFIC CONTROL AND PROTECTION
- LAY HMA SURFACE COURSE AFTER STAGE 2 USING 701201 FOR TRAFFIC CONTROL AND PROTECTION

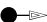

-  = TEMPORARY PAVEMENT
-  = TEMPORARY GUARD RAIL
-  = PATCH, CLASS C
-  = IMPACT ATTENUATOR
-  = DRUM WITH STEADY BURNING BI-DIRECTIONAL LIGHT
-  = TYPE III BARRICADE WITH FLASHING LIGHTS
-  = TRAFFIC SIGNAL

FILE NAME =	USER NAME = rundbladerr	DESIGNED -	REVISED -
et:\pw\work\p\midot\rundbladerr\d0232736	D201310-sh1-staging.dgn	DRAWN -	REVISED -
Default	PLOT SCALE = 40.0000' / in.	CHECKED -	REVISED -
	PLOT DATE = Thu Oct 10 13:44:19 2013	DATE -	REVISED -

**STATE OF ILLINOIS
DEPARTMENT OF TRANSPORTATION**

**STAGING PLANS
IL 78**

SCALE: SHEET OF SHEETS STA. TO STA.

F.A.P. RTE.	SECTION	COUNTY	TOTAL SHEETS	SHEET NO.
650	104T-3	JO DAVIESS	97	38
CONTRACT NO. 64F74				
ILLINOIS FED. AID PROJECT				