

PLAN

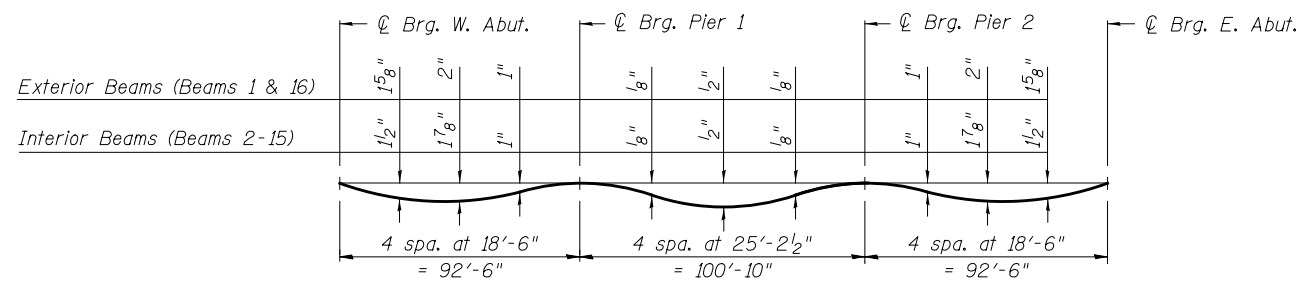

DEAD LOAD DEFLECTION DIAGRAM

(Includes weight of concrete only.)

Note:

The above deflections are not to be used in the field if the engineer is working from the "Theoretical Elevations Adjusted for Dead Load Deflections" as shown on sheets S-7 thru S-13 of S-18.

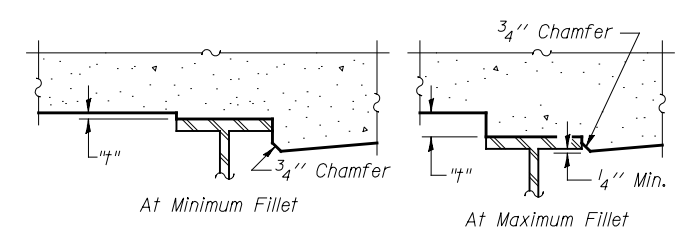

To determine "t": After all structural steel has been erected, elevations of the top flanges of the beams shall be taken at intervals shown above. These elevations subtracted from the "Theoretical Grade Elevations Adjusted for Dead Load Deflection" shown on sheets S-7 thru S-13 of S-18, minus slab thickness, equals the fillet heights "t" above top flange of beams.

FILLET HEIGHTS

THIS SHEET INCLUDED FOR INFORMATION ONLY



USER NAME =	DESIGNED - BAR	REVISED
	CHECKED - NPP	REVISED
PLOT SCALE =	DRAWN - BAR	REVISED
PLOT DATE =	CHECKED - KJZ	REVISED

STATE OF ILLINOIS
DEPARTMENT OF TRANSPORTATION

TOP OF SLAB ELEVATIONS 1
STRUCTURE NO. 022-0512

SHEET NO. S-4 OF S-18 SHEETS

F.A.P. RTE.	SECTION	COUNTY	TOTAL SHEETS	SHEET NO.
311	652-A	DuPAGE	20	6
CONTRACT NO. 60W84				

ILLINOIS FED. AID PROJECT