

Contract # 97351

BENCHMARK:
 Square Cut In Wingwall Of Box Culvert
 Sta. 34+98.47 105.91' LT
 Elev. 471.36
 Existing Structure: None

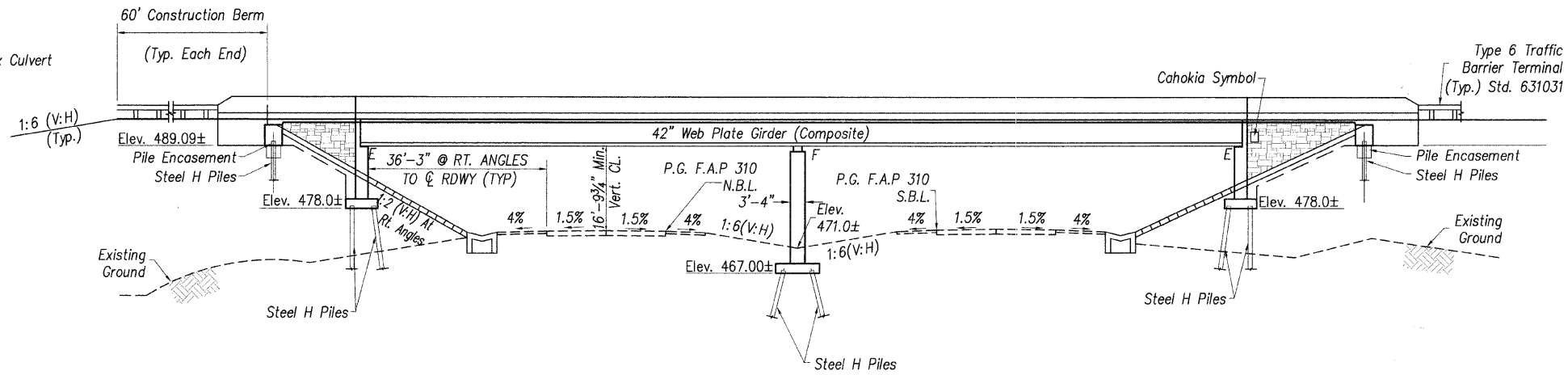

ELEVATION
(LOOKING SOUTH)

STATION 36+23.37
 BUILT 200_ BY
 VILLAGE OF BETHALTO
 SEC. 05-00016-03-BR
 F.A.U. RT. 8959
 STR. NO. 060-6851 LOADING HS20

NAME PLATE
 SEE STANDARD 515001

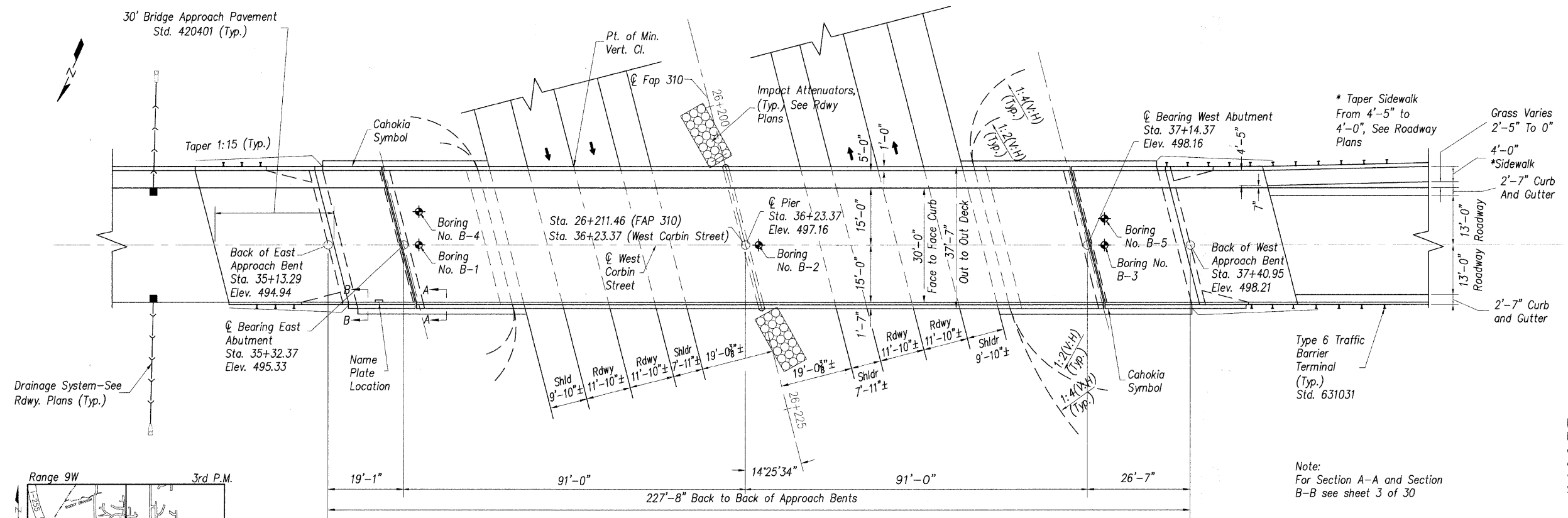

PLAN

DESIGN STRESSES
 $f_c = 3,500$ psi
 $f_y = 60,000$ psi (Reinforcement)
 $f_y = 50,000$ psi (Structural Steel)
 $f_y = 36,000$ psi (Structural Steel)

LOADING HS 20
 Allow 50 psf for Future Wearing Surface
DESIGN SPECIFICATIONS
 2002 A.A.S.H.T.O. Standard Specifications for Highway Bridges
SEISMIC DATA
 Seismic Performance Category (SPC) = A
 Bedrock Acceleration (A) = 0.09
 Site Coefficient (S) = 1.0

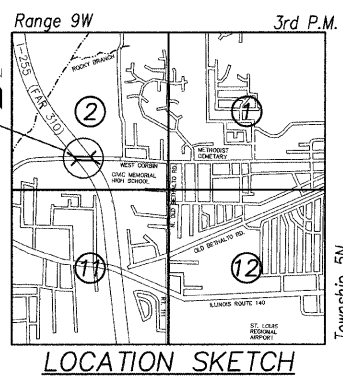

LOCATION SKETCH

DESIGNED	T.M.M.
CHECKED	C.M.W.
DRAWN	B.D.M./S.H.K.
CHECKED	C.M.W.

Hoelscher Engineering, P.C.
 11 Executive Drive Suite 12
 Fairview Heights, Illinois 62208
 (618)624-8610 FAX: (618)624-8611

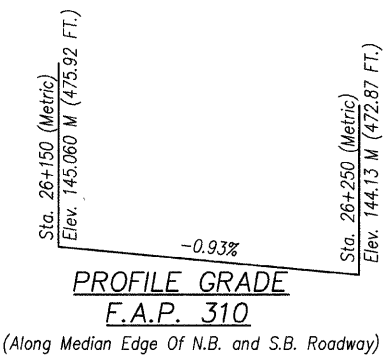

PROFILE GRADE
WEST CORBIN STREET
 (At ϕ Of Roadway)

APPROVED
 FOR STRUCTURAL ADEQUACY ONLY
Ralph E. Anderson
 ENGINEER OF BRIDGES AND STRUCTURES

I certify that to the best of knowledge, information and belief, this bridge design is structurally adequate for the design loading shown on the plans. The design is an economical one for the style of structure and complies with requirements of current AASHTO Standard Specifications for Highway Bridges.



9-16-08
 Curtis M. Watkins
 Licensed Structural Engineer
 State of Illinois No. 81-005494
 Expires 11/30/2008

ILLINOIS DEPARTMENT OF TRANSPORTATION
GENERAL PLAN
WEST CORBIN STREET OVER F.A.P. 310 (IL-255)
 F.A.U. 8959 SECTION 05-00016-03-BR
 MADISON COUNTY
 STATION 36+23.37
 STRUCTURE NO. 060-6851

REVISIONS	
NAME	DATE