

F.A.P. RTE.	SECTION	COUNTY	TOTAL SHEETS	SHEET NO.
781	1YRS, 2ZRS-1	CRAWFORD	378	87
STA. 8+900		TO STA. 9+250		
FED. ROAD DIST. NO.	ILLINOIS	FED. AID PROJECT		

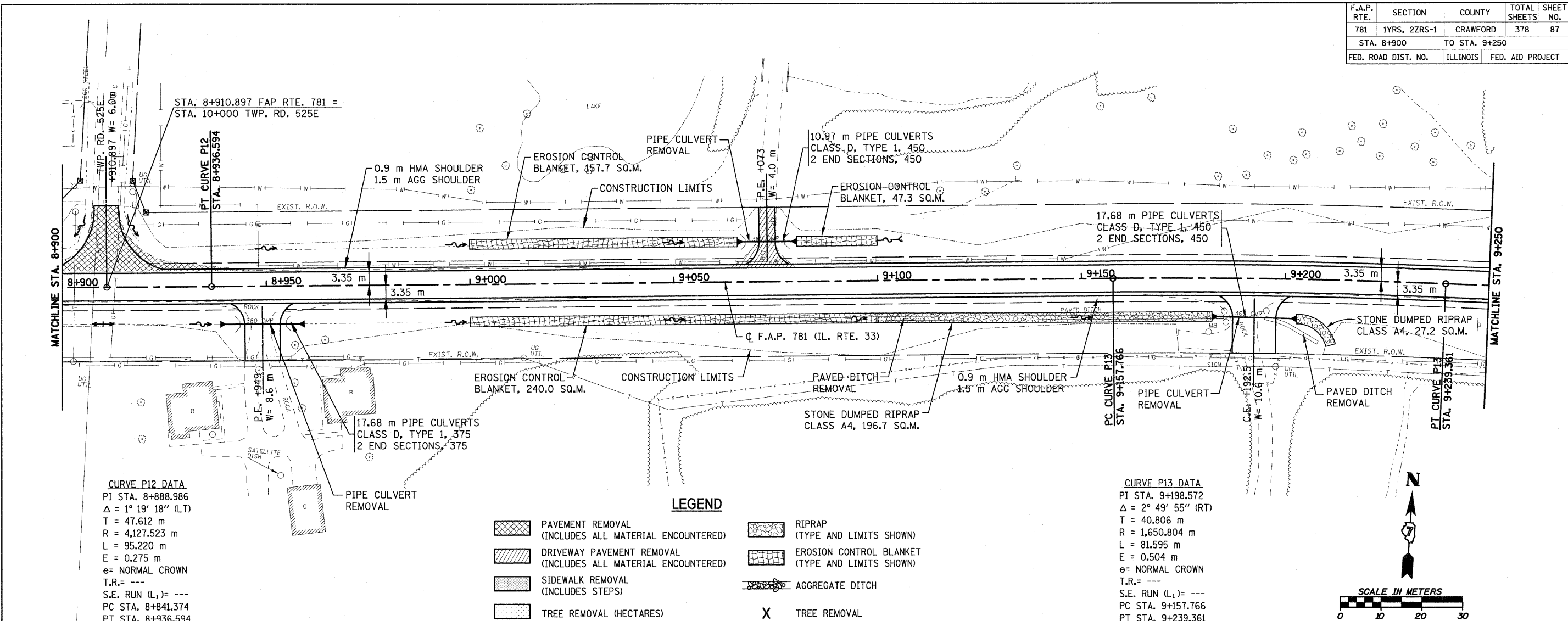

CURVE P12 DATA
 PI STA. 8+888.986
 $\Delta = 1^\circ 19' 18''$ (LT)
 T = 47.612 m
 R = 4,127.523 m
 L = 95.220 m
 E = 0.275 m
 e = NORMAL CROWN
 T.R. = ---
 S.E. RUN (L₁) = ---
 PC STA. 8+841.374
 PT STA. 8+936.594

LEGEND

- PAVEMENT REMOVAL (INCLUDES ALL MATERIAL ENCOUNTERED)
- DRIVEWAY PAVEMENT REMOVAL (INCLUDES ALL MATERIAL ENCOUNTERED)
- SIDEWALK REMOVAL (INCLUDES STEPS)
- TREE REMOVAL (HECTARES)
- RIPRAP (TYPE AND LIMITS SHOWN)
- EROSION CONTROL BLANKET (TYPE AND LIMITS SHOWN)
- AGGREGATE DITCH
- TREE REMOVAL

CURVE P13 DATA
 PI STA. 9+198.572
 $\Delta = 2^\circ 49' 55''$ (RT)
 T = 40.806 m
 R = 1,650.804 m
 L = 81.595 m
 E = 0.504 m
 e = NORMAL CROWN
 T.R. = ---
 S.E. RUN (L₁) = ---
 PC STA. 9+157.766
 PT STA. 9+239.361

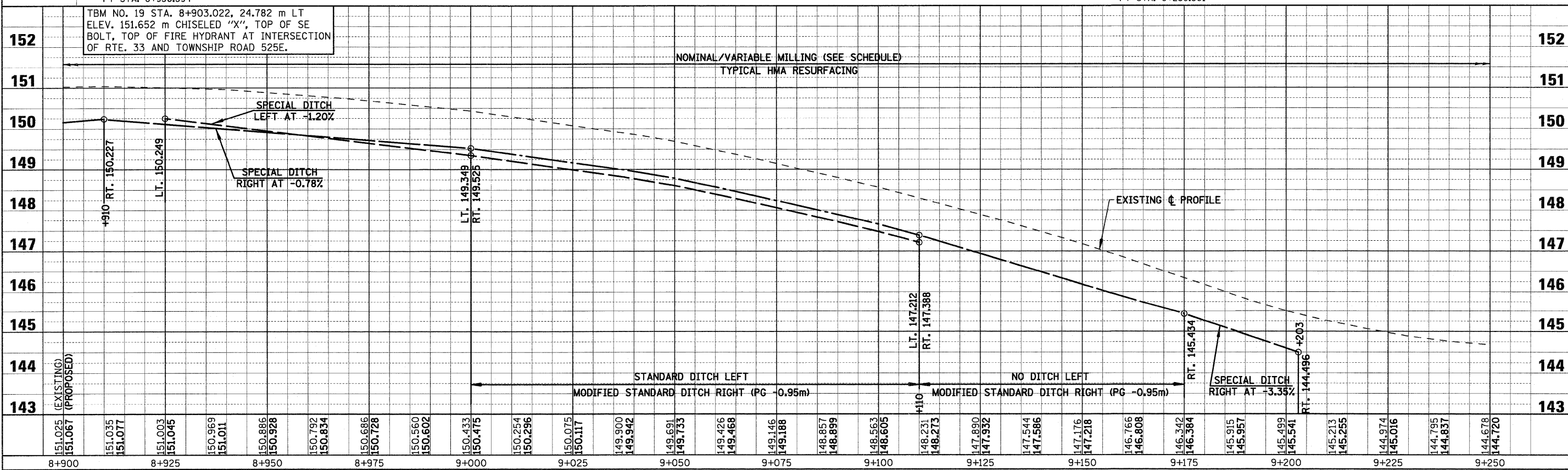
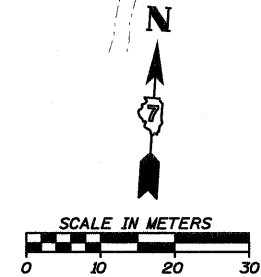

TBM NO. 19 STA. 8+903.022, 24.782 m LT
 ELEV. 151.652 m CHISELED "X", TOP OF SE
 BOLT, TOP OF FIRE HYDRANT AT INTERSECTION
 OF RTE. 33 AND TOWNSHIP ROAD 525E.