

ELEVATION

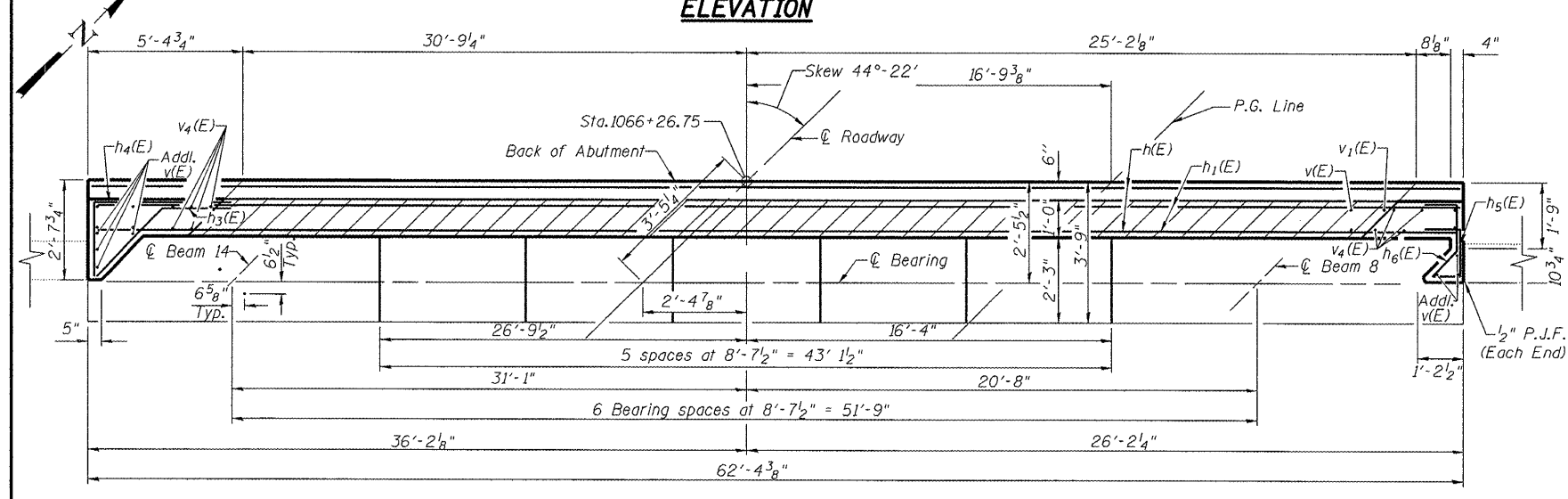

TOP VIEW

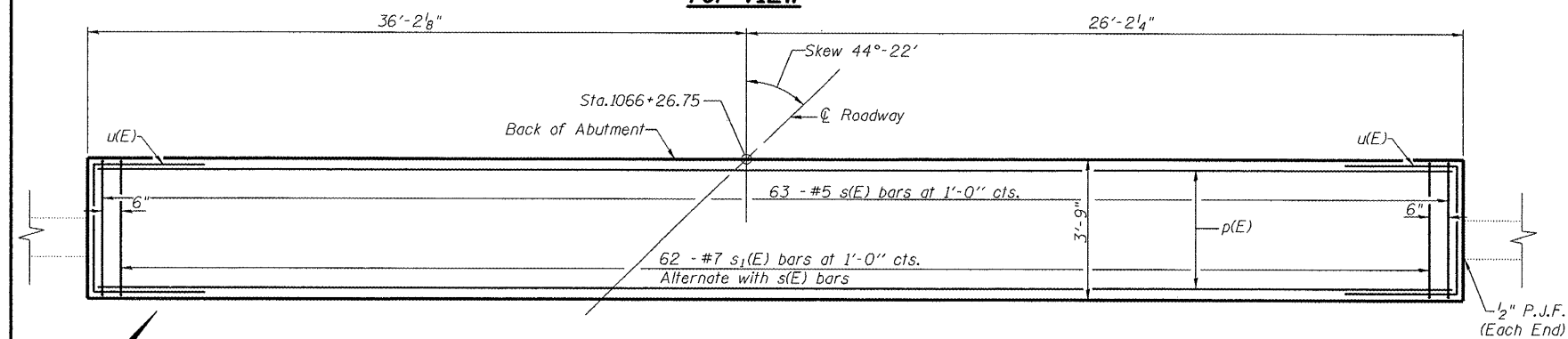

PLAN-CAP

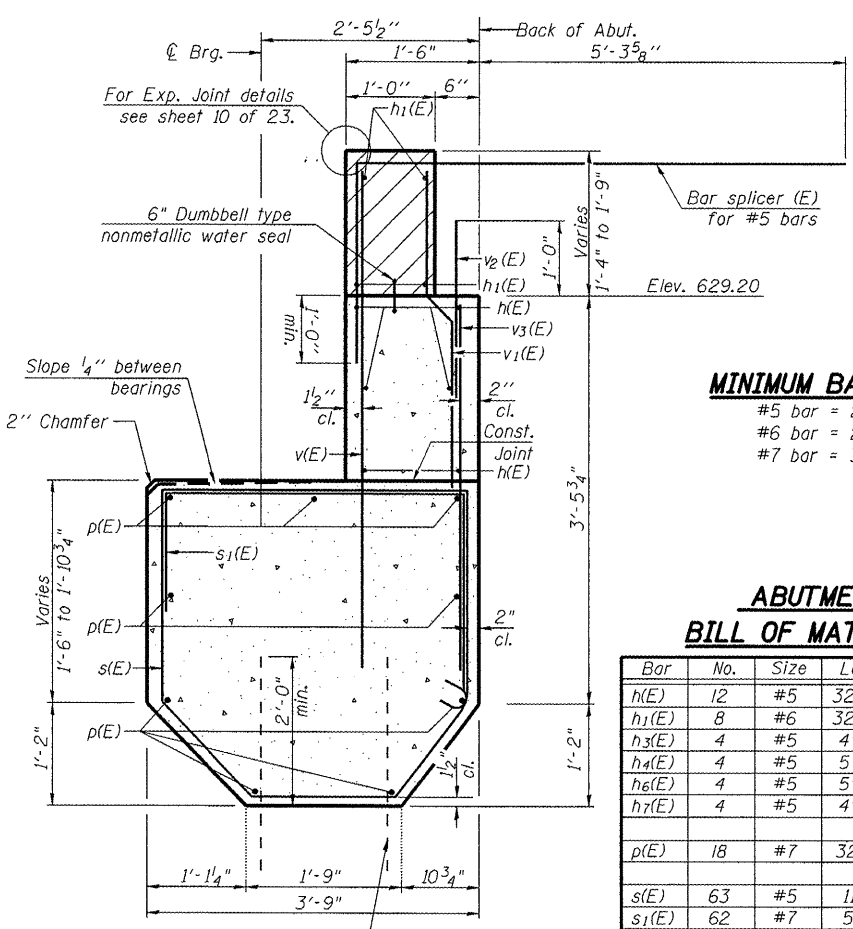

MINIMUM BAR LAP
#5 bar = 2'-5"
#6 bar = 2'-10"
#7 bar = 3'-10"

ABUTMENT
BILL OF MATERIAL

Bar No.	Size	Length	Shape
h(E)	12 #5	32'-7"	—
h1(E)	8 #6	32'-10"	—
h3(E)	4 #5	4'-5"	—
h4(E)	4 #5	5'-4"	—
h6(E)	4 #5	5'-1"	—
h7(E)	4 #5	4'-4"	—
p(E)	18 #7	32'-11"	—
s(E)	63 #5	11'-1"	—
s1(E)	62 #7	5'-9"	—
u(E)	6 #6	9'-0"	—
v(E)	70 #5	5'-4"	—
v1(E)	63 #4	3'-6"	—
v2(E)	60 #5	2'-0"	—
v3(E)	63 #5	3'-1"	—
v4(E)	8 #5	4'-0"	—

▲ Structure Excavation Cu. Yd. 41
▲ Concrete Structures Cu. Yd. 32
▲ Reinforcement Bars, Epoxy Coated Pound 4510
▲ Bar Splicers Each 40
▲ Concrete Sealer Sq. Ft. 583

For details of Bar Splicers, see sheet 13 of 23.
Bars indicated thus 9x2-#7 etc. indicates 9 lines of bars with 2 lengths per line.
▲ For Information Only

SEC. THRU ABUT.

FOR INFORMATION ONLY

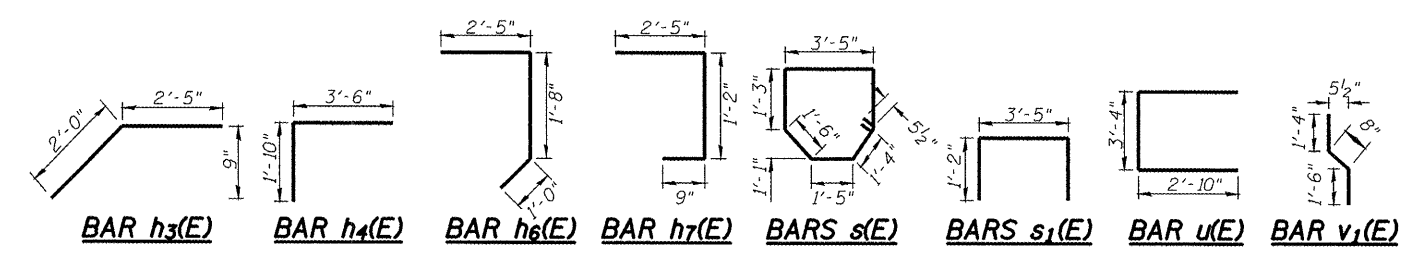

Notes:
Hatched area to be poured after superstructure false work has been removed. Quantity of concrete included with Concrete Superstructure.
Space reinforcement in cap to miss anchor bolts. Four steps monolithically with cap.
All exposed corners shall have a 3/4" chamfer (typ.)
The bar splicer is to be placed parallel to the approach pavement reinforcement.

ILLINOIS DEPARTMENT OF TRANSPORTATION

**SOUTHBOUND NORTH ABUTMENT DETAILS
I 55 OVER MACOUPIN CREEK
F.A.I. ROUTE 55 - SEC. (68-4)F
MONTGOMERY COUNTY
STATION 1066+03.18
STRUCTURE NO. 068-0038 N.B.
STRUCTURE NO. 068-0039 S.B.**

DATE: 04-08
REVISED: DRAWN BY: MLO
CHECKED BY: PBB