

F.A.P. RTE.	SECTION	COUNTY	TOTAL SHEETS	SHEET NO.
646	(122)I	BUREAU	18	1
FED. ROAD DIST. NO.	ILLINOIS	CONTRACT NO. 66858		

STATE OF ILLINOIS  
DEPARTMENT OF TRANSPORTATION  
DIVISION OF HIGHWAYS

**PROPOSED  
HIGHWAY PLANS**  
F.A.P. ROUTE 646 (IL 40)  
SECTION (122)I  
PROJECT F-0646(068)  
BUREAU COUNTY

C - 93 - 140 - 08

REPLACEMENT OF EXSTING SN 006-2526,  
LOCATED 7.2 MILES SOUTH OF US 6,  
WITH A PRECAST BOX CULVERT

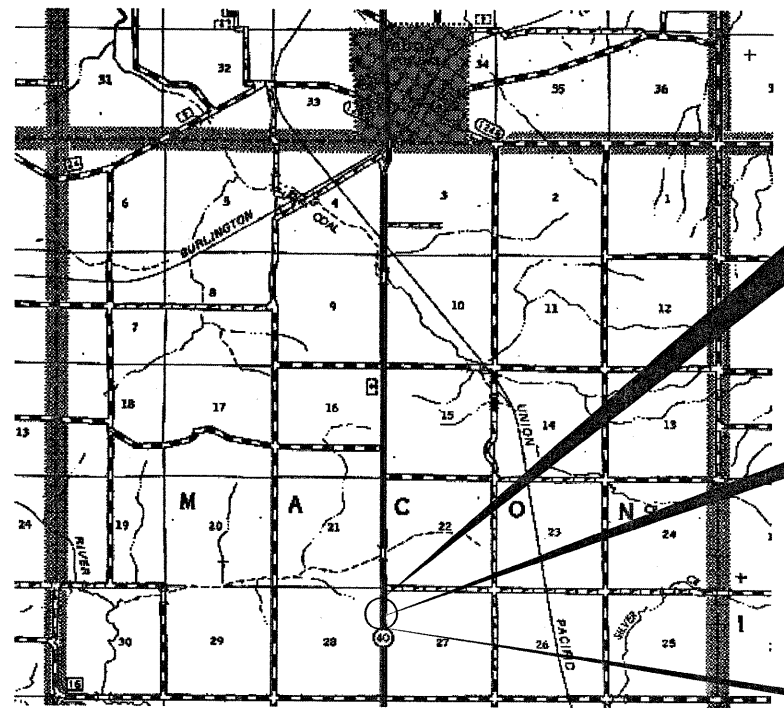

LOCATION MAP  
NOT TO SCALE

GROSS LENGTH = NET LENGTH = 490 FT. = 0.093 MILE

BEGIN IMPROVEMENT  
STA 376+50

SN 006-2573  
STA 379+00  
10' X 5' PRECAST BOX  
CULVERT WITH CAST  
IN PLACE END SECTIONS

END IMPROVEMENT  
STA 381+40

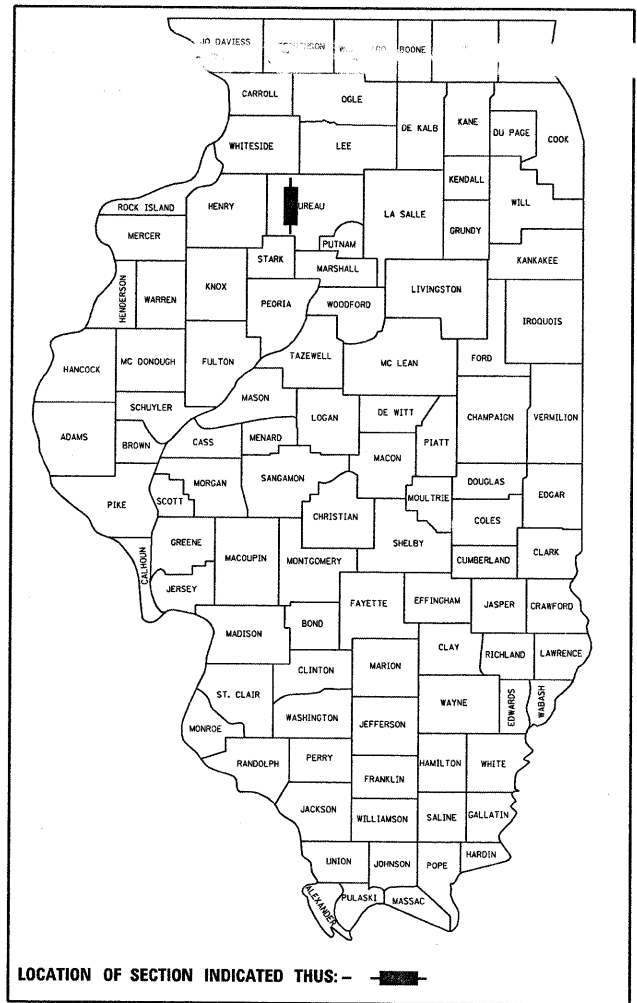

FUNCTIONAL CLASSIFICATION  
RURAL MINOR ARTERIAL  
2009 ADT = 1,400  
P.V. = 79.3%  
S.U. = 5.9%  
M.U. = 14.8%

STATE OF ILLINOIS  
DEPARTMENT OF TRANSPORTATION  
DIVISION OF HIGHWAYS

SUBMITTED 10/22 20 08

*George Pym*  
DEPUTY DIRECTOR OF HIGHWAYS, REGION ENGINEER  
December 5, 20 08

*Eric E. Harms*  
ENGINEER OF DESIGN AND ENVIRONMENT  
December 5, 20 08

*Christine M. Reed*  
DIRECTOR OF HIGHWAYS, CHIEF ENGINEER

PRINTED BY THE AUTHORITY  
OF THE STATE OF ILLINOIS

INDEX OF SHEETS

- 1 COVER SHEET
- 2 GENERAL NOTES
- 3 SUMMARY OF QUANTITIES
- 4 TYPICAL SECTIONS
- 5 SCHEDULES
- 6 PLAN AND PROFILE SHEETS
- 7 DETOUR PLAN
- 8-13 CULVERT PLANS
- 14-15 DETAILS
- 16-18 CROSS SECTIONS

STANDARDS

- BLR 22-6 TYPICAL APP OF T.C.D. RURAL LOCAL HIGHWAY (2-LANE 2-WAY RURAL TRAF.) (ROAD CLOSED TO THRU TRAFFIC)
- 000001-05 STANDARD SYMBOLS, ABBREVIATIONS AND PATTERNS
- 001001-02 AREAS OF REINFORCEMENT BARS
- 001006 DECIMAL OF AN INCH AND OF A FOOT
- 280001-04 TEMPORARY EROSION CONTROL SYSTEMS
- 542401-01 METAL END SECTION FOR PIPE CULVERTS
- 630001-08 STEEL PLATE BEAM GUARDRAIL
- 630101-08 GUARDRAIL MOUNTED ON EXISTING CULVERTS
- 630201-06 PCC/HMA STABILIZATION AT STEEL PLATE BEAM GUARDRAIL
- 630301-05 SHOULDER WIDENING FOR TYPE 1 (SPECIAL) GUARDRAIL TERMINALS
- 635006-03 REFLECTOR AND TERMINAL MARKER PLACEMENT
- 635011-02 REFLECTOR MARKER AND MOUNTING DETAILS
- 701001-02 OFF-ROAD OPERATIONS 2L, 2W, MORE THAN 15' (4.5 m) AWAY
- 701006-03 OFF-ROAD OPERATIONS 2L, 2W, 15' (4.5 m) TO 24" (600 mm) FROM PAVEMENT EDGE
- 701011-02 OFF-ROAD MOVING OPERATIONS 2L, 2W, DAY ONLY
- 701306-02 LANE CLOSURE, 2L, 2W, SLOW MOVING OPERATIONS DAY ONLY, FOR SPEEDS P 45 MPH
- 701311-03 LANE CLOSURE, 2L, 2W, MOVING OPERATIONS - DAY ONLY
- 701901-01 TRAFFIC CONTROL DEVICES
- 780001-02 TYPICAL PAVEMENT MARKINGS

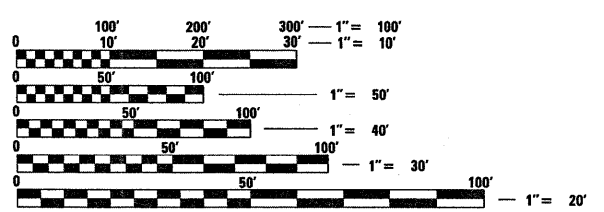

FULL SIZE PLANS HAVE BEEN PREPARED USING STANDARD ENGINEERING SCALES. REDUCED SIZED PLANS WILL NOT CONFORM TO STANDARD SCALES. IN MAKING MEASUREMENTS ON REDUCED PLANS, THE ABOVE SCALES MAY BE USED.

J.U.I.E.  
JOINT UTILITY LOCATION INFORMATION FOR EXCAVATION  
1-800-892-0123  
OR 811

PROJECT ENGINEER: JOE KANNEL  
SQUAD LEADER: MICHELE LINDEMANN

CONTRACT NO. 66858