

CASE I

CASE II

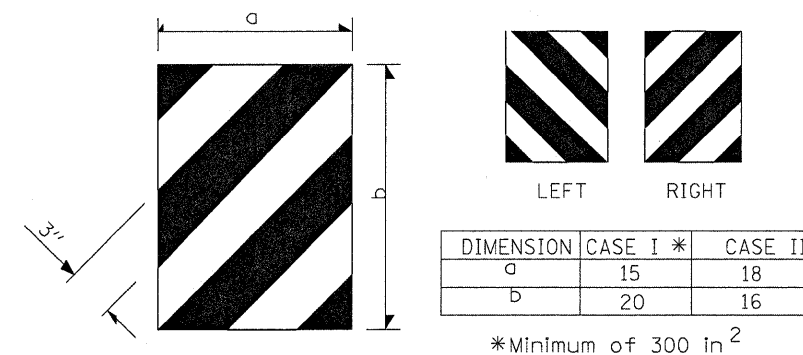

### TERMINAL MARKER DETAILS

Color: Black / Yellow reflectorized

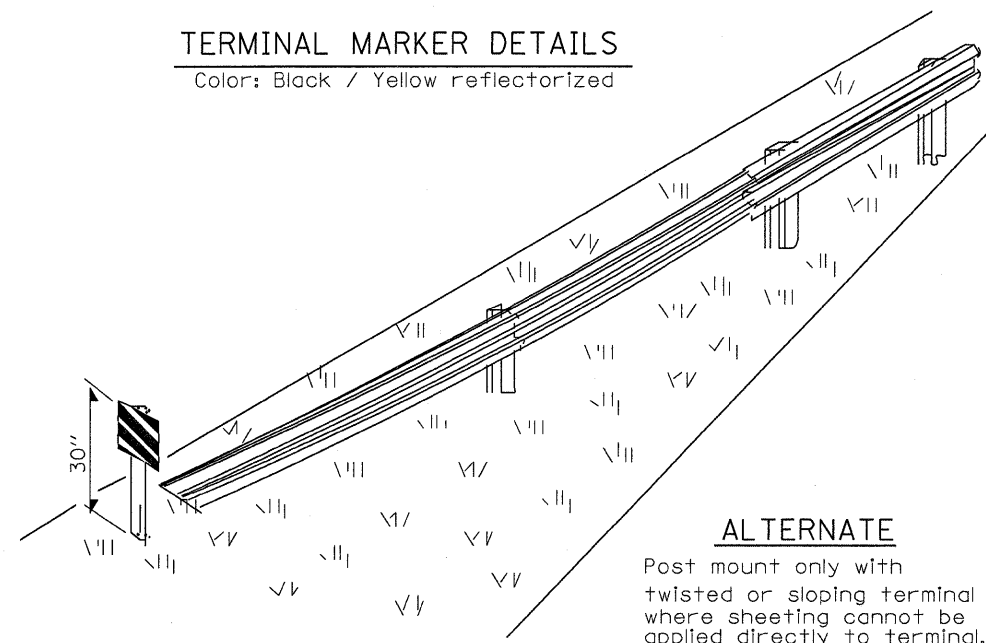

### ALTERNATE

Post mount only with twisted or sloping terminal where sheeting cannot be applied directly to terminal.

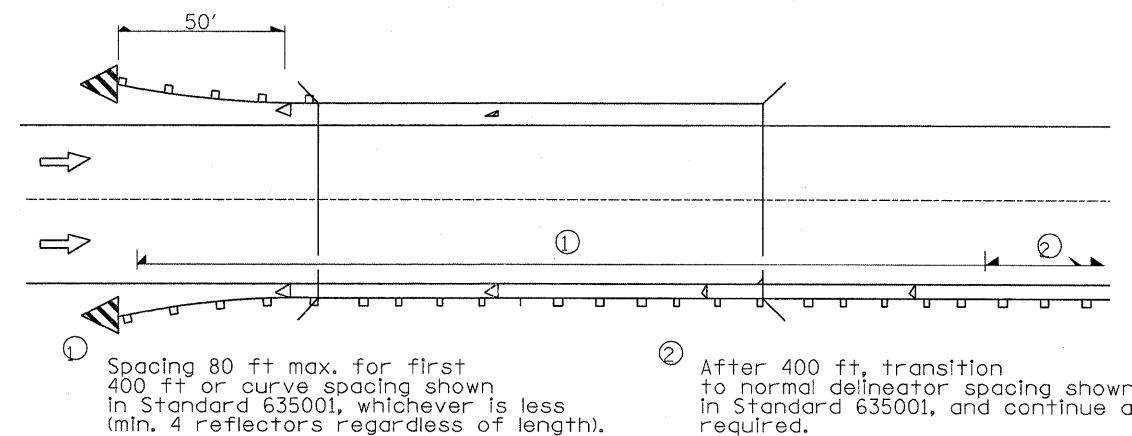

ONE-WAY TRAFFIC

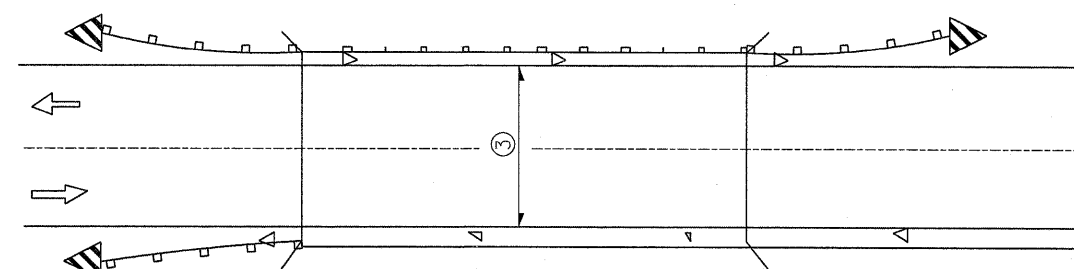

- ◁ Monodirectional silver
- ◁ Monodirectional amber
- ◁ Terminal Marker - Black/Yellow Left or Right as appropriate

TWO-WAY TRAFFIC

### GUARDRAIL / BARRIER WALL / BRIDGE RAIL REFLECTORS

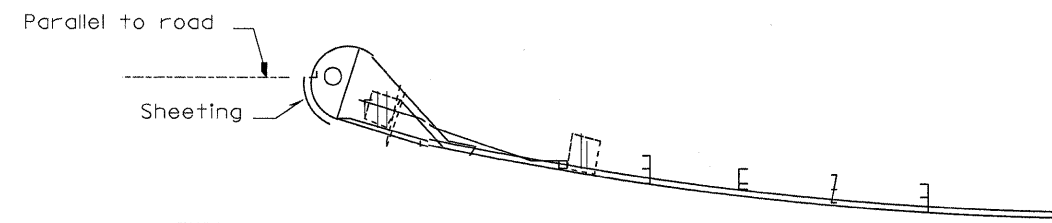

SHEETING POSITION: CASE II

FILE NAME =	USER NAME = braboygo	DESIGNED -	REVISED -	STATE OF ILLINOIS DEPARTMENT OF TRANSPORTATION	REFLECTOR AND TERMINAL MARKER PLACEMENT	F.A.P. RTE.	SECTION	COUNTY	TOTAL SHEETS	SHEET NO.
es:\pw\work\p\dot\braboygo\dms48744\0368835 Details.DGN		DRAWN -	REVISED -			587	(22)I & I-1	LASALLE	31	23
PLOT SCALE = 50,0000' / IN.		CHECKED -	REVISED -			CONTRACT NO. 66835				
PLOT DATE = Oct 17, 2008 - 07:40:48 AM		DATE -	REVISED -			FED. ROAD DIST. NO. - ILLINOIS FED. AID PROJECT				