

INDEX OF SHEETS

- 1 COVERSHEET
- 2 GENERAL NOTES
- 3 SUMMARY OF QUANTITIES
- 4-5 TYPICAL SECTION
- 6-7 SCHEDULES
- 8-10 PLAN & PROFILE
- 11-12 DETOUR
- 13-14 RIGHT-OF-WAY SHEETS
- 15-17 BOX CULVERT SN 050-2051
- 18-21 BOX CULVERT SN 050-2052
- 22-24 DETAILS
- 25-31 CROSS SECTIONS

STANDARDS

- | | |
|-----------|--|
| 000001-05 | STANDARD SYMBOLS, ABBREVIATIONS AND PATTERNS |
| 001001-02 | AREAS OF REINFORCEMENT BARS |
| 001006 | DECIMAL OF AN INCH AND OF A FOOT |
| 280001-04 | TEMPORARY EROSION CONTROL SYSTEMS |
| 515001-03 | NAME PLATE FOR BRIDGES |
| 630001-08 | STEEL PLATE BEAM GUARDRAIL |
| 630201-06 | PCC/HMA STABILIZATION AT STEEL PLATE BEAM GUARDRAIL |
| 630301-05 | SHOULDER WIDENING FOR TYPE 1 (SPECIAL) GUARDRAIL TERMINALS |
| 635006-03 | REFLECTOR AND TERMINAL MARKER PLACEMENT |
| 635011-02 | REFLECTOR MARKER AND MOUNTING DETAILS |
| 666001-01 | RIGHT-OF-WAY MARKERS |
| 701001-02 | OFF-ROAD OPERATIONS 2L, 2W, MORE THAN 15' (4.5 m) AWAY |
| 701006-03 | OFF-ROAD OPERATIONS 2L, 2W, 15' (4.5 m) TO 24" (600 mm) FROM PAVEMENT EDGE |
| 701011-02 | OFF-ROAD MOVING OPERATIONS 2L, 2W, DAY ONLY |
| 701301-03 | LANE CLOSURE, 2L, 2W, SHORT TIME OPERATIONS |
| 701306-02 | LANE CLOSURE, 2L, 2W, SLOW MOVING OPERATIONS DAY ONLY, FOR SPEEDS P 45 MPH |
| 701901-01 | TRAFFIC CONTROL DEVICES |
| 780001-02 | TYPICAL PAVEMENT MARKINGS |
| 781001-03 | TYPICAL APPLICATIONS RAISED REFLECTIVE PAVEMENT MARKERS |

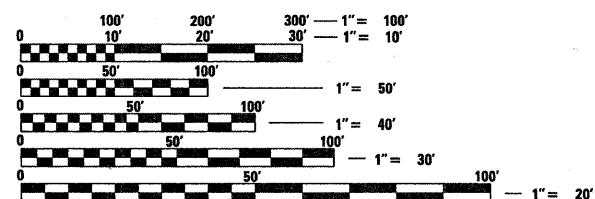

FULL SIZE PLANS HAVE BEEN PREPARED USING STANDARD ENGINEERING SCALES. REDUCED SIZED PLANS WILL NOT CONFORM TO STANDARD SCALES. IN MAKING MEASUREMENTS ON REDUCED PLANS, THE ABOVE SCALES MAY BE USED.

J.U.L.I.E.
JOINT UTILITY LOCATION INFORMATION FOR EXCAVATION
1-800-892-0123
OR 811

PROJECT ENGINEER: JOE KANNEL

UNIT CHIEF: PATRICK BRABOY

TOWNSHIP: MENDOTA

CONTRACT NO. 66835

STATE OF ILLINOIS

DEPARTMENT OF TRANSPORTATION

DIVISION OF HIGHWAYS

PROPOSED

HIGHWAY PLANS

FAP 587 (US ROUTE 34)

SECTION (22)I & I-1

PROJECT F-0587(023)

LASALLE COUNTY

C-93-107-08

BOX CULVERT REPLACEMENTS

PR SN 050-2052
STA 1176+57.28
DOUBLE 12' X 7' BC

PR SN 050-2051
STA 1118+15.00
DOUBLE 8' X 6' BC

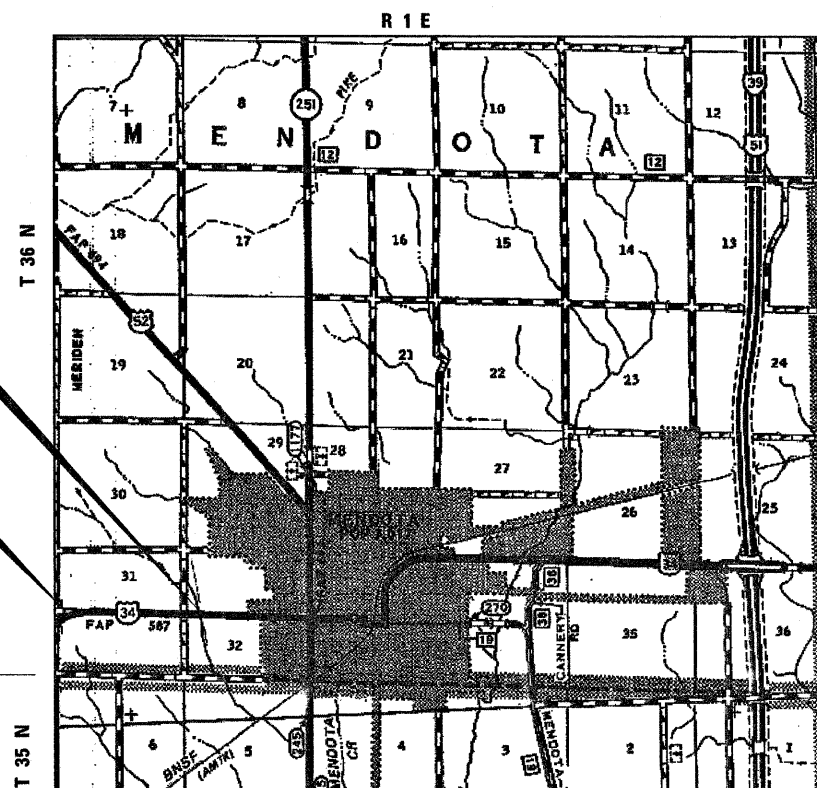

GROSS LENGTH = 6368 FT. = 1.20 MILE
NET LENGTH = 1368 FT. = 0.25 MILE

F.A.P. RTE.	SECTION	COUNTY	TOTAL SHEETS	SHEET NO.
587	(22)I & I-1	LASALLE	31	1
FED. ROAD DIST. NO.	ILLINOIS	CONTRACT NO. 66835		

P-93-028-06
D-93-072-08

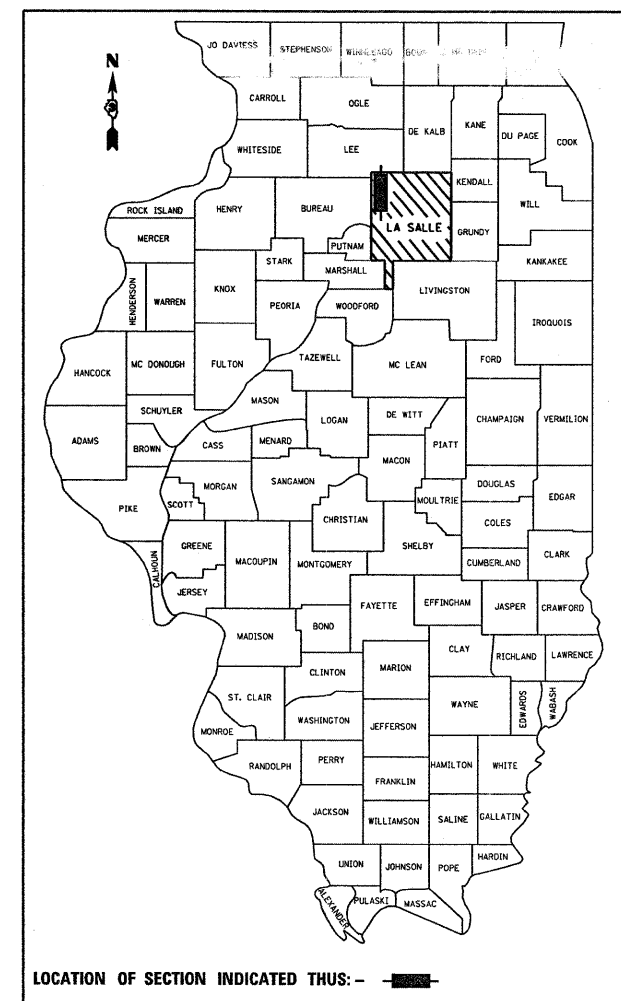

LOCATION OF SECTION INDICATED THUS: -

FUNCTIONAL CLASSIFICATION
RURAL MINOR ARTERIAL
(CLASS 3 DESIGNATED TRUCK ROUTE)

2007 ADT = 2,400
P.V. = 87.5% S.U. = 5.2% M.U. = 7.3%

STATE OF ILLINOIS
DEPARTMENT OF TRANSPORTATION
DIVISION OF HIGHWAYS

SUBMITTED 10-17 20 08

John P. Ryan
DEPUTY DIRECTOR OF HIGHWAYS, REGION ENGINEER

December 5, 20 08
Eric E. Harn
INTERIM ENGINEER OF DESIGN AND ENVIRONMENT

December 5, 20 08
Christine M. Reed
DIRECTOR OF HIGHWAYS, CHIEF ENGINEER

PRINTED BY THE AUTHORITY
OF THE STATE OF ILLINOIS