

EROSION CONTROL SCHEDULE:

- INSTALL PERIMETER EROSION BARRIER. INSTALL INLET FILTERS ON EXISTING INLETS.
- BEGIN CLEARING AND GRUBBING FOR CONSTRUCTION OF DITCHES AND OTHER DRAINAGE FEATURES.
- NO WORK SHALL BE PERFORMED IN FLOWING WATER AND NO EQUIPMENT SHALL ENTER SALT CREEK WITHOUT APPROVAL FROM KDSWCD. WORK IN AND NEAR STREAM AND STREAMBANKS SHOULD BE ISOLATED FROM CONCENTRATED FLOWS OR STREAM FLOW.
- BEGIN TEMPORARY SEEDING ON ALL ERODABLE/BARE AREAS EVERY SEVEN DAYS. STABILIZE STOCKPILES WITHIN 3 DAYS.
- CONSTRUCT DITCH AND PLACE TEMPORARY DITCH CHECKS.
- BEGIN TOPSOIL REMOVAL AND STOCKPILING OF TOPSOIL. BEGIN EXCAVATION AND STOCKPILING OF SUITABLE FILL.
- STABILIZE DENUDED AREAS WITHIN 7 DAYS AND STOCKPILES WITHIN 3 DAYS OF LAST CONSTRUCTION ACTIVITY IN THAT AREA.
- THE STREAM BANKS SHOULD BE STABILIZED AT THE END OF EACH DAY. ONCE WORK IN THIS AREA BEGINS, PRIORITY SHALL BE GIVEN TO THE COMPLETION OF THE WORK AND FINAL STABILIZATION OF ALL DISTURBED AREAS.
- BEGIN CONSTRUCTION OF ROADWAY EMBANKMENTS.
- INSTALL STORM SEWER, CURB AND GUTTER. PLACE TEMPORARY INLET PROTECTION.
- INSTALL A DEWATERING AREA. SKIM AND BYPASS CLEAN WATER AND CONSTRUCT SEDIMENT TRAPS AND FABRIC BAG OR POLYMER FOR SEDIMENT FILTERING. PREVENT SCOURING.
- INSTALL EITHER A STABILIZED HAUL ROAD OR STONE ACCESS PAD ON THE BANK OR WITHIN THE COFFER DAM AREA FOR EQUIPMENT ACCESS. INSTALL TEMPORARY SHEET PILING. BEGIN BRIDGE CONSTRUCTION (SEE NOTE 3).
- MONITOR SEDIMENT CONTROL PRACTICES DAILY TO ADDRESS TDML (TOTAL MAXIMUM DAILY LOADS) REQUIREMENT FOR IMPAIRED WATERWAYS.
- COMPLETE GRADING AND INSTALL PERMANENT SEEDING AND PLANTINGS.
- COMPLETE PAVING. COMPLETE BRIDGE CONSTRUCTION.
- WHEN ALL CONSTRUCTION ACTIVITY IS COMPLETE AND SITE IS STABILIZED, REMOVE PERIMETER EROSION BARRIER TEMPORARY DITCH CHECKS AND ANY ACCUMULATED SEDIMENT. RE-SEED ANY AREAS DISTURBED BY THEIR REMOVAL. REMOVE TEMPORARY INLET PROTECTION.

LEGEND

SYMBOL	DESCRIPTION
	INLET FILTERS (SEE NOTE 1)
	TEMPORARY DITCH CHECK (SEE NOTE 1)
	SEDIMENT BASIN FOR DEWATERING
	DOUBLE ROW PERIMETER EROSION BARRIER (SILT FENCE)
	DUST CONTROL
	SEEDING, CLASS 4A (MODIFIED), SEEDING, CLASS 5 (MODIFIED) AND EROSION CONTROL BLANKET (SEE NOTE 2)
	RIPRAP

CONTRACT NO. 63077

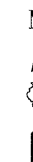

DATE	BY
DATE	BY

DATE	BY
DATE	BY

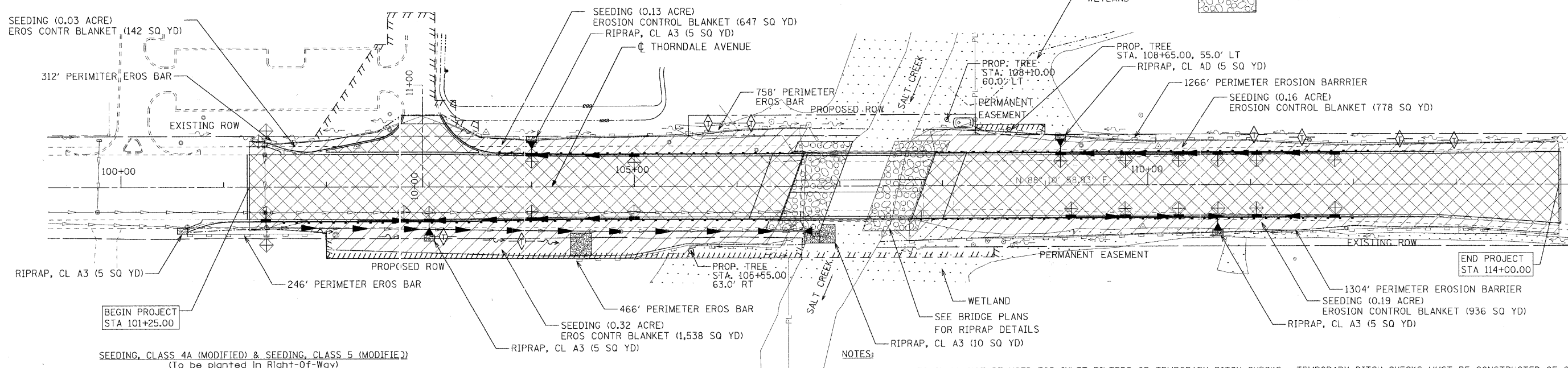

- NOTES:**
- STRAW BALES SHALL NOT BE USED FOR INLET FILTERS OR TEMPORARY DITCH CHECKS. TEMPORARY DITCH CHECKS MUST BE CONSTRUCTED OF STONE. REFER TO IDOT STANDARD DETAIL 280001-4 FOR SIZING. TEMPORARY DITCH CHECKS MUST BE PLACED IMMEDIATELY AFTER GRADING. SEDIMENT SHALL BE REMOVED FROM EROSION CONTROL SYSTEMS WHEN THE HEIGHT OF THE SEDIMENT EXCEEDS ONE-HALF OF THE HEIGHT OF THE FILTER DEVICE.
 - EROSION CONTROL BLANKET SHALL BE BIONET/UN-STITCHED OR HABITAT FRIENDLY WHEN PLACED DIRECTLY ADJACENT TO SALT CREEK. A DOUBLE NET BLANKET SUITABLE FOR HANDLING CONCENTRATED FLOWS SHOULD BE USED IN PROPOSED DITCHES UPSLOPE FROM THE CREEK.
 - ALL DISTURBED WORK AREAS MUST BE ISOLATED FROM CREEK FLOWS AT ALL TIMES, INCLUDING A-FRAME STRUCTURES, STEEL SHEETS, TRENCH BOXES, JERSEY BARRIERS OR WATER FILLED BLADDERS, ETC. THE DIVERSION/ISOLATION OF THE CREEK FLOWS MUST BE CONSTRUCTED FROM NON-ERODIBLE MATERIALS. THE KDSWCD MUST BE IN AGREEMENT WITH OVERALL EXACT METHOD OF DIVERSION/ISOLATION PRIOR TO THE COMMENCEMENT OF CONSTRUCTION. CONSTRUCTION ACCESS ISSUES SUCH AS PLACEMENT OF HAUL ROAD AND COFFERDAM MUST BE ADDRESSED PRIOR TO PRE-CONSTRUCTION MEETING. CONTACT KDSWCD AT 630-584-7961 EXT. 3.
 - THE KANE-DUPAGE SOIL AND WATER CONSERVATION DISTRICT (KDSWCD) MUST BE NOTIFIED ONE WEEK PRIOR TO THE COMMENCEMENT OF LAND DISTURBING ACTIVITIES, AND ONE WEEK PRIOR TO THE FINAL INSPECTION. A COPY OF THE APPROVED EROSION AND SEDIMENT CONTROL PLAN SHALL BE MAINTAINED ON THE SITE AT ALL TIMES. A SHOP DRAWING OF COFFERDAM AND CREEK WORK SHALL BE SUBMITTED TO KDSWCD PRIOR TO STARTING WORK.
 - PRIOR TO COMMENCING LAND-DISTURBING ACTIVITIES IN AREAS OTHER THAN INDICATED ON THESE PLANS, INCLUDING BUT NOT LIMITED TO ADDITIONAL PHASES OF DEVELOPMENT SUCH AS: DEWATERING METHODS, COFFERDAM SELECTION AND OFF-SITE BORROW OR WASTE AREAS) A SUPPLEMENTARY EROSION CONTROL PLAN SHALL BE SUBMITTED TO THE OWNER FOR REVIEW BY THE KDSWCD.
 - THE CONTRACTOR IS RESPONSIBLE FOR INSTALLATION OF ANY ADDITIONAL EROSION CONTROL MEASURES NECESSARY TO PREVENT EROSION AND SEDIMENTATION AS DETERMINED BY THE KDSWCD.

Species	Common Name	Lbs/acre	Size of Stock (in.)
Andropogon scoparius	Little bluestem	4.000	24-36
Bouteloua curtipendula	Side-oats grama	4.000	12-36
Elymus virginicus	Virginia wild rye	1.000	24-36
Sporobolus heterolepis	Prairie drop seed	0.500	12-24
Species	Common Name	Lbs/acre	Size of Stock (in.)
Asclepias tuberosa	Butterfly milkweed	0.125	12-36
Asclepias verticillata	Whorled milkweed	0.125	12-24
Aster azureus	Sky blue aster	0.050	6-24
Aster ericoides	Heath aster	0.050	12-36
Aster laevis	Smooth blue aster	0.015	12-48
Aster novae-angliae	New England aster	0.050	12-48
Cassia fasciculata	Partridge pea	0.125	6-36
Coreopsis lanceolata	Sand coreopsis	0.100	24-36
Coreopsis palmata	Prairie coreopsis	0.015	12-36
Desmanthus illinoense	Illinois sensitive plant	0.125	12-48
Echinacea purpurea	Broad-leaved purple coneflower	0.500	24-36
Monarda fistulosa	Wild bergamot	0.050	24-48
Petalostemum candidum	White prairie clover	0.065	12-24
Petalostemum purpureum	Purple prairie clover	0.500	12-24
Ratibida pinnata	Yellow coneflower	0.250	12-48
Rudbeckia hirta	Black-eyed Susan	1.000	12-36
Solidago graminifolia	Grass-leaved goldenrod	0.125	12-48
Solidago nemoralis	Old-field goldenrod	0.125	6-20
Solidago rigida	Stiff goldenrod	0.125	12-48
Tradescantia ohiensis	Common spiderwort	0.050	12-48
Verbena stricta	Hoary vervain	0.100	12-24
Cover crop:	Annual rye @ 10 lbs. per acre		12-24
	Seed oats @ 32 lbs. per acre		12-30

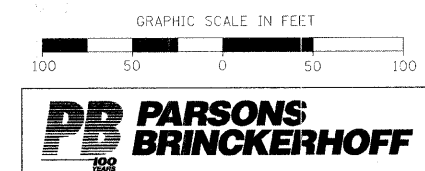

FOR ADDITIONAL EROSION CONTROL NOTES SEE GENERAL NOTES.

REVISIONS	
NAME	DATE
S. VERTHEIN	11/06/08

DUPAGE COUNTY DIVISION OF TRANSPORTATION
 THORNDALE AVENUE OVER SALT CREEK
LANDSCAPING, EROSION AND SEDIMENT CONTROL DETAILS
 SCALE: 1" = 50'
 DATE: 09-05-08
 DRAWN BY: SJV
 CHECKED BY: PVS