

F.A. RTE.	SECTION	COUNTY	TOTAL SHEETS	SHEET NO.
345	98-00153-02-BR	DUPAGE	65	23
STA. 101+25.00		TO STA. 114+00.00		
FED. ROAD DIST. NO. 1		ILLINOIS FED. AID PROJECT		
		MOT-06 OF 08		

CONTRACT NO. 63077

DATE	BY

DATE	BY

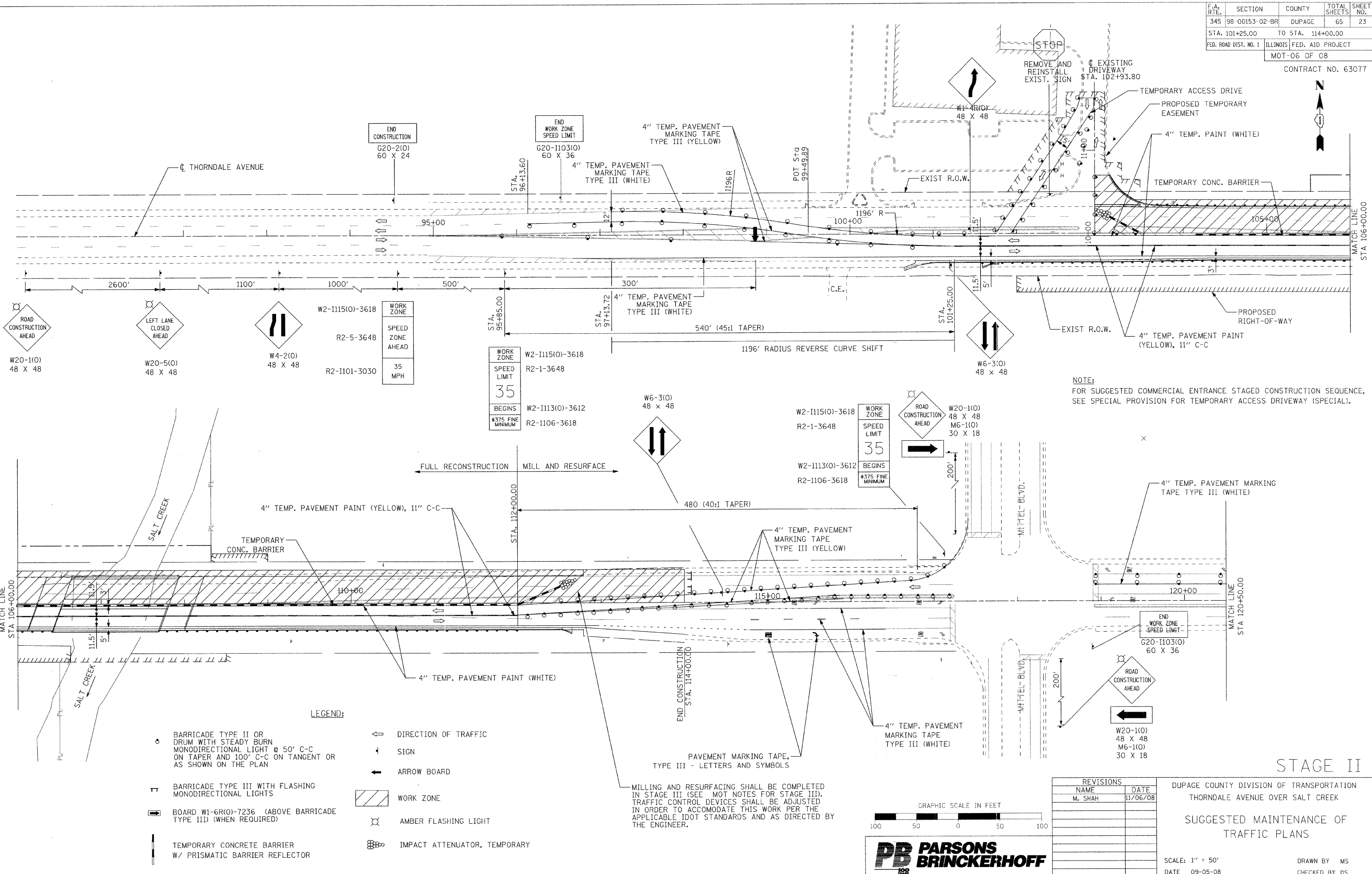

NOTE:  
FOR SUGGESTED COMMERCIAL ENTRANCE STAGED CONSTRUCTION SEQUENCE,  
SEE SPECIAL PROVISION FOR TEMPORARY ACCESS DRIVEWAY (SPECIAL).

- LEGEND:**
- BARRICADE TYPE II OR DRUM WITH STEADY BURN MONODIRECTIONAL LIGHT @ 50' C-C ON TAPER AND 100' C-C ON TANGENT OR AS SHOWN ON THE PLAN
  - ⇄ DIRECTION OF TRAFFIC
  - ⊕ SIGN
  - ⇆ ARROW BOARD
  - ▨ BARRICADE TYPE III WITH FLASHING MONODIRECTIONAL LIGHTS
  - ▨ WORK ZONE
  - ⊗ AMBER FLASHING LIGHT
  - ⇆ BOARD W1-6R(O)-7236 (ABOVE BARRICADE TYPE III) (WHEN REQUIRED)
  - ▨ TEMPORARY CONCRETE BARRIER W/ PRISMATIC BARRIER REFLECTOR
  - ⊗ IMPACT ATTENUATOR, TEMPORARY

MILLING AND RESURFACING SHALL BE COMPLETED IN STAGE III (SEE MOT NOTES FOR STAGE III). TRAFFIC CONTROL DEVICES SHALL BE ADJUSTED IN ORDER TO ACCOMMODATE THIS WORK PER THE APPLICABLE IDOT STANDARDS AND AS DIRECTED BY THE ENGINEER.

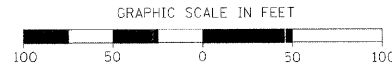

REVISIONS	
NAME	DATE
M. SHAH	11/06/08

DUPAGE COUNTY DIVISION OF TRANSPORTATION  
THORNDALE AVENUE OVER SALT CREEK

SUGGESTED MAINTENANCE OF TRAFFIC PLANS

SCALE: 1" = 50'  
DATE 09-05-08  
DRAWN BY MS  
CHECKED BY DS

PLOT DATE = 11/2/2008  
PLOT SCALE = AS SHOWN  
USER NAME = USER

\$\$\$GN\$\$  
\$\$\$PRF\$\$\$