

PLAN	DATE
REVISED	
NOTED	
NO.	

PROFILE	DATE
REVISED	
NOTED	
NO.	

FIELD ENGINEER: MARILIN SOLOMON (847) 705-4407

DOT
PLOT DATE = 7/22/2008
FILE NAME = 462222
PLOT SCALE = NONE
USER NAME = mander

FOR INDEX OF SHEETS, SEE SHEET 2

PROJECT LOCATED IN THE CITY OF WOODDALE

TRAFFIC DATA

ADT (2030) = 45,000
POSTED SPEED LIMIT = 45 MPH
DESIGN SPEED = 50 MPH

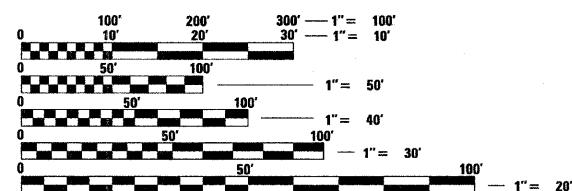

FULL SIZE PLANS HAVE BEEN PREPARED USING STANDARD ENGINEERING SCALES. REDUCED SIZED PLANS WILL NOT CONFORM TO STANDARD SCALES. IN MAKING MEASUREMENTS ON REDUCED PLANS, THE ABOVE SCALES MAY BE USED.

J.U.L.I.E.
JOINT UTILITY LOCATION INFORMATION FOR EXCAVATION
1-800-892-0123 OR 811

CONTRACT NO. 63077

STATE OF ILLINOIS DEPARTMENT OF TRANSPORTATION DIVISION OF HIGHWAYS PLANS FOR PROPOSED FEDERAL AID PROJECT

FAP ROUTE 345
THORNDALE AVENUE OVER SALT CREEK
PROJECT NO. BRF-0345(045)
STRUCTURE NO. 022-3011
SECTION 98-00153-02-BR
DUPAGE COUNTY
C-91-138-04

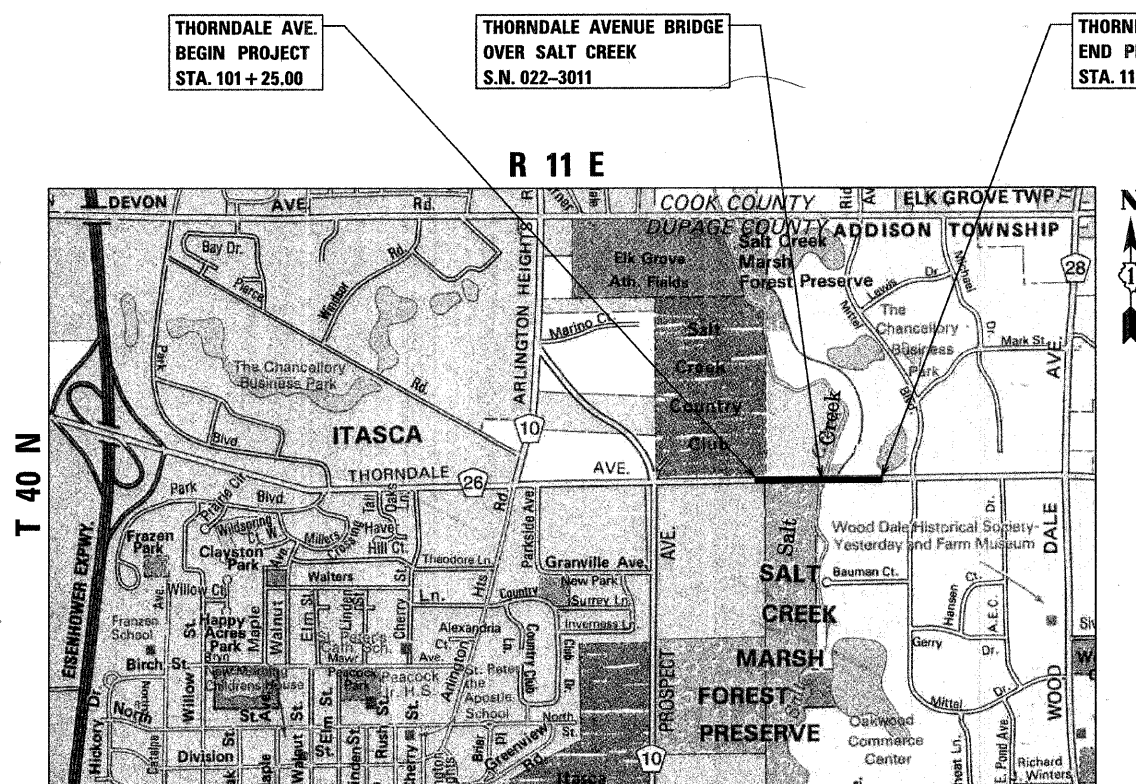

ADDISON TOWNSHIP

LOCATION MAP
NOT TO SCALE

GROSS LENGTH OF PROJECT = 1,275 FEET (0.24 MILES)
NET LENGTH OF PROJECT = 1,146.34 FEET (0.217 MILES)

F.A. RTE.	SECTION	COUNTY	TOTAL SHEETS	SHEET NO.
345	98-00153-02-BR	DUPAGE	65	1
STA. 101+25.00	TO STA. 114+00.00			
FED. ROAD DIST. NO. 1	ILLINOIS	FED. AID PROJECT		

CONTRACT NO. 63077



LOCATION OF SECTION INDICATED THIS: -



Jamal Grainawi
JAMAL GRAINAWI, S.E., P.E.
LICENSE NO.: 81-5161
EXPIRES: November 30, 2008
DATE: July 22, 2008

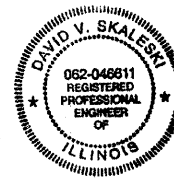

David Skaleski
DAVID V. SKALESKI, P.E.
LICENSE NO.: 062-046611
EXPIRES: November 30, 2009
DATE: July 22, 2008

STATE OF ILLINOIS
DEPARTMENT OF TRANSPORTATION
DIVISION OF HIGHWAYS
APPROVED July 23, 2008
Charles A. Popanski
DUPAGE COUNTY, COUNTY ENGINEER
PASSED SEPTEMBER 15, 2008
Christina Hart
DISTRICT 1 ENGINEER OF LOCAL ROADS & STREETS

RELEASING FOR BID
BASED ON LIMITED
REVIEW SEPTEMBER 15, 2008
Diana M. O'Kun
DEPUTY DIRECTOR OF HIGHWAYS, REGION 1 ENGINEER

PARSONS BRINCKERHOFF
230 WEST MONROE STREET, SUITE 900,
CHICAGO, ILLINOIS 60606
TEL: 312-782-8150 - FAX: 312-782-1684

FINAL (100%) SUBMITTAL