

40'± OFF EAST SIDE N.B. SHOULDER. ELEV. 633.62

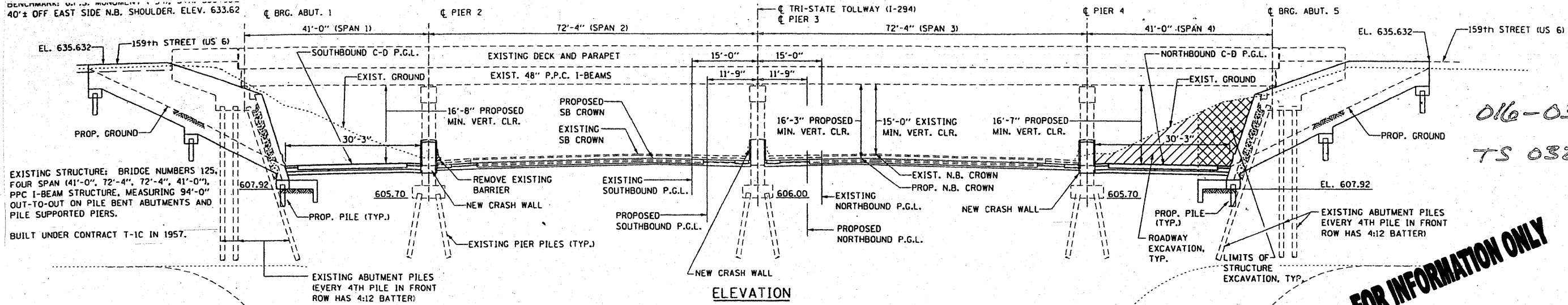

016-0383
TS 032

FOR INFORMATION ONLY

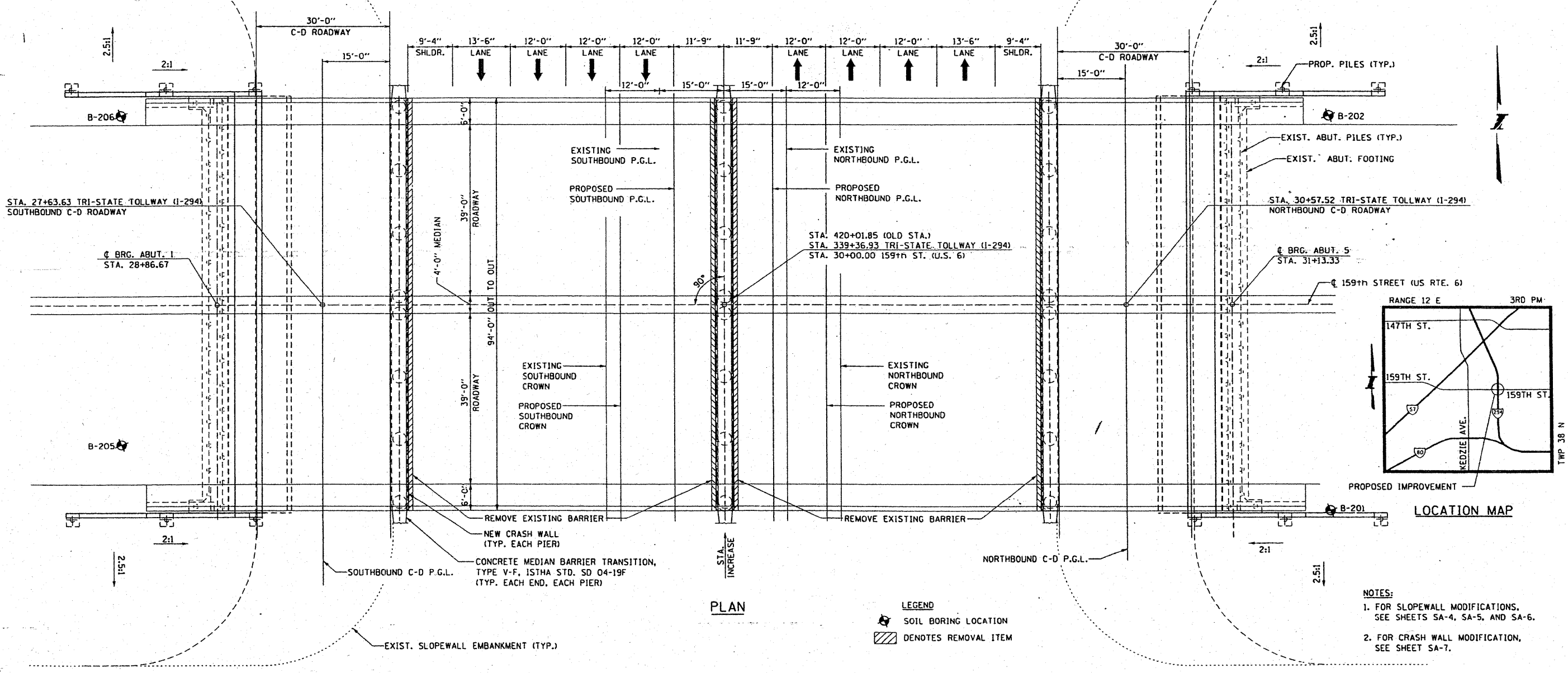

LEGEND
 SOIL BORING LOCATION
 DENOTES REMOVAL ITEM

NOTES:
 1. FOR SLOPEWALL MODIFICATIONS, SEE SHEETS SA-4, SA-5, AND SA-6.
 2. FOR CRASH WALL MODIFICATION, SEE SHEET SA-7.

FILE NAME =	USER NAME = drivakosgn	DESIGNED -	REVISED -	STATE OF ILLINOIS DEPARTMENT OF TRANSPORTATION	GENERAL PLAN AND ELEVATION OF EXISTING BRIDGE	F.A.P. RTE. *	SECTION	COUNTY	TOTAL SHEETS	SHEET NO.
cr:\projects\dl13109\design\eev.dgn		DRAWN -	REVISED -			2008-067 BR	COOK	10	4	
		CHECKED -	REVISED -			CONTRACT NO. 60F56				
		DATE -	REVISED -			FED. ROAD DIST. NO. [ILLINOIS] FED. AID PROJECT				