

Salem-Leckrone Airport

SALEM AIRPORT AUTHORITY
1100 AIRPORT RD.
SALEM, IL 62881

SUMMARY OF QUANTITIES				
ITEM NO.	DESCRIPTION	UNIT	TOTAL QUANTITY	AS-BUILT QUANTITY
AR150510	ENGINEER'S FIELD OFFICE	L.S.	1	
AR150520	MOBILIZATION	L.S.	1	
AR150540	HAUL ROUTE	L.S.	1	
AR152410	UNCLASSIFIED EXCAVATION	C.Y.	17	
AR152480	SHOULDER ADJUSTMENT	S.Y.	271	
AR156500	TEMPORARY EROSION CONTROL	L.S.	1	
AR156531	EROSION CONTROL BLANKET	S.Y.	271	
AR209510	CRUSHED AGGREGATE BASE COURSE	TON	417	
AR401911	REMOVE & REPLACE BIT. SURFACE	S.Y.	111	
AR501506	6" PCC PAVEMENT	S.Y.	1,770	
AR501530	PCC TEST BATCH	EACH	1	
AR501604	4" PCC SIDEWALK	S.F.	95	
AR501900	REMOVE PCC PAVEMENT	S.Y.	1,735	
AR510510	TIE DOWN	EACH	3	
AR620520	PAVEMENT MARKING-WATERBORNE	S.F.	16	
AR620525	PAVEMENT MARKING-BLACK BORDER	S.F.	32	
AR701900	REMOVE PIPE	L.F.	57	
AR705544	4" NON PERFORATED UNDERDRAIN	L.F.	66	
AR751411	INLET-TYPE A	EACH	1	
AR751900	REMOVE INLET	EACH	1	
AR901510	SEEDING	ACRE	0.06	

INDEX TO SHEETS	
SHEET NO.	SHEET TITLE
1	COVER SHEET
2	SUMMARY OF QUANTITIES AND INDEX TO SHEETS
3	SCOPE OF WORK
4	PROPOSED SAFETY PLAN
5	CONSTRUCTION SAFETY DETAILS AND NOTES
6	EXISTING CONDITIONS DEMOLITION PLAN
7	TYPICAL SECTIONS AND DRAINAGE DETAILS
8	PROPOSED CONSTRUCTION PLAN
9	PROPOSED JOINTING PLAN
10	PROPOSED JOINT DETAILS
11	PROPOSED MARKING PLAN



RECONSTRUCT
CONCRETE APRON,
PHASE 2

IDA No: SLO-4836

SBG Project No:
3-17-SBGP-156/162

Contract No. SA034

GENERAL NOTES:

QUANTITIES

PAYMENT WILL BE MADE UNDER THE ITEM NUMBERS, DESCRIPTIONS AND UNITS NOTED IN THE ABOVE TABLE IN ACCORDANCE WITH THE BASIS OF PAYMENT FOR EACH RESPECTIVE WORK ITEM COMPLETED AND ACCEPTED BY THE ENGINEER.

CERTIFIED PAYROLLS

THE RESIDENT ENGINEER/TECHNICIAN CANNOT FORWARD CONSTRUCTION REPORTS TO THE ILLINOIS DIVISION OF AERONAUTICS FOR PROCESSING UNTIL ALL CERTIFIED PAYROLLS FOR THE PERIOD HAVE BEEN RECEIVED.

MATERIAL CERTIFICATIONS

MATERIALS TO BE INCORPORATED INTO THE PROJECT CANNOT BE USED WITHOUT PRIOR APPROVAL. ALL MATERIALS TO BE USED IN THE PROJECT MUST BE SUBMITTED TO THE RESIDENT ENGINEER FOR APPROVAL. USE OF MATERIALS WITHOUT PRIOR APPROVAL AND ULTIMATELY DETERMINED TO BE UNACCEPTABLE BY THE ILLINOIS DIVISION OF AERONAUTICS ARE SUBJECT TO REMOVAL AND/OR NON-PAYMENT.

NO.	DATE	DESCRIPTION		
		DES	DWN	REV

ISSUE: NOVEMBER 13, 2020

PROJECT NO: 20A0053D

CAD FILE: G-002-FLP.DWG

DESIGN BY: JRH/JAR 11/03/2020

DRAWN BY: CWS 11/03/2020

REVIEWED BY: BSS 11/13/2020

SHEET TITLE

SUMMARY OF
QUANTITIES AND
INDEX TO SHEETS

GENERAL NOTES

1. THE SCOPE OF WORK SHEET IS INTENDED ONLY AS A GENERAL DESCRIPTION OF WORK ITEMS AND THEIR APPROXIMATE LOCATIONS AND LIMITS, FOR THE PURPOSE OF UNDERSTANDING THE SCOPE OF THE PROJECT. THIS SHEET SHALL NOT BE USED AS A CONSTRUCTION PLAN. REFER TO THE FOLLOWING PLAN SHEETS FOR DETAILED CONSTRUCTION REQUIREMENTS, LOCATIONS, AND ITEMS OF WORK.
2. WORK FOR THIS PROJECT CONSIST OF RECONSTRUCTION OF A PORTION OF THE MAIN PCC AIRCRAFT APRON, THIS PROJECT INCLUDES PAVEMENT REMOVAL, CONSTRUCTION OF NEW PCC PAVEMENT, BITUMINOUS PAVING, PAVEMENT MARKING AND ASSOCIATED ITEMS.
3. THE CONTRACTOR SHALL FURNISH ALL LABOR, MATERIAL, EQUIPMENT, AND TRANSPORTATION NECESSARY TO CONSTRUCT ALL ELEMENTS OF THE PROJECT AS DESCRIBED IN THE CONSTRUCTION PLANS AND SPECIFICATIONS.
4. THE RULES, REGULATIONS, AND SPECIFICATIONS ENUMERATED HEREIN SHALL BE CONSIDERED AS MINIMUM REQUIREMENTS. THEY SHALL NOT PROHIBIT THE CONTRACTOR FROM FURNISHING AND INSTALLING HIGHER GRADES OF MATERIAL THAN ARE SPECIFIED HEREIN.
5. THE CONTRACTOR IS NOT PERMITTED TO USE THE AIRPORT ENTRANCE DRIVE AND AUTO PARKING LOT ADJACENT TO THE ADMINISTRATION BUILDING FOR MATERIAL AND EQUIPMENT HAULING OR STORAGE.
6. IT SHALL BE THE RESPONSIBILITY OF THE CONTRACTOR TO PROTECT, PRESERVE AND REPAIR THE EXISTING AIRFIELD AND ROADWAY PAVEMENTS AT ALL TIMES. THE CONTRACTOR SHALL REPAIR ANY DAMAGE TO EXISTING ELECTRICAL, DRAINAGE, AND PAVEMENT STRUCTURES AT NO ADDITIONAL COST TO THE CONTRACT.
7. NO EQUIPMENT SHALL BE PERMITTED TO CROSS OR USE ANY EXISTING AIRPORT PAVEMENT OUTSIDE THE CONSTRUCTION LIMITS, GENERAL PROJECT AREA OR HAUL ROUTE.
8. CONTRACTOR IS REQUIRED TO PROVIDE THEIR OWN RESTROOM FACILITIES.
9. UNLESS OTHERWISE NOTED, ALL DISTURBED AREAS OUTSIDE OF THE PROPOSED CONSTRUCTION LIMITS SHALL BE GRADED, SEEDED AND/OR HYDROMULCH SEEDED IN ACCORDANCE WITH ITEM 901 AT NO ADDITIONAL COST TO THE CONTRACT.
10. ALL WASTE MATERIAL SHALL BE HAULED FROM THE AIRPORT AND PROPERLY DISPOSED OF UNLESS OTHERWISE SPECIFIED HEREIN.
11. THE CONTRACTOR SHALL BE RESPONSIBLE FOR OBTAINING PERMITS FOR HAULING ON PUBLIC ROADS, AS APPLICABLE. THE CONTRACTOR SHALL BE RESPONSIBLE FOR CORRECTING ANY DAMAGES TO ANY PAVEMENTS (PUBLIC OR PRIVATE) CAUSED BY HIS/HER CONSTRUCTION EQUIPMENT OR PERSONNEL.
12. THE OWNER SHALL HAVE THE RIGHT OF FIRST REFUSAL FOR ALL SALVAGEABLE MATERIAL REMOVED ON THE PROJECT.
13. THE CONTRACTOR SHALL COORDINATE WITH THE RESIDENT ENGINEER/TECHNICIAN SO THEY MAY DEVELOP ONE SET OF REDLINED AS-BUILT RECORD DRAWINGS AT THE COMPLETION OF THE PROJECT.
14. THE CONSTRUCTION LIMITS SHALL BE RESTRICTED TO AREAS THAT ARE ABSOLUTELY NECESSARY TO DISTURB TO COMPLETE THE REQUIRED WORK ITEMS. LIMITS SHALL BE COORDINATED WITH THE RESIDENT ENGINEER/TECHNICIAN PRIOR TO BEGINNING ANY WORK.
15. CONTRACTOR SHALL RESTORE TO ORIGINAL CONDITION ALL GRASS, STONE, OR PAVEMENT DISTURBED BY CONTRACTOR'S CONSTRUCTION OPERATIONS, STAGING, AND CONSTRUCTION ACCESS ROUTES. DISTURBED AREAS TO BE REPAIRED, GRADED, AND MULCHED SEEDED IN ACCORDANCE WITH ITEMS 901 AND 908, UNLESS OTHERWISE NOTED. STAGING AREA AND SITE ACCESS RESTORATION SHALL BE INCLUDED IN THE COST OF THE HAUL ROUTE.
16. THE PROJECT PAY ITEMS ARE INTENDED TO BE INCLUSIVE OF ALL WORK TO BE PERFORMED AS SHOWN IN THESE PLANS. ALL INCIDENTAL WORK REQUIRED TO COMPLETE THE PROJECT TO THE SATISFACTION OF THE RESIDENT ENGINEER/TECHNICIAN IS TO BE INCLUDED IN THE COSTS OF PERFORMING THESE ITEMS.
17. APPROXIMATE LOCATIONS OF UNDERGROUND UTILITIES ARE SHOWN THROUGHOUT THESE PLANS. THE CONTRACTOR SHALL DETERMINE EXACT LOCATIONS AND PROTECT THESE UTILITIES DURING CONSTRUCTION. ANY UTILITIES DAMAGED DURING CONSTRUCTION SHALL BE REPAIRED AT THE CONTRACTOR'S EXPENSE. CONTRACTOR SHALL COORDINATE WITH THE PROPER PERSONS FOR THE PURPOSE OF LOCATING AND PROTECTING EXISTING UNDERGROUND UTILITIES.
18. THE CONTRACTOR MUST AT ALL TIMES MAINTAIN PROPER DRAINAGE FOR ALL AREAS AFFECTED BY HIS WORK.
19. NO CONSTRUCTION EQUIPMENT GREATER THAN 25' TALL WILL BE PERMITTED ON THE PROJECT. HOWEVER OTHER EQUIPMENT TALLER THAN 25' MAY BE PERMITTED WITH THE APPROVAL OF THE AIRPORT MANAGER AND AIRSPACE APPROVAL BY THE FAA.

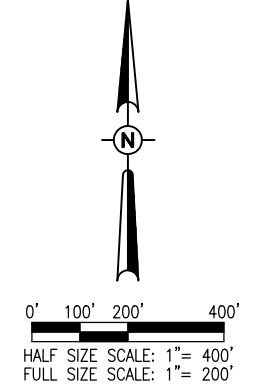
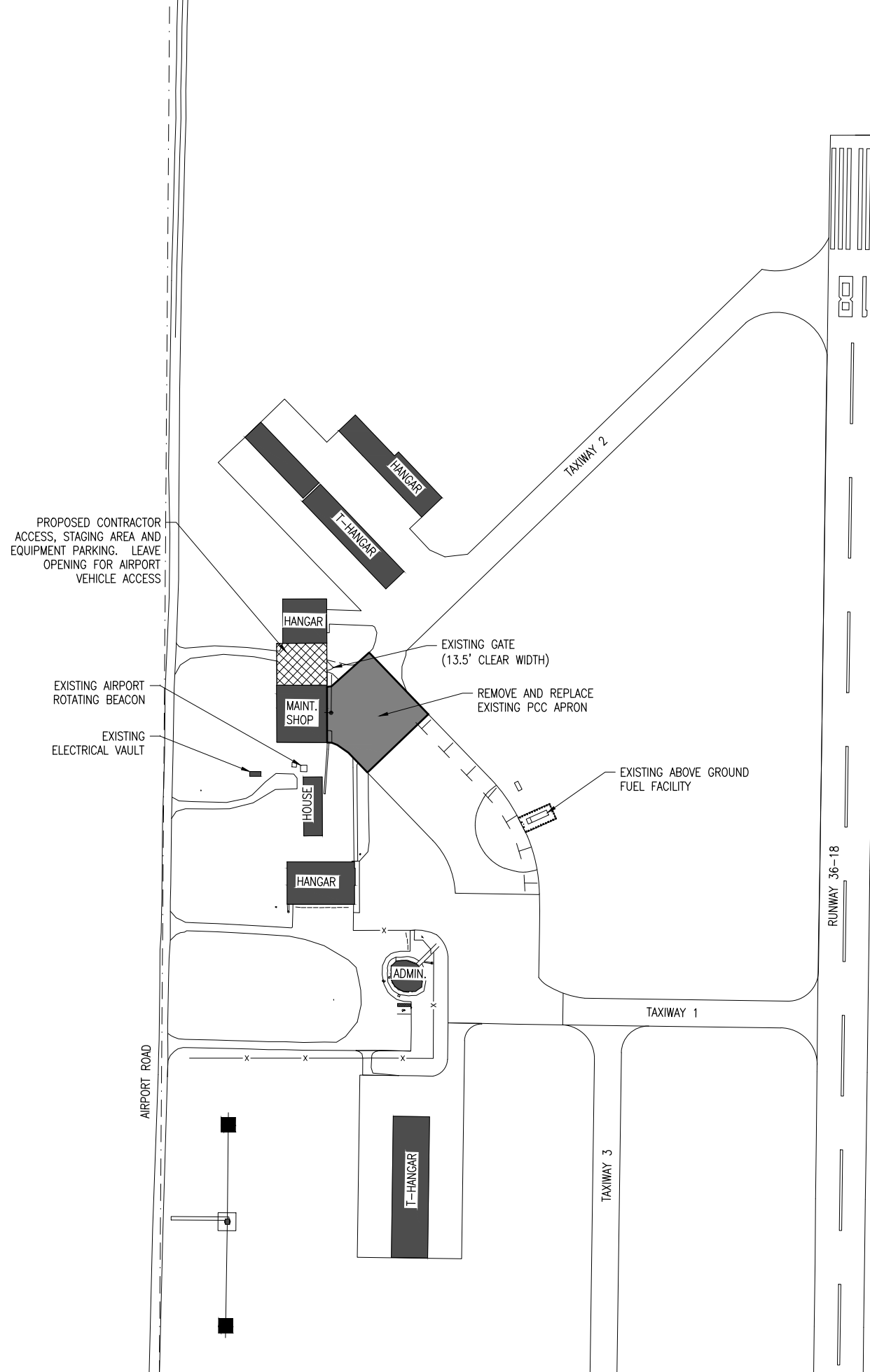

LEGEND

	EXISTING IMPROVEMENTS
	EXISTING BUILDINGS
	PROPOSED IMPROVEMENTS
	PROPOSED CONTRACTOR STAGING AREA
	EXISTING FENCE
	AIRPORT PROPERTY LINE



Offices Nationwide
www.hanson-inc.com

Hanson Professional Services Inc.
1525 S. 6th Street
Springfield, IL 62568
phone: 217-788-2450
fax: 217-788-2503

Illinois Licensed
Professional Service Corporation
#184-001084

Salem-Leckrone Airport

SALEM AIRPORT AUTHORITY
1100 AIRPORT RD.
SALEM, IL 62881



RECONSTRUCT CONCRETE APRON, PHASE 2

IDA No: SLO-4836
SBG Project No: 3-17-SBGP-156/162
Contract No. SA034

NO.	DATE	DESCRIPTION		
		DES	DWN	REV

ISSUE: NOVEMBER 13, 2020
PROJECT NO: 20A0053D
CAD FILE: G-003-SOW.DWG
DESIGN BY: JRH/JAR 11/03/2020
DRAWN BY: CWS 11/03/2020
REVIEWED BY: BSS 11/13/2020

SHEET TITLE

SCOPE OF WORK

NOV 12, 2020 3:35 PM HERNDD1562 1:20:08BS20A0053D\CAD\AIRPORT\1\SHEETC-003-SOW.DWG

UTILITY NOTE

THE LOCATION, SIZE, AND TYPE OF MATERIAL OF EXISTING UNDERGROUND AND/OR ABOVEGROUND UTILITIES INDICATED ON THE PLANS ARE NOT REPRESENTED AS BEING ACCURATE, SUFFICIENT OR COMPLETE. NEITHER THE OWNER NOR THE ENGINEER ASSUMES ANY RESPONSIBILITY WHATSOEVER IN RESPECT TO THE ACCURACY, COMPLETENESS, OR SUFFICIENCY OF THE INFORMATION. THERE IS NO GUARANTEE, EITHER EXPRESSED OR IMPLIED, THAT THE LOCATIONS, SIZE AND TYPE OF MATERIAL OF EXISTING UNDERGROUND UTILITIES INDICATED ARE REPRESENTATIVE OF THOSE TO BE ENCOUNTERED IN THE CONSTRUCTION. IT SHALL BE THE CONTRACTOR'S RESPONSIBILITY TO DETERMINE THE ACTUAL LOCATION OF ALL SUCH FACILITIES, INCLUDING SERVICE CONNECTIONS TO UNDERGROUND UTILITIES. PRIOR TO CONSTRUCTION, THE CONTRACTOR SHALL NOTIFY THE UTILITY COMPANIES OF HIS OPERATIONAL PLANS AND SHALL OBTAIN FROM THE RESPECTIVE UTILITY COMPANIES DETAILED INFORMATION AND ASSISTANCE RELATIVE TO THE LOCATION OF THEIR FACILITIES AND THE WORKING SCHEDULE OF THE COMPANIES FOR REMOVAL OR ADJUSTMENT WHERE REQUIRED. IN THE EVENT AN UNEXPECTED UTILITY INTERFERENCE IS ENCOUNTERED DURING CONSTRUCTION, THE CONTRACTOR SHALL IMMEDIATELY NOTIFY THE UTILITY COMPANY OF JURISDICTION. THE OWNER'S REPRESENTATIVE AND/OR THE RESIDENT ENGINEER SHALL ALSO BE IMMEDIATELY NOTIFIED. ANY DAMAGE TO SUCH MAINS AND SERVICES SHALL BE RESTORED TO SERVICE AT ONCE AND PAID FOR BY THE CONTRACTOR AT NO ADDITIONAL COST TO THE CONTRACT. ALL UTILITY CABLES AND LINES SHALL BE LOCATED BY THE RESPECTIVE UTILITY. CONTACT JULIE (JOINT UTILITY LOCATION INFORMATION FOR EXCAVATORS) FOR UTILITY INFORMATION, PHONE: 1-800-892-0123. CONTACT THE FAA (FEDERAL AVIATION ADMINISTRATION) FOR ASSISTANCE IN LOCATING FAA CABLES AND UTILITIES. LOCATION OF FAA POWER, CONTROL, AND COMMUNICATION CABLES SHALL BE COORDINATED WITH AND/OR LOCATED BY THE FAA. ALSO CONTACT AIRPORT DIRECTOR/MANAGER AND AIRPORT PERSONNEL FOR ASSISTANCE IN LOCATING UNDERGROUND AIRPORT CABLES AND/OR UTILITIES. ALSO COORDINATE WORK WITH ALL ABOVEGROUND UTILITIES.

J.U.L.I.E. INFORMATION

COUNTY _____ MARION
 CITY _____ SALEM
 TOWNSHIP _____ SALEM
 SECTION NO. _____ T.2N. - R.2E.
 ADDRESS _____ SALEM-LECKRONE AIRPORT
 1100 AIRPORT ROAD
 SALEM, IL 62881

CRITICAL POINT DATA					
DESCRIPTION	LATITUDE	LONGITUDE	GROUND ELEV.	EQUIP. HEIGHT	EQUIP. ELEV.
CRITICAL POINT 1	N038°38'47.06"	W088°58'00.79"	569.0'	25'	594.0'
CRITICAL POINT 2	N038°38'46.92"	W088°57'59.99"	568.0'	25'	593.0'
CRITICAL POINT 3	N038°38'46.02"	W088°57'58.88"	569.0'	25'	594.0'
CRITICAL POINT 4	N038°38'45.16"	W088°58'00.01"	568.0'	25'	593.0'

SAFETY PLAN COMPLIANCE DOCUMENT

PRIOR TO THE ISSUANCE OF A CONSTRUCTION NOTICE-TO-PROCEED (NTP), THE CONTRACTOR SHALL BE RESPONSIBLE FOR PREPARING AND SUBMITTING A SAFETY PLAN COMPLIANCE DOCUMENT IN ACCORDANCE WITH FAA ADVISORY CIRCULAR 150/5370-2G, PARAGRAPH 2.4.2, OR EQUIVALENT SECTION IN SUBSEQUENT/CURRENT ISSUE. THE AIRPORT MANAGER SHALL APPROVE THIS DOCUMENT AND SUBMIT TO THE DIVISION OF AERONAUTICS FOR APPROVAL PRIOR TO THE NTP ISSUANCE.

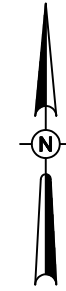

0' 30' 60' 120'
 HALF SIZE SCALE: 1" = 120'
 FULL SIZE SCALE: 1" = 60'

LEGEND

- EXISTING IMPROVEMENTS
- EXISTING BUILDINGS
- PROPOSED IMPROVEMENTS
- PROPOSED CONTRACTOR STAGING AREA
- EXISTING FENCE
- PROPOSED HAUL ROUTE
- PROPOSED BARRICADES
- CONSTRUCTION SIGN



Offices Nationwide
 www.hanson-inc.com

Hanson Professional Services Inc.
 1525 S. 6th Street
 Springfield, IL 62568
 phone: 217-788-2450
 fax: 217-788-2503

Illinois Licensed
 Professional Service Corporation
 #184-001084

Salem-Leckrone Airport

SALEM AIRPORT AUTHORITY
 1100 AIRPORT RD.
 SALEM, IL 62881



SAFETY PLAN NOTES

- BARRICADES SHALL BE IN PLACE PRIOR TO BEGINNING CONSTRUCTION.
- FOLLOWING THE FINAL CONCRETE POUR, IF NO WORK ITEMS ARE IN PROGRESS DURING THE CONCRETE CURING PERIOD, THE CONTRACT TIME WILL BE TEMPORARILY STOPPED UNTIL THE CONCRETE REACHES SPECIFIED STRENGTH AND WORK RESUMES.
- THE ABOVE GROUND FUEL FACILITY SHALL REMAIN ACCESSIBLE AT ALL TIMES DURING CONSTRUCTION.
- FLAGPERSONS AND/OR ESCORTS MAY BE NECESSARY TO ENSURE PROPER CONTROL OF CONSTRUCTION VEHICLE TRAFFIC ACROSS ACTIVE AIRFIELD PAVEMENTS. PAVEMENTS ARE TO BE KEPT FREE OF DEBRIS AT ALL TIMES. COSTS TO MAINTAIN ACTIVE/CLEAN PAVEMENTS SHALL BE INCLUDED IN ITEM AR150540 HAUL ROUTE.
- AT ALL TIMES, THE CONTRACTOR'S OPERATIONS SHALL BE SUCH AS TO MINIMIZE DISRUPTION TO AIRCRAFT OPERATIONS.
- PRIOR TO CONSTRUCTION, THE RESIDENT ENGINEER/TECHNICIAN AND CONTRACTOR SHALL ASSESS THE EXISTING CONDITIONS OF THE CONSTRUCTION EQUIPMENT PARKING AREA AND AIRPORT ROAD BY MEANS OF VISUAL INSPECTION AND DOCUMENT THE CONDITIONS WITH VIDEO/PHOTOGRAPHS. AT THE COMPLETION OF ALL WORK AREA CONSTRUCTION, THE HAUL ROUTE AND CONSTRUCTION EQUIPMENT PARKING AREA SHALL BE RESTORED TO PRE-CONSTRUCTION CONDITIONS PER THE SPECIFICATIONS.
- THE COSTS FOR PROVISION, PLACEMENT, MAINTENANCE AND REMOVAL OF BARRICADES ON THE AIRFIELD AND ALL ASSOCIATED INCIDENTALS SHALL BE PAID FOR UNDER ITEM AR150520 MOBILIZATION.
- THE COSTS FOR CONSTRUCTION/MAINTENANCE/RESTORATION OF HAUL ROUTE AND EQUIPMENT STAGING AREA, TEMPORARY SIGNAGE AND ALL ASSOCIATED INCIDENTALS SHALL BE PAID FOR UNDER ITEM AR150540 HAUL ROUTE.

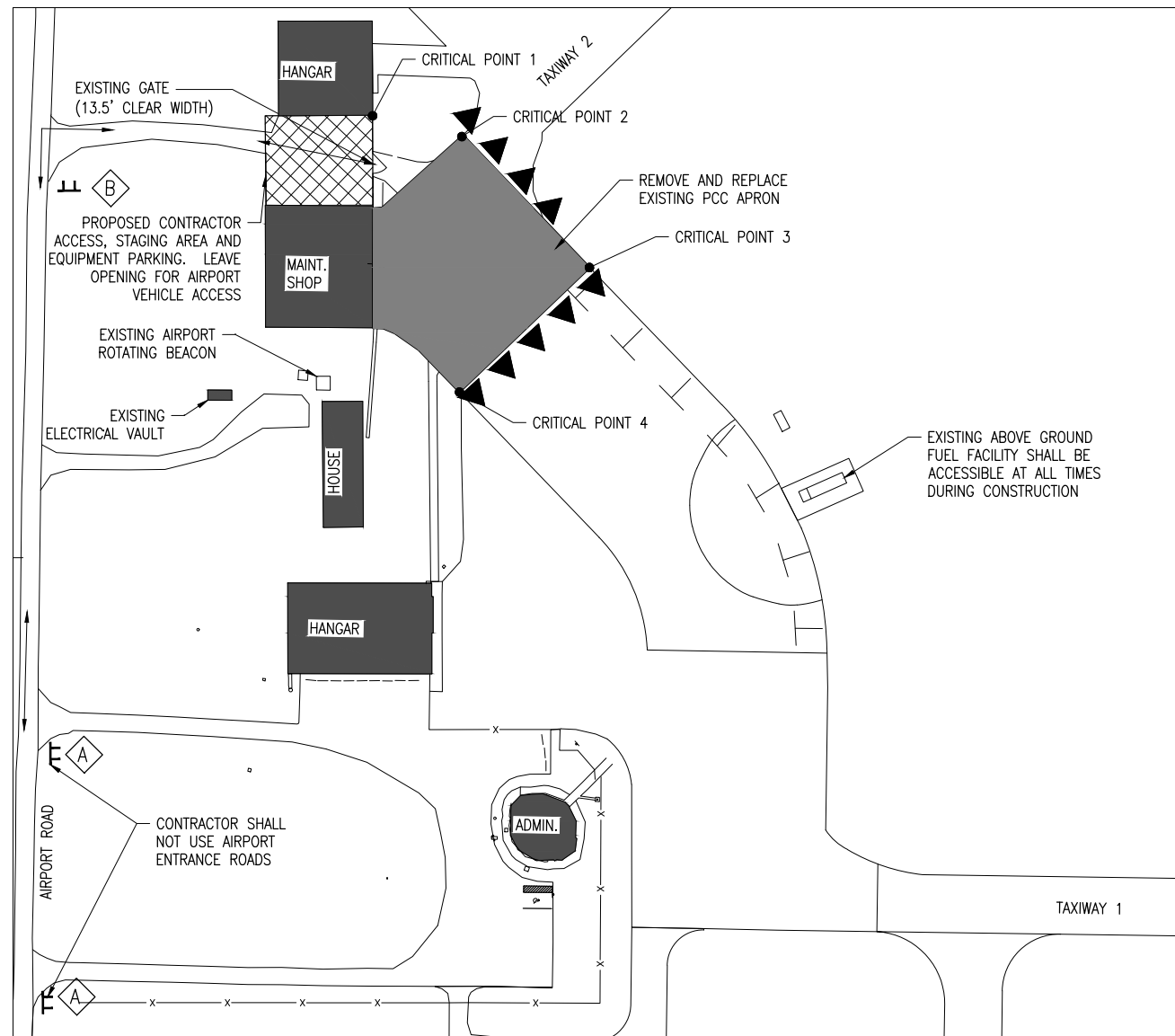

NOV 12, 2020 3:35 PM HERND01562 1:20:08BS20A0053DCAD:SALEM-AIRPORT-TT-SHEET-C-004-SFY.DWG

RECONSTRUCT CONCRETE APRON, PHASE 2

IDA No: SLO-4836
 SBG Project No:
 3-17-SBGP-156/162
 Contract No. SA034

NO.	DATE	DESCRIPTION		
		DES	DWN	REV

ISSUE: NOVEMBER 13, 2020
 PROJECT NO: 20A0053D
 CAD FILE: C-004-SFY.DWG
 DESIGN BY: JRH/JAR 11/03/2020
 DRAWN BY: CWS 11/03/2020
 REVIEWED BY: BSS 11/13/2020

SHEET TITLE

PROPOSED SAFETY PLAN

Salem-Leckrone Airport

SALEM AIRPORT AUTHORITY
1100 AIRPORT RD.
SALEM, IL 62881



**RECONSTRUCT
CONCRETE APRON,
PHASE 2**

IDA No: SLO-4836
SBG Project No:
3-17-SBGP-156/162
Contract No. SA034

NO.	DATE	DESCRIPTION		
		DES	DWN	REV

ISSUE: NOVEMBER 13, 2020
PROJECT NO: 20A0053D
CAD FILE: C-501-SFY.DWG
DESIGN BY: JRH/JAR 11/03/2020
DRAWN BY: CWS 11/03/2020
REVIEWED BY: BSS 11/13/2020

SHEET TITLE

**CONSTRUCTION
SAFETY DETAILS
AND NOTES**

SAFETY NOTES

- FOLLOWING ARE THE CONSTRUCTION SAFETY PROCEDURES THAT THE CONTRACTOR SHALL FOLLOW THROUGHOUT THIS PROJECT. ADDITIONAL REQUIREMENTS ARE SHOWN ON THE SAFETY AND PHASING NOTES AND DETAILS SHEET.
- ALL PROVISIONS OF THE LATEST EDITION OF FAA ADVISORY CIRCULAR AC 150/5370-2 (CURRENT EDITION), "OPERATIONAL SAFETY ON AIRPORTS DURING CONSTRUCTION", APPLY TO THIS CONTRACT, EXCEPT AS MODIFIED BY THIS SAFETY PLAN, OR AS MODIFIED BY THE OWNER THROUGH THE RESIDENT ENGINEER AT THE PRECONSTRUCTION CONFERENCE, OR DURING THE COURSE OF THE CONTRACT.
- THE CONTRACTORS SHALL MINIMIZE DISRUPTION OF STANDARD OPERATING PROCEDURES FOR AERONAUTICAL ACTIVITY BY REMAINING WITHIN THE PRESCRIBED STAGING, CONSTRUCTION, AND PHASING AREAS PRESENTED ON THE PROJECT SAFETY AND PHASING PLANS.
- NO UNAUTHORIZED PERSONNEL SHALL ENTER ANY AREA OF THE AIRPORT THAT COULD POTENTIALLY BE HAZARDOUS. THE AIRPORT MANAGER RESERVES THE RIGHT TO SUSPEND OPERATIONS IN ORDER TO MAINTAIN SAFETY AT THE AIRPORT.
- CONTRACTOR EQUIPMENT, VEHICLES, AND PROJECT MATERIALS SHALL BE STORED AT THE STAGING AREA SHOWN ON THE PLAN VIEW, EXCEPT AS OTHERWISE PROVIDED FOR AT THE PRECONSTRUCTION CONFERENCE.
- ALL CONSTRUCTION EQUIPMENT OPERATING IN THE PRESCRIBED CONSTRUCTION AREA IS REQUIRED TO DISPLAY A CHECKERBOARD FLAG PROPERLY LOCATED OR A ROTATING BEACON (STROBE) AS SPECIFIED IN AC 150/5210-5, "PAINTING, MARKING, AND LIGHTING OF VEHICLES USED ON AN AIRPORT" LATEST EDITION.
- NO CONSTRUCTION MATERIAL STOCKPILES SHALL BE LOCATED WITHIN 250' OF ANY ACTIVE RUNWAY, WITHIN 66' OF ANY OTHER ACTIVE AIRPORT OPERATIONS AREA, OR PENETRATE A PART 77 IMAGINARY SURFACE (PROVIDED BY THE RESIDENT ENGINEER) EXTENDING OUT AND UPWARDS FROM ALL SIDES OF AN ACTIVE RUNWAY.
- NO OPEN TRENCHES WITHIN 250' OF AN ACTIVE RUNWAY CENTERLINE OR WITHIN 66' OF ANY AIRPORT OPERATIONS AREA WILL BE PERMITTED UNLESS PROPERLY MARKED. OTHER TRENCHES SHALL BE MAINTAINED SAFE, I.E., BARRICADED OR COVERED WITH STEEL PLATES IN ALL OTHER AREAS.
- OPEN TRENCHES, EXCAVATIONS, AND STOCKPILED MATERIALS AT THE CONSTRUCTION SITE SHOULD BE PROMINENTLY MARKED WITH ORANGE FLAGS AND LIGHTED WITH FLASHING YELLOW LIGHTS DURING HOURS OF RESTRICTED VISIBILITY AND/OR DARKNESS.
- THE MAXIMUM ANTICIPATED HEIGHT OF THE CONSTRUCTION EQUIPMENT WILL BE 25 FEET, WHICH IS EXPECTED TO BE A CONCRETE TRUCK, DUMP TRUCK, OR BACKHOE.
- NO OPEN FLAME WELDING OR TORCH CUTTING OPERATION IS PERMITTED UNLESS ADEQUATE FIRE AND SAFETY PRECAUTIONS ARE PROVIDED AND HAVE BEEN APPROVED BY THE AIRPORT MANAGER NO FLARE POTS ARE ALLOWED ON THE PROJECT.
- SOIL, DEBRIS, AND LOOSE MATERIAL DROPPED OR TRUCKED ONTO AIRPORT ROADS, TAXIWAYS, AND SOD SURFACES, OR WHICH CAN BE BLOWN ONTO SUCH SURFACES, SHALL BE IMMEDIATELY SWEEP, PICKED UP AND REMOVED, OR PLACED INTO CLOSED CONTAINERS. ANY DAMAGE TO AIRPORT PROPERTY SHALL BE REPAIRED IMMEDIATELY AT NO COST TO THE OWNER.
- EACH CONTRACTOR SHALL BE RESPONSIBLE FOR LOCATING AND MAINTAINING AIRPORT LIGHTING AND NAVIGATIONAL ELECTRICAL SYSTEMS DURING CONSTRUCTION. A CONTACT PERSON AND TELEPHONE NUMBER FOR 24 HOUR EMERGENCY IMMEDIATE REPAIR SHALL BE SUBMITTED TO THE AIRPORT MANAGER AND RESIDENT ENGINEER. HAUL ROUTES CROSSING PAVEMENT, DRAINAGE, MISCELLANEOUS. STRUCTURES AND/OR AIRFIELD CABLES SHALL BE PROTECTED FROM DAMAGE.
- ALL AIRCRAFT AND AIRPORT OPERATIONS HAVE THE RIGHT-OF-WAY. CONTRACTOR TO YIELD TO VEHICLES AND REMAIN CLEAR AT ALL TIMES.
- CONTRACTOR SHALL PLACE, SECURE, AND MAINTAIN LIGHTED BARRICADES AND CLOSURE CROSSES WHEN A RUNWAY/TAXIWAY/APRON IS CLOSED OR AS REQUIRED BY THE PLANS AND DESIGNATED BY THE RESIDENT ENGINEER/TECHNICIAN.
- CONTRACTOR SHALL MARK HAZARDOUS AREA WITH STEADY-BURNING OR FLASHING RED LIGHTS DURING PERIODS OF LOW VISIBILITY AS REQUIRED.
- THE CONTRACTOR SHALL PERIODICALLY PERFORM ONSITE INSPECTIONS THROUGHOUT THE DURATION OF THE PROJECT WITH THE IMMEDIATE REMEDY OF ANY DIFFERENCES, WHETHER CAUSED BY NEGLIGENCE, OVERSIGHT, OR PROJECT SCOPE CHANGE.
- CONTRACTOR SHALL MOVE MAINTENANCE OF TRAFFIC COMPONENTS AT THE WRITTEN DIRECTION OF THE RESIDENT ENGINEER/TECHNICIAN AT NO ADDITIONAL COST.
- CONTRACTOR SHALL NOT REMOVE THE BARRICADES WITHOUT THE APPROVAL BY THE RESIDENT ENGINEER/TECHNICIAN.
- CONTRACTOR SHALL MAINTAIN FLASHERS, SIGNS AND/OR BARRICADES AS REQUIRED BY THE PLANS, CITY OR COUNTY REGULATIONS OR CONTRACTOR ACTIVITIES. CONTRACTOR SHALL OBTAIN ANY AND ALL REQUIRED LOCAL PERMITS UNLESS SPECIFIED OTHERWISE.
- THE CONTRACTOR SHALL UTILIZE WATER AND/OR CHEMICALS APPROVED BY THE RESIDENT ENGINEER AS NECESSARY TO CONTROL DUST.
- NO CONSTRUCTION VEHICLES SHALL BE DRIVEN ACROSS ANY ACTIVE RUNWAY, INCLUDING TURF RUNWAYS. CONSTRUCTION EQUIPMENT OR CONSTRUCTION ACTIVITY WILL NOT BE PERMITTED WITHIN 250' OF ANY ACTIVE RUNWAY CENTERLINE OR WITHIN 66' OF ANY OTHER ACTIVE AIRPORT TAXIWAY OR APRON. HOWEVER, CONSTRUCTION MAY BE PERMITTED IN THESE AREAS IF THE CONTRACTOR HAS GAINED APPROVAL FROM THE AIRPORT MANAGER AT LEAST 7 DAYS IN ADVANCE OF THE SCHEDULED CONSTRUCTION PERIOD AND THE OPERATIONAL AREA IS CLOSED TO TRAFFIC AND PROPER NOTAMS ARE ISSUED BY THE AIRPORT MANAGER TO THE APPROPRIATE FLIGHT SERVICE STATION.
- UNLESS SPECIFIED OTHERWISE, COST FOR THE ABOVE IS TO BE CONSIDERED INCIDENTAL TO THE PROJECT. SEPARATE PAYMENT SHALL NOT BE MADE.

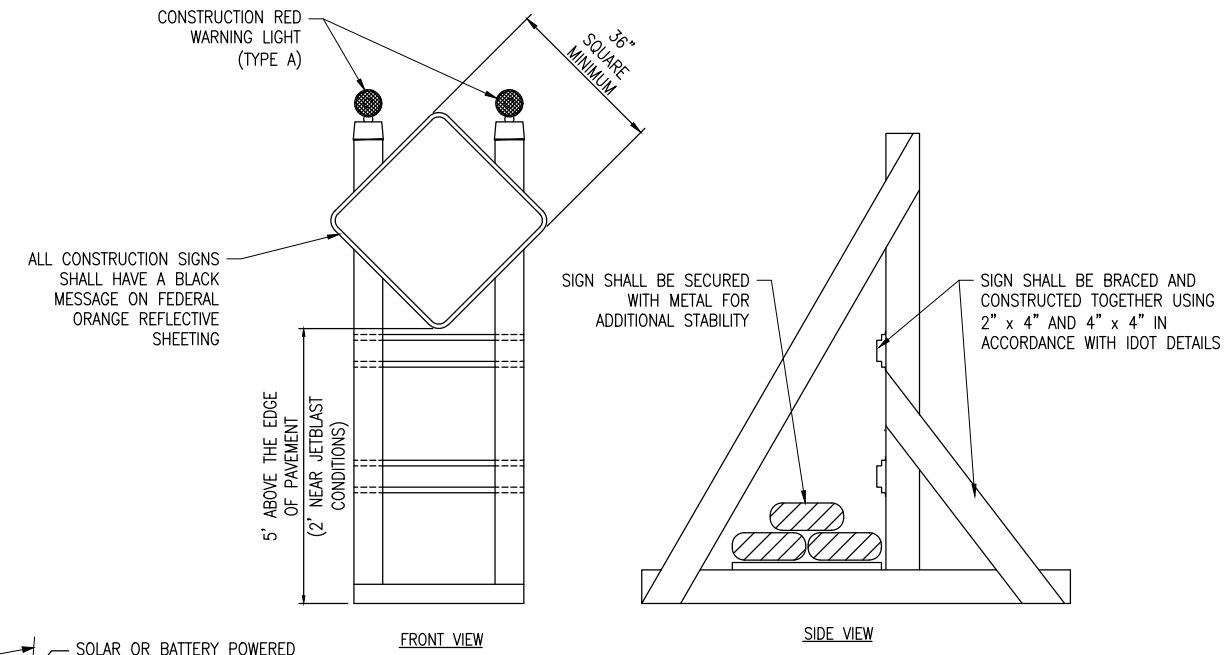

SIGNAGE NOTES

- ALL CONSTRUCTION SIGNS AND TRAFFIC CONTROL DEVICES SHALL CONFORM TO THE MANUAL ON UNIFORM TRAFFIC CONTROL DEVICES INCLUDING THE ILLINOIS SUPPLEMENT (LATEST EDITION) AND THE FAA ADVISORY CIRCULARS (LATEST EDITION) UNLESS NOTED OTHERWISE. THE FAA OR MORE STRINGENT SPECIFICATIONS SHALL GOVERN.
- UNLESS OTHERWISE SPECIFIED, CONSTRUCTION SIGNS SHALL BE MOUNTED ON PORTABLE OR NON-PORTABLE SUPPORTS. A PORTABLE SUPPORT IS DEFINED AS A TYPICAL SIGN STANDARD AS SHOWN ON THIS SHEET, OR A SMALL LIGHT WEIGHT TRAILER. A NON-PORTABLE SUPPORT IS DEFINED AS DRIVEN METAL OR WOOD POST. ALL SIGNS, REGARDLESS OF THE TYPE OF SUPPORTS USED, SHALL BE MOUNTED SUCH THAT THE MESSAGE ON THE SIGN IS LEVEL IN THE HORIZONTAL PLANE AFTER PLACEMENT. THE COST OF CONSTRUCTION WARNING LIGHTS SHALL BE INCLUDED IN THE COST OF THE CONSTRUCTION SIGNS.
- CONSTRUCTION RED WARNING LIGHT: THESE ARE PORTABLE, LENS DIRECTED, ENCLOSED LIGHTS. THE COLOR OF THE LIGHT EMITTED SHALL BE RED. THEY ARE TO BE USED IN A LOW INTENSITY FLASHING MODE (TYPE A).
- THE LIGHTING SHALL BE MAINTAINED IN OPERATION DURING THE HOURS OF DARKNESS BETWEEN 1/2 HOUR AFTER SUNSET AND 1/2 HOUR BEFORE SUNRISE AND WHEN CONDITIONS EXIST WHICH TEND TO OBSCURE VISION.
- COST FOR PROVIDING, PLACING, MAINTAINING, AND REMOVING SIGNS SHALL BE INCLUDED IN ITEM AR150540 HAUL ROUTE.

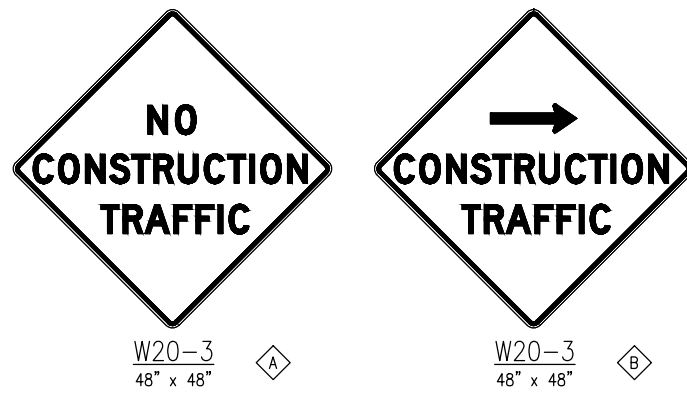

CONSTRUCTION SIGNS
NOT TO SCALE

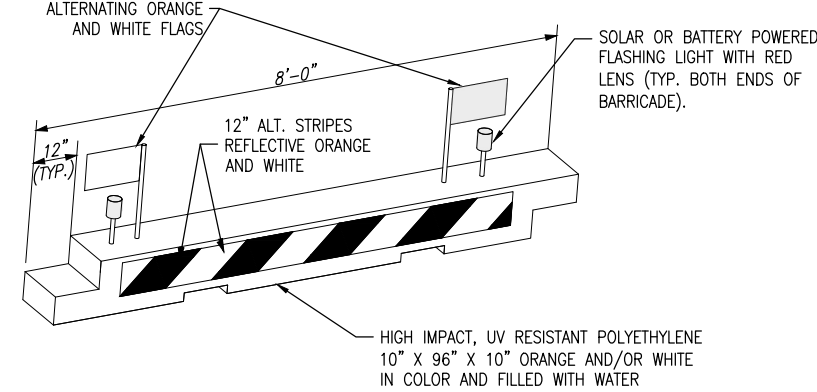

LOW PROFILE BARRICADE DETAIL
NOT TO SCALE

BARRICADE NOTES

- CLOSED AIRFIELD PHASING AREAS, OPEN TRENCHES, AND STOCKPILED MATERIALS AT THE CONSTRUCTION SITE SHALL BE PROMINENTLY MARKED WITH LIGHTED BARRICADES WITH STEADY BURNING OR FLASHING RED LIGHTS AS SPECIFIED IN 150/5370-2, "OPERATIONAL SAFETY ON AIRPORT DURING CONSTRUCTION, LATEST EDITION. LIGHTED BARRICADES MUST BE NO TALLER THAN 18" (EXCLUSIVE OF SUPPLEMENTARY LIGHTS AND FLAGS) ON THE TAXIWAYS AND COMPLY WITH ADVISORY CIRCULAR 150/5370-2, LATEST EDITION. CONTRACTOR SHALL NIGHT CHECK BARRICADES DAILY FOR PROPER OPERATION.
- BARRICADES SHALL BE SPACED END TO END THE WIDTH OF THE PAVEMENT IN 4' INCREMENTS. BARRICADES ARE TO BE SET BACK 66' FROM THE ACTIVE TAXIWAY CENTERLINE OR AS SHOWN ON THE PLANS.
- CONSTRUCTION RED WARNING LIGHT: THESE ARE PORTABLE, LENS DIRECTED, ENCLOSED LIGHTS. THE COLOR OF THE LIGHT EMITTED SHALL BE RED. THEY MAY BE USED IN EITHER A STEADY BURN (TYPE C) OR LOW INTENSITY FLASHING MODE (TYPE A) UNLESS NOTED OTHERWISE.
- THE LIGHTING SHALL BE MAINTAINED IN OPERATION DURING THE HOURS OF DARKNESS BETWEEN 1/2 HOUR BEFORE SUNSET AND 1/2 HOUR AFTER SUNRISE AND WHEN CONDITIONS EXIST WHICH TEND TO OBSCURE VISION.
- BARRICADES SHALL BE SECURED TO THE GROUND BY APPROVED METHODS TO PREVENT MOVEMENT BY PROP WASH, JET BLAST OR OTHER WIND CURRENTS.
- THE ONLY COLOR COMBINATION ON BARRICADES IS ORANGE AND WHITE. THE ORANGE STRIPES SHALL BE ENCAPSULATED LENS REFLECTIVE SHEETING. THE WHITE STRIPES SHALL BE EITHER ENCAPSULATED OR ENCLOSED LENS REFLECTIVE SHEETING AND MUST BE IN ACCEPTABLE CONDITION.
- COST FOR PROVIDING, PLACING, MAINTAINING, AND REMOVING BARRICADES SHALL BE INCLUDED IN ITEM AR150520 MOBILIZATION.

NOV 12, 2020 3:36 PM HEERND01562
I:\20\JOBS\20A0053D\CAD\AIRPORT\SHHEET\C-501-SFY.DWG

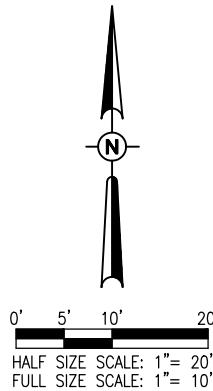

LEGEND

	EXISTING IMPROVEMENTS
	EXISTING BUILDINGS
	PROPOSED PAVEMENT REMOVAL
	PROPOSED IMPROVEMENTS
	EXISTING FENCE
	PROPOSED SAWCUT

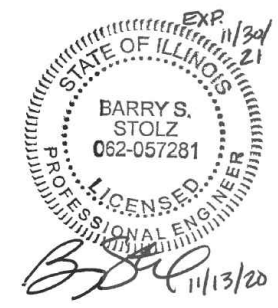

**RECONSTRUCT
CONCRETE APRON,
PHASE 2**

IDA No: SLO-4836
SBG Project No:
3-17-SBGP-156/162
Contract No. SA034

NO.	DATE	DESCRIPTION		
		DES	DWN	REV

ISSUE: NOVEMBER 13, 2020

PROJECT NO: 20A0053D
CAD FILE: C-131-EXST.DWG
DESIGN BY: JRH/JAR 11/03/2020
DRAWN BY: CWS 11/03/2020
REVIEWED BY: BSS 11/13/2020

SHEET TITLE

**EXISTING
CONDITIONS
DEMOLITION PLAN**

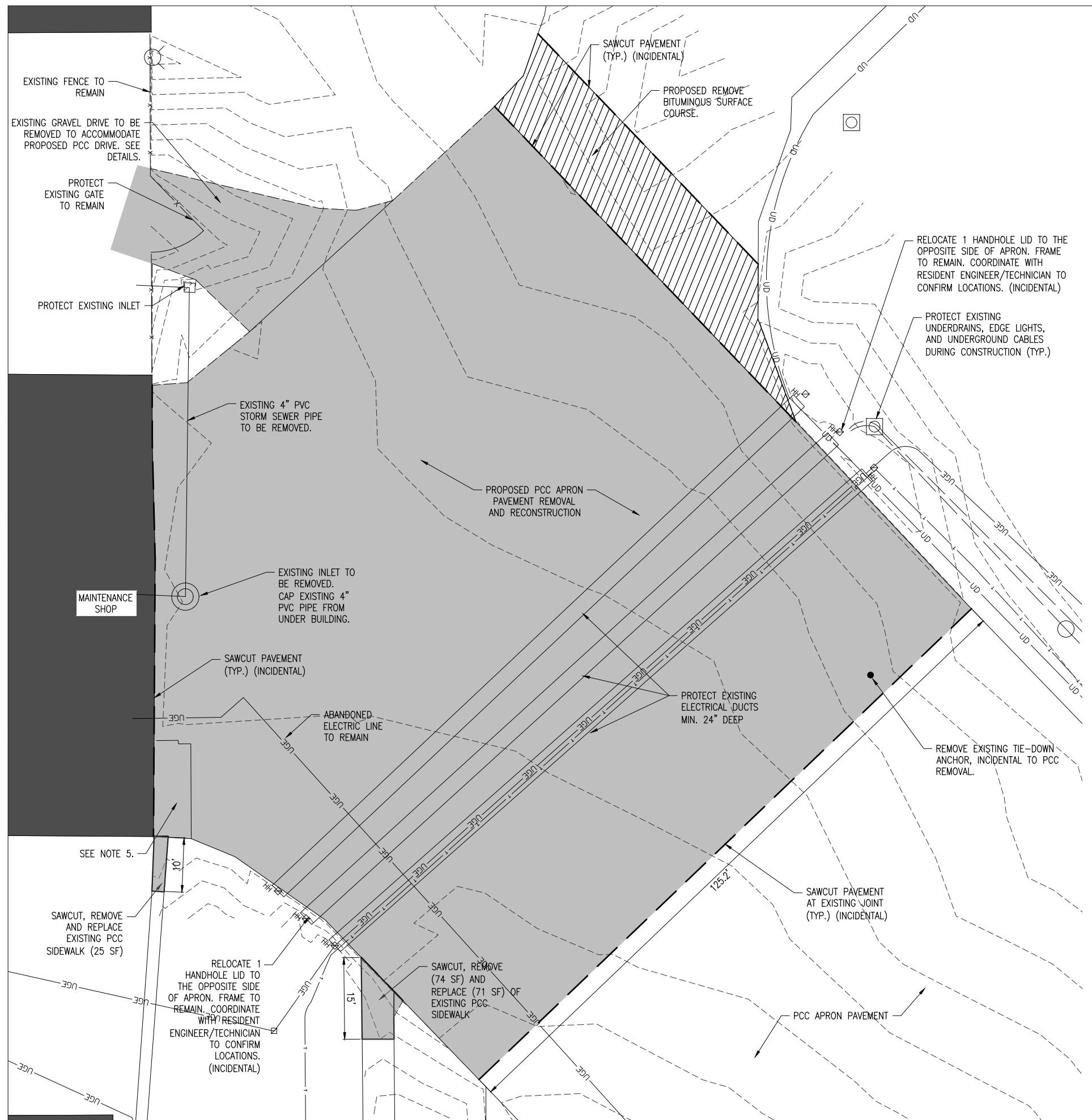

NOTES

1. DURING THE PCC PAVEMENT RECONSTRUCTION, THE CONTRACTOR SHALL REMOVE TO A SUFFICIENT DEPTH IN ORDER TO ACCOMMODATE THE CONSTRUCTION OF THE PROPOSED PCC PAVEMENT TO PROPOSED GRADES. IF FOR ANY REASON THE CONTRACTOR REMOVES A GREATER DEPTH, NO ADDITIONAL COMPENSATION WILL BE ALLOWED FOR EXTRA MATERIAL.
2. EXISTING TIE-DOWN ANCHOR IS TO BE REMOVED AND PROPERLY DISPOSED OF AS INCIDENTAL TO THE EXISTING PCC PAVEMENT REMOVAL.
3. THE CONTRACTOR SHALL PROTECT EXISTING PAVEMENT, HANGARS AND BUILDINGS AT ALL TIMES DURING CONSTRUCTION.
4. EXISTING PCC PAVEMENT SECTION IS APPROX. 9.5" PCC ON 5" CRUSHED AGGREGATE.
5. CANOPY SUPPORT LEGS (2) TO BE REMOVED TEMPORARILY AND BOLTED TO NEW PAVEMENT. PROTECT EXISTING CANOPY OR TEMPORARILY REMOVE DURING CONSTRUCTION AND REPLACE WHEN COMPLETE. (INCIDENTAL). CONTRACTOR HAS THE OPTION OF REPLACING ALL OR PART OF THE CANOPY ASSEMBLY IN LIEU OF REINSTALLING THE EXISTING. ANY PROPOSED REPLACEMENT ASSEMBLY SHALL BE APPROVED BY THE OWNER. ALL COST ASSOCIATED WITH PROTECTION, REMOVAL, REINSTALLATION, OR REPLACEMENT OF THE CANOPY ASSEMBLY SHALL BE INCIDENTAL TO THE PROJECT AND NO FURTHER PAYMENT WILL BE MADE.

NOV 12, 2020 3:36 PM HERNDD1562
I:\20\JOBS\20A0053D\CAD\AIRPORT\131-EXST.DWG

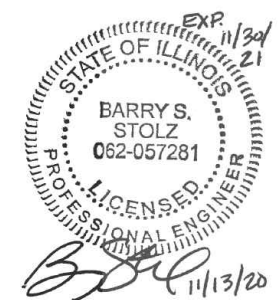

**RECONSTRUCT
CONCRETE APRON,
PHASE 2**

IDA No: SLO-4836

SBG Project No:
3-17-SBGP-156/162

Contract No. SA034

NO.	DATE	DESCRIPTION		
		DES	DWN	REV

ISSUE: NOVEMBER 13, 2020

PROJECT NO: 20A0053D

CAD FILE: C-302-TYP.DWG

DESIGN BY: JRH/JAR 11/03/2020

DRAWN BY: CWS 11/03/2020

REVIEWED BY: BSS 11/13/2020

SHEET TITLE

**TYPICAL SECTIONS
AND DRAINAGE
DETAILS**

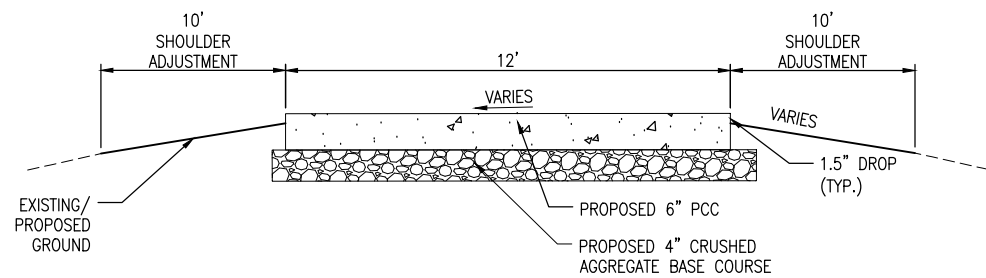

PROPOSED PCC DRIVE
NOT TO SCALE

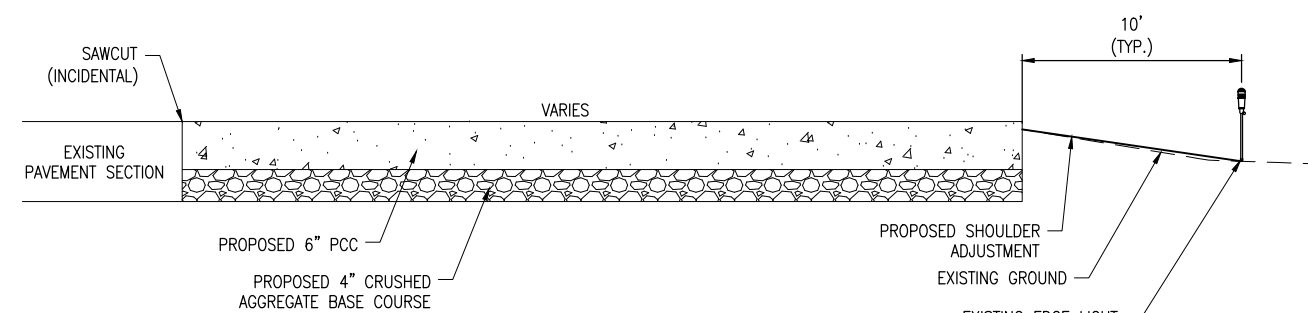

PROPOSED APRON TYPICAL SECTION
NOT TO SCALE

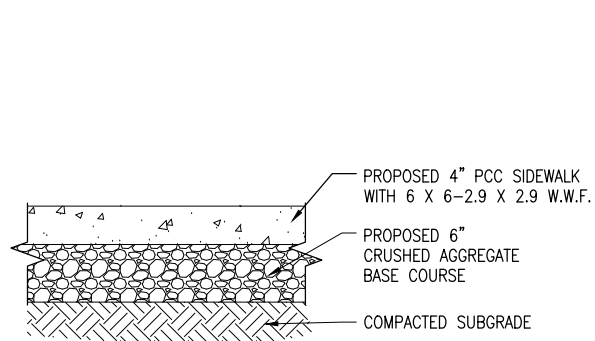

PROPOSED CONCRETE SIDEWALK SECTION
NOT TO SCALE

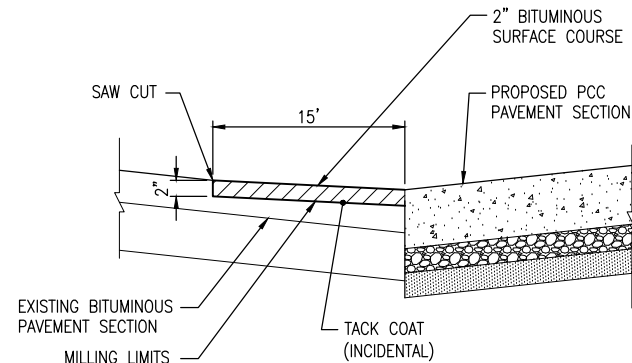

REMOVE AND REPLACE BITUMINOUS SURFACE DETAIL
NOT TO SCALE

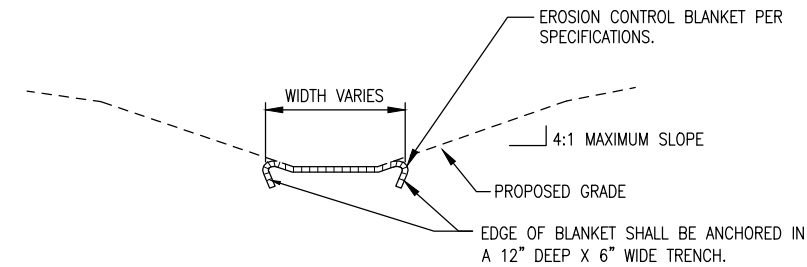

NOTE: ALL EROSION CONTROL BLANKETS SHALL BE INSTALLED PER MANUFACTURER'S RECOMMENDATIONS BASED ON THE PROPOSED TYPE AND USE.

TYPICAL EROSION CONTROL BLANKET
NOT TO SCALE

NOTES:

1. TRANSVERSE JOINTS SPACED AT 4" INTERVALS.
2. 3/4" PREFORMED EXPANSION JOINT FILLER TO BE USED AT ALL LOCATIONS WHERE SIDEWALK IS ADJACENT TO PCC PAVEMENT.

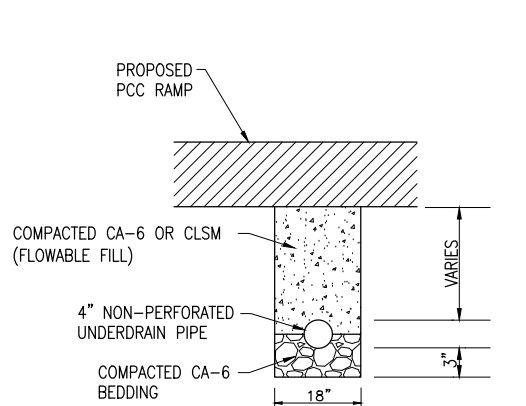

**NON-PERFORATED UNDERDRAIN TRENCH
UNDER PAVEMENT**
NOT TO SCALE

NOTE:
COST OF ALL WORK ASSOCIATED WITH THIS DETAIL SHALL BE INCLUDED IN COST OF NON-PERFORATED UNDERDRAIN PIPE.

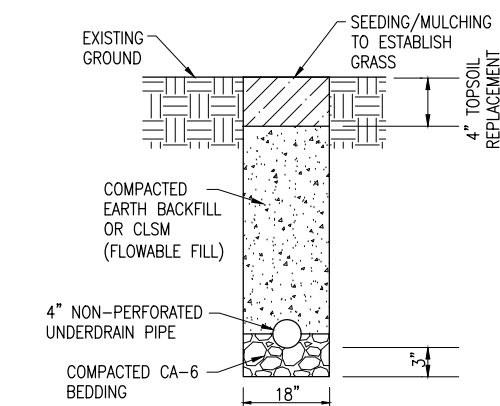

**NON-PERFORATED UNDERDRAIN TRENCH
UNDER TURF**
NOT TO SCALE

NOTE:
COST OF ALL WORK ASSOCIATED WITH THIS DETAIL SHALL BE INCLUDED IN COST OF NON-PERFORATED UNDERDRAIN PIPE.

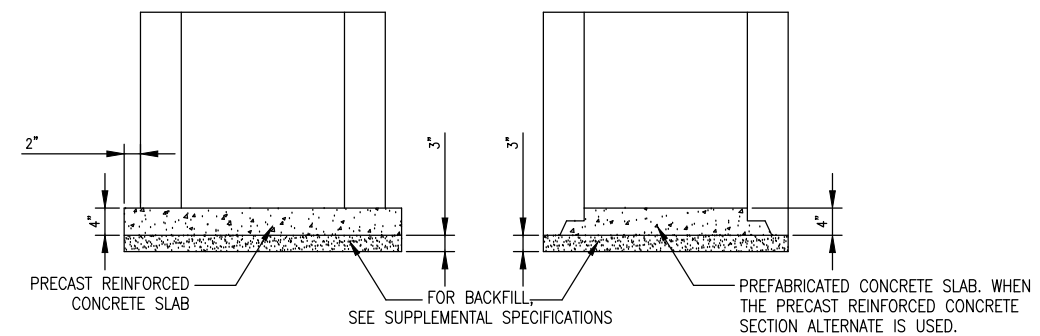
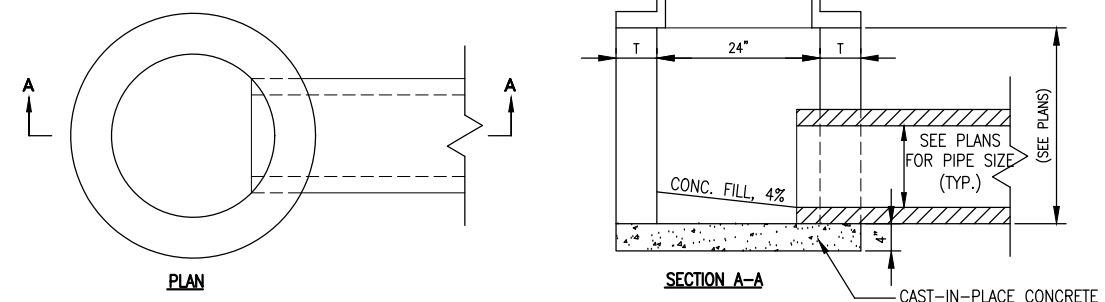

ALTERNATE METHODS

NOTES

1. SEE CONSTRUCTION PLAN FOR SIZE AND NUMBER OF PIPE CONNECTIONS.
2. INLETS TO BE PRECAST REINFORCED CONCRETE SECTIONS (T = 3").

INLET TYPE A

(IDOT STANDARD 602301)

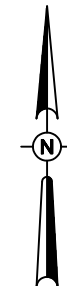

0' 5' 10' 20'
HALF SIZE SCALE: 1" = 20'
FULL SIZE SCALE: 1" = 10'

LEGEND

- EXISTING IMPROVEMENTS
- EXISTING BUILDINGS
- PROPOSED IMPROVEMENTS
- EXISTING FENCE
- PROPOSED SAWCUT
- PROPOSED REMOVE AND REPLACE BIT. SURFACE
- PROPOSED SHOULDER ADJUSTMENT

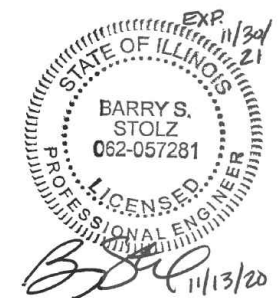

RECONSTRUCT CONCRETE APRON, PHASE 2

IDA No: SLO-4836
SBG Project No:
3-17-SBGP-156/162
Contract No. SA034

NO.	DATE	DESCRIPTION		
		DES	DWN	REV

ISSUE: NOVEMBER 13, 2020

PROJECT NO: 20A0053D
CAD FILE: C-141-CON.DWG

DESIGN BY: JRH/JAR 11/03/2020
DRAWN BY: CWS 11/03/2020

REVIEWED BY: BSS 11/13/2020

SHEET TITLE

PROPOSED CONSTRUCTION PLAN

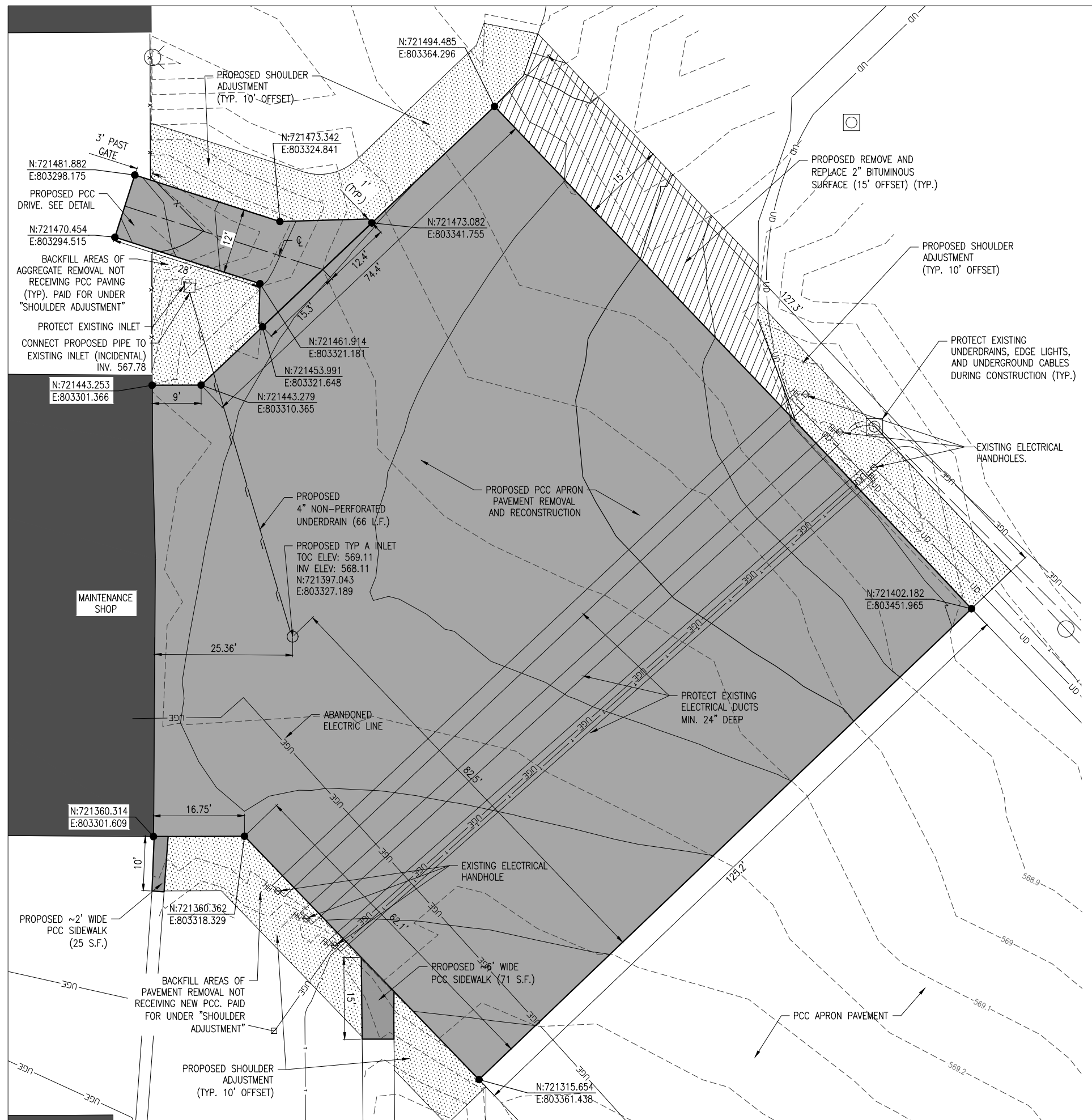

NOTES

- DURING THE PCC PAVEMENT RECONSTRUCTION, THE CONTRACTOR SHALL REMOVE TO A SUFFICIENT DEPTH IN ORDER TO ACCOMMODATE THE CONSTRUCTION OF THE PROPOSED PCC PAVEMENT TO PROPOSED GRADES. IF FOR ANY REASON THE CONTRACTOR REMOVES A GREATER DEPTH, NO ADDITIONAL COMPENSATION WILL BE ALLOWED FOR EXTRA MATERIAL.
- EXISTING TIE-DOWN ANCHOR IS TO BE REMOVED AND PROPERLY DISPOSED OF AS INCIDENTAL TO THE EXISTING PCC PAVEMENT REMOVAL.
- THE CONTRACTOR SHALL PROTECT EXISTING PAVEMENT, HANGARS AND BUILDINGS AT ALL TIMES DURING CONSTRUCTION.
- EXISTING PCC PAVEMENT SECTION IS APPROX. 9.5" PCC ON 5" CRUSHED AGGREGATE.
- DURING THE BITUMINOUS SURFACE REMOVAL AND REPLACEMENT WORK, THE CONTRACTOR SHALL PROTECT THE PROPOSED PCC PAVEMENT AREA AND EXISTING PAVEMENT TO REMAIN. THE INTENT IS TO REMOVE A SUFFICIENT DEPTH OF PAVEMENT IN ORDER TO PAVE A 2" DEPTH OF BITUMINOUS SURFACE TO PROPOSED GRADES. IF FOR ANY REASON THE CONTRACTOR REMOVES A GREATER DEPTH, NO ADDITIONAL COMPENSATION WILL BE ALLOWED TO PAVE BACK TO THE PROPOSED GRADES.
- AREAS NOTED AS "SHOULDER ADJUSTMENT" SHALL ALSO RECEIVE EROSION CONTROL BLANKET INSTALLATION FOLLOWING SEEDING.

NOV 12, 2020 3:36 PM HERND01562
I:\20\085\20A0053D\CAD\AIRPORT\141-CON.DWG

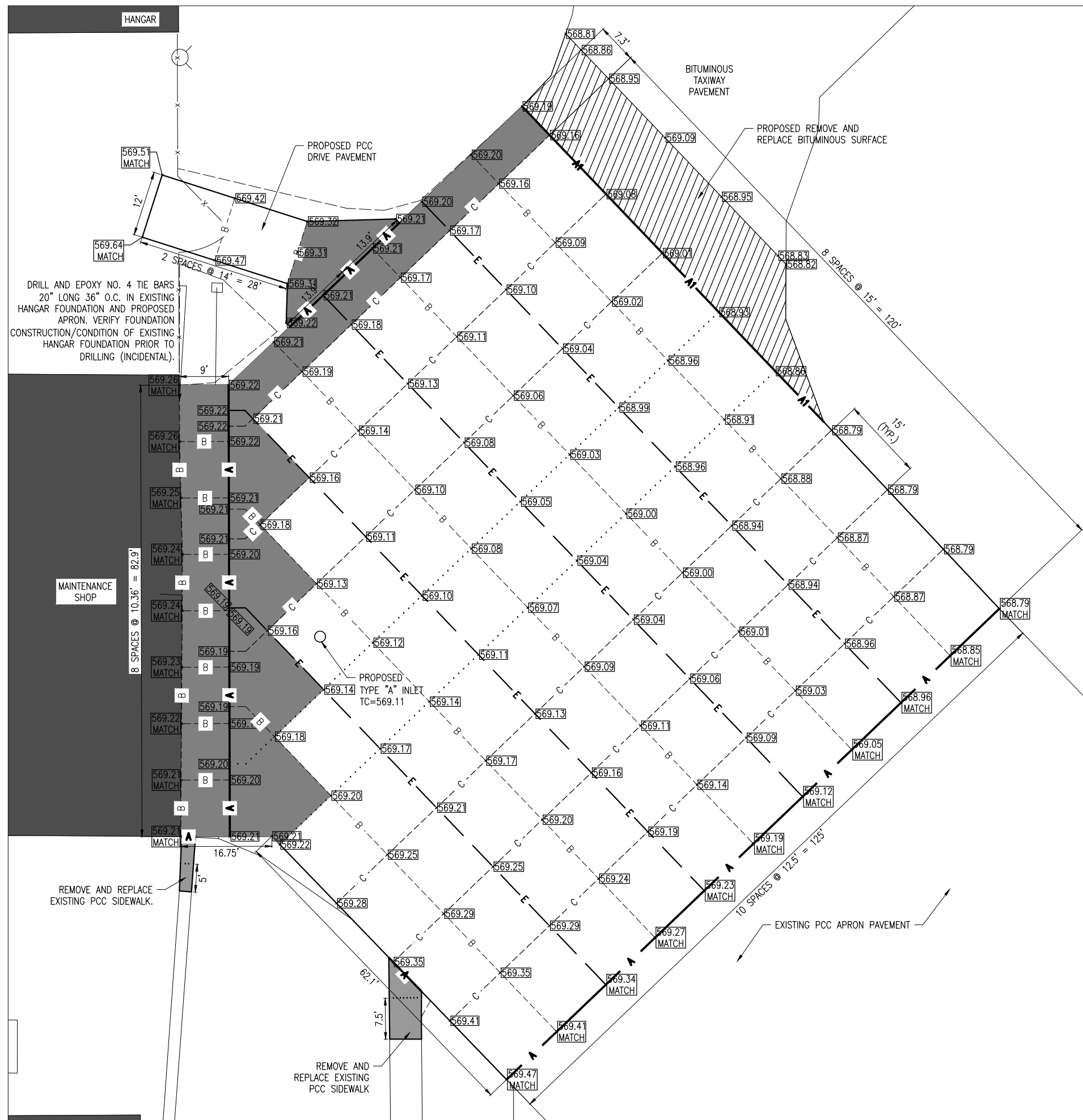
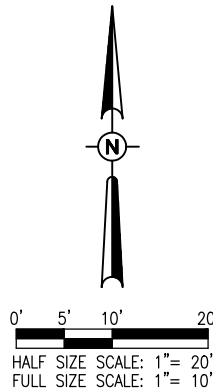

DRILL AND EPOXY NO. 4 TIE BARS
20" LONG 36" O.C. IN EXISTING
HANGAR FOUNDATION AND PROPOSED
APRON. VERIFY FOUNDATION
CONSTRUCTION/CONDITION OF EXISTING
HANGAR FOUNDATION PRIOR TO
DRILLING (INCIDENTAL).

LEGEND

- EXISTING IMPROVEMENTS
- PROPOSED IMPROVEMENTS
- EXISTING FENCE
- TYPE A, ISOLATION JOINT
- TYPE A1-MODIFIED, ISOLATION JOINT
- TYPE B, CONTRACTION JOINT
- TYPE C, CONTRACTION JOINT
- TYPE D, CONTRACTION JOINT
- TYPE E, CONSTRUCTION JOINT
- PROPOSED TIE DOWN ANCHOR
- PROPOSED REINFORCED PANEL
- PROPOSED SPOT ELEVATION

JOINTING NOTES

1. ALL JOINT EDGES SHALL BE SAWCUT TO PRODUCE THE 1/4" CHAMFER.
2. ALL LONGITUDINAL AND TRANSVERSE CONTRACTION JOINTS SHALL BE SAWED.
3. ALL DOWEL BARS SHALL BE SECURELY HELD IN PLACE BY MEANS OF A DOWEL BAR ASSEMBLY WHICH WILL ENSURE THAT THEY WILL REMAIN PARALLEL TO THE SURFACE OF THE PAVEMENT AND TO THE CENTERLINES OF THE PAVEMENT LANES. THE DOWEL BAR ASSEMBLIES SHALL BE APPROVED BY THE RESIDENT ENGINEER/TECHNICIAN PRIOR TO INSTALLATION.
4. DOWEL BARS FOR 6 IN. THICK PAVEMENT SHALL BE 3/4 IN. DIAMETER, 18 IN. LONG AT 12 IN. SPACING.
5. ALL TIE BARS SHALL BE HELD IN PLACE BY SUPPORT PINS OR OTHER METHODS TO PREVENT SHIFTING DURING AND AFTER CONCRETE PLACEMENT. SUPPORT PINS SHALL BE OF SUFFICIENT LENGTH TO PENETRATE AT LEAST 6" INTO THE SUBGRADE.
6. ALL TIE BARS SHALL BE PLACED AT A POINT NOT LESS THAN 6" OR MORE THAN 15" FROM A TRANSVERSE OR EXPANSION JOINT.
7. DOWELS IN TRANSVERSE CONTRACTION AND LONGITUDINAL CONSTRUCTION JOINTS SHALL BE COATED WITH A RUSTPROOFING COMPOUND AND HALF THE LENGTH GREASED WITH A HEAVY GREASE.
8. ALLOWABLE TOLERANCES FOR GROOVE DEPTH WILL BE ±1/8" FOR CONSTRUCTION JOINTS AND ±1/4" FOR CONTRACTION JOINTS.
9. THE CONTRACTOR IS REQUIRED TO DRILL AND EPOXY THE PROPOSED DOWELS IN ACCORDANCE WITH THE DETAILS AND SPECIFICATIONS. THE EPOXY MATERIAL MUST BE APPROVED BY THE DIVISION OF AERONAUTICS PRIOR TO USE.
10. THE COST OF ALL DOWEL BARS, TIE-BARS, SAWING AND SEALING SHALL BE INCLUDED IN THE COST OF THE PCC PAVEMENT.
11. WHEN CONSTRUCTING "FILL-IN" PAVEMENT LANES THE CONTRACTOR SHALL USE BELTING OR OTHER PROTECTIVE MATERIAL FOR THE PAVING MACHINE TO TRAVEL ON AND WILL PROTECT THE TRANSVERSE JOINTS.
12. JOINT SEALANT SHALL BE AS SPECIFIED IN THE STANDARD SPECIFICATIONS, ITEM 605.
13. CURING COMPOUND SHALL BE AS SPECIFIED IN THE SPECIAL PROVISIONS, ITEM 501, SECTION 501-2.9, AND SHALL BE APPROVED PRIOR TO THE PAVING OPERATION BY THE RESIDENT ENGINEER/TECHNICIAN.
14. ALL NON-ALIGNED EDGES WILL BE SAWED FULL DEPTH.

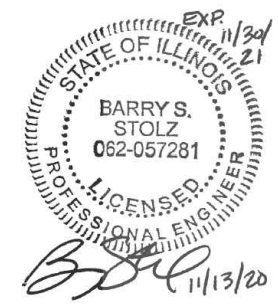

RECONSTRUCT CONCRETE APRON, PHASE 2

IDA No: SLO-4836
SBG Project No:
3-17-SBGP-156/162
Contract No. SA034

NO.	DATE	DESCRIPTION		
		DES	DWN	REV

ISSUE: NOVEMBER 13, 2020
PROJECT NO: 20A0053D
CAD FILE: C-161-JNT.DWG
DESIGN BY: JRH/JAR 11/03/2020
DRAWN BY: CWS 11/03/2020
REVIEWED BY: BSS 11/13/2020

SHEET TITLE

PROPOSED JOINTING PLAN

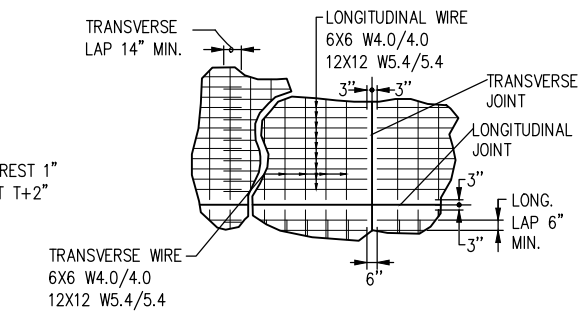
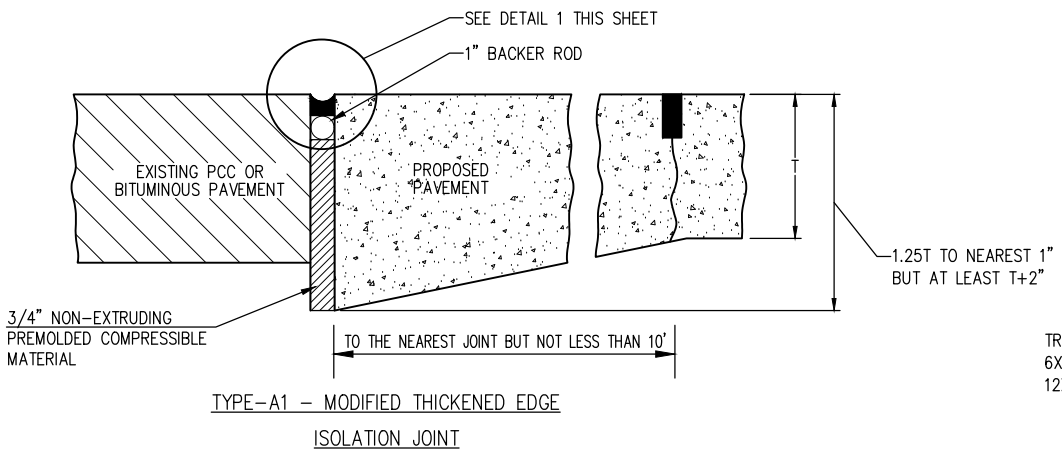
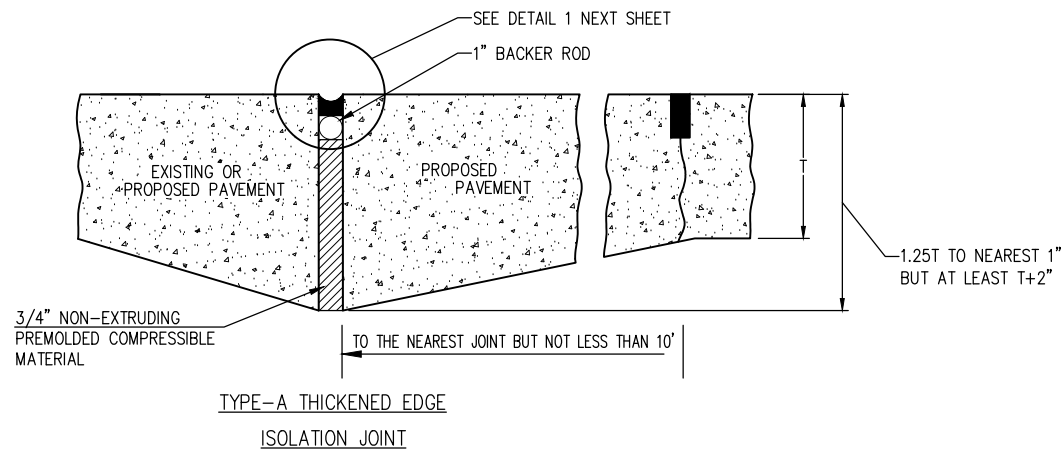

REINFORCEMENT SHEET WIRE FABRIC DETAIL
NOT TO SCALE

NOTE:
DIFFERENT WIRE MESH SIZES/CONFIGURATIONS OR SIZES ARE PERMITTED
IF THE MINIMUM CROSS SECTIONAL AREA EQUALS 0.5 OR GREATER.

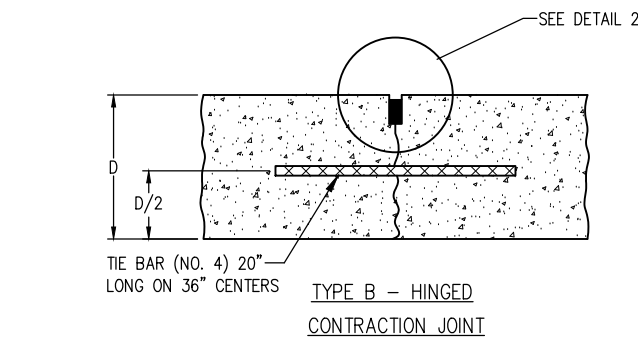

TYPE B - HINGED
CONTRACTION JOINT

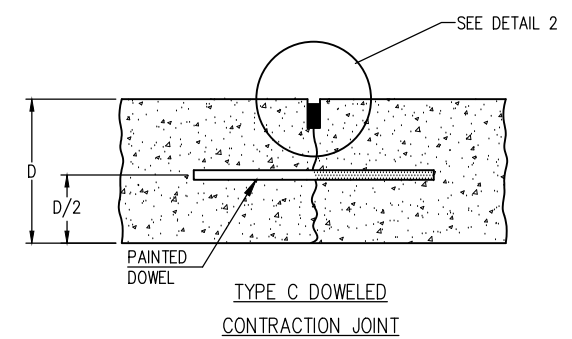

TYPE C DOWELED
CONTRACTION JOINT

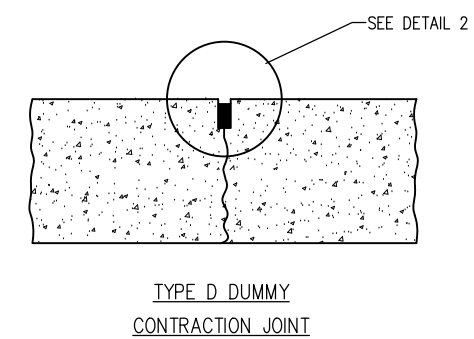

TYPE D DUMMY
CONTRACTION JOINT

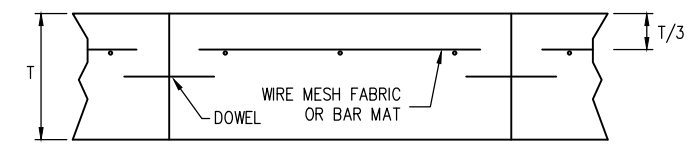

PAVEMENT REINFORCING DETAIL
NOT TO SCALE

REINFORCING NOTES:

1. END LAPS SHALL BE A MINIMUM OF 12", BUT NOT LESS THAN 30 TIMES THE DIAMETER OF THE LONGITUDINAL WIRE OR BAR.
2. SIDE LAPS SHALL BE A MINIMUM OF 6", BUT NOT LESS THAN 20 TIMES THE DIAMETER OF TRANSVERSE WIRE OR BAR.
3. END AND SIDE CLEARANCES SHALL BE A MAXIMUM OF 6" AND A MINIMUM OF 2".
4. LONGITUDINAL MEMBERS SHALL BE SPACED NOT LESS THAN 4" NOR MORE THAN 12" APART.
5. TRANSVERSE MEMBERS SHALL BE SPACED NOT LESS THAN 4" NOR MORE THAN 24" APART.
6. REINFORCING SHALL CONSIST OF WELDED STEEL WIRE FABRIC CONFORMING TO THE REQUIREMENTS OF ASTM A 185 OR BAR MATS CONFORMING TO THE REQUIREMENTS OF ASTM A 184 OR A 704.
7. PAVEMENT REINFORCING SHALL BE INCIDENTAL TO ITEM 501 PCC PAVEMENT.

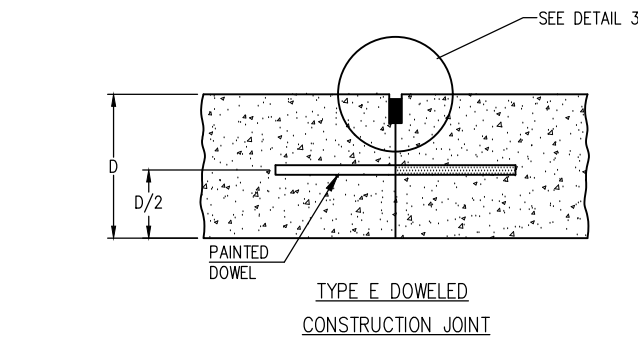

TYPE E DOWELED
CONSTRUCTION JOINT

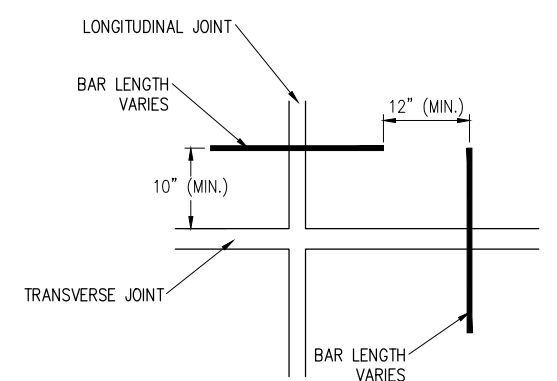

POSITION OF DOWELS AT EDGE OF JOINT TYPE C OR E
DOWEL PLAN VIEW

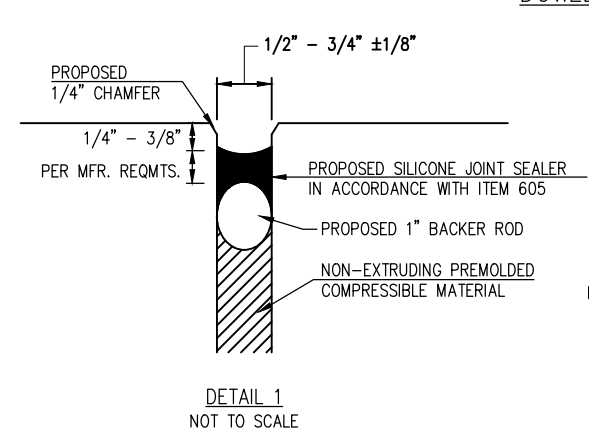

DETAIL 1
NOT TO SCALE

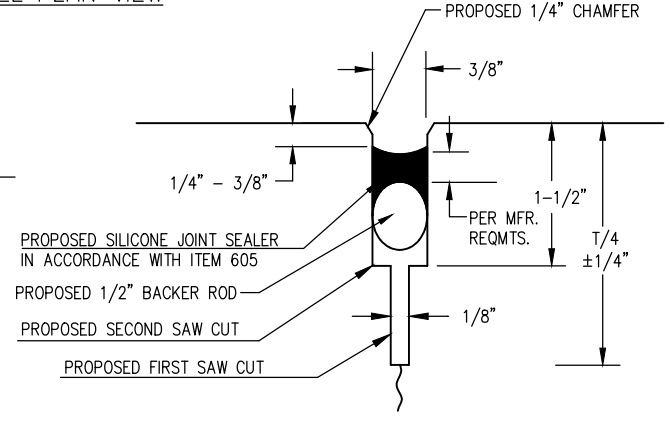

DETAIL 2
NOT TO SCALE
JOINT SEALING DETAILS
NOT TO SCALE

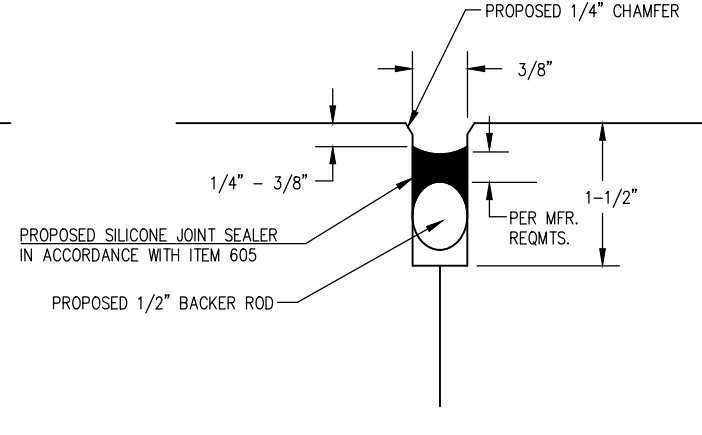

DETAIL 3
NOT TO SCALE

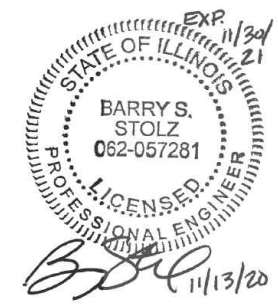

RECONSTRUCT
CONCRETE APRON,
PHASE 2

IDA No: SLO-4836
SBG Project No:
3-17-SBGP-156/162
Contract No. SA034

NO.	DATE	DESCRIPTION		
		DES	DWN	REV

ISSUE: NOVEMBER 13, 2020
PROJECT NO: 20A0053D
CAD FILE: C-561-JNT.DWG
DESIGN BY: JRH/JAR 11/03/2020
DRAWN BY: CWS 11/03/2020
REVIEWED BY: BSS 11/13/2020

SHEET TITLE

PROPOSED JOINT
DETAILS

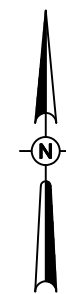

0' 15' 30' 60'
HALF SIZE SCALE: 1" = 60'
FULL SIZE SCALE: 1" = 30'

LEGEND

- EXISTING IMPROVEMENTS
- EXISTING BUILDINGS
- PROPOSED IMPROVEMENTS
- EXISTING FENCE
- PROPOSED PAVEMENT MARKING

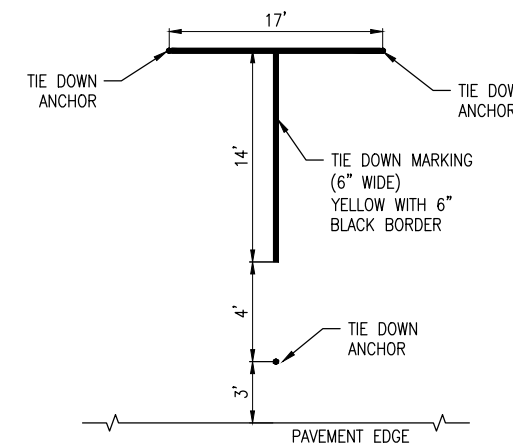

TIE DOWN DETAIL
NOT TO SCALE

PAVEMENT MARKING NOTES

1. TYPE B GLASS BEADS SHALL BE REQUIRED FOR ALL YELLOW PERMANENT PAINT MARKINGS. GLASS BEADS ARE NOT REQUIRED FOR TEMPORARY MARKINGS OR BLACK PAINT. REFER TO SPECIFICATION ITEM 620 FOR ADDITIONAL INFORMATION.
2. PAINT SHALL MEET REQUIREMENTS OF TECHNICAL SPECIFICATION 620, WATERBORNE PAINT.
3. IMMEDIATELY PRIOR TO THE APPLICATION OF PAINT, ALL SURFACES SHALL BE DRY AND FREE FROM DIRT, GREASE, OIL, LAITANCE, OR OTHER FOREIGN MATERIAL WHICH WOULD REDUCE THE BOND BETWEEN THE PAINT AND THE PAVEMENT. THIS SHALL INCLUDE PAINTED AREAS ON THE EXISTING PAVEMENTS. REFER TO SPECIFICATION ITEM 620-3.3 FOR ADDITIONAL INFORMATION.
4. EXISTING PAVEMENT MARKINGS OUTSIDE THE LIMITS OF THE MARKINGS SHOWN ON THE MARKING PLAN WHICH ARE REMOVED OR WORN DUE TO CONSTRUCTION ACTIVITY SHALL BE REPAINTED. NO ADDITIONAL COMPENSATION SHALL BE MADE FOR THIS WORK.
5. IF THE CONTRACTOR ELECTS TO "BLOCK PAINT" THE BLACK PAINT AND THEN PAINT YELLOW OVER THE BLACK PAINT; ONLY THE VISIBLE BLACK PAINT WILL BE ELIGIBLE FOR PAYMENT.

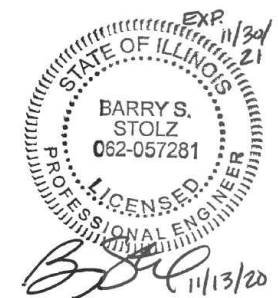

RECONSTRUCT CONCRETE APRON, PHASE 2

IDA No: SLO-4836
SBG Project No:
3-17-SBGP-156/162
Contract No. SA034

NO.	DATE	DESCRIPTION		
		DES	DWN	REV

ISSUE: NOVEMBER 13, 2020
PROJECT NO: 20A0053D
CAD FILE: C-151-MRK.DWG
DESIGN BY: JRH/JAR 11/03/2020
DRAWN BY: CWS 11/03/2020
REVIEWED BY: BSS 11/13/2020

SHEET TITLE

PROPOSED MARKING PLAN

NOV 12, 2020 3:36 PM HERND01562
I:\20\JOBS\20A0053D\CAD\AIRPORT\151-MRK.DWG

