

- 1 COVER SHEET
- 2 GENERAL NOTES
- 3 SUMMARY OF QUANTITIES
- 4 - 5 BUREAU COUNTY SCHEDULES
- 6 BUREAU COUNTY LOCATION MAP
- 7 LIVINGSTON COUNTY SCHEDULE
- 8 LIVINGSTON COUNTY LOCATION MAP
- 9 DETAILS

LIST OF ILLINOIS DOT HIGHWAY STANDARDS

- 000001-08 STANDARD SYMBOLS, ABBREVIATIONS AND PATTERNS
- 701201-05 LANE CLOSURE, 2L, 2W, DAY ONLY, FOR SPEEDS ≥ 45 MPH
- 701400-10 APPROACH TO LANE CLOSURE, FREEWAY/EXPRESSWAY
- 701406-12 LANE CLOSURE, FREEWAY/EXPRESSWAY, DAY OPERATIONS ONLY
- 701411-09 LANE CLOSURE, MULTILANE, AT ENTRANCE OR EXIT RAMP FOR SPEEDS ≥ 45 MPH
- 701426-09 LANE CLOSURE, MULTILANE INTERMITTENT OR MOVING OPERATION, FOR SPEEDS ≥ 45 MPH
- 701428-01 TRAFFIC CONTROL, SETUP AND REMOVAL, FREEWAY/EXPRESSWAY
- 701456-05 PARTIAL EXIT RAMP CLOSURE FREEWAY/EXPRESSWAY
- 701501-06 URBAN LANE CLOSURE, 2L, 2W, UNDIVIDED
- 701601-09 URBAN LANE CLOSURE, MULTILANE, 1W OR 2W WITH NONTRAVERSABLE MEDIAN
- 701606-10 URBAN LANE CLOSURE, MULTILANE, 2W WITH MOUNTABLE MEDIAN
- 701901-08 TRAFFIC CONTROL DEVICES

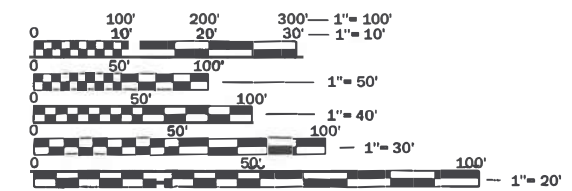

FULL SIZE PLANS HAVE BEEN PREPARED USING STANDARD ENGINEERING SCALES. REDUCED SIZED PLANS WILL NOT CONFORM TO STANDARD SCALES. IN MAKING MEASUREMENTS ON REDUCED PLANS, THE ABOVE SCALES MAY BE USED.

J.U.L.I.E.
 JOINT UTILITY LOCATION INFORMATION FOR EXCAVATION
 1-800-892-0123
 OR 811

PROJECT ENGINEER: BRAD DUNCAN, P.E.
UNIT CHIEF: LUIS CALDERON, P.E.
 DISTRICT 3 NO. (815) 434-6131
 CONTRACT NO. 66L44

STATE OF ILLINOIS
 DEPARTMENT OF TRANSPORTATION

PROPOSED HIGHWAY PLANS

VARIOUS ROUTES SECTION D3 BRIDGE DECK SEALING FY 2021 BRIDGE DECK SEALING LIVINGSTON & BUREAU COUNTIES

C-93-037-21

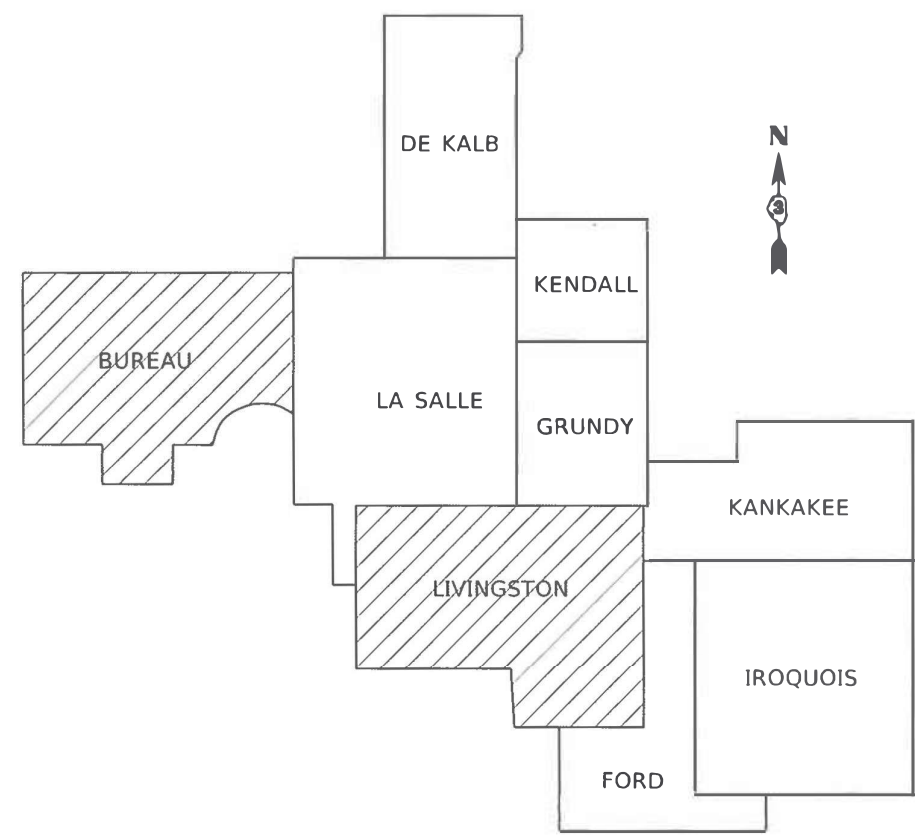

F.A. RTE.	SECTION	COUNTY	TOTAL SHEETS	SHEET NO.
VAR	D3 BRIDGE DECK SEALING	VARIOUS	9	1
		ILLINOIS	CONTRACT NO. 66L44	

D-93-006-21



STATE OF ILLINOIS
 DEPARTMENT OF TRANSPORTATION

SUBMITTED October 15, 2020

[Signature]
 REGIONAL ENGINEER

December 4, 2020

[Signature]
 ENGINEER OF DESIGN AND ENVIRONMENT

December 4, 2020

[Signature]
 DIRECTOR OF HIGHWAYS PROJECT IMPLEMENTATION '13

**PRINTED BY THE AUTHORITY
 OF THE STATE OF ILLINOIS**

GENERAL NOTES

ANY REFERENCE TO A STANDARD IN THESE PLANS SHALL BE INTERPRETED TO MEAN THE EDITION AS INDICATED BY THE SUBNUMBER SHOWN IN THE LIST OF STANDARDS OR THE COPY INCLUDED IN THESE PLANS.

THE ENGINEER WILL BE THE SOLE JUDGE CONCERNING CURING TIME FOR THE SEALER.

COMMITMENTS

NONE

STATE OF ILLINOIS
DEPARTMENT OF TRANSPORTATION
DISTRICT THREE
AS BUILT INFORMATION

SUPERVISING CONSTRUCTION FIELD ENGINEER

RESIDENT ENGINEER / TECHNICIAN

START & END DATES
OF CONSTRUCTION:

INSPECTORS:

STATE OF ILLINOIS
DEPARTMENT OF TRANSPORTATION
DISTRICT THREE

PREPARED BY: _____
DISTRICT STUDIES & PLANS ENGINEER

DATE: _____

EXAMINED BY: _____
DISTRICT CONSTRUCTION ENGINEER

DISTRICT MATERIALS ENGINEER

DISTRICT OPERATIONS ENGINEER

* D3 BRIDGE DECK SEALING FY 2021 - BUREAU & LIVINGSTON COUNTIES

MODEL: \\MODELM\JM\MS
FILE: \\mms\c\p\work\asubid\calderon\607104570\66L44\asb\cover.dgn

USER NAME = calderonl	DESIGNED -	REVISED -
	DRAWN -	REVISED -
PLOT SCALE = 100.0000 ' / in.	CHECKED -	REVISED -
PLOT DATE = 9/30/2020	DATE -	REVISED -

**STATE OF ILLINOIS
DEPARTMENT OF TRANSPORTATION**

GENERAL NOTES

SCALE: SHEET OF SHEETS STA. TO STA.

F.A. RTE.	SECTION	COUNTY	TOTAL SHEETS	SHEET NO.
VAR	*	VARIOUS	9	2
CONTRACT NO. 66L44				
ILLINOIS FED. AID PROJECT				

CODE NO.	ITEM	UNIT	TOTAL QUANTITY	CONSTRUCTION CODE	
				STP-FLEX 80% FED/20% STATE	STP-FLEX 80% FED/20% STATE
				BRIDGE 0047	BRIDGE 0047
				BUREAU CO	LIVINGSTON CO
67100100	MOBILIZATION	L SUM	1	0.5	0.5
70100420	TRAFFIC CONTROL AND PROTECTION, STANDARD 701411	EACH	6	5	1
70100450	TRAFFIC CONTROL AND PROTECTION, STANDARD 701201	L SUM	1	0.5	0.5
70100700	TRAFFIC CONTROL AND PROTECTION, STANDARD 701406	L SUM	1	0.5	0.5
70100825	TRAFFIC CONTROL AND PROTECTION, STANDARD 701456	L SUM	1	0.5	0.5
70102620	TRAFFIC CONTROL AND PROTECTION, STANDARD 701501	L SUM	1	0.5	0.5
70102625	TRAFFIC CONTROL AND PROTECTION, STANDARD 701606	L SUM	1	0.5	0.5
70102630	TRAFFIC CONTROL AND PROTECTION, STANDARD 701601	L SUM	1	0.5	0.5
X5870015	BRIDGE DECK CONCRETE SEALER	SQ FT	1,186,923	853,353	333,570
Z0048665	RAILROAD PROTECTIVE LIABILITY INSURANCE	L SUM	1	0.5	0.5

MODEL: \\MODELMATHS
 FILE: \\maths\csm\workspaced\calderon\071045702666445ch-cover.dgn

USER NAME = calderonl	DESIGNED -	REVISED - LC 10.30.2020
	DRAWN -	REVISED -
PLOT SCALE = 100.0000 ' / in.	CHECKED -	REVISED -
PLOT DATE = 9/30/2020	DATE -	REVISED -

**STATE OF ILLINOIS
DEPARTMENT OF TRANSPORTATION**

SUMMARY OF QUANTITIES

SCALE: SHEET OF SHEETS STA. TO STA.

* D3 BRIDGE DECK SEALING FY 2021 - BUREAU & LIVINGSTON COUNTIES

F.A. RTE.	SECTION	COUNTY	TOTAL SHEETS	SHEET NO.
VAR	*	VARIOUS	9	3
CONTRACT NO. 66L44				
		ILLINOIS	FED. AID PROJECT	

CONCRETE SEALER SCHEDULE - BUREAU COUNTY

STRUCTURE NUMBER	FACILITY CARRIED	APPROXIMATE LOCATION	FEATURE CROSSED	DECK WIDTH	PARAPET SURFACE	MEDIAN SURFACE	DECK LENGTH	SEAL AREA	TRAFFIC CONTROL AND PROTECTION STANDARD	
				FEET	FEET	FEET	FEET	SQ FT		
BUREAU COUNTY										
INTERSTATE STRUCTURES - 49										
006-0001	I-80 EASTBOUND	1.04 E/HENRY CO LN	KING CREEK	40.2	7.4		98.2	4,674	701406	
006-0002	I-80 WESTBOUND	1.05 E/HENRY CO LN	KING CREEK	40.2	7.4		98.2	4,674	701406	
006-0003	I-80 EASTBOUND	1.51 E/HENRY CO LN	BARBARA DITCH	40.2	7.4		73.5	3,499	701406	
006-0004	I-80 WESTBOUND	1.52 E/HENRY CO LN	BARBARA DITCH	40.2	7.4		73.5	3,499	701406	
006-0005	I-80 EASTBOUND	3.44 E/HENRY CO LN	ABBOTT DITCH	40.2	7.4		178	8,473	701406	
006-0006	I-80 WESTBOUND	3.45 E/HENRY CO LN	ABBOTT DITCH	40.2	7.4		178	8,473	701406	
006-0007	I-80 EASTBOUND	3.81 E/HENRY CO LN	COAL CREEK	40	7.6		176	8,378	701406	
006-0008	I-80 WESTBOUND	3.82 E/HENRY CO LN	COAL CREEK	40	7.6		176	8,378	701406	
006-0009	I-80 EASTBOUND	1.0 MI. W. OF IL 40	DRAINAGE DITCH	40.5	7.6		136	6,542	701406	
006-0010	I-80 WESTBOUND	1.0 MI. W. OF IL 40	DRAINAGE DITCH	40.5	7.6		136	6,542	701406	
006-0016	I-80 WESTBOUND	2 MI N WYANET	WEST BUREAU CREEK	34	7.4		43	1,780	701406	
006-0017	I-80 EASTBOUND	2 MI N WYANET	WEST BUREAU CREEK	34	7.4		94.8	3,925	701406	
006-0020	I-80 EASTBOUND	2.8 MI W O I-180	US 34	40	7.6		138.6	6,597	701406	
006-0021	I-80 WESTBOUND	2.8 MI W O I-180	US 34	40	7.6		138.6	6,597	701406	
006-0038	I-180 NORTHBOUND	4 MI E. OF PRINCETON	I-80	26.5	4.8		273.2	8,551	701456 *	
006-0039	I-180 SOUTHBOUND	4 MI E. OF PRINCETON	I-80	26.5	4.8		272.2	8,520	701456 *	
006-0043	I-180 NORTHBOUND	1.1 MI N ILL 26	BRUSH CREEK	39	5		191	8,404	701406 *	
006-0044	I-180 SOUTHBOUND	1.1 MI N ILL 26	BRUSH CREEK	39	5		191	8,404	701406 *	
006-0045	I-180 SOUTHBOUND	2 MI NW BUREAU JCT	ILL 26	39	5		212.5	9,350	701406, 701411 *	
006-0046	I-180 NORTHBOUND	2 MI NW BUREAU JCT	ILL 26	39	5		212.5	9,350	701406, 701411 *	
006-0047	I-180 SOUTHBOUND	0.5 MI S JCT ILL 26	EAST BUREAU CREEK	39	5		211.1	9,288	701406, 701411 SB *	
006-0048	I-180 NORTHBOUND	0.5 MI S JCT ILL 26	EAST BUREAU CREEK	39	5		211.1	9,288	701406 *	
006-0049	I-180 SOUTHBOUND	0.7 MI S ILL 26	IAIS RR, I & M CANAL	39	5		716.8	31,539	701406 *	
006-0050	I-180 NORTHBOUND	0.7 MI S ILL 26	IAIS RR, I & M CANAL	39	5		716.8	31,539	701406 *	
006-0051	I-180 SOUTHBOUND	1.2 MI S JCT ILL 26	BUREAU CREEK	39	5		371.5	16,346	701406 *	
006-0052	I-180 NORTHBOUND	1.2 MI S JCT ILL 26	BUREAU CREEK	39	5		371.5	16,346	701406 *	
006-0053	I-180 SOUTHBOUND	1.4 MI S JCT ILL 26	BOTTOM RD FAS 246	39	5		176.3	7,757	701406 *	
006-0054	I-180 NORTHBOUND	1.4 MI S JCT ILL 26	BOTTOM RD FAS 246	39	5		176.3	7,757	701406 *	
006-0055	I-180 EASTBOUND	3 MI W HENNEPIN	FAP 318 NB	39	5		328.4	14,450	701406 *	
006-0056	I-180 EASTBOUND	3 MI W HENNEPIN	I-180 RMP 10.01	39	5		234	10,296	701406 *	
006-0057	I-180 EASTBOUND	2 MI SW BUREAU JCT.	IL 29(SBI29A)&IAIS RR	63	5		393	26,724	701406, 701411 *	
006-0058	I-180 WESTBOUND	2 MI. SW BUREAU JCT.	IL 29(SBI29A)&IAIS RR	69.7	5		383.8	28,670	701406, 701411 *	
006-0060	I-180 EASTBOUND	1.5 MI W HENNEPIN	ILL 26 & BUREAU CRK.	39	5		401	17,644	701406 *	
006-0151	I-80 EASTBOUND	2 MI. W. OF IL 26	BUREAU CREEK	40	7.4		292	13,841	701406	
006-0152	I-80 WESTBOUND	2 MI. W. OF IL 26	BUREAU CREEK	40	7.4		292	13,841	701406	
006-0165	I-80 EASTBOUND	1.7 MI E JCT ILL 89	SPRING CREEK	40	7.6		170	8,092	701406	
006-0166	I-80 WESTBOUND	1.7 MI E JCT ILL 89	SPRING CREEK	40	7.6		170	8,092	701406	
006-0167	I-80 EASTBOUND	1.9 MI E JCT ILL 89	ILLINOIS RY	40	7.6		154.5	7,354	701406 *	
006-0168	I-80 WESTBOUND	1.9 MI E JCT ILL 89	ILLINOIS RY	40	7.6		154.5	7,354	701406	
006-0170	I-80 EASTBOUND	4.6 MI E JCT FAI 180--MP 65.6	CREEK & TR 352	40	7.6		310.1	14,761	701406	
006-0171	I-80 WESTBOUND	4.6 MI E JCT FAI 180--MP 65.6	CREEK & TR 352	40	7.6		356.9	16,988	701406	
006-0172	I-80 EASTBOUND	1.2 MI E JCT FAI 180--MP 62.2	E. BUREAU CREEK	40.3	7.6		172.1	8,244	701406	
006-0173	I-80 WESTBOUND	1.2 MI E JCT FAI 180--MP 62.2	E. BUREAU CREEK	40.3	7.6		172.1	8,244	701406	
006-0174	I-80 EASTBOUND	1.8 MI W ILL 89--MP 68.3	NEGRO CREEK	40.8	7.6		221	10,696	701406	
006-0175	I-80 WESTBOUND	1.8 MI W ILL 89--MP 68.3	NEGRO CREEK	40.8	7.6		221	10,696	701406	
006-0176	I-80 EASTBOUND	2.6 MI W OF I-180	BN RR	42.4	7.6		275.9	13,795	701406	
006-0177	I-80 WESTBOUND	2.6 MI W OF I-180	BN RR	42.4	7.6		275.9	13,795	701406	
006-0184	I-80 EASTBOUND	0.9 MI W OF IL 40	HENNEPIN CANAL	41	7.6		185.2	9,001	701406	
006-0185	I-80 WESTBOUND	0.9 MI W OF IL 40	HENNEPIN CANAL	41	7.6		185.2	9,001	701406	
INTERSTATE STRUCTURES SUB-TOTAL								536,048		

* STRUCTURE HAS EXISTING PCC OVERLAY.
ADDITIONAL DRYING TIME MAY BE REQUIRED.

MODEL: \\MODELMARIES
FILE: \\maries_capp\work\bridge\calderon\00710457\0366\44sch-cover.dgn

* D3 BRIDGE DECK SEALING FY 2021 - BUREAU & LIVINGSTON COUNTIES

USER NAME = calderon	DESIGNED -	REVISED -
	DRAWN -	REVISED -
PLOT SCALE = 100.0000' / in.	CHECKED -	REVISED -
PLOT DATE = 10/16/2020	DATE -	REVISED -

**STATE OF ILLINOIS
DEPARTMENT OF TRANSPORTATION**

SCHEDULES	
SCALE:	SHEET OF SHEETS STA. TO STA.

F.A. RTE.	SECTION	COUNTY	TOTAL SHEETS	SHEET NO.
VAR	*	VARIOUS	9	4
			CONTRACT NO. 66L44	
		ILLINOIS	FED. AID PROJECT	

CONCRETE SEALER SCHEDULE - BUREAU COUNTY

STRUCTURE NUMBER	FACILITY CARRIED	APPROXIMATE LOCATION	FEATURE CROSSED	DECK	PARAPET	MEDIAN	DECK	SEAL	TRAFFIC CONTROL AND PROTECTION STANDARD
				WIDTH	SURFACE	SURFACE	LENGTH	AREA	
				FEET	FEET	FEET	FEET	SQ FT	
BUREAU COUNTY									
NON-INTERSTATE STRUCTURES - 42									
006-0083	ILL ROUTE 29 AND 26	0.3 MI N JCT ILL 26	BUREAU CR OVERFLOW	34	7.4		308	12,751	701201
006-0084	ILL ROUTE 29	0.1 MI S JCT ILL 26	BUREAU CREEK	35.9	7.4		218	9,439	701201
006-0085	FAP 318 NB	3 MI W OF HENNEPIN	I-180 EX RMP 1001	39	5		372.7	16,399	701406
006-0086	ILL 40	3.1 MI S JCT ILL 92	WALNUT SPECIAL DITCH	40	7.4		42.8	2,029	701201
006-0097	ILL 92	1.4 MI W JCT ILL 40	GREEN RIVER	32	7.4		170	6,698	701201
006-0101	ILL 92	.7 MI W VAN ORIN	BR MASTERS CR	32	7.4		60.3	2,376	701201
006-0116	FAS 244/BACKBONE RD	1.8 MI W JCT ILL 26	I-80	28	7.6		208.5	7,423	701201
006-0123	TR 148	3.0 MI. E. OF IL 40	I-80	24	1.83		216.7	5,597	701201
006-0124	TR 188	4.3 MI W JCT ILL 26	I-80	24	1.83		235	6,070	701201
006-0125	TR 241	0.9 MI S JCT FAI 80	I-180	30.5	5		277.6	9,855	701201
006-0126	TR 281	1.4 MI N ILL 26	I-180	28.5	5		314	10,519	701201
006-0127	TR 322(2600E)	1.6 MI E JCT I-180	I-80	24	1.83		217.5	5,618	701201
006-0128	TR 333	2.5 MI N JCT ILL 29	I-180	26.5	5		282.9	8,911	701201
006-0129	TR 364 (3000E)	1.4 MI N SEATONVILLE	I-80	24	1.83		250	6,458	701201
006-0133	TR 370 (3100E)	2.2 MI W ILL 89	I-80	24	1.83		268.3	6,930	701201
006-0135	US RT 34	1.1MI NE JCT ILL 26	BN RR	42.5	5		348.8	16,568	701201
006-0137	US 6	1.3 MI E OF I-180	E BUREAU CREEK	30	7.4		156	5,834	701201
006-0140	US 6	WEST EDGE OF SHEFFIELD	COAL CREEK	32	7.6		130.4	5,164	701201
006-0142	ILL 89	0.8 MI S ARLINGTON	BRANCH OF BRUSH CR.	32	1.8		63.5	2,146	701201
006-0143	ILL 29	NORTHEAST EDGE DEPUE	NEGRO CREEK	32	7.4		153.3	6,040	701201
006-0144	US RT 6	IN SEATONVILLE	NEGRO CREEK	32	7.4		105.3	4,149	701201
006-0145	ILL 40	1.2 MI S OF BUDA	COAL CREEK	32	7.4		118	4,649	701201
006-0148	IL 26 & IL 29	S EDGE BUREAU JCT.	HENNEPIN CANAL	32	7.4		168	6,619	701501
006-0149	ILL 92	1.6 MI. W. US 34	BUREAU CREEK	32	7.4		306	12,056	701201
006-0153	IL 92	3.3 MI. W. OF US 34	STREAM	32	7.4		82.1	3,235	701201
006-0154	US 6/34	1 MI. W OF PRINCETON	BIG BUREAU CREEK	40	7.4		235.2	11,148	701201
006-0155	IL 29	EAST EDGE OF DEPUE	DRAINAGE DITCH	32	7.4		116	4,570	701201
006-0156	IL 40	3.5 MI. N. OF I-80	HICKORY CREEK	40	7.4		74.1	3,512	701201
006-0157	IL 40	3 MI. N. OF I-80	DITCH # 4	40	7.4		65	3,081	701201
006-0159	IL 26	0.3 MI. NW OF I-180	E. BUREAU CREEK	44	7.6	14.2	317.4	20,885	701601
006-0160	IL 92	1 MI. E. OF WALNUT	UNNAMED STREAM	32	7.4		78.5	3,093	701201
006-0161	US 6 & 34	AT EAST EDGE WYANET	WEST BUREAU CREEK	36	7.4		150	6,510	701201
006-0162	IL 26	N. EDGE OF PRINCETON	I-80	66.5	7.6	9	216.5	17,991	701601
006-0163	NEW BEDFORD RD	0.6 MI W JCT IL 40	GREEN RIVER	28	7.6		165	5,874	701201
006-0164	IL 89	0.60 MI S OF US 6	IAIS RAILROAD	30	4.6		230	7,958	701501
006-0169	US RT 6	W OF DEPUE SPUR	BRUSH CREEK	32	7.6		127	5,029	701201
006-0178	ILL 89	S. EDGE OF LADD	I-80	56	7.6	7	214.6	15,151	701601
006-0181	IL 89	0.5 MI S JCT US 34	PIKE CREEK	32	7.6		145	5,742	701201
006-0182	US 34	0.5 MI SW OF LAMOILLE	PIKE CREEK	32	7.6		105	4,158	701201
006-0183	US 34	1 MI NE OF LAMOILLE	PIKE CREEK	32	7.6		105	4,158	701201
006-0187	IL 26	N OF PRINCETON BY PARK	BIG BUREAU CREEK	40	7.6		255	12,138	701201
006-0188	IL 89	6.3 MI N OF I-80	BRUSH CREEK	32	7.6		70	2,772	701201
NON-INTERSTATE STRUCTURES SUB-TOTAL								317,305	
BUREAU COUNTY TOTALS								853,353	

* STRUCTURE HAS EXISTING PCC OVERLAY.
ADDITIONAL DRYING TIME MAY BE REQUIRED.

MODEL: \\MODELS\MARIES
FILE: \\maries_capp\work\bridge\calderon\007104570\966L44\sh-concr.dgn

* D3 BRIDGE DECK SEALING FY 2021 - BUREAU & LIVINGSTON COUNTIES

USER NAME = calderon	DESIGNED -	REVISED - LC 10.30.2020
	DRAWN -	REVISED -
PLOT SCALE = 100.0000' / in.	CHECKED -	REVISED -
PLOT DATE = 9/30/2020	DATE -	REVISED -

**STATE OF ILLINOIS
DEPARTMENT OF TRANSPORTATION**

SCHEDULES

SCALE: SHEET OF SHEETS STA. TO STA.

F.A. RTE.	SECTION	COUNTY	TOTAL SHEETS	SHEET NO.
VAR	*	VARIOUS	9	5
			CONTRACT NO. 66L44	
		ILLINOIS	FED. AID PROJECT	

BUREAU COUNTY

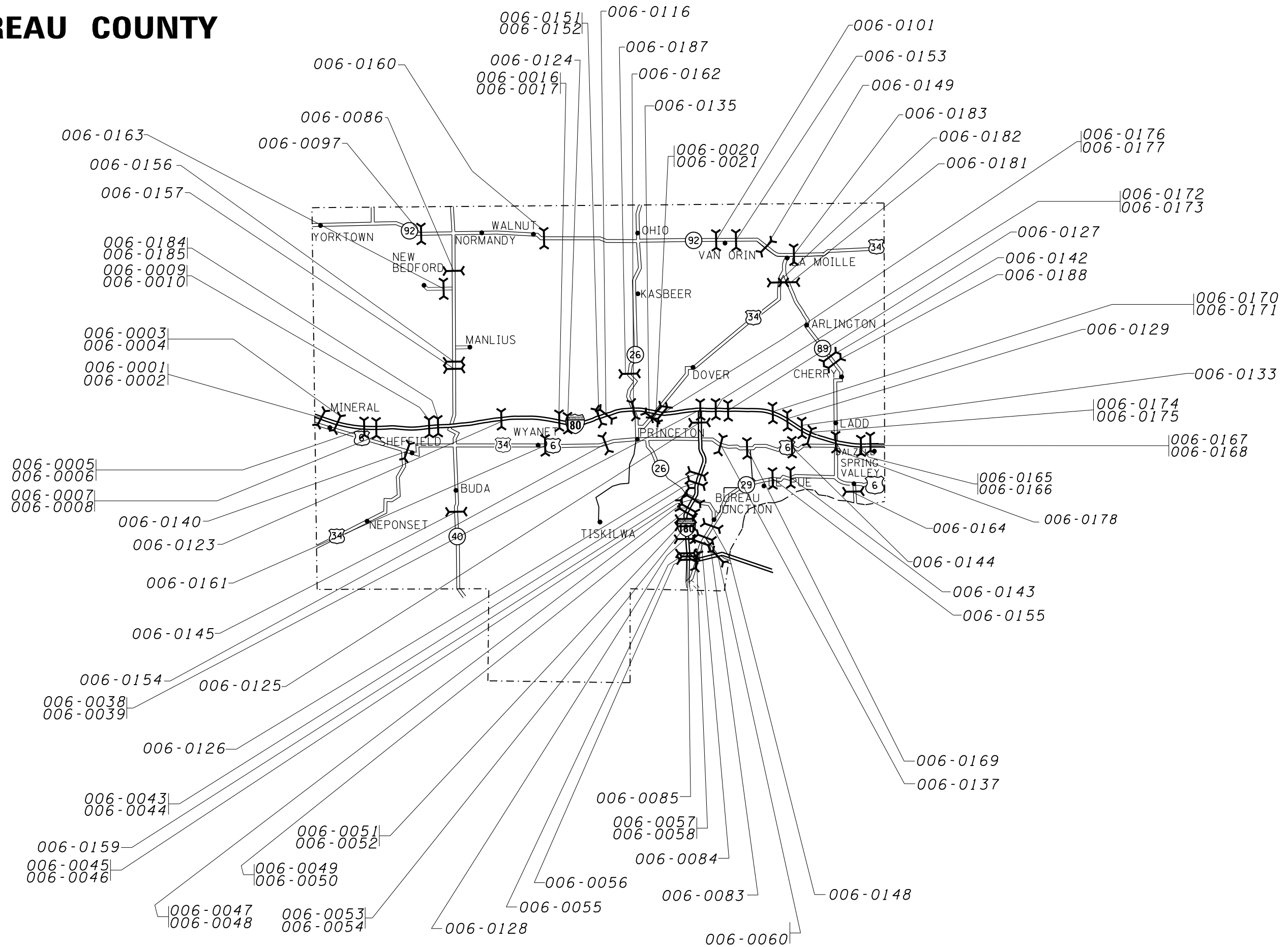

MODEL: \\MODELS\MARFES
 FILE: \\MARFES_CAD\work\bridge\calderon\071045370366L44\sh-covr.dwg

USER NAME = calderon	DESIGNED -	REVISED -
	DRAWN -	REVISED -
PLOT SCALE = 100.0000' / in.	CHECKED -	REVISED -
PLOT DATE = 9/30/2020	DATE -	REVISED -

STATE OF ILLINOIS
DEPARTMENT OF TRANSPORTATION

LOCATION MAP				
SCALE:	SHEET	OF	SHEETS	STA. TO STA.

* D3 BRIDGE DECK SEALING FY 2021 - BUREAU & LIVINGSTON COUNTIES				
F.A. RTE.	SECTION	COUNTY	TOTAL SHEETS	SHEET NO.
VAR	*	VARIOUS	9	6
			CONTRACT NO. 66L44	
		ILLINOIS	FED. AID PROJECT	

CONCRETE SEALER SCHEDULE - LIVINGSTON COUNTY

STRUCTURE NUMBER	FACILITY CARRIED	APPROXIMATE LOCATION	FEATURE CROSSED	DECK WIDTH	PARAPET SURFACE	MEDIAN SURFACE	DECK LENGTH	SEAL AREA	TRAFFIC CONTROL AND PROTECTION STANDARD
				FEET	FEET	FEET	FEET	SQ FT	
LIVINGSTON COUNTY - INTERSTATE STRUCTURES - 10									
053-0120	I-55 SOUTHBOUND	1.0 MILE NORTH OF	ROOKS	38.5	5		97	4,220	701406
053-0121	I-55 NORTHBOUND	MCLEAN COUNTY LINE	CREEK	38.5	5		97	4,220	701406
053-0124	I-55 SOUTHBOUND	3 MILES SOUTHWEST	ROOKS	38.5	5		282	12,267	701406
053-0125	I-55 NORTHBOUND	OF PONTIAC	CREEK	38.5	5		282	12,267	701406
053-0128	I-55 SOUTHBOUND	WEST OF	VERMILLION	38.5	5		403.5	17,552	701406
053-0129	I-55 NORTHBOUND	PONTIAC	RIVER	38.5	5		403.5	17,552	701406
053-0139	I-55 SOUTHBOUND	3 MILES SOUTHWEST	BRANCH WEST FORK	38.5	5		91.8	3,993	701406
053-0140	I-55 NORTHBOUND	OF DWIGHT	MAZON RIVER	38.5	5		91.8	3,993	701406
053-0186	I-55 SOUTHBOUND	0.5 MILES NORTH OF IL 17	NORFOLK SOUTHERN	40	7.6		150.5	7,164	701406
053-0187	I-55 NORTHBOUND	NORTHWEST OF DWIGHT	(CONRAIL) RAILROAD	40	7.6		150.5	7,164	701406, 701411
INTERSTATE STRUCTURES SUB-TOTAL								90,392	
LIVINGSTON COUNTY - NON-INTERSTATE STRUCTURES - 42									
053-0002	OLD RT 66/FAS 294	7.7 MI S OF ILL 116	DRAINAGE DITCH	32	1		74	2,442	701201
053-0003	OLD RT 66/FAS 294	4.5 MI S ILL 116	ROOKS CREEK	32	1		215.5	7,112	701201
053-0005	OLD RT 66/FAS 294	1.3 MI S ILL 116	TURTLE CREEK	33	1		63.2	2,149	701201
053-0007	ILL 116 EASTBOUND	0.6 MILE SOUTH	VERMILLION	40	7.4		229	10,855	701601
053-0008	ILL 116 WESTBOUND	OF ILL 23	RIVER	40	7.4		229	10,855	701601
053-0019	US 24	EAST EDGE FAIRBURY	INDIAN CREEK	39.3	7.4		163	7,612	701201
053-0026	ILL 17	1.3 MI E JCT ILL 17 & 23	VERMILLION RIVER	32	7.4		324.1	12,770	701201
053-0027	ILL 17	2.5 MI E JCT ILL 17 & 23	DRAINAGE DITCH	32	7.4		60.8	2,396	701201
053-0038	ILL 17	0.2 MI W OF ILL 47	GOOSEBERRY CREEK	44	1.6		32	1,459	701501
053-0047	ILL 47	0.3 MI N OF ILL 116	5 MILE CREEK	32	7.4		124.8	4,917	701201
053-0064	ILL 116	3.9 MI W OF I-55	ROOKS CREEK	39.4	1.2		75.8	3,077	701201
053-0066	ILL 116	1.1 MI E OF I-55	TURTLE CREEK	48	1.6	4	54.5	2,921	701606
053-0075	ILL 116	2.9 MI W OF ILL 47	FELKY SLOUGH	36			116	4,176	701201
053-0115	IL 23	2.23 MILE N OF PONTIAC	I-55	46.5	5	19.25	295	20,871	701601
053-0135	TR 101	4 MI NE OF PONTIAC	I-55	26.5	5		265.33	8,358	701201
053-0147	ILL 17	4.5 MI E OF ILL 47	GOOSEBERRY CR TRIB	32	7.6		118.8	4,704	701201
053-0150	ILL 17	6.1 MI E OF ILL 47	MAZON RIVER	36	7.6		181.6	7,918	701201
053-0157	FAS 370 (LONG POINT RD)	0.93 MI W OF IL 23	LONG POINT CREEK	28			108.6	3,041	701201
053-0158	ILL 17	1.33 MI W OF I-55	W FORK MAZON RIVER	32	7.4		107	11,342	701201
053-0160	ILL 17	1.0 MI E OF ILL 23	PRAIRIE CREEK	32	7.4		80.3	3,164	701201
053-0163	ILL 170	4.3 MI S OF ILL 17	BR OF MUD CREEK	32	7.4		67.8	2,671	701201
053-0164	ILL 170	6.2 MI S OF ILL 17	BR OF MUD CREEK	32	7.4		43.2	1,702	701201
053-0165	ILL 170	6.9 MI S OF ILL 17	BR OF BAKER RUN	32	7.4		54.9	2,163	701201
053-0166	ILL 47	0.9 MI S ILL 116	5 MILE CREEK	32	7.4		150.9	5,945	701201
053-0167	ILL 17	2.8 MI E OF ILL 17/23	DRAINAGE DITCH	32	7.4		107	4,216	701201
053-0168	ILL 47	0.4 MI S OF US 24	VERMILION RIVER	36	7.4		181.5	7,877	701501
053-0169	ILL 47	8.9 MI S OF US 24	INDIAN CREEK	36	7.4		91.3	3,962	701201
053-0170	ILL 47	0.2 MI S OF ILL 116	5 MILE CREEK	50.7	7.4		98	5,694	701201
053-0174	ILL 23	2.1 MI S OF I-55	NORTH CREEK	40	7.4		83.8	3,972	701201
053-0175	FAU 6322/OLD 66 NB	0.1 MILES NORTH	INTERMITTENT	33.9	1		121.4	4,237	701601
053-0176	FAU 6322/OLD 66 SB	OF IL 23	STREAM	33.9	1		121.4	4,237	701601
053-0177	ILL 23	1.3 MI W OF CORNELL	VERMILION RIVER	32	7.6		334	13,226	701201
053-0178	ILL 116	2.2 MI E OF ILL 47	5 MILE CREEK	32	7.6		92	3,643	701201
053-0179	ILL 47	3.6 MI S OF ILL 116	VERMILION RIVER	36	7.6		192	8,371	701201
053-0181	ILL 116	0.04 MI W OF ILL 47	5 MILE CREEK	46	7.6		91	4,878	701201
053-0182	ILL 17	3.4 MI E OF ILL 47	DRAINAGE DITCH	36	7.6		105	4,578	701201
053-0183	ILL 23	5.7 MI S OF ILL 17	MOLE CREEK	32	7.6		107.5	4,257	701201
053-0185	ILL 17	7.7 MI E OF ILL 47	STREAM	36	7.6		83.3	3,632	701201
053-0188	US 24	FORREST - W OF IL 47	S FORK VERMILION RIVER	30	7.6		228.6	8,595	701501
053-0189	IL 23	7.31 MI S OF IL 17	SHORT POINT CREEK	37.4	7.6		151.5	6,818	701201
053-0190	IL 116	1.9 MI E OF JCT IL 116 & IL 23	SMITH BRANCH	36	7.6		70.5	3,074	701201
053-0191	IL 116	2.53 MI E OF JCT IL 116 & IL 23	SMITH BRANCH	37.5	7.6		73	3,292	701201
NON-INTERSTATE STRUCTURES SUB-TOTAL								243,179	
LIVINGSTON COUNTY TOTALS								333,570	

* STRUCTURE HAS EXISTING PCC OVERLAY. ADDITIONAL DRYING TIME MAY BE REQUIRED.

MODEL: \\MODELS\MARIES
FILE: \\MARIES\cadd\work\bridge\calderon\1007104570\66L44\sh-concr.dgn

USER NAME = calderon	DESIGNED -	REVISED -
	DRAWN -	REVISED -
PLOT SCALE = 100.0000' / in.	CHECKED -	REVISED -
PLOT DATE = 9/30/2020	DATE -	REVISED -

**STATE OF ILLINOIS
DEPARTMENT OF TRANSPORTATION**

SCALE:	SHEET	OF	SHEETS	STA.	TO STA.
--------	-------	----	--------	------	---------

* D3 BRIDGE DECK SEALING FY 2021 - BUREAU & LIVINGSTON COUNTIES					
F.A. RTE.	SECTION	COUNTY	TOTAL SHEETS	SHEET NO.	
VAR	*	VARIOUS	9	7	
					CONTRACT NO. 66L44
					ILLINOIS FED. AID PROJECT

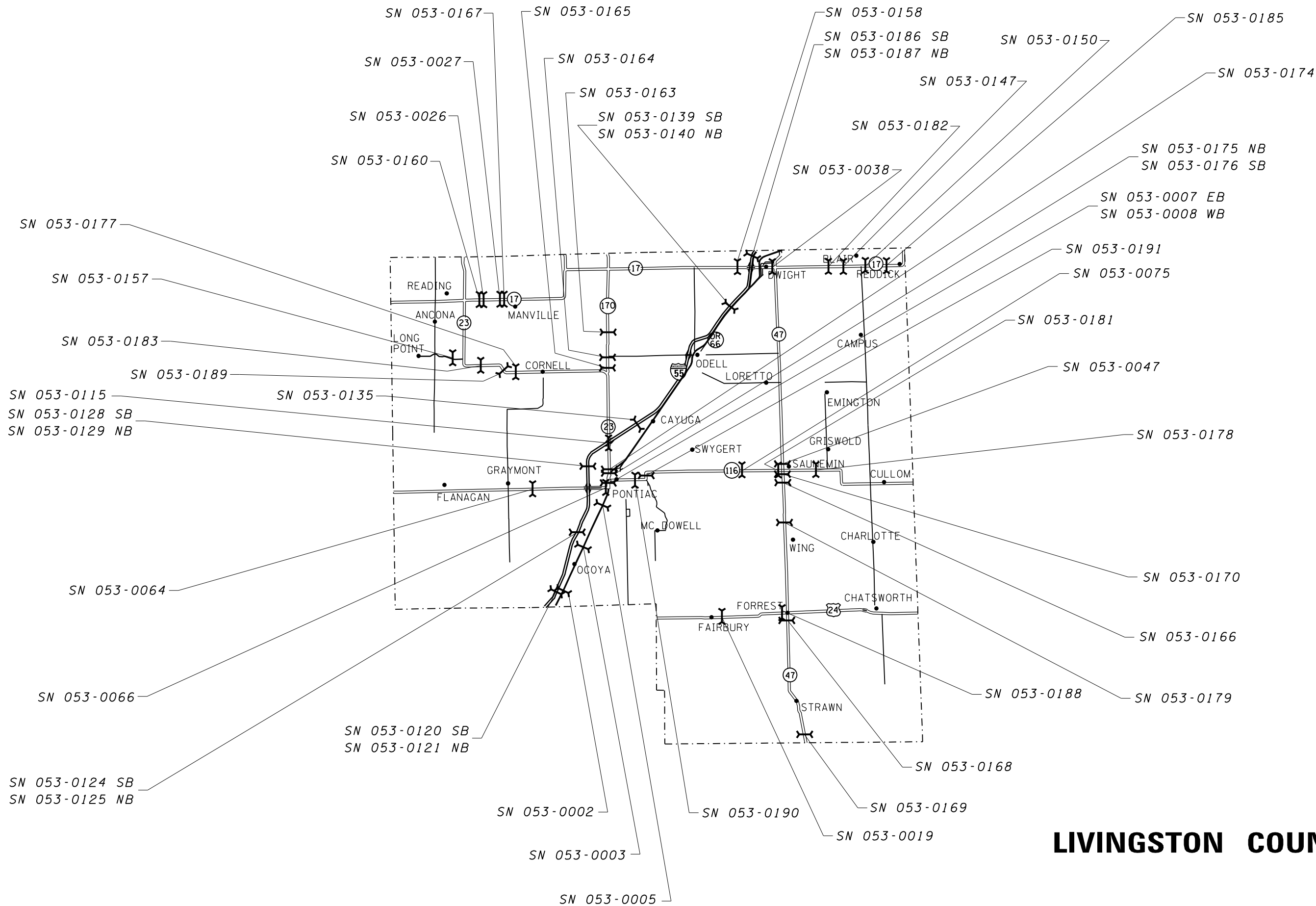

LIVINGSTON COUNTY

MODEL: \\MODELS\MARTE
 FILE: \\MARTE_CAD\work\bridge\calderon\07104570\66L44\sh-covr.dwg

* D3 BRIDGE DECK SEALING FY 2021 - BUREAU & LIVINGSTON COUNTIES

USER NAME = calderon	DESIGNED -	REVISED -	STATE OF ILLINOIS DEPARTMENT OF TRANSPORTATION	LOCATION MAP				F.A. RTE.	SECTION	COUNTY	TOTAL SHEETS	SHEET NO.
PLOT SCALE = 100.0000' / in.	DRAWN -	REVISED -		VAR	*	VARIOUS	9	8				
PLOT DATE = 9/30/2020	CHECKED -	REVISED -		SCALE:	SHEET	OF	SHEETS	STA.	TO	STA.	CONTRACT NO. 66L44	
	DATE -	REVISED -									ILLINOIS FED. AID PROJECT	

LIMITS OF BRIDGE DECK SEALING
END TO END OF DECK

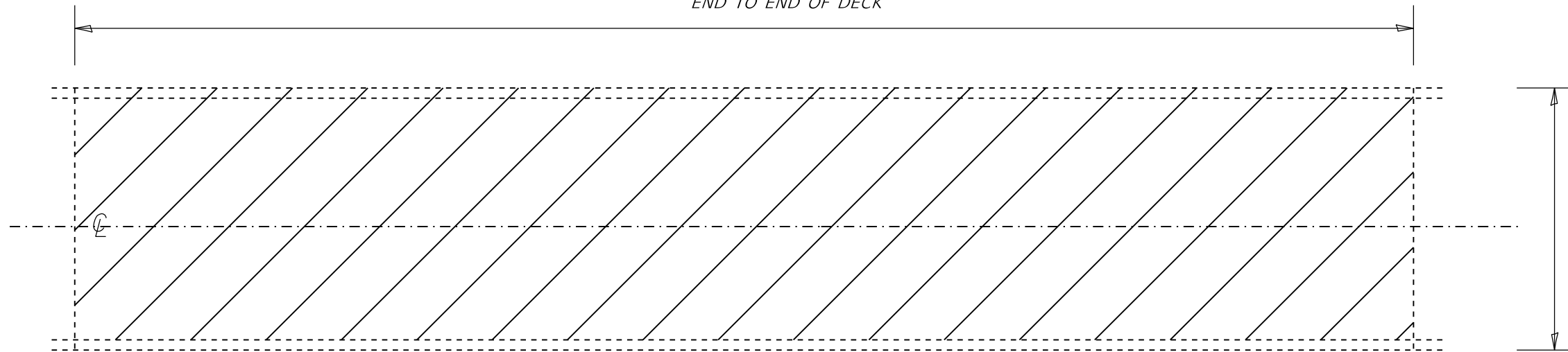

PLAN VIEW

NOTE: BRIDGE APPROACH PAVEMENT SHALL NOT BE SEALED.

EXISTING PAVEMENT MARKINGS AND RAISED REFLECTIVE PAVEMENT MARKERS SHALL BE TEMPORARILY COVERED PRIOR TO APPLICATION OF THE DECK SURFACE TREATMENT, TO PREVENT THE MATERIAL FROM BEING APPLIED TO THE MARKINGS AND TO PROTECT THE REFLECTIVE PROPERTIES OF THE MARKINGS. THE TEMPORARY COVERING MATERIAL USED SHALL BE SUCH THAT IT WILL NOT AFFECT THE MARKING'S REFLECTIVITY WHEN REMOVED AFTER APPLICATION OF THE DECK SURFACE TREATMENT AND PRIOR TO OPENING TO TRAFFIC. COST INCLUDED WITH CONCRETE SEALER. EXISTING EXPANSION JOINTS SHALL BE TEMPORARILY COVERED, PRIOR TO APPLICATION OF THE DECK SURFACE TREATMENT, TO PREVENT THE MATERIAL FROM BEING APPLIED TO THE JOINTS. THE TEMPORARY COVERING SHALL BE REMOVED AFTER THE APPLICATION OF THE DECK SURFACE TREATMENT AND PRIOR TO OPENING TO TRAFFIC. COST IS INCLUDED WITH CONCRETE SEALER.

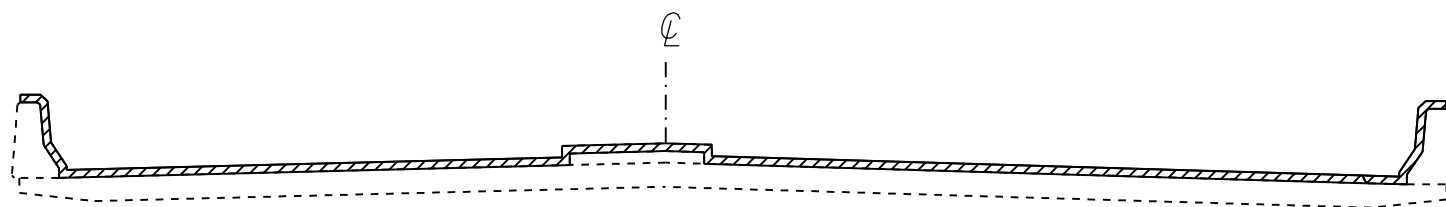

SECTION WITH
PARAPET AND MEDIAN

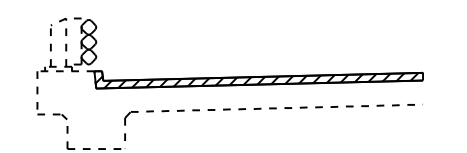

SECTION WITH CURB AND
TUBULAR THREE BEAM RETROFIT RAIL

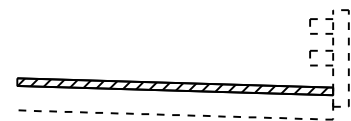

SECTION WITH
BRIDGE RAIL

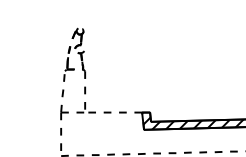

CONCRETE AND
ALUMINUM RAILING

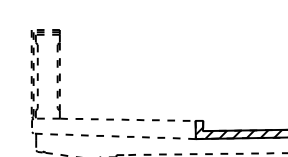

CONCRETE
BRIDGE RAILING

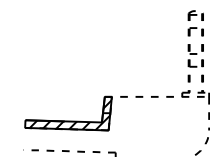

BRIDGE RAIL

VARIOUS SECTIONS WITH SIDEWALK AND/OR CONCRETE CURB



SECTION WITH CONCRETE
AND ALUMINUM RAILING

 AREA TO BE SEALED

NOT TO SCALE

MODEL: \\MODELMANETS
FILE: \\manets_cad\work\bridge\calderon\607104570\66L44\sh-cd-0616.dgn

USER NAME = calderonl	DESIGNED -	REVISED -
	DRAWN -	REVISED -
PLOT SCALE = 100.0000' / in.	CHECKED -	REVISED -
PLOT DATE = 9/30/2020	DATE -	REVISED -

STATE OF ILLINOIS
DEPARTMENT OF TRANSPORTATION

BRIDGE DECK & PARAPET
SEALING DETAILS

SCALE: SHEET OF SHEETS STA. TO STA.

* D3 BRIDGE DECK SEALING FY 2021 - BUREAU & LIVINGSTON COUNTIES			
F.A. RTE.	SECTION	COUNTY	TOTAL SHEETS
VAR	*	VARIOUS	9
		CONTRACT NO.	66L44
		ILLINOIS	FED. AID PROJECT